

NO.	DATE	REVISION	APPROV.
1	8/31/00	REVISED EAST PARKING LOT GRADES, TYP. SECTIONS, SWALE	JFW
2	10/09/01	REVISED PER CONSTRUCTION RECORDS	JFW
3			

NOTES:

TEMPORARY SWALE TO BE HYDROMULCHED WITH GRASS IN ACCORDANCE WITH GRADING NOTE 9.

LEGEND:

- TC 585.05 TOP OF CURB ELEVATION
- P 593.91 PAVEMENT ELEVATION
- 582 — PROPOSED CONTOUR

BENCHMARK:

1. CITY MON. NO. 2 LOCATED ON THE NORTHWEST CORNER OF THE BRIDGE @ I-30 AND F.M. 549 ELEVATION = 609.56
2. "□" CUT IN THE CENTER OF A 4 FOOT HEADWALL LOCATED AT THE NORTHEAST CORNER OF F.M. 549 AND STATE HIGHWAY 276 ELEVATION = 592.75

GRADING NOTES

1. IT SHALL BE THE RESPONSIBILITY OF THE CONTRACTOR TO VERIFY BOTH HORIZONTALLY AND VERTICALLY THE LOCATION OF ALL EXISTING UTILITIES AND UNDERGROUND FACILITIES PRIOR TO CONSTRUCTION, TO TAKE NECESSARY PRECAUTIONS IN ORDER TO PROTECT ALL FACILITIES ENCOUNTERED, AND TO NOTIFY THE ENGINEER PROMPTLY OF ALL CONFLICTS OF THE WORK WITH EXISTING FACILITIES. THE CONTRACTOR SHALL PRESERVE AND PROTECT ALL EXISTING UTILITIES FROM DAMAGE DURING CONSTRUCTION. ANY DAMAGES BY THE CONTRACTOR TO EXISTING UTILITIES SHALL BE REPAIRED BY THE CONTRACTOR AT HIS EXPENSE. EXISTING TOPOGRAPHIC INFORMATION SHOWN IS BASED ON FIELD SURVEY PREPARED BY WIER & ASSOCIATES.
2. GRADING CONTRACTOR SHALL NOTIFY AND COORDINATE WITH ALL UTILITY COMPANIES OR FIRMS HAVING FACILITIES ON OR ADJACENT TO THE PROJECT STREETS BEFORE DISTURBING, ALTERING, REMOVING, RELOCATING, ADJUSTING OR CONNECTING TO SAID FACILITIES. CONTRACTOR SHALL PAY ALL COSTS IN CONNECTION WITH THE ALTERATION OF OR RELOCATION OF THE EXISTING MANHOLES AND GATE VALVE BOXES AS REQUIRED TO MATCH FINISHED GRADES IN CONFORMANCE WITH THE CITY STANDARDS. NO SEPARATE MEASUREMENT OR PAYMENT WILL BE MADE.
3. GRADING CONTRACTOR SHALL COOPERATE WITH ALL OTHER CONTRACTORS PERFORMING WORK ON THIS PROJECT TO INSURE PROPER AND TIMELY COMPLETION OF THIS PROJECT.
4. GRADING CONTRACTOR TO COMPLY WITH ALL STATE AND LOCAL SEDIMENT CONTROL AND AIR POLLUTION ORDINANCES OR RULES.
5. FOR THE WORK ON THE CITY RIGHT-OF-WAY, THE GRADING CONTRACTOR SHALL PROVIDE ALL NECESSARY AND ADEQUATE SAFETY PRECAUTIONS SUCH AS SIGNS, FLAGS, LIGHTS, BARRICADES AND FLAGMEN AS REQUIRED BY THE LOCAL AUTHORITIES AND IN ACCORDANCE WITH THE MANUAL ON UNIFORM TRAFFIC CONTROL DEVICES. THE GRADING CONTRACTOR SHALL BE SOLELY RESPONSIBLE FOR AND HOLD HARMLESS, THE CITY, AND THE OWNER FROM ANY CLAIMS FOR DAMAGE DONE TO EXISTING PRIVATE PROPERTY, PUBLIC UTILITIES, OR THE TRAVELING PUBLIC.
6. COMPLETE THE WORK TO THE SATISFACTION OF THE CITY PUBLIC WORKS DEPARTMENTS AND OBTAIN A LETTER FROM THE DEPARTMENT STATING THAT THE WORK UNDER PUBLIC JURISDICTION IS ACCEPTABLE.
7. GRADING CONTRACTOR SHALL TAKE ALL AVAILABLE PRECAUTIONS TO CONTROL DUST. CONTRACTOR SHALL CONTROL DUST BY SPRINKLING, OR BY OTHER METHODS AS DIRECTED BY ENGINEER AND/OR OWNER'S.
8. REFER TO PAVING DETAILS FOR TYPE OF PAVING AND BASE TO BE USED.
9. ALL AREAS NOT COVERED BY PAVING OR PLANNED LANDSCAPING SHALL BE PLANTED WITH GRASS WITHIN THE PROJECT LIMITS INCLUDING ADJACENT PARKWAYS AND DISTURBED AREAS. SEE LANDSCAPING PLAN.
10. ALL EXCAVATING IS UNCLASSIFIED AND SHALL INCLUDE ALL MATERIALS ENCOUNTERED. UNSUITABLE EXCAVATED MATERIALS AND ALL WASTE RESULTING FROM CLEARING AND GRUBBING SHALL BE DISPOSED OF OFF-SITE BY GRADING CONTRACTOR.
11. MAINTAIN AS MUCH EXISTING VEGETATION AS POSSIBLE AS WELL AS RE-ESTABLISHING THE GROUND COVER AS EARLY AS POSSIBLE. GRASS BUFFER STRIPS SHALL BE LEFT AROUND THE PERIMETER TO AID IN FILTERING SEDIMENTATION. A DENSITY OF TEMPORARY OR PERMANENT GROUND COVER SUFFICIENT TO PREVENT EROSION SHOULD BE ESTABLISHED ON ALL BERMS, SWALES, AND SLOPES.
12. ALL SITE GRADING AND EARTHWORK CONSTRUCTION SHALL COMPLY WITH THE GEOTECHNICAL REPORT.
13. ALL STORM DRAIN CONSTRUCTION SHALL CONFORM TO THE STANDARD CONSTRUCTION DETAILS OF THE CITY OF ROCKWALL OR TXDOT, AS SPECIFIED.

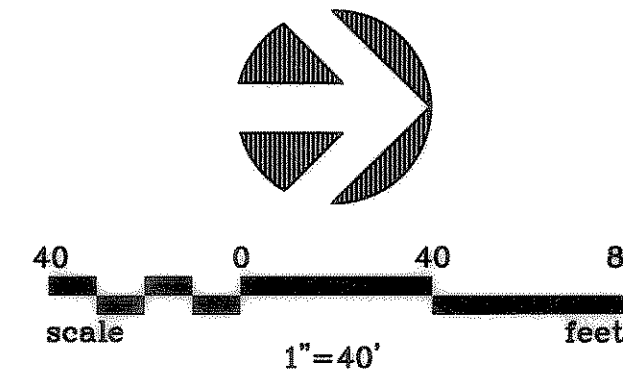

OFF-SITE GRADING AUTHORIZED BY ADJACENT PROPERTY OWNER VIA LETTER DATED AUG. 7, 2000.

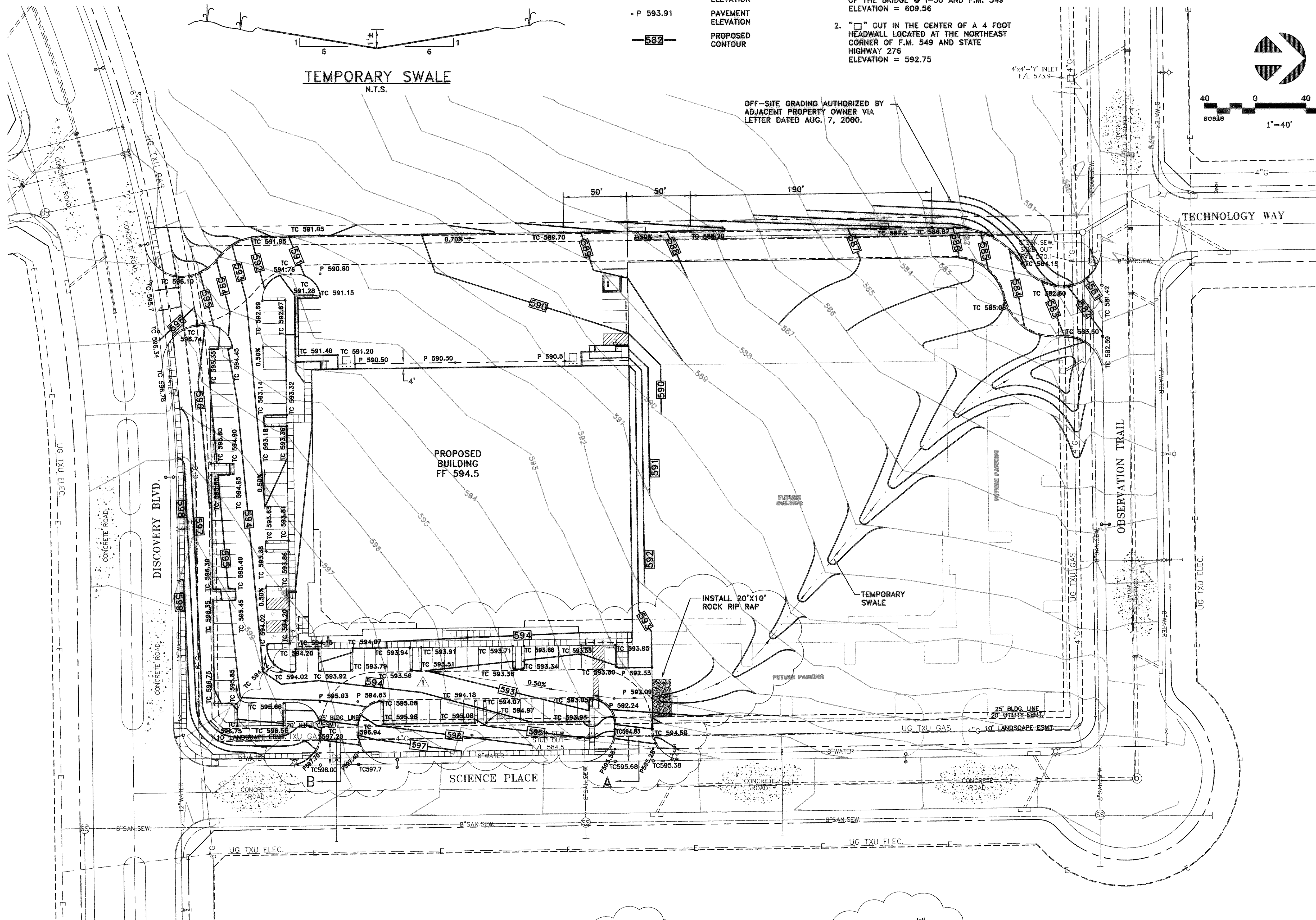

!! CAUTION !!
 EXISTING AND/OR PROPOSED UTILITIES IN AREA. CONTRACTOR SHALL CONTACT THE PROPER UTILITY COMPANIES AT LEAST 48 HOURS PRIOR TO CONSTRUCTION. THESE CONTACTS SHALL INCLUDE, BUT NOT BE LIMITED TO THE FOLLOWING COMPANIES:
 TXU ELECTRIC 972-485-6277
 TXU GAS 1-800-725-0934
 NORTH TEXAS CABLE COM. 972-771-0202
 SOUTHWESTERN BELL TELEPHONE 214-320-5307

RECORD DRAWING
 BASED ON CONTRACTOR MARKUPS,
 NOT FIELD SURVEY.

ALL ABOVE GROUND TOPOGRAPHIC FEATURES INCLUDING MANHOLES, FIRE HYDRANTS, PAVEMENT, INLETS, AND ELEVATION CONTOURS ARE BASED UPON A TOPOGRAPHIC SURVEY COMPLETED BY WEIR AND ASSOCIATES. ALL UNDERGROUND UTILITY INFORMATION BASED ON IMPROVEMENT PLAN FOR ROCKWALL TECHNOLOGY PARK PREPARED BY WEIR & ASSOCIATES, INC. DATED JANUARY 1999.

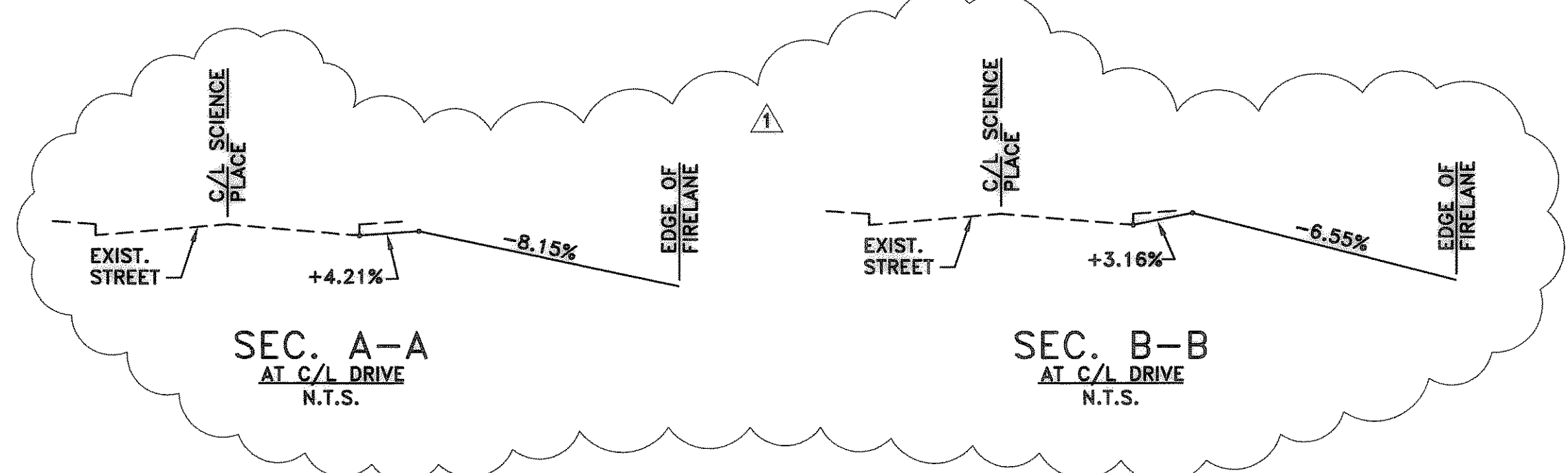

DATE:	JULY 2000	SCALE:	1"=40'	JOB NO.:	00-226
DRAWN:	GBW	DESIGN:	JFW	REVIEWED:	BRG
REDC PHASE I OFFICE/WAREHOUSE GRADING PLAN					
ROCKWALL ECONOMIC DEVELOPMENT CORPORATION					
Grantham, Burge & Waldbauer Engineers, Inc.					
SHT. 3					
OF 7					

1919 S. SHILOH ROAD, SUITE 530, L.B. 27 GARLAND, TEXAS 75042
 (972) 840-1916 (TEL)
 (972) 840-2156 (FAX)