

212 W. Ninth Street
Tyler, Texas 75701
903-597-6606
903-597-0517 Fax

MHS
PLANNING & DESIGN, LLC

TRAIL DETAILS
ROCKWALL TECHNOLOGY PARK
ROCKWALL EDC, ROCKWALL, TEXAS

SAWED CRACK CONTROL JOINTS ON 5' CENTERS ON 5' WIDE CONC TRAILS
6' CENTERS ON 6' WIDE CONC TRAILS

3/4" EXPANSION JOINTS AT 48' MAXIMUM INTERVALS AND WHERE SIDEWALK ABUTS PERPENDICULAR TO EDGES OF CONCRETE TRAIL, BUILDING STRUCTURES, ETC. SEE DETAILS THIS SHEET.

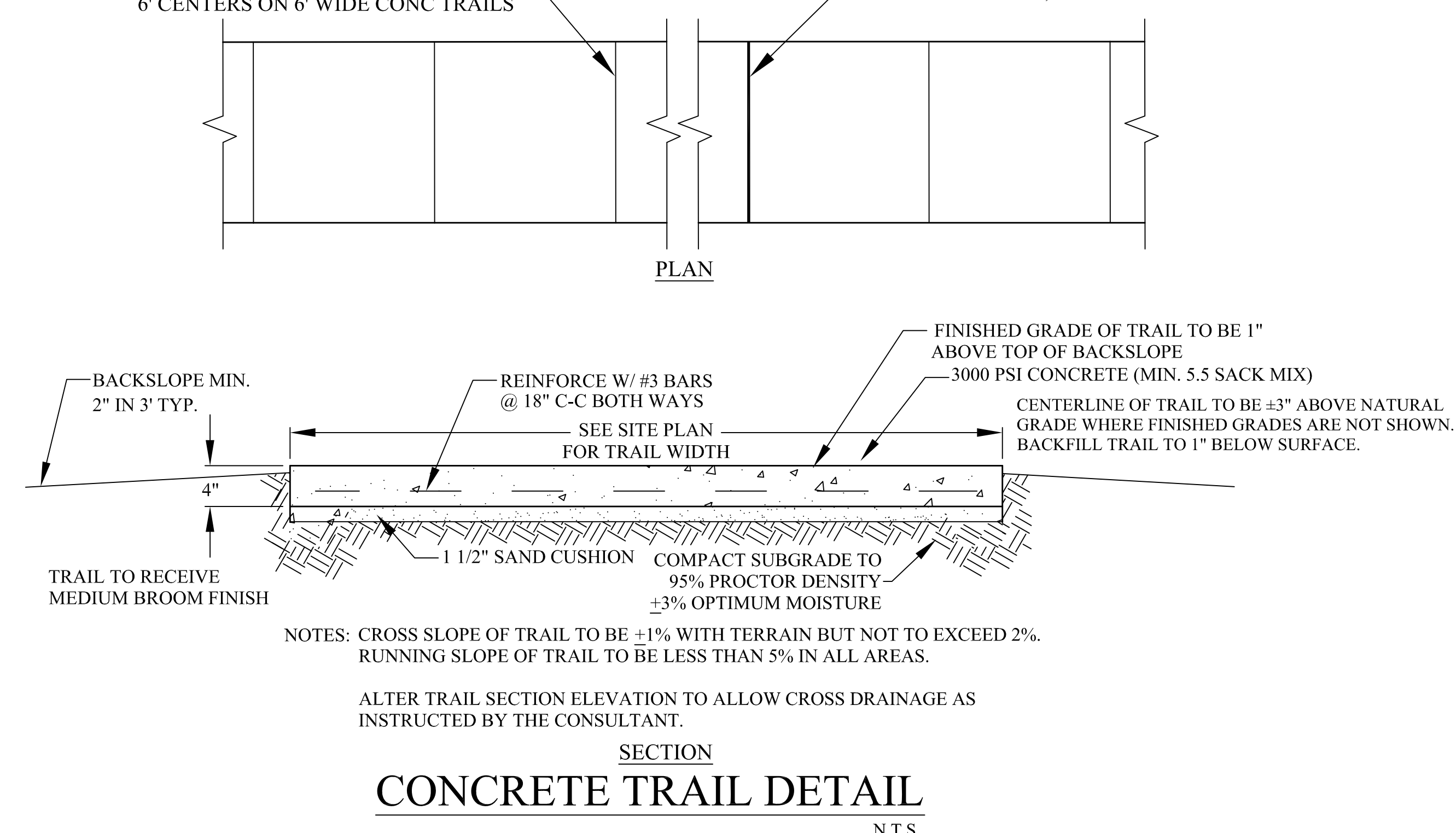

NOTE: TRAIL LOCATIONS TO BE STAKED ON THE GROUND FOR APPROVAL BY CONSULTANT PRIOR TO CONSTRUCTION.

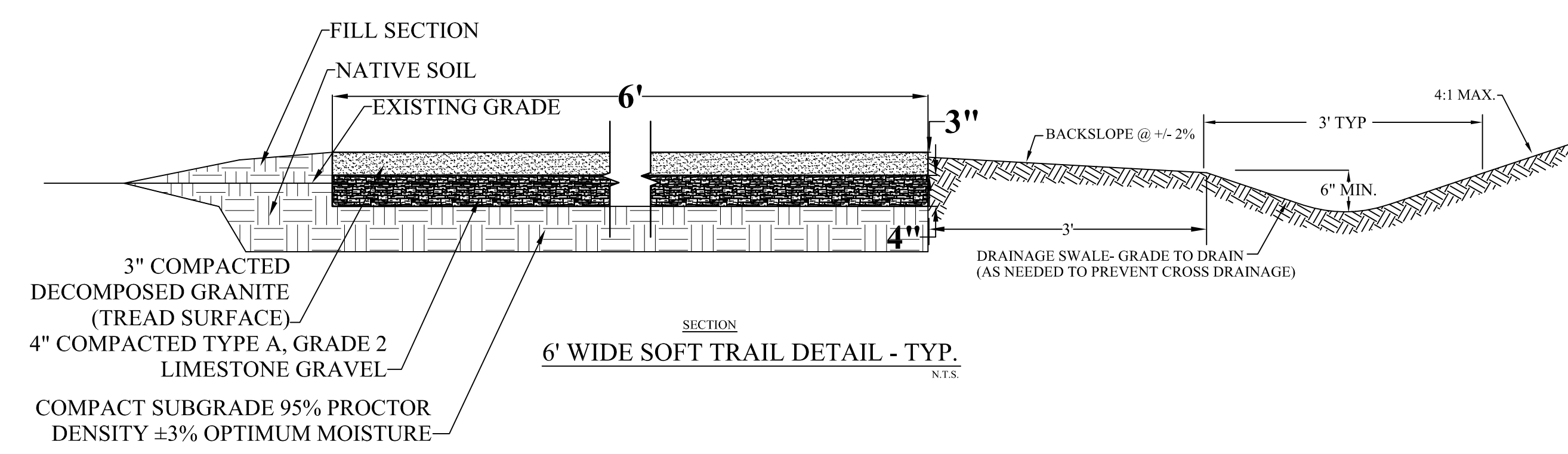
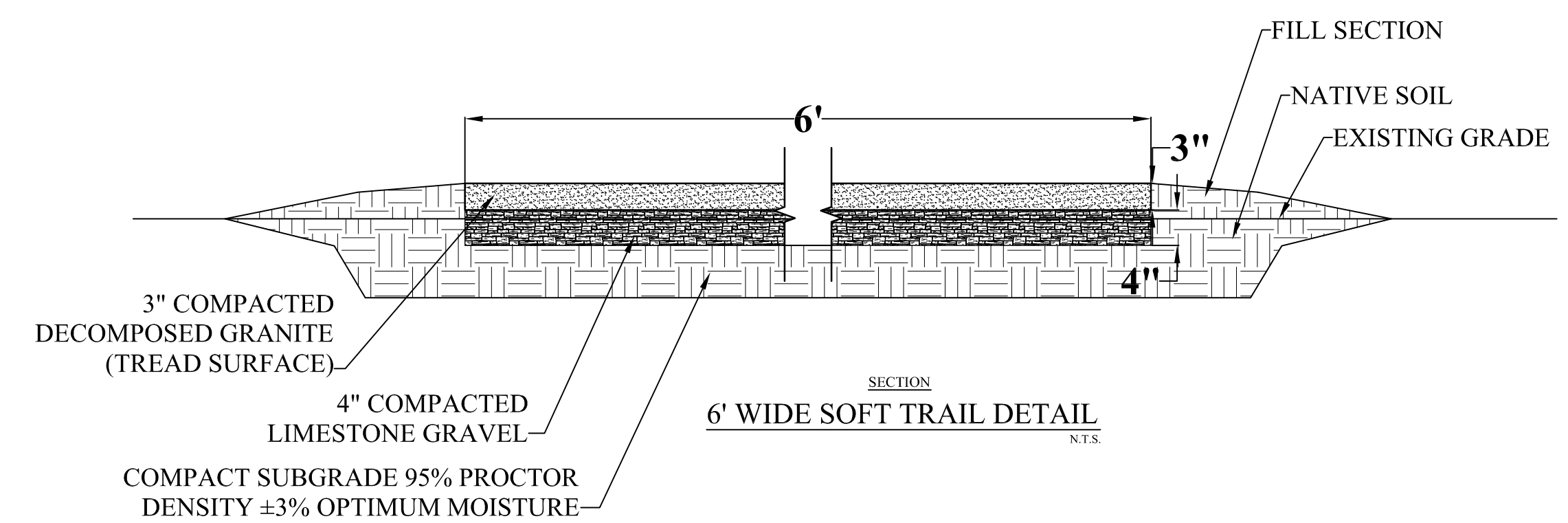

NOTE: GRADE TRAIL CORRIDOR TO MEET REQUIRED SLOPES. SHAPE REQUIRED DRAINAGE SWALE ON UPHILL SIDE TO PREVENT CROSS DRAINAGE. EXCAVATE NATIVE SOIL TO A DEPTH OF 4" & 6" WIDTH, COMPACT AS INDICATED, ADD LIMESTONE GRAVEL, COMPACT, PLACE DECOMPOSED GRANITE AS TRAIL SURFACE, & ROLL UNTIL COMPACTED. USE NATIVE SOIL TO BRING OUTSIDE EDGES OF TRAIL FLUSH WITH TOP OF GRANITE TREAD. FEATHER OUT AS INDICATED. CROSS SLOPE OF TRAIL TO BE ±1% WITH TERRAIN BUT NOT TO EXCEED 2%. RUNNING SLOPE OF TRAIL TO BE LESS THAN 5% IN ALL AREAS. FINISHED TREAD SURFACE SHALL BE SMOOTH, STABLE, FIRM, & SLIP RESISTANT.

DECOMPOSED GRANITE TRAIL TO BE FORMED WITH 1" x 4" FORMING BOARDS, COMPACTED AND THEN FORMING BOARDS TO BE REMOVED.

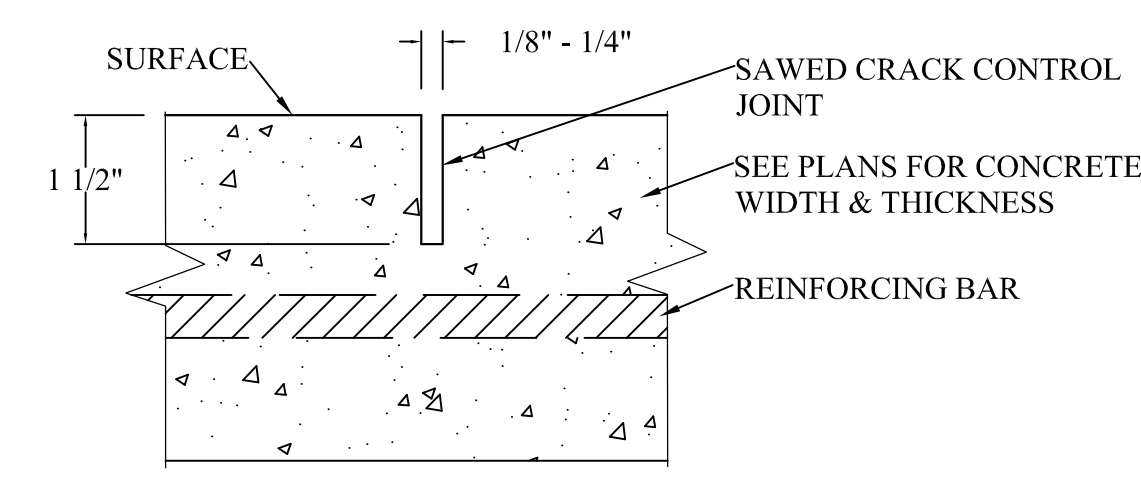
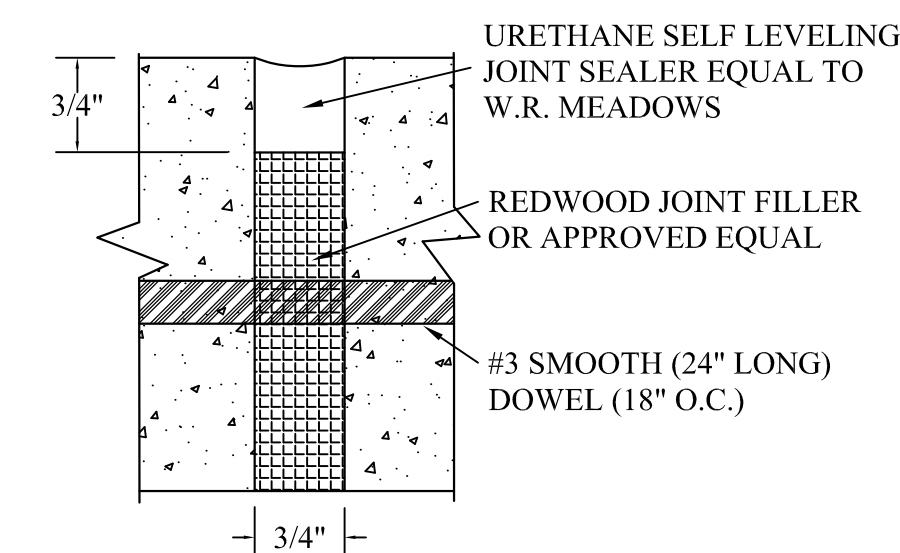
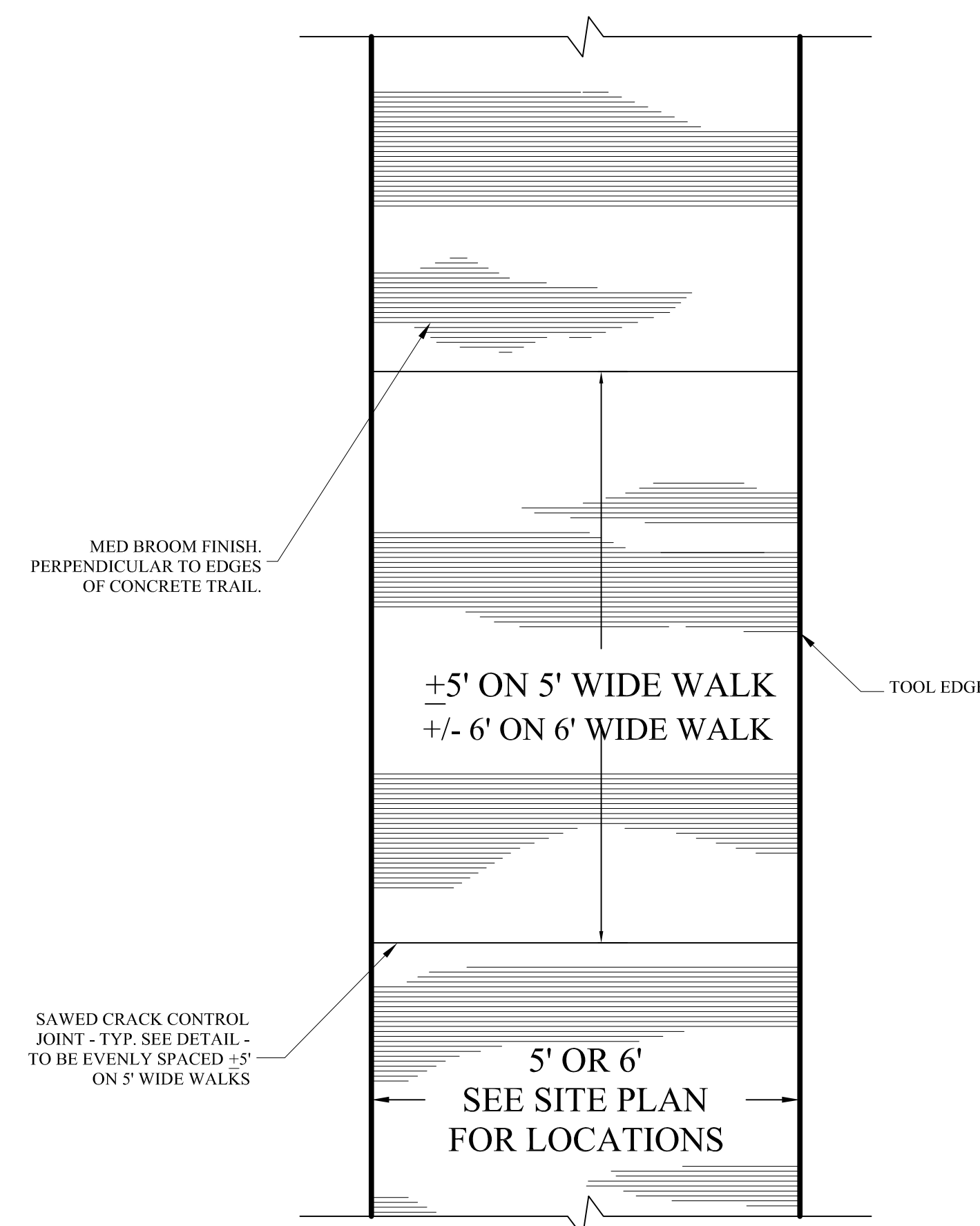

DRAWN: HNR
CHECKED: MHS
DATE: JAN 2012
SCALE: AS SHOWN
JOB NO.: 12-001