

TREES TO BE REMOVED				TREES TO REMAIN AND BE PROTECTED			
TREE ID	COMMON NAME	CALIPER REMOVED (INCH)	REPLACEMENT CALIPER (INCH)	TREE ID	COMMON NAME	CALIPER (INCH)	
#1	HACKBERRY	13	6.5	#2	HACKBERRY	13	
#7	HACKBERRY	12	6	#3	HACKBERRY	13	
#8	HACKBERRY	11	5.5	#4	HACKBERRY	12	
#9	HACKBERRY	11	5.5	#5**	AMERICAN ELM	25 (4x10')	
#10	HACKBERRY	12	6	#6***	AMERICAN ELM	4	
#11	HACKBERRY	15	7.5	#46	HACKBERRY	12	
#12	HACKBERRY	11	5.5	#47	HACKBERRY	13	
#13	HACKBERRY	11	5.5	#48	HACKBERRY	13	
#14	HACKBERRY	12	6	#49	HACKBERRY	28 (1x8", 1x24")	
#15	HACKBERRY	13	6.5	#50	HACKBERRY	15	
#16	HACKBERRY	20 (1x12", 2x8")	10	#51	HACKBERRY	14	
#17	HACKBERRY	13	6.5	#52	HACKBERRY	18	
#18	HACKBERRY	11	5.5	#53	HACKBERRY	13	
#19	HACKBERRY	11	5.5				TOTAL: 196"
#20	HACKBERRY	11	5.5				*** FEATURE TREE
#21	HACKBERRY	12	6				
#22	HACKBERRY	11	5.5				
#23	HACKBERRY	15	7.5				
#24	HACKBERRY	12	6				
#25	HACKBERRY	11	5.5				
#26	RED CEDAR	11	5.5				
#27	HACKBERRY	11	5.5				
#28**	AMERICAN ELM	11	5.5				
#29	HACKBERRY	11	5.5				
#30	HACKBERRY	11	5.5				
#31	HACKBERRY	11	5.5				
#32	RED CEDAR	11	5.5				
#34	HACKBERRY	18	9				
#35	HACKBERRY	11	5.5				
#36	BOIS D'ARC	34 (1x22", 2x12")	0				
#37	RED CEDAR	11	5.5				
#38	RED CEDAR	11	5.5				
#39	HACKBERRY	13	6.5				
#40	HACKBERRY	16.5 (1x6", 1x7", 1x9")	8.5				
#41	BOIS D'ARC	15	15				
#42	HACKBERRY	11	5.5				
#43	HACKBERRY	16.5 (2x11")	8.5				
#44	HACKBERRY	24	12				
#45	HACKBERRY	11	5.5				
#54	RED CEDAR	11	5.5				
		TOTAL:	502"				259.5"

PROPOSED TREES

TREE TYPE	SIZE	QTY	TOTAL CALIPER (INCH)
DECIDUOUS CANOPY	3" CAL.	43	129
DECIDUOUS ORNAMENTAL	2" CAL.	3	6
EVERGREEN**	8" HT./2" CAL.	112	224
		TOTAL:	359

***NOTE:
ACCORDING TO THE AMERICAN STANDARD FOR NURSERY STOCK, AN 8" HEIGHT EVERGREEN TREE HAS A TWO (2) INCH CALIPER. IF THESE TREES CAN BE APPLIED TO THE REPLACEMENT CALIPERS, THE PLAN MEETS THE MITIGATION REQUIREMENT.

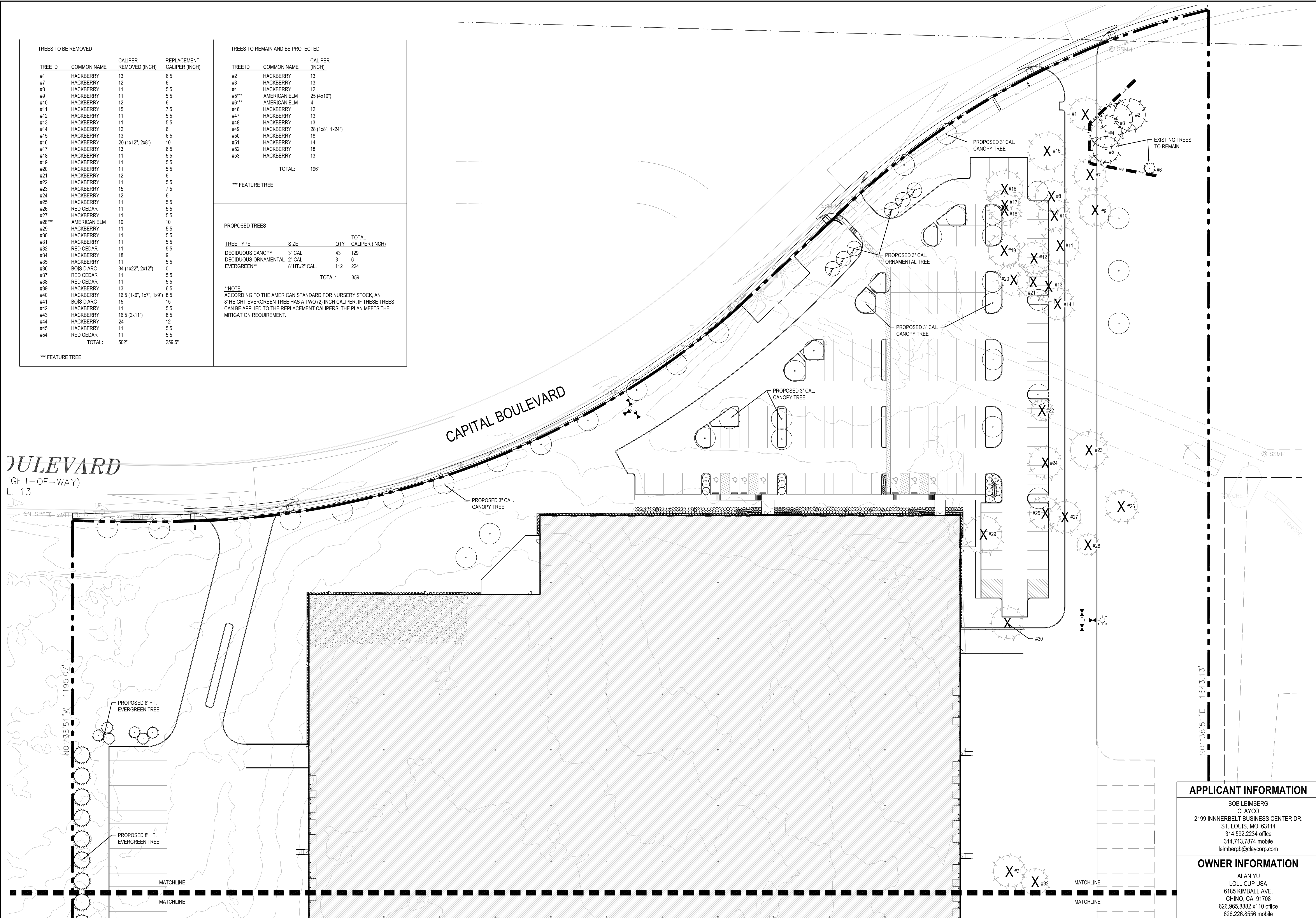

BOULEVARD
RIGHT-OF-WAY
L. 13

CAPITAL BOULEVARD

S01°38'51"E 1643.13'

APPLICANT INFORMATION
BOB LEIMBERG
CLAYCO
2199 INNERBELT BUSINESS CENTER DR.
ST. LOUIS, MO 63114
314.592.2234 office
314.713.7874 mobile
leimbergb@claycorp.com

OWNER INFORMATION
ALAN YU
LOLLICUP USA
6185 KIMBALL AVE.
CHINO, CA 91708
626.965.8882 x110 office
626.226.8556 mobile
alan.yu@lollcup.com

PROJECT NAME
LOLLICUP
CASE NUMBER: SP2017-042

DRAWING ISSUE	
DESCRIPTION	DATE
SITE PLAN SUBMITTAL - CITY OF ROCKWALL	12/15/17
REVISIONS - CITY OF ROCKWALL	01/03/18
ENGINEERING REVIEW	03/02/18
RECORD DRAWINGS	03/06/19

DRAWING TITLE
TREESCAPE PLAN
AREA 1

DRAWING NO.
L01-01

Form # 601-03049 Consult.# 101-03049

CLAYCO
THE ART & SCIENCE OF BUILDING
2199 INNERBELT BUSINESS CENTER DRIVE
ST. LOUIS, MISSOURI 63114
Ph 314.429.5100 Fx 314.429.3137

ARCHITECT
FORUM
2199 INNERBELT BUSINESS CENTER DRIVE
ST. LOUIS, MISSOURI 63114
Ph 314.429.1010 Fx 314.429.7770

CONTRACTOR / DEVELOPER
CLAYCO
LANDSCAPE ARCHITECT
FORUM
CIVIL ENGINEER
FREESE & NICHOLS
STRUCTURAL ENGINEER

MECHANICAL ENGINEER
ELECTRICAL ENGINEER
PLUMBING ENGINEER
FIRE PROTECTION ENGINEER

Lollcup
3201 Capital Blvd.
Rockwall, Texas 75032

1 TREESCAPE PLAN - AREA 1
SCALE: 1" = 40'-0"



13/2018 2:16:04 PM