

DISCOVERY BOULEVARD

DISCOVERY BOULEVARD

INNOVATION DRIVE

INNOVATION DRIVE

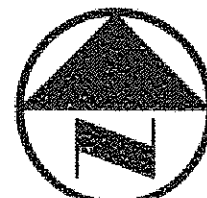

LEGEND

- B. BOLLARD
- EM. ELECTRIC METER
- PP. POWER POLE
- LS. LIGHT STANDARD
- WM. WATER METER
- WV. WATER VALVE
- ICV. IRRIGATION CONTROL VALVE
- FH. FIRE HYDRANT
- CL. CLEANOUT
- MH. MANHOLE
- TSC. TRAFFIC SIGNAL CONTROL
- TSP. TRAFFIC SIGNAL POLE
- TE. TELEPHONE BOX
- FL. FLOOD LIGHT
- FP. FLAG POLE
- TS. TRAFFIC SIGN
- PROPERTY LINE
- FENCE
- PROPOSED DRAINAGE DIVIDE
- PROPOSED CONTOUR
- PROPOSED DRAINAGE FLOW DIRECTION
- PROPOSED 100-YR FLOODPLAIN LIMITS
- PROPOSED DRAINAGE AREA ID AREA IN ACRES Q100 IN CUBIC FEET PER SECOND
- EXISTING DRAINAGE AREA ID AREA IN ACRES Q100 IN CUBIC FEET PER SECOND
- PROPOSED DETENTION AREA

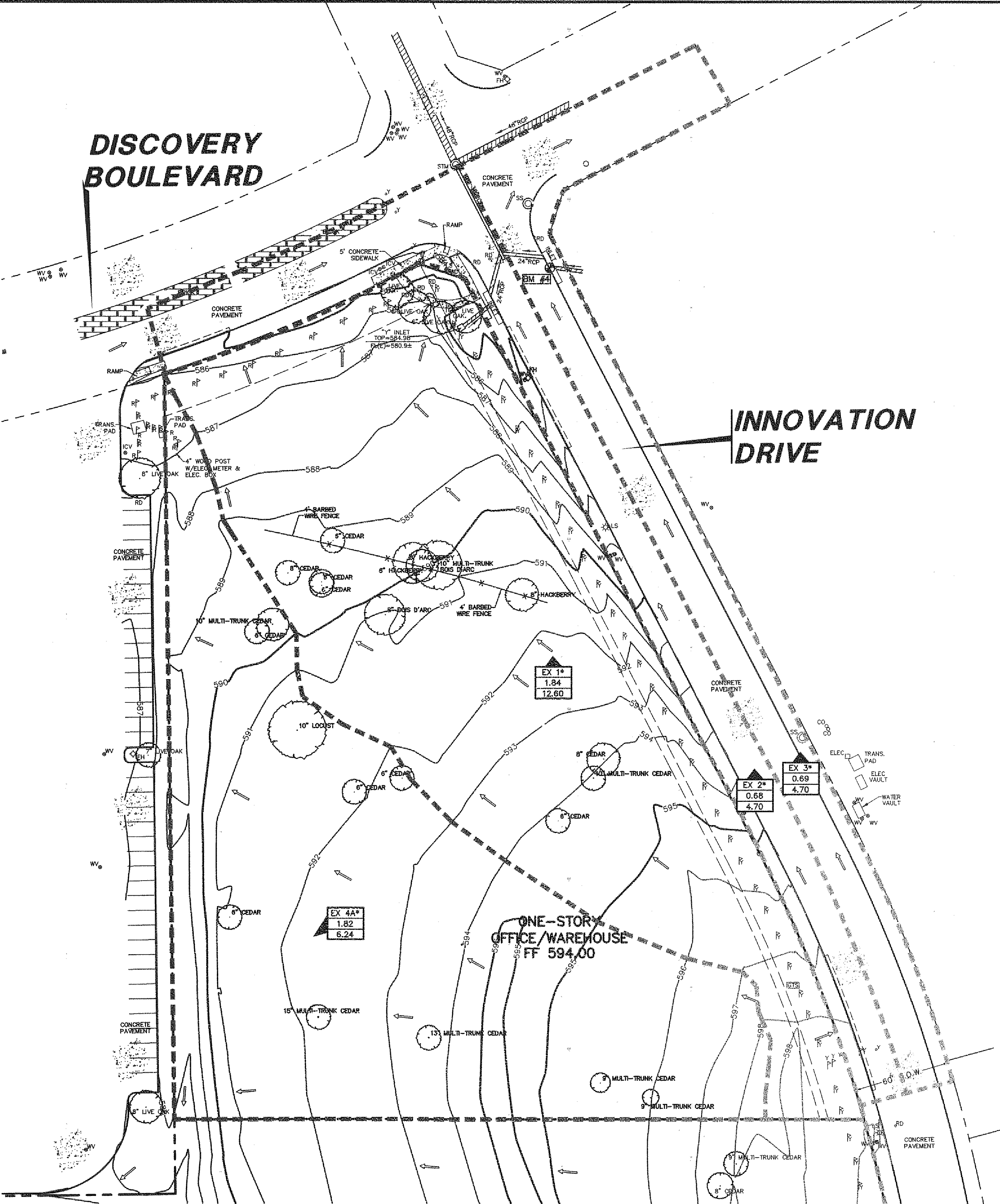

1 EXISTING DA MAP

EXISTING DRAINAGE CRITERIA:
Q=(C)(I)(A)

DRAINAGE AREA ID	AREA (acres)	C	Tc (minutes)	STORM FREQUENCY (100 YEAR)	I ₁₀₀ (inch/hour)	Q ₁₀₀ (cfs)	COMMENTS
1**	1.84	0.70	10	100 YEAR	9.80	12.80	CROSS ROAD IN RCP STRUCTURE
2*	0.68	0.70	10	100 YEAR	9.80	4.70	CROSS ROAD IN RCP STRUCTURE
3*	0.68	0.70	10	100 YEAR	9.80	4.70	CROSS ROAD IN RCP STRUCTURE
4*	1.82	0.35	10	100 YEAR	9.80	6.24	DRAINS TO EXIST. TxDOT STORM SYSTEM

**NOTE: DRAINAGE AREA 1 SHOWN BASED UPON A COMBINATION OF TOPOGRAPHIC SURVEY DATA OBTAINED ON THE GROUND AND DRAINAGE AREA MAP PREPARED BY WER & ASSOCIATES FOR ROCKWALL TECHNOLOGY PARK, DATED 03-10-99.
*DRAINAGE AREAS 2 AND 3 ARE SHOWN BASED UPON DRAINAGE AREA MAP PREPARED BY WER & ASSOCIATES FOR ROCKWALL TECHNOLOGY PARK, DATED 03-10-99.
*DRAINAGE AREA 4A IS A PORTION OF DRAINAGE AREA D-1 AS SHOWN IN DRAINAGE AREA MAP PREPARED BY WER & ASSOCIATES FOR ROCKWALL TECHNOLOGY PARK, DATED 03-10-99.

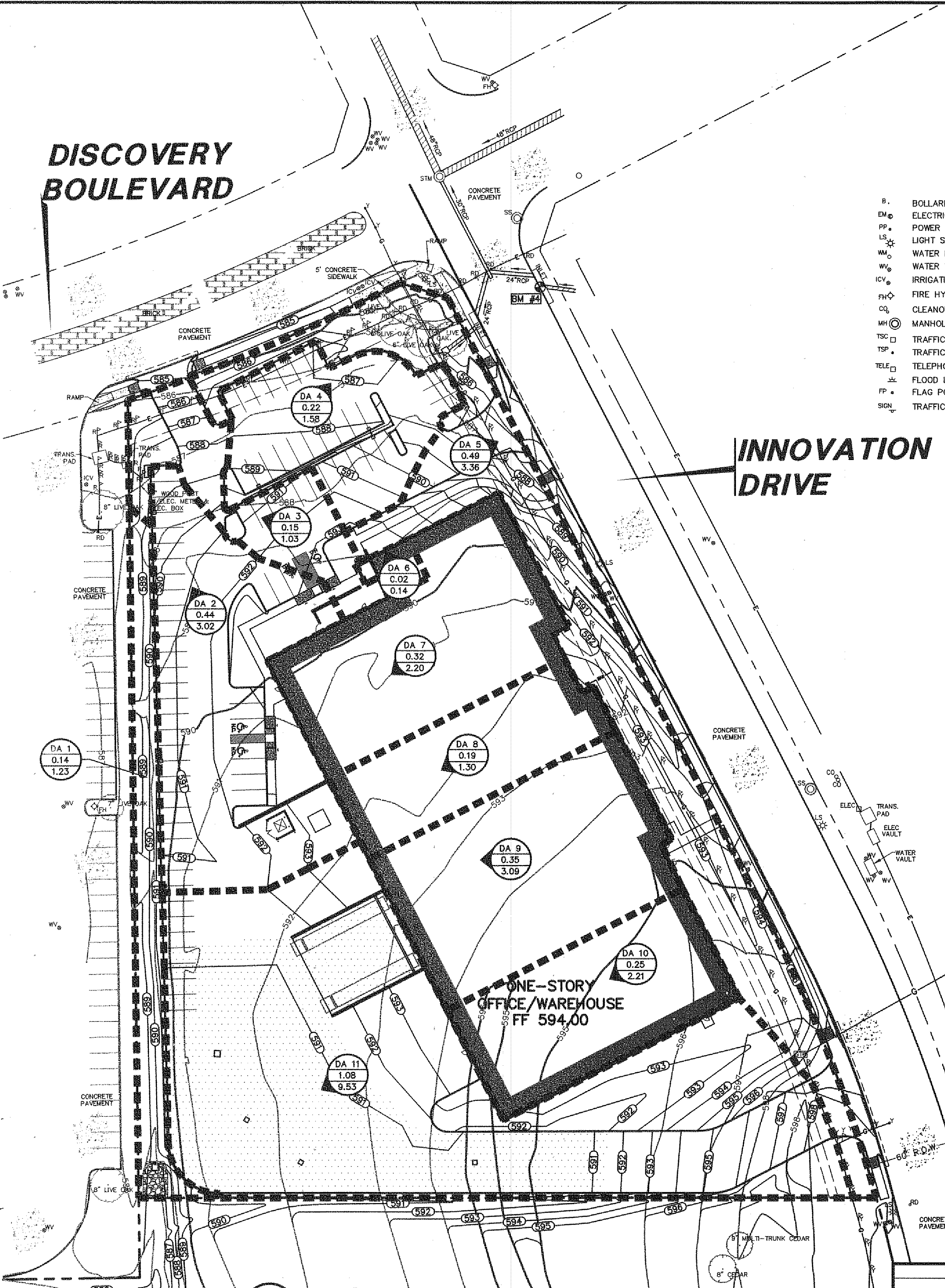

2 PROPOSED DA MAP

PROPOSED DRAINAGE CRITERIA:
Q=(C)(I)(A)

DRAINAGE AREA ID	AREA (acres)	C	Tc (minutes)	STORM FREQUENCY (100 YEAR)	I ₁₀₀ (inch/hour)	Q ₁₀₀ (cfs)	COMMENTS
1	0.14	0.90	10	100 YEAR	9.80	1.23	DRAINS TO ADJACENT PROPERTIES
2*	0.44	0.70	10	100 YEAR	9.80	3.02	DRAINS TO PROPOSED CURB INLET
3*	0.15	0.70	10	100 YEAR	9.80	1.03	DRAINS TO DISCOVERY BOULEVARD
4*	0.22	0.70	10	100 YEAR	9.80	1.51	DRAINS TO PROPOSED CURB INLET
5*	0.49	0.70	10	100 YEAR	9.80	3.36	DRAINS TO INNOVATION DRIVE
6*	0.02	0.70	10	100 YEAR	9.80	0.14	DRAINS TO NORTH ROOF DRAIN
7*	0.32	0.70	10	100 YEAR	9.80	2.20	DRAINS TO EAST ROOF DRAIN
8*	0.19	0.70	10	100 YEAR	9.80	1.30	DRAINS TO EAST ROOF DRAIN
9	0.35	0.90	10	100 YEAR	9.80	3.09	DRAINS TO EAST ROOF DRAIN, DETENTION
10	0.25	0.90	10	100 YEAR	9.80	2.21	DRAINS TO EAST ROOF DRAIN, DETENTION
11	1.08	0.90	10	100 YEAR	9.80	9.53	DRAINS TO PROPOSED DETENTION AREA

*NOTE: DRAINAGE AREAS 2 THRU 8 ARE SHOWN WITH A RUNOFF COEFFICIENT OF 0.70 PER THE DRAINAGE AREA MAP PREPARED BY WER & ASSOCIATES FOR ROCKWALL TECHNOLOGY PARK, DATED 03-10-99.

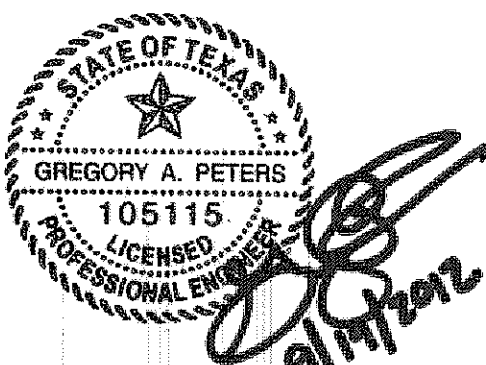

RECORD DRAWING
THIS DRAWING HAS BEEN REVISED TO REFLECT CONSTRUCTION RECORDS MAINTAINED AND PROVIDED BY THE CONTRACTOR FOR THIS PROJECT.
CONTRACTOR: HILL & WILKINSON
DATE REVISED: 08/30/2012

NO.	DATE	REVISION
1	8/30/2012	RECORD DRAWING

Pacheco Koch 8350 N. CENTRAL EXPWY, SUITE 1000 DALLAS, TX 75206 972.235.3031
DALLAS • FORT WORTH • HOUSTON TX REG. SURVEYING FIRM LS-100080-00

EXIST. AND PROP. DRAINAGE AREA MAP
HATFIELD & COMPANY, INC.
DISCOVERY BLVD. & INNOVATION ST.
ROCKWALL
CITY OF ROCKWALL, ROCKWALL COUNTY, TX

DESIGN	DRAWN	DATE	SCALE	NOTES	FILE	NO.
GAP	GAP	MARCH 2012	1"=40'			C4.1