

ROCKWALL ECONOMIC
DEVELOPMENT CORPORATION
VOLUME 3495, PAGE 314
D.R.R.C.T.

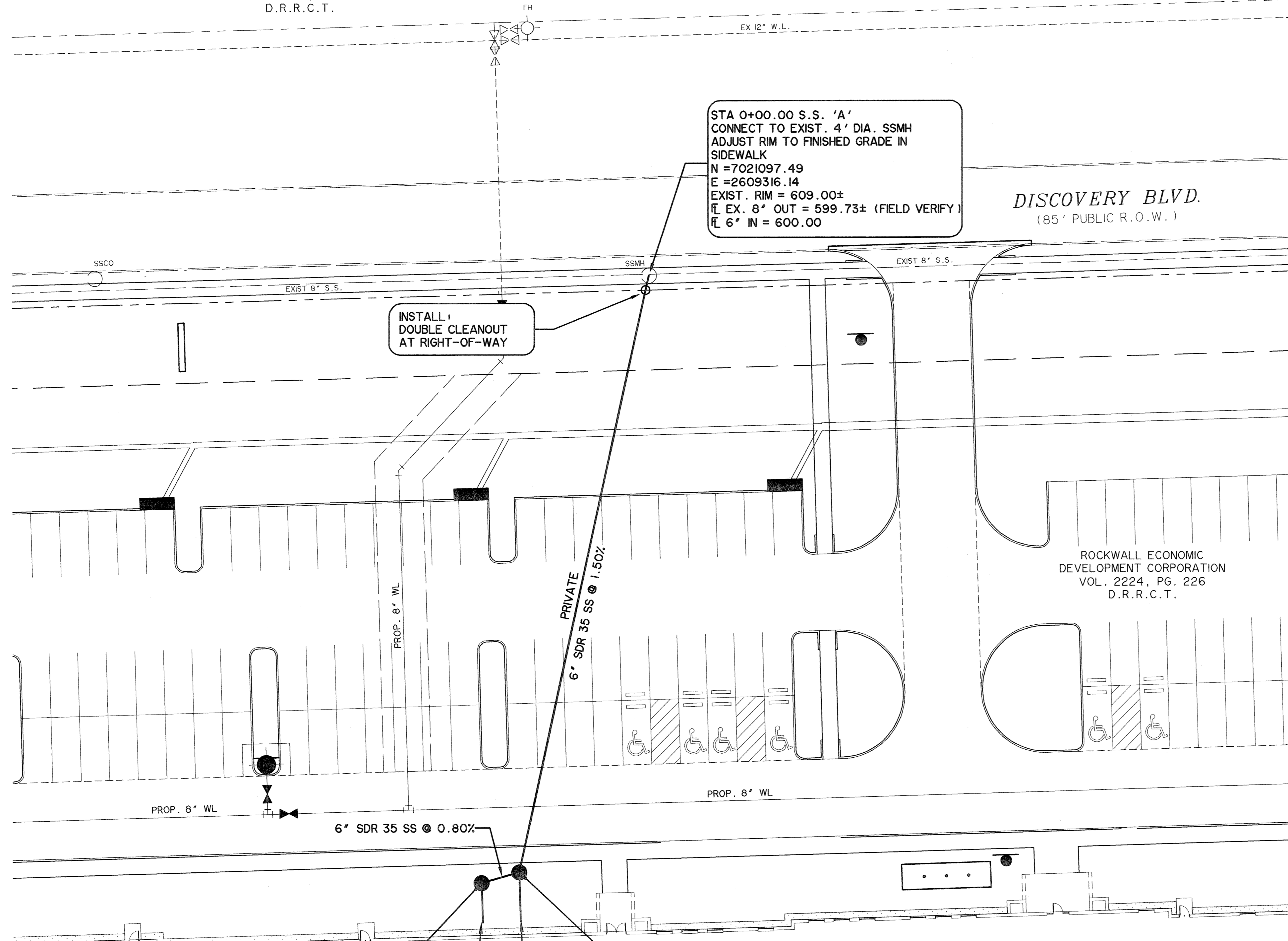

STA 0+00.00 S.S. 'A'
CONNECT TO EXIST. 4' DIA. SSMH
ADJUST RIM TO FINISHED GRADE IN
SIDEWALK
N = 7021097.49
E = 2609316.14
EXIST. RIM = 609.00±
ℓ EX. 8" OUT = 599.73± (FIELD VERIFY)
ℓ 6" IN = 600.00

DISCOVERY BLVD.
(85' PUBLIC R.O.W.)

INSTALL
DOUBLE CLEANOUT
AT RIGHT-OF-WAY

PRIVATE
6" SDR 35 SS @ 1.50%

ROCKWALL ECONOMIC
DEVELOPMENT CORPORATION
VOL. 2224, PG. 226
D.R.R.C.T.

STA 2+03.31 S.S. LINE 'A'
CONSTRUCT 4' DIA. SAMPLING SSMH
INSTALL:
10 LF 6" SDR 35 SS STUB SOUTH
N = 7020907.70
E = 2609263.14
PROP. RIM = 615.20±
ℓ 6" IN = 603.15
ℓ 6" OUT = 603.05

CONTRACTOR SHALL
COORDINATE FINAL
UTILITY LOCATIONS WITH
BUILDING PLANS

STA 1+90.94 S.S. LINE 'A'
CONSTRUCT STD. 4' DIA. SSMH
INSTALL:
15 LF 6" SDR 35 SS STUB SOUTH
N = 7020911.03
E = 2609275.05
PROP. RIM = 615.30±
ℓ 6" IN = 602.95
ℓ 6" OUT = 602.85

CAUTION !!
EXISTING UTILITIES ARE INDICATED ON THE PLANS FROM AVAILABLE INFORMATION. IT SHALL BE THE RESPONSIBILITY OF THE CONTRACTOR TO VERIFY THE LOCATION OF ALL UTILITIES, TO NOTIFY ALL UTILITY COMPANIES OF THE CONTRACTORS OPERATIONS, TO PROTECT ALL UTILITIES FROM DAMAGE, TO REPAIR ALL UTILITIES DAMAGED DUE TO THE CONTRACTORS OPERATIONS, AND TO NOTIFY THE ENGINEER PROMPTLY OF ALL CONFLICTS OF THE WORK WITH EXISTING UTILITIES.

- NOTES:
1. ALL CONNECTIONS TO EXISTING SANITARY SEWER MANHOLES WILL BE CONSTRUCTED ACCORDING TO DETAILS SHOWN ON U302.
 2. CONSTRUCT 10 L.F. OF CONCRETE ENCASEMENT WHERE S.S. STUB OUTS OR MAIN SEWER LINES CROSS OR COME WITHIN STORM DRAIN LINES OR WATER LINES WITH LESS THAN 9' OF SEPARATION.
 3. SEE MEP PLANS FOR CONNECTIONS TO BUILDING.

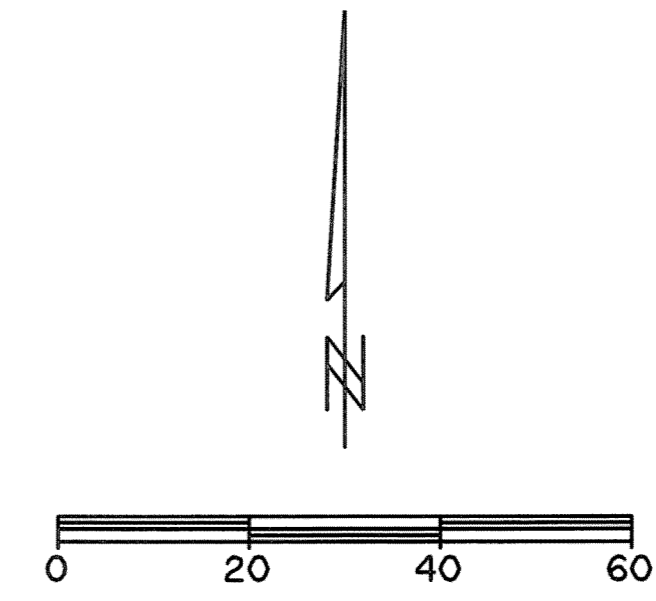

RECORD PLANS
03-04-13

*** BENCH MARKS ***

BM A
AN "X" CUT IN THE BACK OF CURB LOCATED AT THE SOUTH RIGHT-OF-WAY LINE OF SPRINGER ROAD ±2470' EAST OF THE INTERSECTION OF SPRINGER ROAD AND F.M. 549.
598.80 FT.

BM B
AN "X" CUT IN THE CENTERLINE OF WALK AT THE SOUTHEAST CORNER OF THE INTERSECTION OF DATA DRIVE AND DISCOVERY BLVD.
600.88 FT.



Turner

Construction Managers/General Contractors
460 West Dussel Drive
Maumee, Ohio 43537
p | 419.893.7000 f | 419.893.1741
www.turnerconstruction.com/lathrop

CONSULTANTS:
PREPARED BY:
WIA WIER & ASSOCIATES, INC.
ENGINEERS SURVEYORS LAND PLANNERS
701 HIGHLANDER BLVD., SUITE 300 ARLINGTON, TEXAS 76015 METRO (817)461-7700
6049 ELM STREET FRESNO, TEXAS 75024 METRO (214)387-9000
Texas Firm Registration No. F-2776 www.WierAssociates.com

SEAL ON THIS DOCUMENT AUTHORIZED BY:



SEAL ID:
DATE: 5/19/12

PROJECT INFORMATION:
**ROCKWALL
TECHNOLOGY PARK
PHASE III
BIMBO BAKERIES USA
ROCKWALL, TEXAS**

CLIENT INFORMATION:
ALLEN FOODS, INC
3055 Discovery Blvd.
Rockwall, Texas
75032

CLIENT PROJECT NO: 00-00000-00

NO.	DATE	REVISION OR SUBJECT
1	XX/XX/XX	REVISION NAME
	X	

PROJECT NO: WA # 12002
PROJECT MANAGER: RON RAMIREZ, P.E.
DESIGNED:
CHECKED: RON RAMIREZ, P.E.

DRAWING TITLE:
**SANITARY SEWER
LAYOUT**

DRAWING NO:
C-U201

FILE: U201-SEWER LAYOUT-12002.dwg
TIME: 14:46
DATE: 04-27-2012