

PLAN OF STEEL LAYOUT
Not To Scale

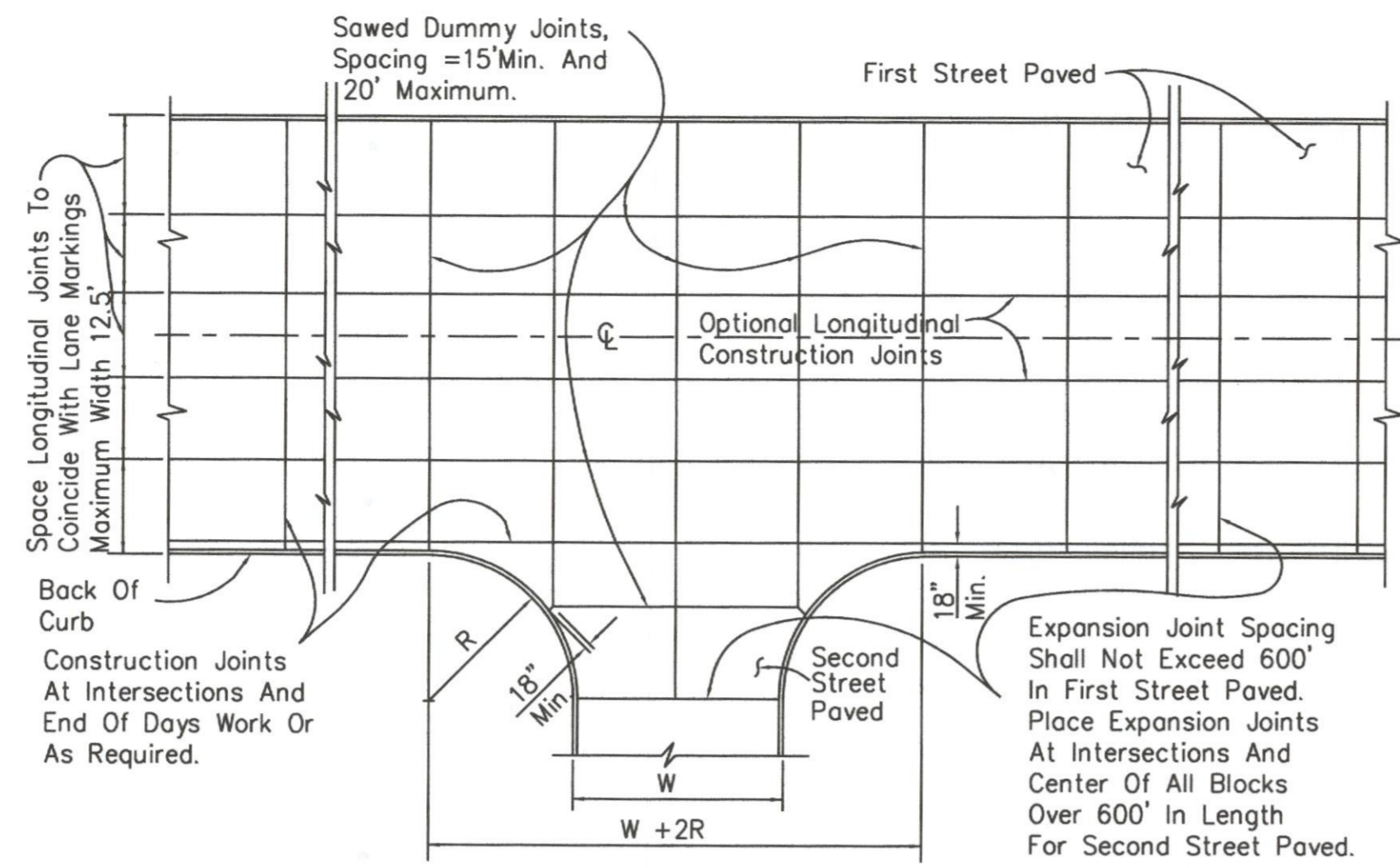

PLAN - JOINT SPACING
Not To Scale

All Fire lanes to be 6" min. - 3600 PSI

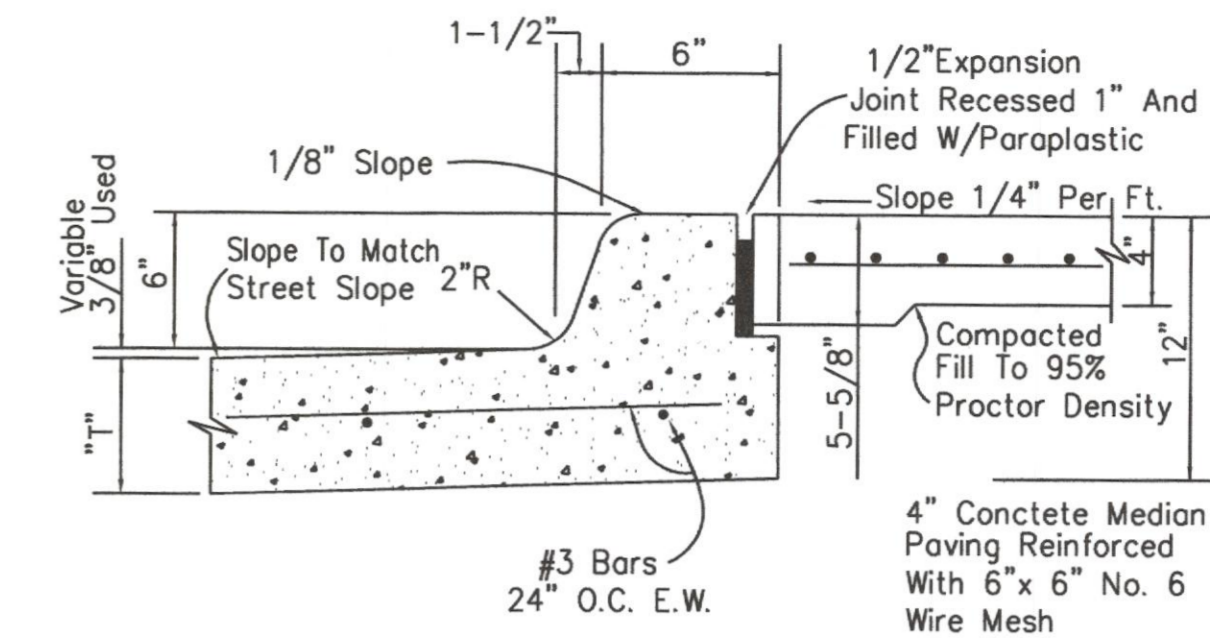

STANDARD MEDIAN CURB & GUTTER

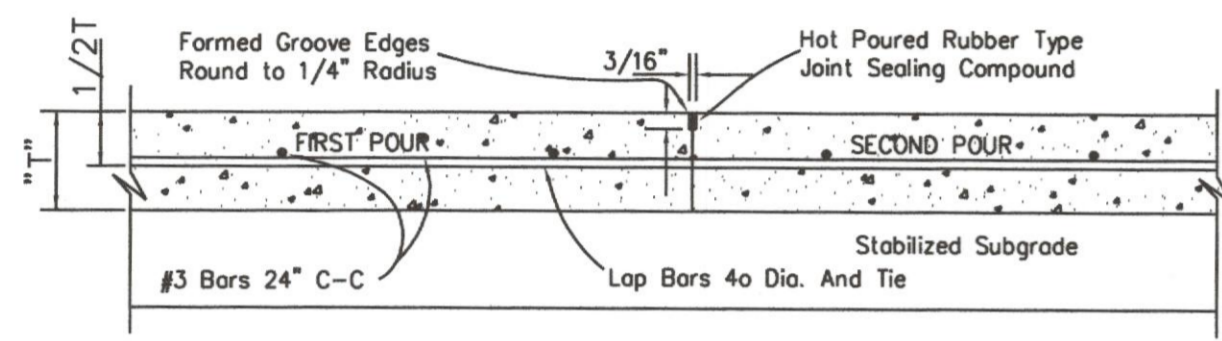

TRANSVERSE CONSTRUCTION JOINT
Not To Scale

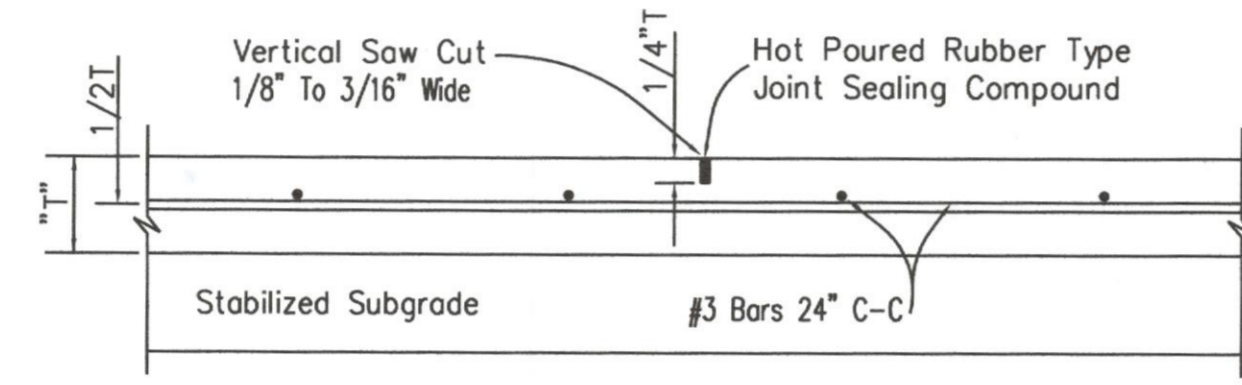

SAWED DUMMY JOINT
Not To Scale

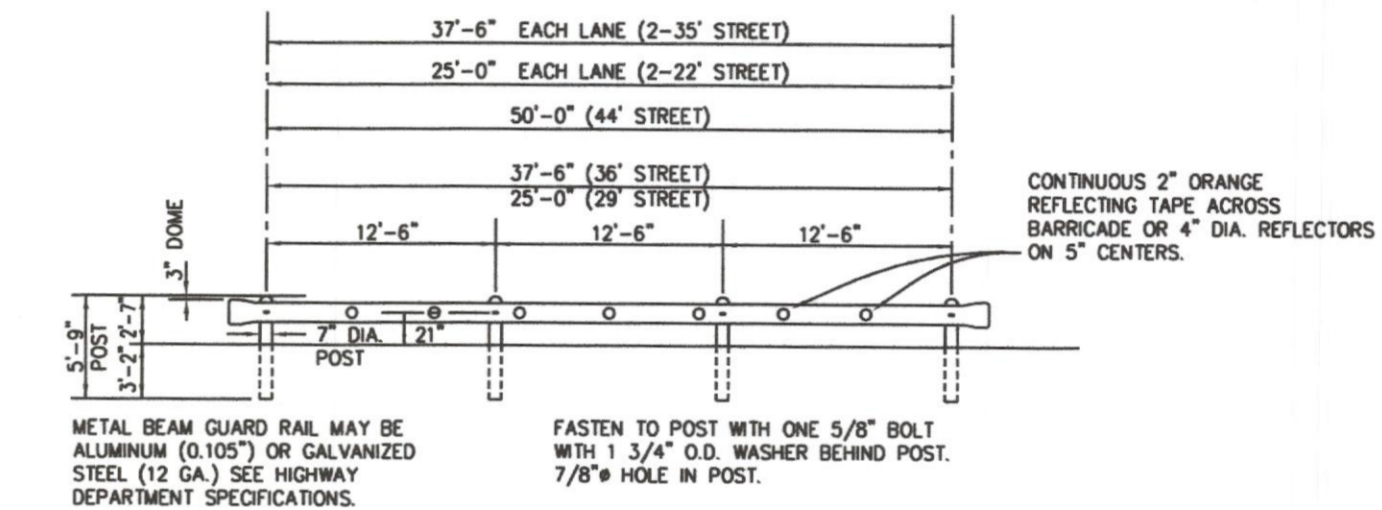

METAL BEAM GUARD RAIL MAY BE ALUMINUM (1035) OR GALVANIZED STEEL (12 GA.) SEE HIGHWAY DEPARTMENT SPECIFICATIONS.

FASTEN TO POST WITH ONE 5/8" BOLT WITH 1 3/4" O.D. WASHER BEHIND POST. 7/8" HOLE IN POST.

CONTINUOUS 2" ORANGE REFLECTING TAPE ACROSS BARRICADE OR 4" DIA. REFLECTORS ON 5' CENTERS.

NOTE
Dimension "T" Equals Pavement Thickness
Shown On Typical Pavement Sections

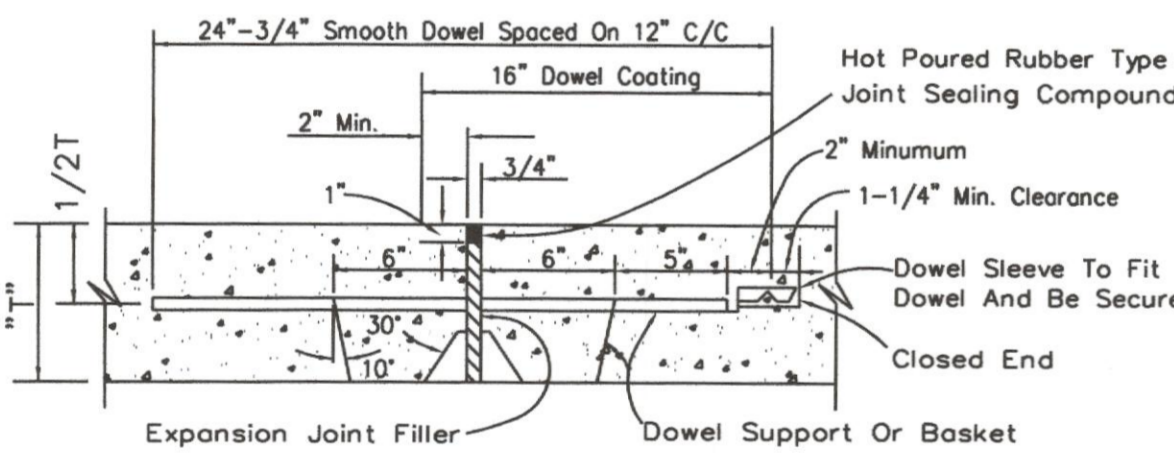

TRANSVERSE EXPANSION JOINT
Not To Scale

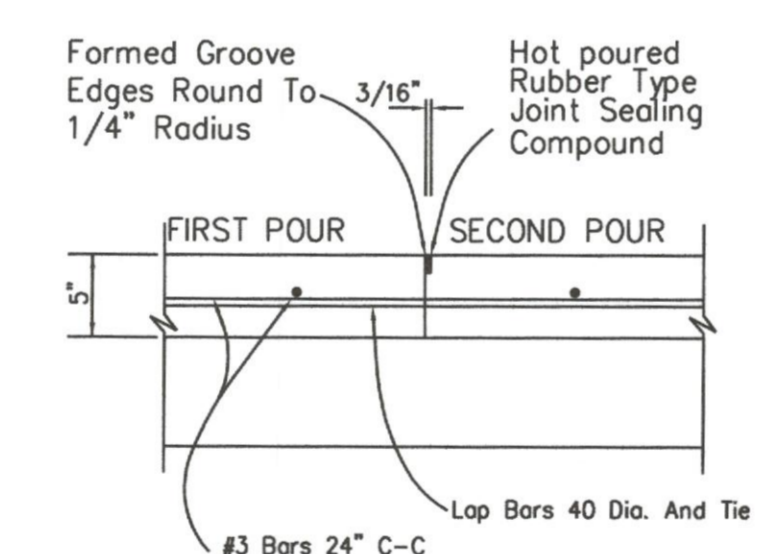

LONGITUDINAL CONSTRUCTION JOINT
Not To Scale

NOTE
*All Fire lanes to be 6" min. - 3600 PSI
Concrete 6 sack - machine finish
6 1/2 sack - hand finish
*No sand under pavement.
*Max. 1" sand under sidewalk.

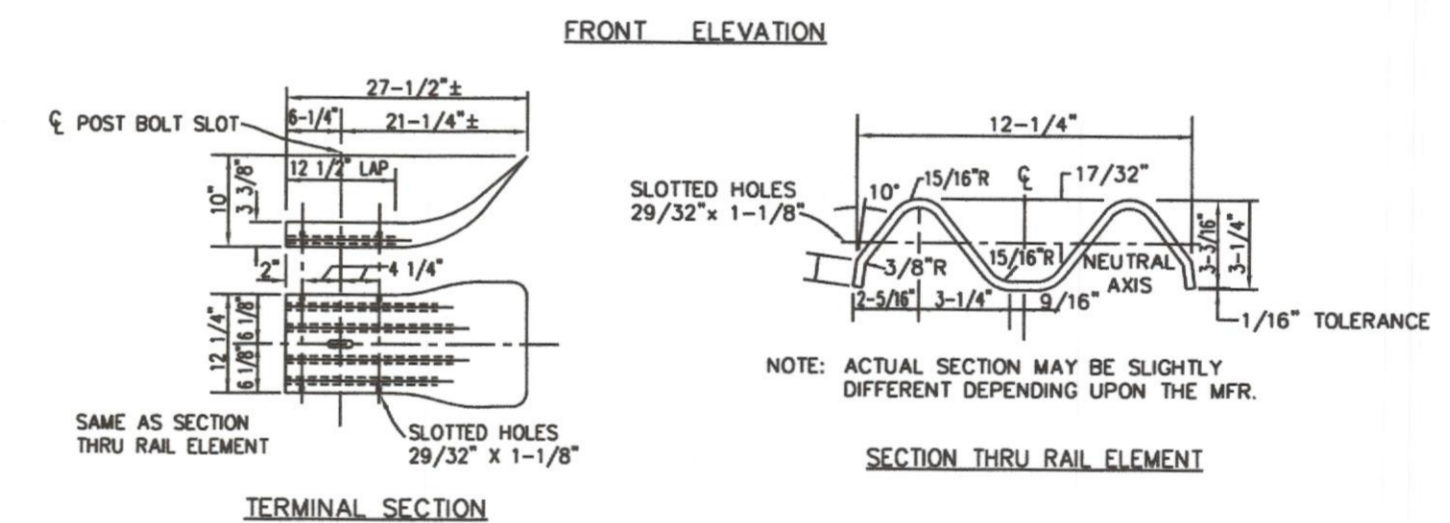

FRONT ELEVATION

TERMINAL SECTION

SECTION THRU RAIL ELEMENT

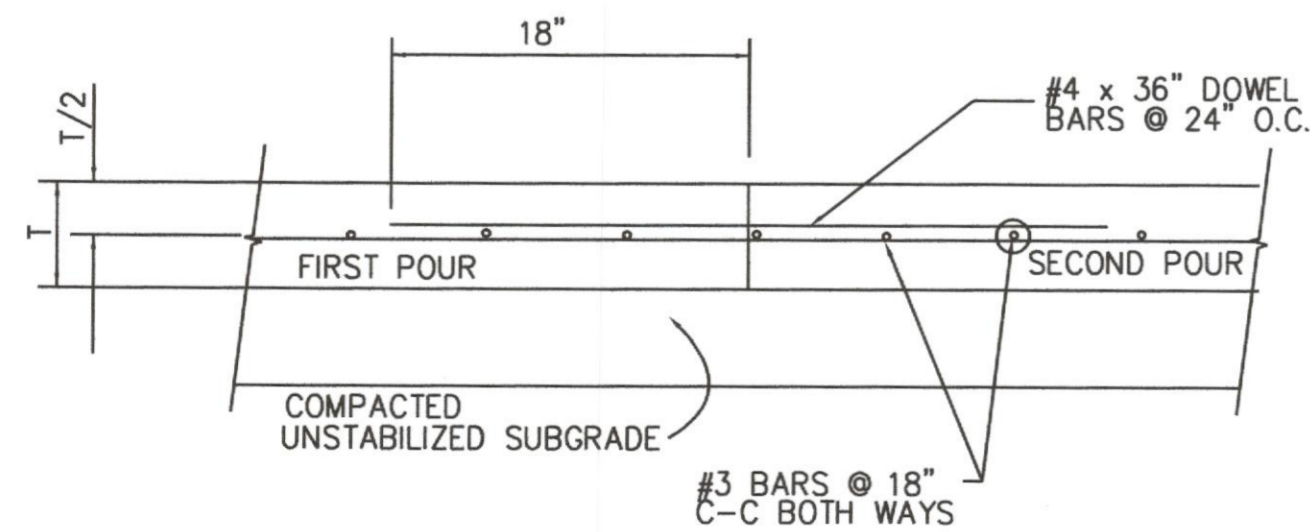

LONGITUDINAL CONSTRUCTION BUTT JOINT
NTS

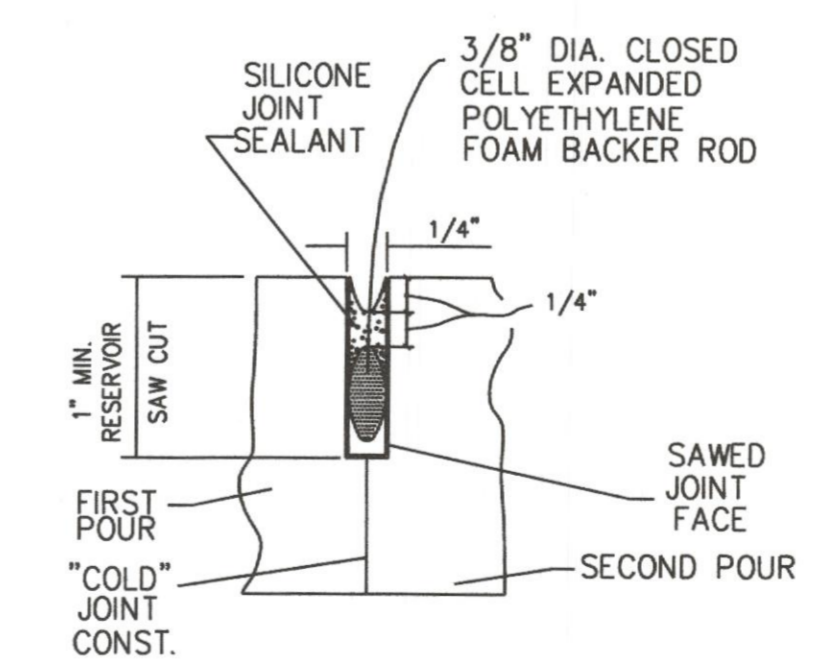

DRAWING NOTES:
1. SILICONE BEAD HAS GENERAL WIDTH TO DEPTH RATIO OF 2:1.
2. POLYETHYLENE FOAM BREAKER ROD DOES NOT SIT ON BOTTOM OF SAW-CUT JOINT.
(DETAIL "B")
SEAL FOR LONGITUDINAL AND TRANSVERSE BUTT JOINT
NTS

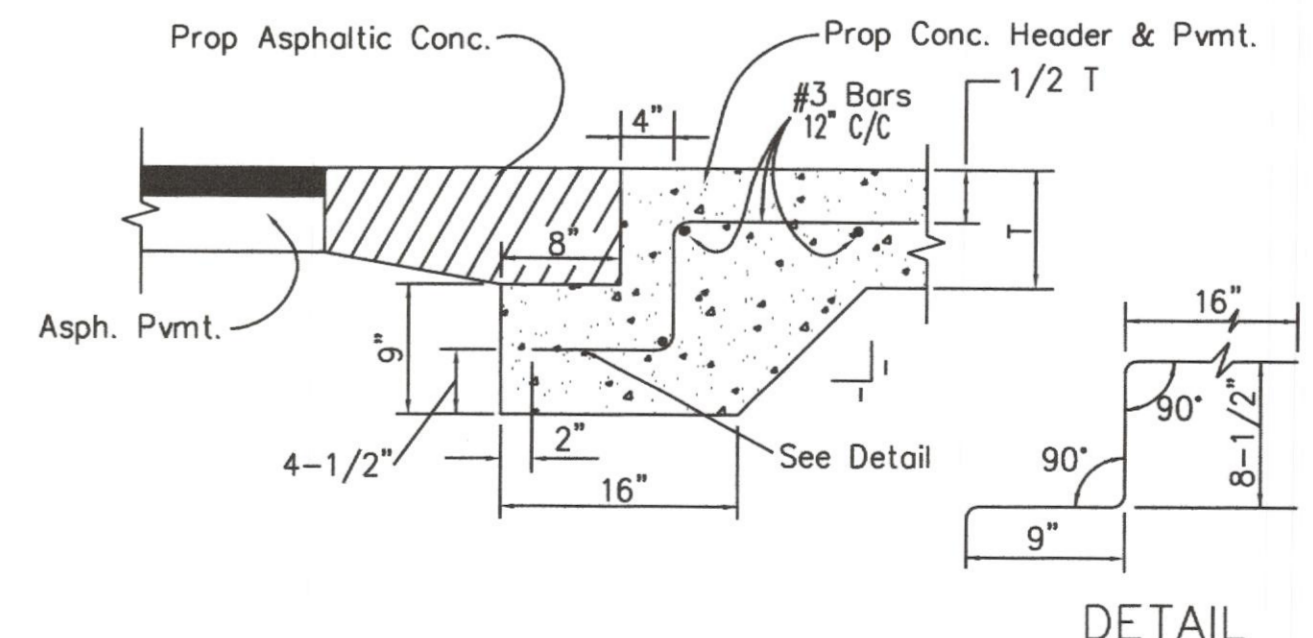

STREET HEADER
Not To Scale



THE SEAL APPEARING ON THIS DRAWING IS THE PROPERTY OF W.L. DOUPHRATE II, TEXAS P.E. NO. 60102 ON

DOUPHRATE & ASSOCIATES, INC.
ENGINEERING - PROJECT MANAGEMENT - SURVEYING
2235 RIDGE RD., # 200 ROCKWALL, TEXAS 76087
PHONE: (972)771-9004 FAX: (972)771-9005

PAVING DETAILS
PROPOSED CARRIER DRIVE
CITY OF ROCKWALL
COUNTY OF ROCKWALL

REVISION
W.L.D.
CHECKED
R.C.T.
DRAWN
04/2010
DATE
10004
PROJECT