

**LEGEND**

- LP LIGHT POLE
- SD STORM DRAIN
- BL BUILDING LINE
- FIR FOUND IRON ROD
- SIR SET IRON ROD
- PRRCT PLAT RECORDS ROCKWALL COUNTY, TEXAS

BASIS OF BEARINGS:  
THE NORTH LINE OF  
YELLOW JACKET LANE  
PER PLAT FILED IN  
CABINET B SLIDE 275-276  
PRRCT

- LINES:
1. N52°51'40"E 10.00'
  2. N37°08'20"W 15.00'
  3. N52°51'40"E 10.00'
  4. S52°51'40"W 10.00'
  5. S37°08'20"E 10.00'
  6. S52°51'40"E 10.00'
  7. S45°24'52"E 34.22'
  8. S45°24'52"E 24.92'
  9. N18°11'35"E 7.30'
  10. S37°08'23"W 7.62'
  11. S79°10'42"E 4.58'
  12. N79°10'42"W 4.39'
  13. N45°24'52"W 7.99'

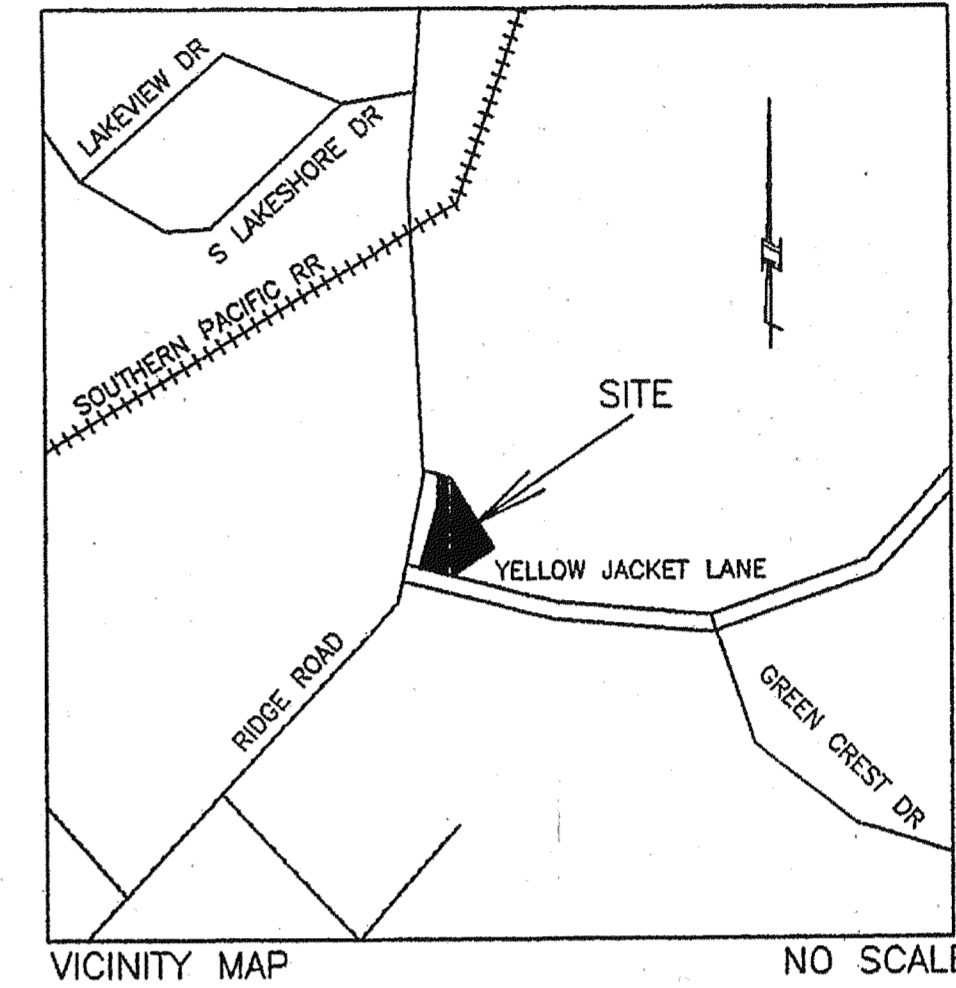

ROCKWALL INDEPENDENT SCHOOL DISTRICT  
TRACT III  
PART OF TRACT 2

- CURVES:
- C1. R= 44.00' L= 25.63' C= 25.56' CB= S62~17'27"E
  - C2. R= 74.00' L= 10.69' C= 10.68' CB= S41~16'37"E
  - C3. R= 50.00' L= 7.22' C= 7.22' CB= N41~16'37"W
  - C4. R= 20.00' L= 11.79' C= 11.62' CB= N62~17'47"W
  - C5. R= 20.00' L= 20.29' C= 19.44' CB= N08~04'14"W
  - C6. R= 20.00' L= 34.30' C= 30.25' CB= S86~16'37"E
  - C7. R= 44.00' L= 43.99' C= 42.18' CB= N07~38'34"W
  - C8. R= 20.00' L= 18.43' C= 17.78' CB= N18~48'45"W
  - C9. R= 20.00' L= 37.00' C= 31.95' CB= S28~01'31"W
  - C10 R= 44.00' L= 27.99' C= 27.52' CB= S62~48'33"W

NOTE: It shall be the policy of the City of Rockwall to withhold issuing building permits until all streets, water, sewer and storm drainage systems have been accepted by the City. The approval of a plat by the City does not constitute any representation, assurance or guarantee that any building within such plat shall be approved, authorized or permits therefore issued, nor shall such approval constitute any representation, assurance or guarantee by the City of the adequacy and availability for water for personal use and fire protection within such plat, as required under Ordinance 04-38.

Trees cannot be damaged during construction.

FILED FOR RECORDS  
ROCKWALL COUNTY, TEXAS  
SEP - 5 PM 2:51  
TAULETTE BURNS  
CO. CLERK  
DEPUTY

**YELLOW JACKET ADDITION**

SHEET 1

REVISED	FINAL PLAT	1.129 ACRES
06/29/2006		
07/05/2006	BEING A TRACT OF PARCEL OF LAND SITUATED IN THE	
07/20/2006	E. P. G. CHISUM SURVEY, ABSTRACT NO. 64	
	AND ALSO BEING IN THE CITY OF ROCKWALL, ROCKWALL COUNTY, TEXAS	
	LANE'S SOUTHWEST SURVEYING INC.	DATE: MAY 22, 2006
	2717 MOTLEY DR, SUITE B	SCALE 1" : 30'
	MESQUITE, TEXAS 75150 - 3812	
	Phone (972) 681-4442 Fax 681-4829	FILE No. RP-789

C:\W04325RP.DWG.....RAG

N 7018088.682  
E 2693527.121  
EL = 483.05'

**YELLOW JACKET LANE**  
( VARIABLE WIDTH PUBLIC ROW )

OWNERS:  
IN KYUNG HWAN  
JUNG OH SOON  
512 SUNSTONE DRIVE  
IRVING, TEXAS 75060  
(972) 259-2122

30' ACCESS, FIRELANE AND UTILITY  
EASEMENT VOL 01984 PG 60-70

- = 50.00'
- = 46.18'
- C = 44.56'
- CB = S 18°52'28" E

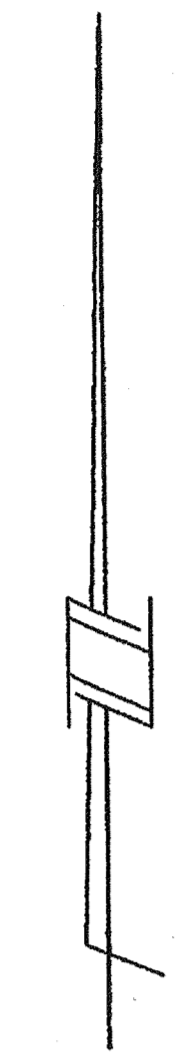

**F.M. 740 ( RIDGE ROAD )**  
( VARIABLE WIDTH PUBLIC ROW )

