

NAD-83 GEODETIC POSITION		NAD-83 TX STATE PLANE, NORTH CENTRAL ZONE	
LATITUDE	N 32° 53' 48.99664"	US SURVEY FT.	
LONGITUDE	N 96° 27' 38.61126"	NORTHING:	7015228.12285
ORTHOMETRIC HEIGHT:	154.2439	EASTING:	2589247.61172
		ELEVATION	NAVD 88: 506.0486
		CONVERGENCE:	+ 1" 06'11.22874"
		SCALE FACTOR:	0.999575247

NAD-83 GEODETIC POSITION		GRID		GEODETIC	
AZIMUTH #1 - P.O. W/T OMNI. ANT.	28° 15' 35"	N 32° 53' 48.99664"			
AZIMUTH #2 - IH30 W/T OMNI. ANT.	73° 31' 25"	N 96° 27' 38.61126"			

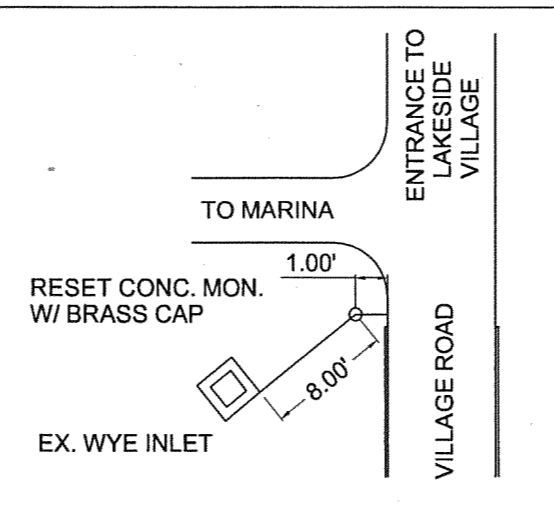

**GENERAL NOTES:**

- A GRADING PERMIT MUST BE OBTAINED FROM CITY OF ROCKWALL PRIOR TO COMMENCEMENT OF ANY CONSTRUCTION ACTIVITIES.
- EROSION CONTROL WILL BE REQUIRED DURING ALL PHASES OF CONSTRUCTION. EROSION CONTROL MEASURES PER CITY OF ROCKWALL, TEXAS STANDARD REQUIREMENTS.
- ALL UTILITIES (INCLUDING ELECTRICAL) WILL BE UNDERGROUND.
- IN FILL SECTIONS SUPPORTING PAVEMENTS, FLATWORK AND DISPLAY AREA, THE FILL AND SUBGRADE SHOULD BE COMPACTED TO A MINIMUM DENSITY OF NINETY-FIVE (95) PERCENT OF ASTM D-698 TO LIMIT SETTLEMENT. ANY CLAY FILL MATERIALS BELOW PAVEMENTS OR FLATWORK SHOULD NOT BE COMPACTED OVER ONE HUNDRED (100) PERCENT DENSITY. FILLS SHOULD BE COMPACTED IN MAXIMUM 9-INCH LOOSE FILL.
- SELECT FILL: THE MATERIAL USED AS SELECT FILL SHOULD BE LIME STABILIZE WITH A LIQUID LIMIT OF LESS THAN 40 AND A PLASTICITY INDEX BETWEEN 15 AND ABOVE. A MINIMUM OF 20 PERCENT OF THE SOIL SHOULD PASS THE NO. 200 SIEVE. THE MATERIAL SHOULD BE SPREAD IN LOOSE HORIZONTAL LIFTS, LESS THAN 9 INCHES THICK, AND BE UNIFORMLY COMPACTED TO A MINIMUM OF 95 PERCENT OF THE MAXIMUM STANDARD PROCTOR DENSITY BETWEEN -1 AND +3 PERCENTAGE POINTS OF ITS OPTIMUM MOISTURE CONTENT AS DETERMINED BY ASTM D-698. IT IS RECOMMENDED THE SELECT FILL PLACEMENT BEGIN IMMEDIATELY AFTER THE SUBGRADE HAS BEEN PREPARED.
- POSITIVE DRAINAGE MUST BE PROVIDED AWAY FROM THE STRUCTURE TO PREVENT THE PONDING OF WATER IN THE SELECT FILL.
- CARE MUST BE TAKEN THAT BACKFILL AGAINST THE EXTERIOR FACE OF GRADE BEAMS IS PROPERLY COMPACTED ON-SITE CLAY. THE SELECT FILL SHOULD NOT EXTEND OUTSIDE THE LIMITS OF THE STRUCTURE.
- ANY NEED TO LIME STABILIZE SUBGRADE UNDER PAVING OR WATER INJECT SUBGRADE BENEATH SELECT FILL WILL BE DETERMINED BY TESTING FOLLOWING SUBGRADE EXCAVATION.
- ALL LABORATORY TESTING TO BE AT OWNER'S EXPENSE. SEQUENCE TO BE DETERMINED BY G.C., OWNER AND OWNER'S ENGINEER.
- ALL FILL SHALL BE COMPACTED USING A SHEEP'S FOOT ROLLER.
- WALL TO BE INSPECTED DURING CONSTRUCTION AND AFTER BY DESIGN ENGINEER OR THEIR DESIGNATED REPRESENTATIVE. A LETTER IS REQUIRED BY DESIGN ENGINEER APPROVING WALL THAT IS SEALED AND SIGNED.

**SITE WORK GRADING PREPARATION**

- INCLUDE ALL DEMOLITION AS REQUIRED FOR CONSTRUCTION.
- SUBGRADE PREPARATION: SURFACE VEGETATION AND ANY FOREIGN MATERIALS SHOULD BE STRIPPED AND REMOVED PRIOR TO CONSTRUCTION OF THE BUILDING PAD AND PAVEMENTS. IT IS ESTIMATED THAT THIS MAY CONSIST OF STRIPPING BETWEEN 3 TO 6 INCHES OF EXISTING SOILS AT THE SITE.
- GOOD DRAINAGE SHOULD BE ESTABLISHED AT THE OUTSET OF CONSTRUCTION AND MAINTAINED TO PREVENT WATER FROM PONDING IN THE BUILDING AND PAVING AREAS.
- WASTE CUT ON UNUSED PORTION OF LOT. LEAVE SMOOTH IN MOWABLE CONDITION.
- CUT PAD AS REQUIRED FOR 4' OF SELECT FILL. CUT MATERIAL TO BE USED AS FILL AS NEEDED IN PAVING OR DISPLAY AREAS.
- THE EXPOSED SUBGRADE SHOULD BE SCARIFIED TO A MINIMUM DEPTH OF SIX INCHES. THE MOISTURE ADJUSTED, AND RECOMPACTED TO NOT LESS THAN 95 PERCENT OF THE MAXIMUM DRY DENSITY AS OBTAINABLE IN THE STANDARD COMPACTION PROCEDURE (ASTM D-698), IN A MOISTURE RANGE OF OPTIMUM TO +3% ABOVE THE SOIL'S OPTIMUM MOISTURE CONTENT.

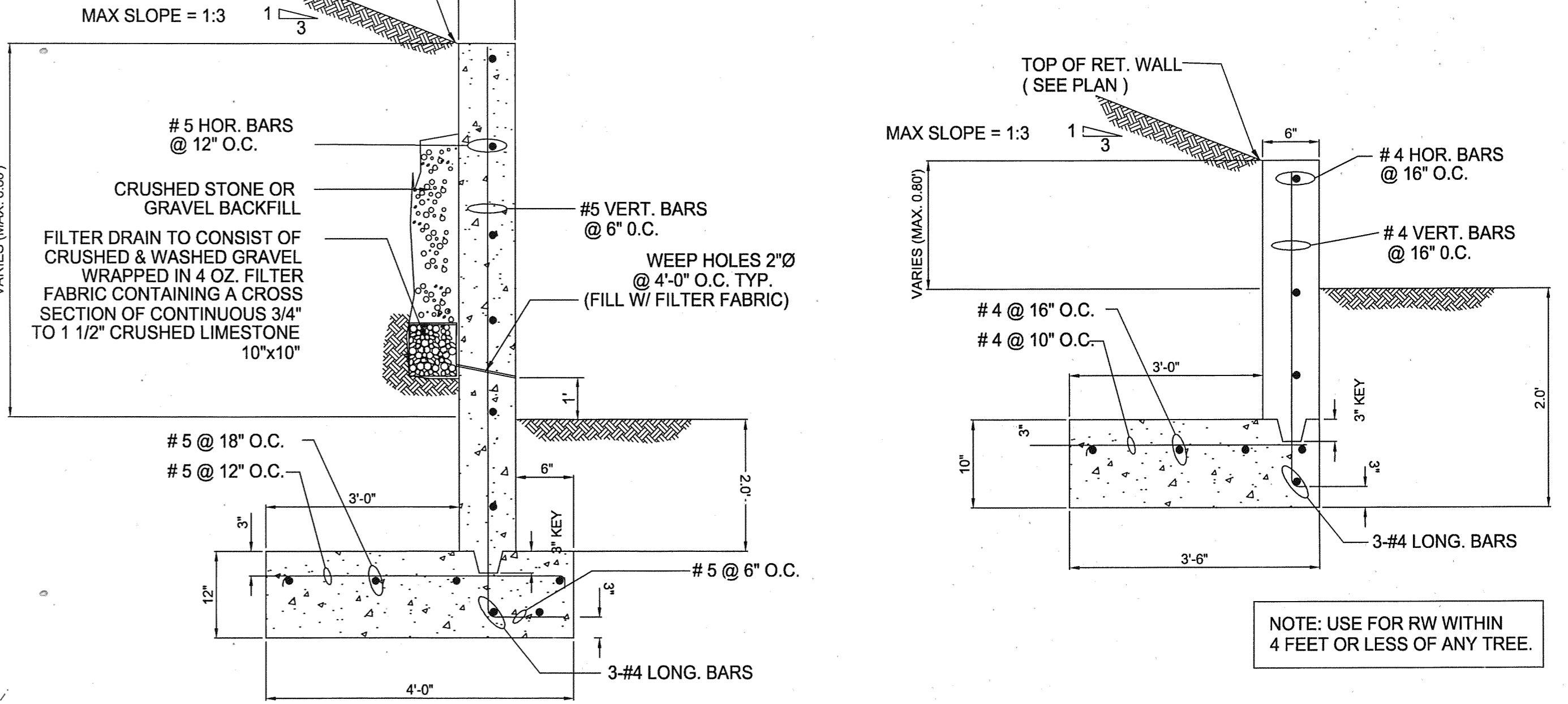

**02 RW-1 SECTION**  
SCALE: NONE

NOTE: NO WALL IN R.O.W. OR EASEMENTS (INCLUDING FOOTINGS)

**03 RW-2 SECTION**  
SCALE: NONE

NOTE: USE FOR RW WITHIN 4 FEET OR LESS OF ANY TREE.

LEGEND	
SANITARY SEWER MANHOLE	SS (circle with cross)
STORM SEWER MANHOLE	SM (circle with cross)
CLEAN OUT	CO (circle with cross)
FIRE HYDRANT	FH (circle with cross)
POWER POLE	PP (circle with cross)
TELEPHONE BOX	TB (circle with cross)
WATER METER	WM (circle with cross)
GATE VALVE	GV (circle with cross)
LIGHT POLE	LP (circle with cross)
IRRIGATION SPRINKLER HEAD LOCATION	IS (circle with cross)
VAN ACCESSIBLE HANDICAP PARKING	VAP (circle with cross)
SIGN LOCATION	SL (circle with cross)
RIGHT OF WAY	R.O.W. (dashed line)
SET IRON ROD	S.I.R. (circle with cross)
EXPANSION JOINT	E.J. (circle with cross)
SAW JOINT	S.J. (circle with cross)
CONSTRUCTION JOINT	C.J. (circle with cross)
EXIST. LIGHTPOLE	EL (circle with cross)
DRAINAGE & UTILITY EASEMENT	DEUE (dashed line)
DRAINAGE FLOW ARROW	DF (arrow)
TRAFFIC FLOW ARROW	TF (arrow)
FOUND IRON ROD	F.I.R. (circle with cross)
GAS METER	GM (circle with cross)
EXIST. WATER VALVE	WV (circle with cross)
EXISTING CONTOURS	(dashed line)
PROPOSED CONTOURS	(solid line)
PROPOSED SANITARY SEWER PIPE	(dashed line)
EXISTING SANITARY SEWER PIPE	(solid line)
PROPOSED WATER LINE	(dashed line)
EXISTING WATER LINE	(solid line)
PROPOSED POWER LINE	(dashed line)
EXISTING POWER LINE	(solid line)
PROPOSED TELEPHONE LINE	(dashed line)
EXISTING TELEPHONE LINE	(solid line)
PROPOSED GAS LINE	(dashed line)
EXISTING GAS LINE	(solid line)
PROPOSED STORM SEWER PIPE	(dashed line)
EXISTING STORM SEWER PIPE	(solid line)
PROPOSED GUY WIRE	(dashed line)
EXISTING GUY WIRE	(solid line)
OVERHEAD ELECTRICAL LINE	(dashed line)
EXISTING FIBER OPTICS CABLE	(solid line)

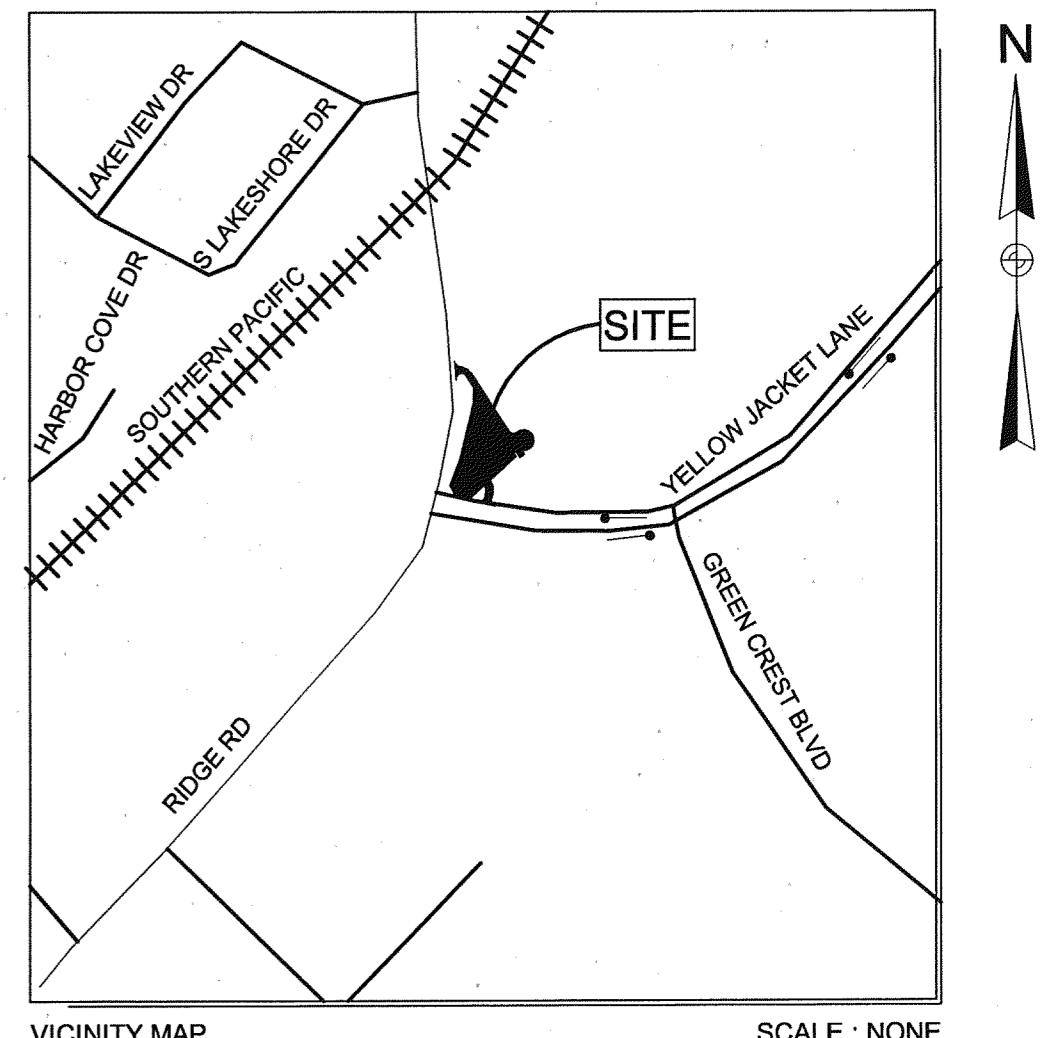

VICINITY MAP SCALE: NONE

**"AS-BUILT DRAWING"**

**AS - BUILT DRAWINGS.**  
TO THE BEST OF MY KNOWLEDGE, THIS PLAN IS AS - BUILT, AND THE INFORMATION IS BASED ON SURVEYING CONDUCTED AT THE SITE AND INFORMATION PROVIDED BY THE CONTRACTOR.

BILLY W. HUDSON

**OWNER/DEVELOPER:**  
IN KYUNG HWAN / CHUNG OH SOON  
512 SUNSTONE DRIVE,  
IRVING, TEXAS 75060

**CONTACT PERSON:**  
CECIL UNRUH 972-771-3862  
ERIC CHUNG 214-718-4900

**BW HUDSON**  
ENGINEERS AND ASSOCIATES  
BUILDING DESIGN-RENDERING  
BLUE PRINTING-SCANNING  
SCALE MODELS-ANIMATIONS

132 E. Main Street, Suite 200  
Grand Prairie, Texas 75050  
www.bwhudsonengineers.com  
Bhudson911@aol.com

Tel. No.: (972) 264-4408  
Fax No.: (972) 264-4416

MARCH 04, 2008

**OWNERSHIP AND USE OF DRAWINGS**  
THESE DRAWINGS WHETHER PRINTED OR ELECTRONIC IN FORM, PREPARED BY THE ENGINEER/BW HUDSON ENGINEERS AND ASSOCIATES, ARE INSTRUMENTS OF SERVICE THROUGH WHICH THE CONTRACTOR SHALL EXECUTE THE WORK DESCRIBED HEREIN. ONLY THE ENGINEER SHALL OWN, CLAIM AUTHORSHIP, CLAIM COPYRIGHT OR RETAIN ANY OTHER RESERVED RIGHTS ON THESE DRAWINGS. UNLESS OTHERWISE AGREED TO OR PERMITTED IN WRITING BY THE ENGINEER, THESE DRAWINGS SHALL NOT BE COPIED, REVISED OR TRANSMITTED TO ANY THIRD PARTY.

THESE DRAWINGS SHALL BE USED SOLELY FOR THIS PROJECT. THE CONTRACTOR, SUBCONTRACTOR, MATERIAL OR EQUIPMENT SUPPLIER ARE PERMITTED TO USE OR REPRODUCE PORTION(S) OF THE DRAWINGS RELATIVE TO THEIR PERFORMANCE CONTRACT AS SPECIFIED IN THE CONTRACT DOCUMENTS.

THESE DRAWINGS SHALL NOT BE USED BY THE CONTRACTOR, SUBCONTRACTOR, MATERIAL OR EQUIPMENT SUPPLIER ON OTHER PROJECTS OR ON ADDITIONS TO THIS PROJECT OUTSIDE THE ORIGINAL SCOPE OF WORKS WITHOUT THE SPECIFIC WRITTEN CONSENT OF THE ENGINEER.

OFFICIAL SUBMISSION OF THESE PLANS TO REGULATORY AGENCIES SHALL ONLY MEAN COMPLIANCE TO REGULATORY REQUIREMENTS AND SHALL NOT BE CONSTRUED AS PUBLICATION OR LOSS OF ENGINEER'S COPYRIGHTS OR OTHER RESERVED RIGHTS.

**PROJECT STATUS:**  
AS-BUILT DRAWING

**PROJECT MANAGER:**  
BILLY W. HUDSON

**DESIGN COORDINATOR:**  
DANTE ABAYON

**DATE:**  
03/04/08

**DRAWING DONE BY:**  
LEMUEL B. QUISTO

**ENGINEER'S SEAL**  
THE SEAL APPEARING ON THIS DOCUMENT WAS AUTHORIZED BY BILLY W. HUDSON, P.E. 38421 ON THE DATE INDICATED HEREIN. ALTERATION OF A SEALED DOCUMENT WITHOUT PROPER NOTIFICATION TO THE RESPONSIBLE ENGINEER IS AN OFFENSE UNDER THE TEXAS ENGINEERING ACT.

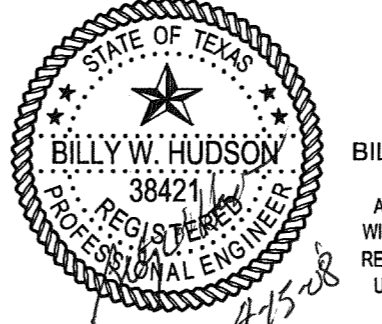

**01 GRADING AND DRAINAGE PLAN**  
SCALE: 1" = 30'-0"

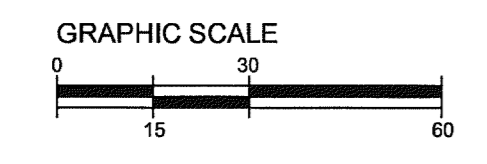

**GRADING AND DRAINAGE PLAN**  
**YELLOW JACKET CROSSING**  
INTERSECTION OF YELLOW JACKET LANE and FM 740 (Ridge Road)  
CITY OF ROCKWALL, TEXAS 75087  
LOT 1, BLOCK A  
1.129 AC