

02 SANITARY SEWER PROFILE
 HOR. SCALE: 1" = 30'-0"
 VER. SCALE: 1" = 3'-0"

- GENERAL NOTES:**
- ALL CONSTRUCTION SHALL CONFORM TO THE REQUIREMENTS OF THE STANDARD SPECIFICATIONS OF THE CITY OF ROCKWALL, TEXAS.
 - CONTRACTOR SHALL PROVIDE "AS BUILT" PLANS TO THE ENGINEER SO THAT THE REPRODUCIBLES OF THE ENGINEERING PLANS MAY BE CORRECTED TO REFLECT "AS BUILT" CONDITIONS.
 - THE CONTRACTOR SHALL BE REQUIRED TO PROVIDE AND MAINTAIN ALL NECESSARY WARNING AND SAFETY DEVICES (FLASHING LIGHTS, BARRICADES, SIGNS, ETC.) TO PROTECT THE PUBLIC SAFETY AND HEALTH UNTIL THE WORK HAS BEEN COMPLETED AND ACCEPTED BY THE CITY.
 - THE LOCATIONS OF EXISTING UTILITIES SHOWN ON THESE PLANS ARE APPROXIMATE. IT IS THE RESPONSIBILITY OF THE CONTRACTOR TO LOCATE AND VERIFY IN THE FIELD ANY UTILITIES THAT MAY CONFLICT WITH THIS CONSTRUCTION. AT LEAST 24 HOURS PRIOR TO BEGINNING CONSTRUCTION IN THE VICINITY OF UNDERGROUND UTILITIES, NOTIFY THE FOLLOWING APPLICABLE:
 - LONE STAR GAS
 - SOUTHWESTERN BELL TEL.
 - TEXAS UTIL. ELECT.
 - TEXAS CALL ONE
 - USE NTCOG AND CITY OF ROCKWALL'S STANDARDS AND DETAILS.
 - ALL UTILITIES (INCLUDING ELECTRICAL) WILL BE UNDERGROUND.
 - PRIOR TO BUILDING PERMIT APPLICATION FIRE FLOW DATA SHALL BE REQUESTED FROM THE DEPARTMENT TO CONFIRM ACTUAL FIRE FLOW FROM HYDRANTS.
 - MARK OLD COUNTRY ROAD AS FIRE LANE "NO PARKING FIRELANE" EVERY 25' WHITE 4" LETTERS ON A 6" RED STRIPED BACKGROUND.
- WASTE WATER UTILITY NOTES:**
- AT LEAST FORTY-EIGHT (48) HOURS BEFORE BEGINNING ANY WASTEWATER CONSTRUCTION IN PUBLIC R.O.W. OR PUBLIC EASEMENT, THE CONTRACTOR SHALL NOTIFY THE CITY OF ROCKWALL FOR MAIN LINE CONSTRUCTION, OR WATER AND WASTEWATER UTILITY TAPS ONLY CONSTRUCTION.
 - IN ADVANCE OF CONSTRUCTION, THE CONTRACTOR SHALL VERIFY THE LOCATIONS OF ALL UTILITIES TO BE EXTENDED, TIED TO, OR ALTERED, OR SUBJECT TO DAMAGE/INCONVENIENCE BY MAINTENANCE RESPONSIBILITY END AT R.O.W./EASEMENT LINES.
 - NO OTHER UTILITY SERVICE/APURTENANCES SHALL BE PLACED NEAR THE PROPERTY LINE, OR OTHER ASSIGNED LOCATION DESIGNATED FOR WASTEWATER UTILITY SERVICE THAT WOULD INTERFERE WITH THE WASTEWATER SERVICES.
 - FOR PRESSURE TAPS, FURNISH, INSTALL AND AIR TEST THE SLEEVE AND VALVE. CONCRETE BLOCKING SHALL BE PLACED BEHIND AND UNDER ALL TAP SLEEVES TWENTY-FOUR (24) HOURS PRIOR TO MAKING THE WET TAP.
 - ALL WASTEWATER PIPE SHALL BE SDR 35 PVC, OR PRESSURE RATED PIPE WERE REQUIRED IF IT IS INSTALL OVER 10' DEEP.
 - CITY MAINTENANCE ENDS AT THE PROPERTY LINE.
 - EXTEND ALL EXISTING UTILITY MANHOLES, BOXES, COVERS, TO PROPOSED FINISH GRADE, UNLESS APPROVED OTHERWISE.
 - ALL WATER LINES SHALL BE CLASS 200
 - ALL FIRE HYDRANTS SHALL HAVE 5' CLEARANCE AROUND.
 - BLUE EMS DISK SHALL BE INSTALLED ON THE WATER LINE AT EVERY CHANGE IN DIRECTION, VALVE, AND SERVICE.
 - ALL EXISTING FIRE HYDRANTS, VALVES, MANHOLES, AND OTHER UTILITIES WILL BE ADJUSTED BY CONTRACTOR, IF NEEDED, AND MUST BE APPROVED BY THE CITY ENGINEER PRIOR TO START OF WORK.

NAD-83 GEODETIC POSITION LATITUDE: N 32° 53' 48.99664" LONGITUDE: N 96° 27' 38.61126" ORTHOMETRIC HEIGHT: 154.2439		NAD-83 TX STATE PLANE, NORTH CENTRAL ZONE US SURVEY FT. NORTHING: 7015228.12285 EASTING: 2589247.61172 ELEVATION NAVD 88: 506.0486 CONVERGENCE: + 1° 06'11.22874" SCALE FACTOR: 0.999575247	
NAD-83 GEODETIC POSITION AZIMUTH #1 - P.O. W/IT OMNI. ANT: 28° 15' 35" AZIMUTH #2 - IH30 W/IT OMNI. ANT: 73° 31' 25"		GRID GEODETIC N 32° 53' 48.99664" N 96° 27' 38.61126"	

LEGEND	
SANITARY SEWER MANHOLE	SS (circle with cross)
STORM SEWER MANHOLE	SMH (circle with cross)
CLEAN OUT	CO (circle with cross)
FIRE HYDRANT	PH (circle with cross)
POWER POLE	PP (circle with cross)
TELEPHONE BOX	TB (circle with cross)
WATER METER	WM (circle with cross)
GATE VALVE	GV (circle with cross)
LIGHT POLE	LP (circle with cross)
IRRIGATION SPRINKLER HEAD LOCATION	IS (circle with cross)
VAN ACCESSIBLE HANDICAP PARKING	VA (circle with cross)
SIGN LOCATION	SL (circle with cross)
RIGHT OF WAY	R.O.W. (dashed line)
SET IRON ROD	S.I.R. (circle with cross)
EXPANSION JOINT	E.J. (circle with cross)
SAW JOINT	S.J. (circle with cross)
CONSTRUCTION JOINT	C.J. (circle with cross)
EXIST. LIGHTPOLE	ELP (circle with cross)
DRAINAGE & UTILITY EASEMENT	DEUE (dashed line)
DRAINAGE FLOW ARROW	DF (arrow)
TRAFFIC FLOW ARROW	TF (arrow)
FOUND IRON ROD	F.I.R. (circle with cross)
GAS METER	GM (circle with cross)
EXIST. WATER VALVE	EWV (circle with cross)
EXISTING CONTOURS	EC (dashed line)
PROPOSED CONTOURS	PC (dashed line)
PROPOSED SANITARY SEWER PIPE	SS (dashed line)
EXISTING SANITARY SEWER PIPE	ES (dashed line)
PROPOSED WATER LINE	WL (dashed line)
EXISTING WATER LINE	EWL (dashed line)
PROPOSED POWER LINE	PL (dashed line)
EXISTING POWER LINE	EPL (dashed line)
PROPOSED TELEPHONE LINE	TL (dashed line)
EXISTING TELEPHONE LINE	ETL (dashed line)
PROPOSED GAS LINE	GL (dashed line)
EXISTING GAS LINE	EGL (dashed line)
PROPOSED STORM SEWER PIPE	STSP (dashed line)
EXISTING STORM SEWER PIPE	ESTSP (dashed line)
PROPOSED GUY WIRE	GW (dashed line)
EXISTING GUY WIRE	EGW (dashed line)
OVERHEAD ELECTRICAL LINE	OEL (dashed line)
EXISTING FIBER OPTICS CABLE	FOC (dashed line)

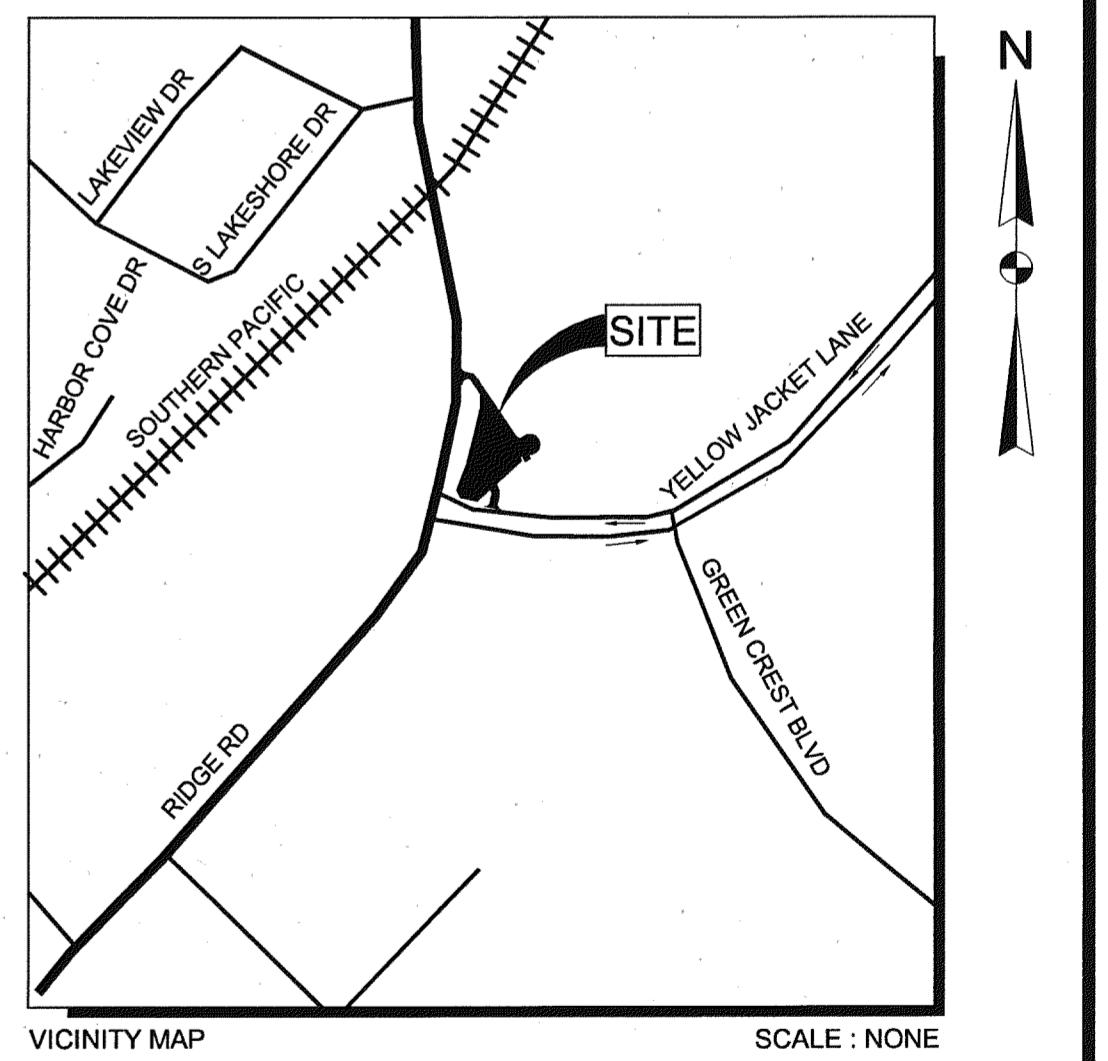

01 UTILITY PLAN
 SCALE: 1" = 30'-0"

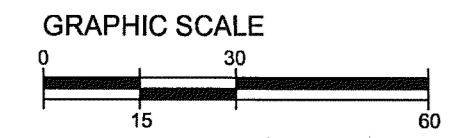

"AS-BUILT DRAWING"

AS - BUILT DRAWINGS.
 TO THE BEST OF MY KNOWLEDGE, THIS PLAN IS AS - BUILT, AND THE INFORMATION IS BASED ON SURVEYING CONDUCTED AT THE SITE AND INFORMATION PROVIDED BY THE CONTRACTOR.

BILLY W. HUDSON

OWNER/DEVELOPER:
 IN KYUNG HWAN / CHUNG OH SOON
 512 SUNSTONE DRIVE,
 IRVING, TEXAS 75060

CONTACT PERSON:
 CECIL UNRUH 972-771-3862
 ERIC CHUNG 214-718-4900

BW HUDSON
 ENGINEERS AND ASSOCIATES
 BUILDING DESIGN-RENDERING
 BLUE PRINTING-SCANNING
 SCALE MODELS-ANIMATIONS

132 E. Main Street, Suite 200
 Grand Prairie, Texas 75050
 www.bwhudsonengineers.com
 BHUDSON911@aol.com

MARCH 04, 2008

Tel. No. : (972) 264-4408
 Fax No. : (972) 264-4416

OWNERSHIP AND USE OF DRAWINGS
 THESE DRAWINGS WHETHER PRINTED OR ELECTRONIC IN FORM, PREPARED BY THE ENGINEER/BW HUDSON ENGINEERS AND ASSOCIATES, ARE INSTRUMENTS OF SERVICE THROUGH WHICH THE CONTRACTOR SHALL EXECUTE THE WORK DESCRIBED HEREIN. ONLY THE ENGINEER SHALL OWN, CLAIM AUTHORSHIP, CLAIM COPYRIGHT OR RETAIN ANY OTHER RESERVED RIGHTS ON THESE DRAWINGS. UNLESS OTHERWISE AGREED TO OR PERMITTED IN WRITING BY THE ENGINEER, THESE DRAWINGS SHALL NOT BE COPIED, REVISED OR TRANSMITTED TO ANY THIRD PARTY.

THESE DRAWINGS SHALL NOT BE USED FOR THIS PROJECT, THE CONTRACTOR, SUBCONTRACTOR, MATERIAL OR EQUIPMENT SUPPLIER ARE PERMITTED TO USE OR REPRODUCE PORTION(S) OF THE DRAWINGS RELATIVE TO THEIR PERFORMANCE CONTRACT AS SPECIFIED IN THE CONTRACT DOCUMENTS.

THESE DRAWINGS SHALL NOT BE USED BY THE CONTRACTOR, SUBCONTRACTOR, MATERIAL OR EQUIPMENT SUPPLIER ON OTHER PROJECTS OR ON ADDITIONS TO THIS PROJECT OUTSIDE THE ORIGINAL SCOPE OF WORKS WITHOUT THE SPECIFIC WRITTEN CONSENT OF THE ENGINEER.

OFFICIAL SUBMISSION OF THESE PLANS TO REGULATORY AGENCIES SHALL ONLY MEAN COMPLIANCE TO REGULATORY REQUIREMENTS AND SHALL NOT BE CONSTRUED AS PUBLICATION OR LOSS OF ENGINEER'S COPYRIGHT OR OTHER RESERVED RIGHTS.

PROJECT STATUS:
 AS-BUILT DRAWING

PROJECT MANAGER:
 BILLY W. HUDSON

DESIGN COORDINATOR:
 DANTE ABAYON

DATE:
 03/04/08

DRAWING DONE BY:
 REXRAY JOHN OJOL

ENGINEER'S SEAL
 THE SEAL APPEARING ON THIS DOCUMENT WAS AUTHORIZED BY BILLY W. HUDSON, P.E. 38421 ON THE DATE INDICATED HEREIN. ALTERATION OF A SEALED DOCUMENT WITHOUT PROPER NOTIFICATION TO THE RESPONSIBLE ENGINEER IS AN OFFENSE UNDER THE TEXAS ENGINEERING ACT.

UTILITY PLAN
YELLOW JACKET CROSSING
 INTERSECTION OF YELLOW JACKET LANE and FM 740 (Ridge Road)
 CITY OF ROCKWALL, TEXAS 75087
 LOT 1, BLOCK A
 1.129 AC

C2