

F:\work\2019\AS-BUILT\grading & drain\grading.dwg Tue Sep 25 14:49:50 2001 B. Johnson
 HP Designer: 1050C Hewlett-Packard HP-GL/2 devices, ADI 4.3 (V4I.5) - 1999052

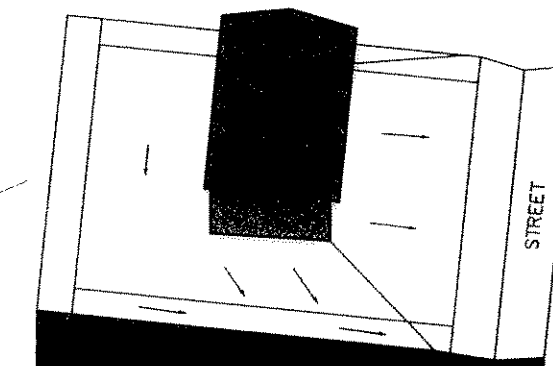

NOTE: NO LOT TO LOT DRAINAGE WILL BE ALLOWED.

SEE NTMWD GENERAL NOTES ON COVER SHEET

AS-BUILT
 ACCORDING TO CONTRACTORS RECORDS

A. W. Fendley
 9-25-01
 DATED:

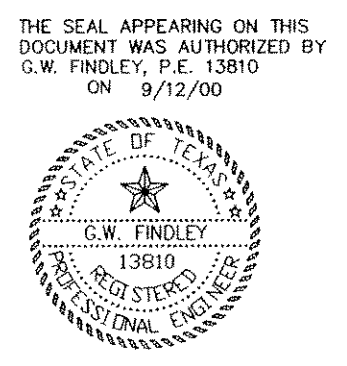

LOT GRADING - SHEET 1						
WINDMILL RIDGE ESTATES PH. IV-B						
City of Rockwall, Rockwall County, Texas						
KPA CONSULTING, INC.						
14800 Quorum Drive ~ Suite 500 ~ Dallas, Texas 75248						
DESIGN	DRAWN	DATE	SCALE	NOTES	FILE	NO.
G.W.F.	B.J.	8/17/01	1"=4' V 1"=40' H	K.P.A.	20129	26