

DEVELOPMENT PLANS FOR WINDMILL RIDGE ESTATES PHASE 4-B CITY OF ROCKWALL, TEXAS

NTMWD NOTES:

- A. NORTH TEXAS MUNICIPAL WATER DISTRICT (NTMWD) 21-INCH SANITARY SEWER GRAVITY TRUNK MAIN IS LOCATED WITHIN LIMITS OF CONSTRUCTION. THE PIPE MATERIAL IS CLAY TILE, WHICH IS EXTREMELY BRITTLE.
- B. OPERATION OF HEAVY EARTH MOVING EQUIPMENT, COMPACTION EQUIPMENT OR HEAVY CONSTRUCTION EQUIPMENT, SUCH AS CONCRETE TRUCKS, SHALL BE RESTRICTED TO SPECIFIC CROSSING POINTS ACROSS NTMWD EASEMENTS, AS APPROVED BY THE NTMWD. THE CROSSINGS SHALL BE DESIGNATED AND VERIFIED TO PROVIDE A MINIMUM OF FIVE FEET OF COVER.
- C. TO ASSURE THAT PLACING OF SIGNIFICANT LOADS OVER THE NTMWD PIPELINE DOES NOT DAMAGE THE EXISTING PIPELINE, NO MATERIALS SHALL BE STOCK-PILED ON THE NTMWD EASEMENT WITHOUT AUTHORIZATION FROM NTMWD. IF THE CONTRACTOR DESIRES TO USE NTMWD'S EASEMENT FOR STOCKPILES OF MATERIALS, CONTACT NTMWD ENGINEERING AT (972) 442-5405 SO YOUR PLANS FOR USE OF NTMWD'S EASEMENT CAN BE REVIEWED.
- D. IN AREAS WHERE THE COVER BETWEEN THE TOP OF THE NTMWD PIPELINE AND THE BOTTOM OF THE SUB-GRADE IS THREE (3) FEET OR LESS, IT IS REQUESTED THAT THE SUB GRADE PREPARATION BE DELETED AND A THICKENED PAVEMENT SECTION BE USED TO LIMIT CONSTRUCTION ACTIVITIES OVER THE PIPELINE.
- E. CROSSING OF THE NTMWD EASEMENT WITH OTHER UTILITIES, SUCH AS TV CABLE, PHONE, GAS AND ELECTRIC, SHALL BE COORDINATED WITH THE NTMWD TO AVOID DAMAGE TO THE NTMWD FACILITIES.
- F. OUTDOOR LIGHTING, LANDSCAPING, SCREENING WALLS OR OTHER FACILITIES SHALL NOT BE INSTALLED IN NTMWD EASEMENTS WITHOUT WRITTEN APPROVAL OF THE NTMWD.
- G. UNLESS OTHERWISE SHOWN OR REQUIRED, A MINIMUM OF ONE-FOOT CLEARANCE SHALL BE PROVIDED FOR ALL UTILITIES CROSSING THE NTMWD PIPELINES.
- H. THE CONTRACTOR SHALL CONTACT NTMWD ENGINEERING AT (972) 442-5405 AT LEAST 48 HOURS PRIOR TO PERFORMING ANY WORK IN THE VICINITY OF THE NTMWD FACILITIES.

GENERAL NOTES

- 1. ALL STREET AND ALLEY INTERSECTIONS AND CONNECTIONS SHALL BE BUILT BY THE DEVELOPER.
- 2. EXCAVATION FROM STREETS TO BE DEPOSITED IN LOW AREAS TO ALLOW PROPER DRAINAGE. ALL FILL IS TO BE PLACED WITH A SHEEP'S FOOT ROLLER.
- 3. ALL EXISTING DITCHES, EXCEPT AS NOTED ON DRAINAGE PLANS, ARE TO BE FILLED TO CONFORM TO SURROUNDING TERRAIN.
- 4. IT WILL BE THE RESPONSIBILITY OF THE DEVELOPER AND/OR THE CONTRACTOR TO PROTECT AND MAINTAIN TO PROPER LINE AND GRADE ALL PUBLIC UTILITIES, MANHOLES, CLEAN OUTS, VALVE BOXES, FIRE HYDRANTS, ETC., DURING THE CONSTRUCTION OF THIS PROJECT, PRIOR TO AND AFTER PLACING PERMANENT PAVEMENT.
- 5. ALL MATERIALS AND WORKMANSHIP SHALL CONFORM TO THE CITY STANDARDS AND SPECIFICATIONS.

NOTE:
THIS SET OF ENGINEERING DRAWINGS SUPERSEDES ANY AND ALL OTHER DRAWINGS RELEASED PRIOR TO THE ISSUANCE OF THIS SET.

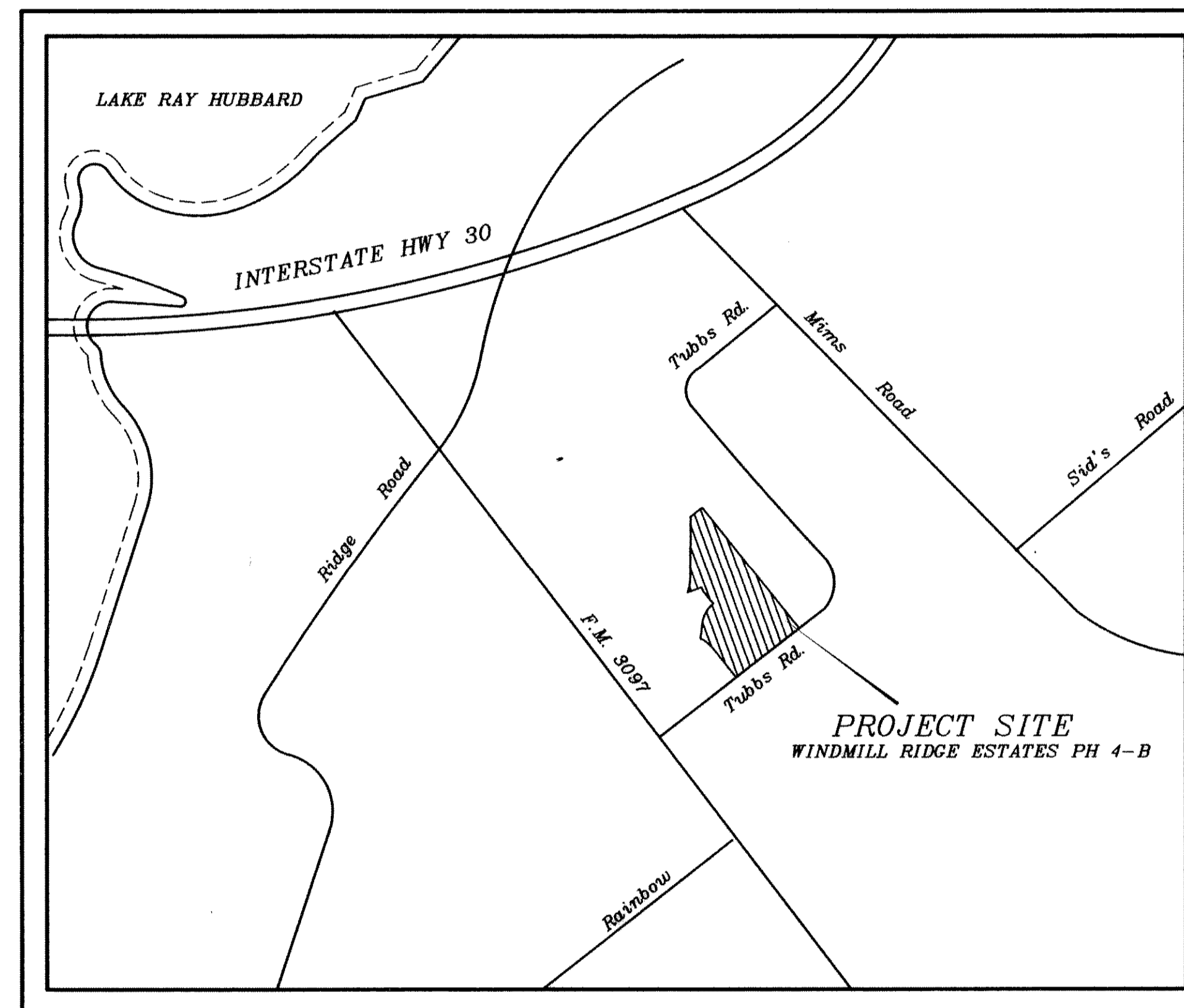

LOCATION MAP
NOT TO SCALE

INDEX

SHEET NO.	DESCRIPTION
2-3	FINAL PLAT
4-14	PAVING PLANS & PROFILES
15	DRAINAGE AREA MAP
16-18	STORM SEWER PLANS
19	WATER & SEWER PLAN
20-23	SANITARY SEWER PROFILES
24	WATER PROFILES
25	STORM WATER POLLUTION PREVENTION PLAN
26-28	LOT GRADING PLANS
29	TRESCAPE PLAN
30	SCREENING WALL DETAILS

PREPARED FOR
SHEPHERD PLACE HOMES
No. 5 Northridge Lane ~ Rockwall, Texas 75087

KPA
KPA CONSULTING, INC.

G. W. FINDLEY, P.E.

14800 QUORUM DRIVE ~ SUITE 500 ~ DALLAS, TEXAS 75248 (972)503-5300

AS-BUILT
ACCORDING TO CONTRACTORS
RECORDS

G. W. Findley

9-25-01
DATED:

THE SEAL APPEARING ON THIS DOCUMENT WAS AUTHORIZED BY G.W. FINDLEY, P.E. 13810 ON 9/10/00

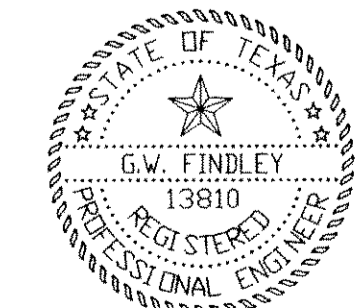

DATE: 1/09/01