

B.M.
 SQUARE ON TOP OF 10" INLET ON N.W. SIDE
 ROCKWALL PARKWAY, 85' S.W. OF CENTERLINE
 OF AUTUMN TRAIL.
 ELEVATION = 535.21

B.M.
 CENTERLINE OF TOP OF 15" INLET ON N.W. SIDE
 OF ROCKWALL PARKWAY, 140' N.E. OF WOODCREEK
 DRIVE.
 ELEVATION = 527.25

5+04.80~ END CONC. P.V.M.T
 & CONST. CONC. ST. HEADER
 & STD. STREET BARRICADE

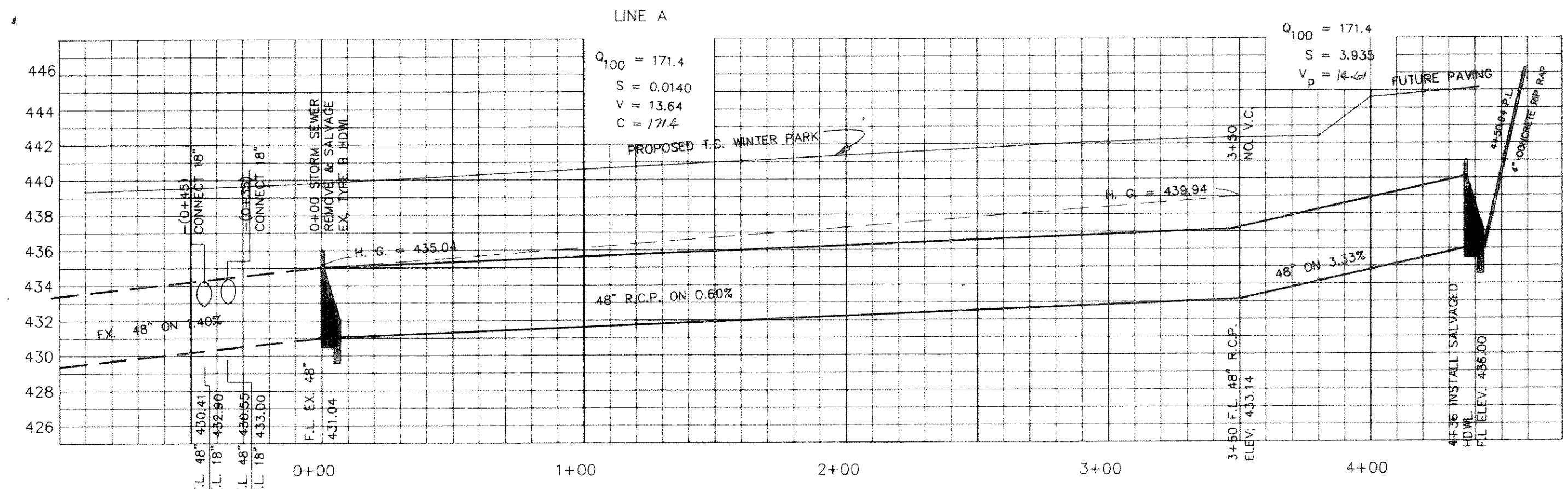
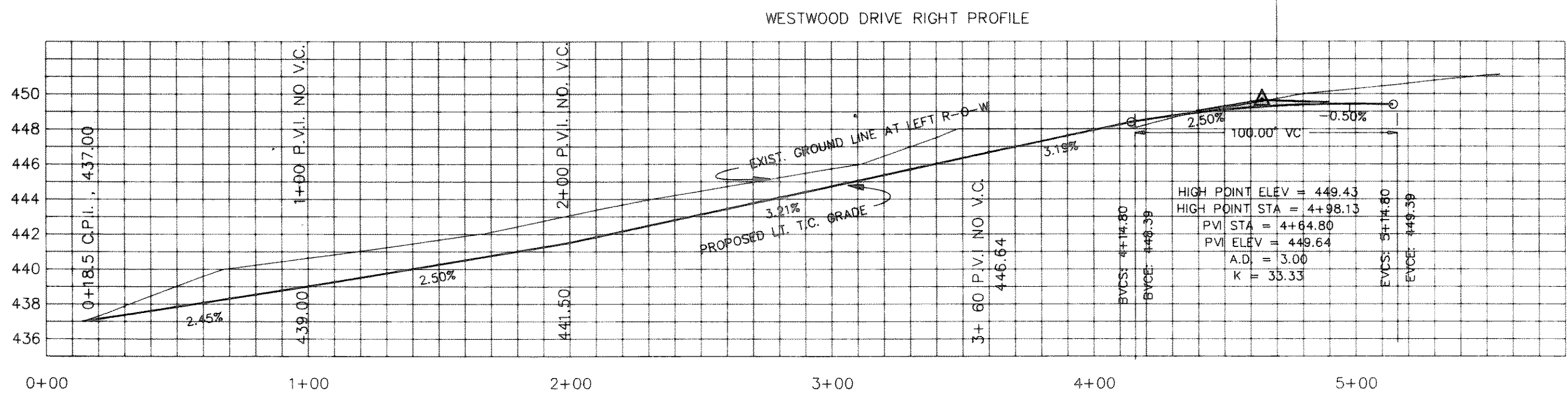
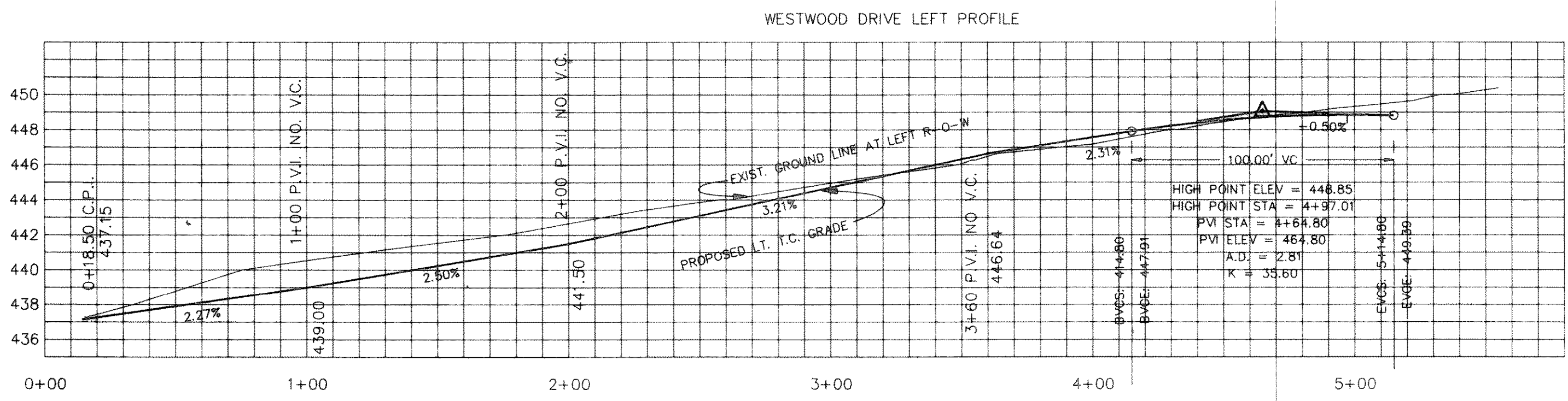
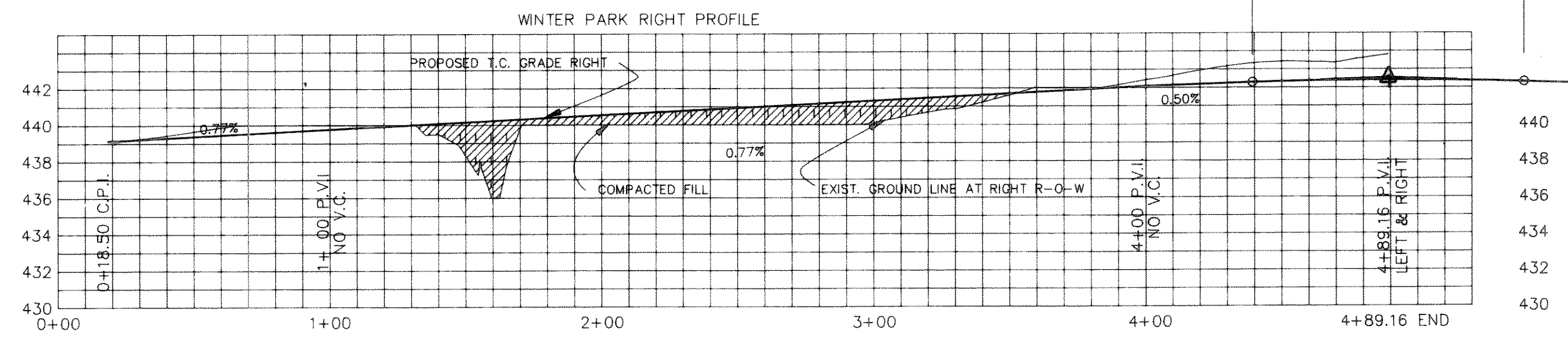
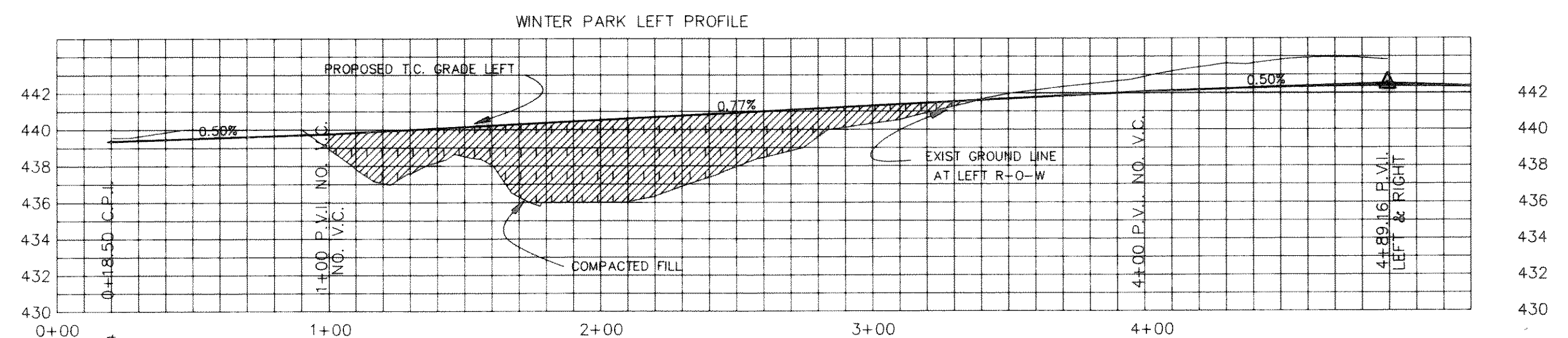

CURVE	RADIUS	LENGTH	TANGENT	CHORD	BEARING	DELTA
C1	39.50'	99.66'	123.63'	75.25'	N73°07'57"W	144°33'41"
C2	39.50'	99.66'	123.63'	75.25'	N71°25'43"E	144°33'41"
C3	20.00'	19.05'	10.31'	18.33'	N63°34'17"W	54°33'41"
C4	20.00'	19.05'	10.31'	18.33'	N61°52'03"E	54°33'41"

AS-BUILT



REVISION DESCRIPTION DATE: 4/12/94 SCALE: HORIZ 1" = 40' VERT 1" = 5'		DESIGN H.L.E.		DRAWN K.E.B.	
HAROLD L. EVANS CONSULTING ENGINEER P.O. BOX 28855 2331 GUS THOMASSON ROAD, SUITE 102 DALLAS, TEXAS 75228, (214) 328-8133			PAVING PLAN WINTER PARK & WESTWOOD DRIVE CITY OF ROCKWALL ROCKWALL COUNTY, TEXAS		
SHEET NO. 4			JOB NO. 9375		