

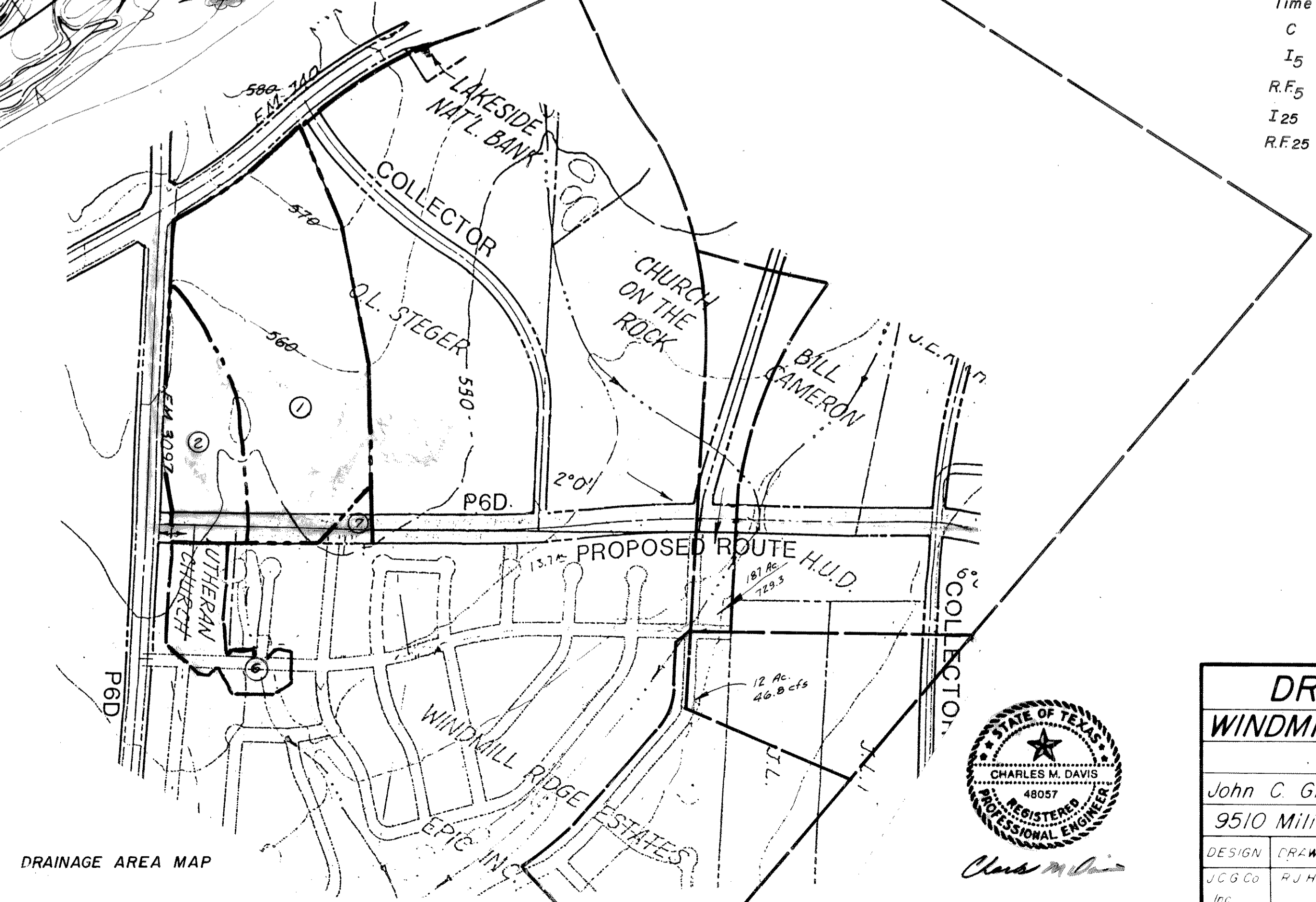

AREA	ACRES	5yr. cfs	Accum. 5yr. cfs	25 yr. cfs.	Accum. 25 yr. cfs
1	22.5	97.9		131.6	
2	6.8	29.6	127.5	39.8	171.4
3	0.2	0.6		0.8	
4	2.5	7.2	7.8	9.8	10.6
5	1.0	2.9	10.7	3.9	14.5
* 6	4.4	12.8	23.5	17.2	31.7
7	0.6	1.7	25.2	2.3	34.0
8	1.7	4.9	30.1	6.6	40.6
9	0.3	0.9	31.0	1.2	41.8
10	1.6	4.6	35.6	6.2	48.0
11	0.7	2.0	37.6	2.7	50.7
* 12	1.1	3.2	40.8	4.3	55.0
* 13	1.3	3.8	44.6	5.1	60.1
14	3.1	9.0	53.6	12.1	72.2
15	0.4	1.2		1.6	
16	0.5	1.4	2.6	2.0	3.6
17	0.6	1.7	4.3	2.3	5.9
18	1.6	4.6	8.9	6.2	12.1
19	1.3	3.8	12.7	5.1	17.2
20	0.2	0.6	13.3	0.8	18.0
21	2.5	7.2	20.5	9.8	27.8
22	1.6	4.6	25.1	6.2	34.0
23	0.1	0.3	25.4	0.4	34.4
24	2.8	8.1	33.5	10.9	45.3
25	0.5	1.4	34.9	2.0	47.3
26	1.9	5.5	40.4	7.4	54.7
27	0.3	0.9		1.2	
28	1.4	4.1	5.0	5.5	6.7
29	0.6	1.7	6.7	2.3	9.0
30	0.7	2.0		2.7	
31	1.3	3.8	5.8	5.1	7.8
32	0.6	1.7	7.5	2.3	10.1
33	1.2	3.5	11.0	4.7	14.8
34	0.6	1.7	12.7	2.3	17.1
35	1.3	3.8	16.5	5.1	22.2
36	0.7	2.0	18.5	2.7	24.9
37	1.5	4.4	22.9	5.8	30.7
38	1.3	3.8	26.7	5.1	35.8
39	0.8	2.3		3.1	
40	2.1	6.1	8.4	8.2	11.3
41	0.1	0.3	8.7	0.4	11.7
42	0.4	1.2	9.9	1.6	13.3
43	3.3	9.6		12.9	
44	1.4	4.1		5.5	

DRAINAGE DATA

Time = 13 min.
 C = 0.50
 I₅ = 5.8 in./hr.
 R.F.₅ = 2.9 cfs/ac.
 I₂₅ = 7.8 in./hr.
 R.F.₂₅ = 3.9 cfs/ac.



DRAINAGE MAP
WINDMILL RIDGE ESTATES NO. 3A
ROCKWALL, TEXAS

John C Gibson Co Inc, Consulting Engineers
 9510 Military Parkway Dallas, Texas 75227

DESIGN	DRAWN	DATE	SCALE	NOTES	FILE	NO
JCG Co	R.J.H.		1"=100'	RD.	Windmill Ridge 3A	3/21

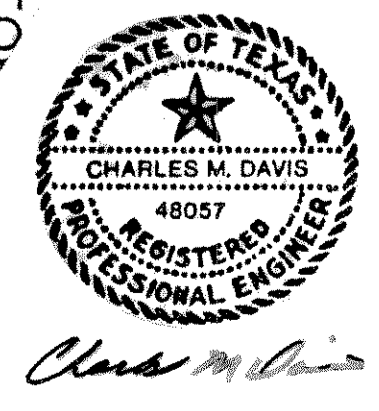

DRAINAGE AREA MAP