

WATER NOTES:

1. WITHIN THIS PLAN SET THE TERM "CITY OF ROCKWALL STANDARDS" IS MEANT TO INCLUDE THE CITY OF ROCKWALL STANDARDS OF DESIGN AND CONSTRUCTION MANUAL, DATED OCTOBER 2019 AND THE PUBLIC WORKS CONSTRUCTION STANDARDS AND SPECIFICATIONS, NORTH CENTRAL TEXAS, 5TH EDITION, DATED OCTOBER 2017. CONTRACTOR SHALL REFER TO BOTH MANUALS PRIOR TO BEGINNING CONSTRUCTION.
2. ALL WATER LINES AND APPURTENANCES THERETO SHALL BE CONSTRUCTED AND/OR INSTALLED PER CITY OF ROCKWALL STANDARDS.
3. ALL WATER PIPE SHALL BE AWWA C900 PVC PIPE, DR-14 PC 305 (BLUE IN COLOR), UNLESS SPECIFIED OTHERWISE IN CITY OF ROCKWALL STANDARDS.
4. INSTALL BLUE EMS LOCATOR PADS ALONG WATER LINES AT EVERY TWO HUNDRED FIFTY (250') FEET, CHANGES IN DIRECTION, VALVE, CURB STOP AND SERVICE CONNECTION TO THE WATER MAIN AND ANY OTHER LOCATION REQUIRED BY CITY OF ROCKWALL STANDARDS.
5. REFER TO CITY OF ROCKWALL STANDARDS FOR WATER PIPE EMBEDMENT.
6. MINIMUM COVER FOR WATER PIPE UNDER PAVEMENT IS 4'.
7. WATER SERVICES SHALL BE SDR-9 (POLYTUBE) HAVING A MINIMUM SIZE OF ONE INCH (1"), METER BOXES SHALL BE SET BETWEEN THE SIDEWALK AND THE BACK OF CURB AS SPECIFIED IN CITY OF ROCKWALL STANDARDS.

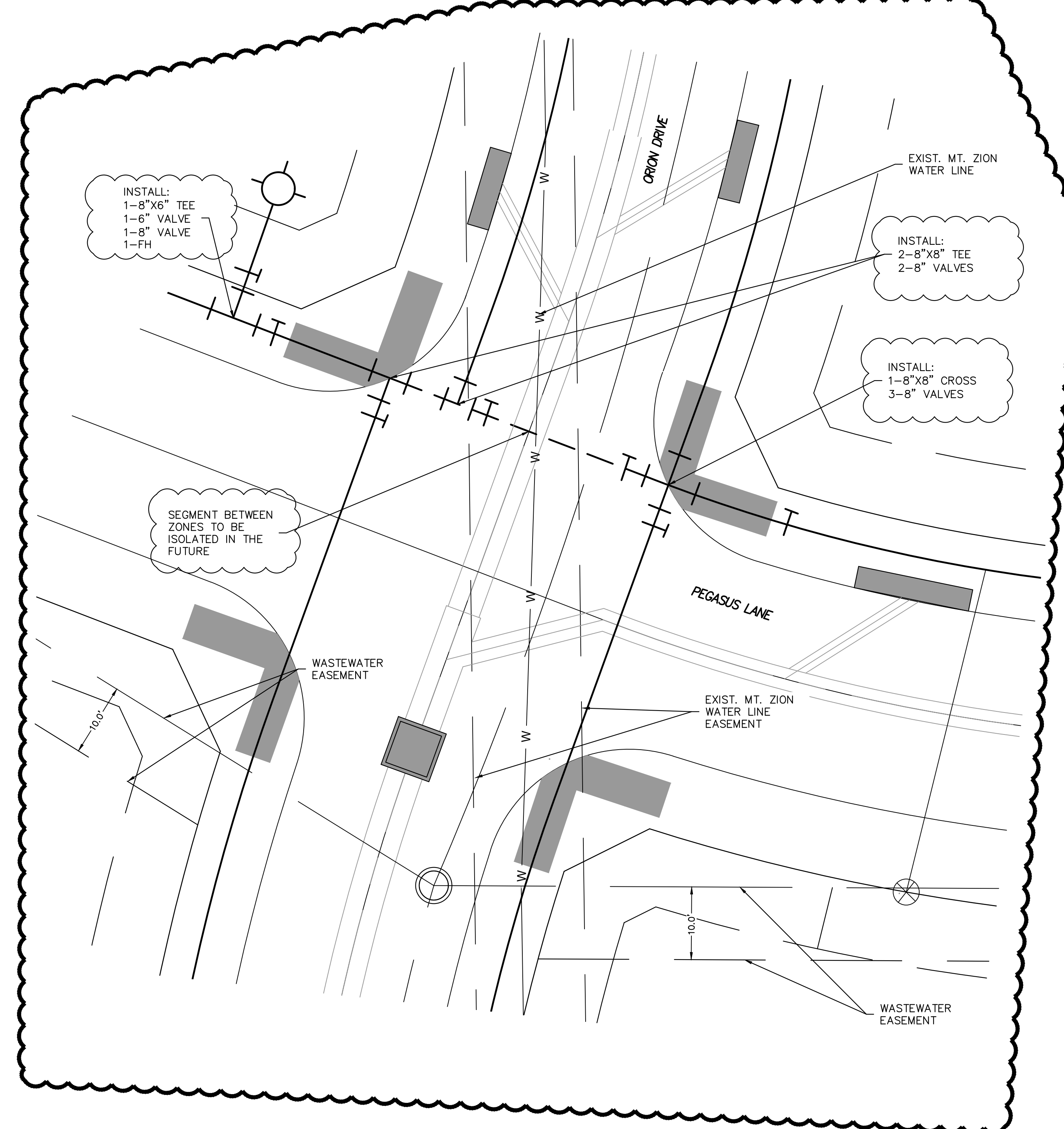

3

- GENERAL NOTES:**
- 1) ALL CONSTRUCTION SHALL BE IN ACCORDANCE WITH THE CITY OF ROCKWALL STANDARDS.
 - 2) THE CONTRACTOR SHALL VERIFY THE HORIZONTAL AND VERTICAL LOCATIONS OF ALL EXISTING UTILITIES IN THE AREA OF CONSTRUCTION PRIOR TO BEGINNING CONSTRUCTION.
 - 3) THE CONTRACTOR SHALL NOTIFY ENGINEER OF RECORD OF ANY DISCREPANCIES BETWEEN THESE PLANS AND ACTUAL FIELD CONDITIONS.
 - 4) DIMENSIONS ARE TO BACK OF CURB, UNLESS OTHERWISE NOTED.

CITY OF ROCKWALL MONUMENT "COR-2"
ALUMINUM DISK STAMPED "CITY OF ROCKWALL SURVEY MONUMENT" +/- .866'
EAST OF INTERSECTION OF WILLIAMS STREET AND CARUTH LANE, AND 50' SOUTH
OF CL OF WILLIAMS STREET. N: 7029731.124, E: 2598589.314, ELEV=529.10

CITY OF ROCKWALL MONUMENT "COR-4"
ALUMINUM DISK STAMPED "CITY OF ROCKWALL SURVEY MONUMENT" ON NORTH SIDE
OF DALTON ROAD +/- .210' WEST OF INTERSECTION OF SH 205 AND DALTON ROAD,
AND 10' NORTH OF CURB LINE. N: 7040336.992, E: 2592422.633, ELEV=541.67

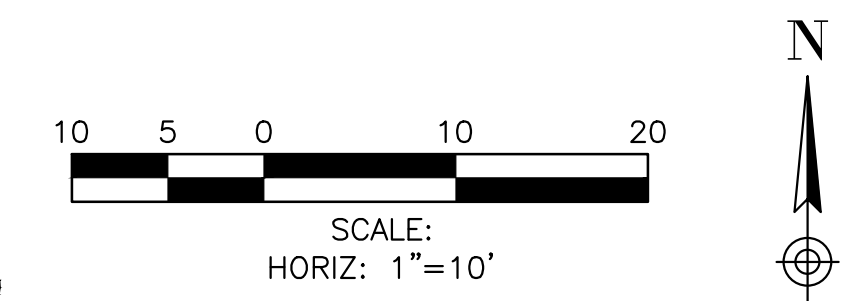
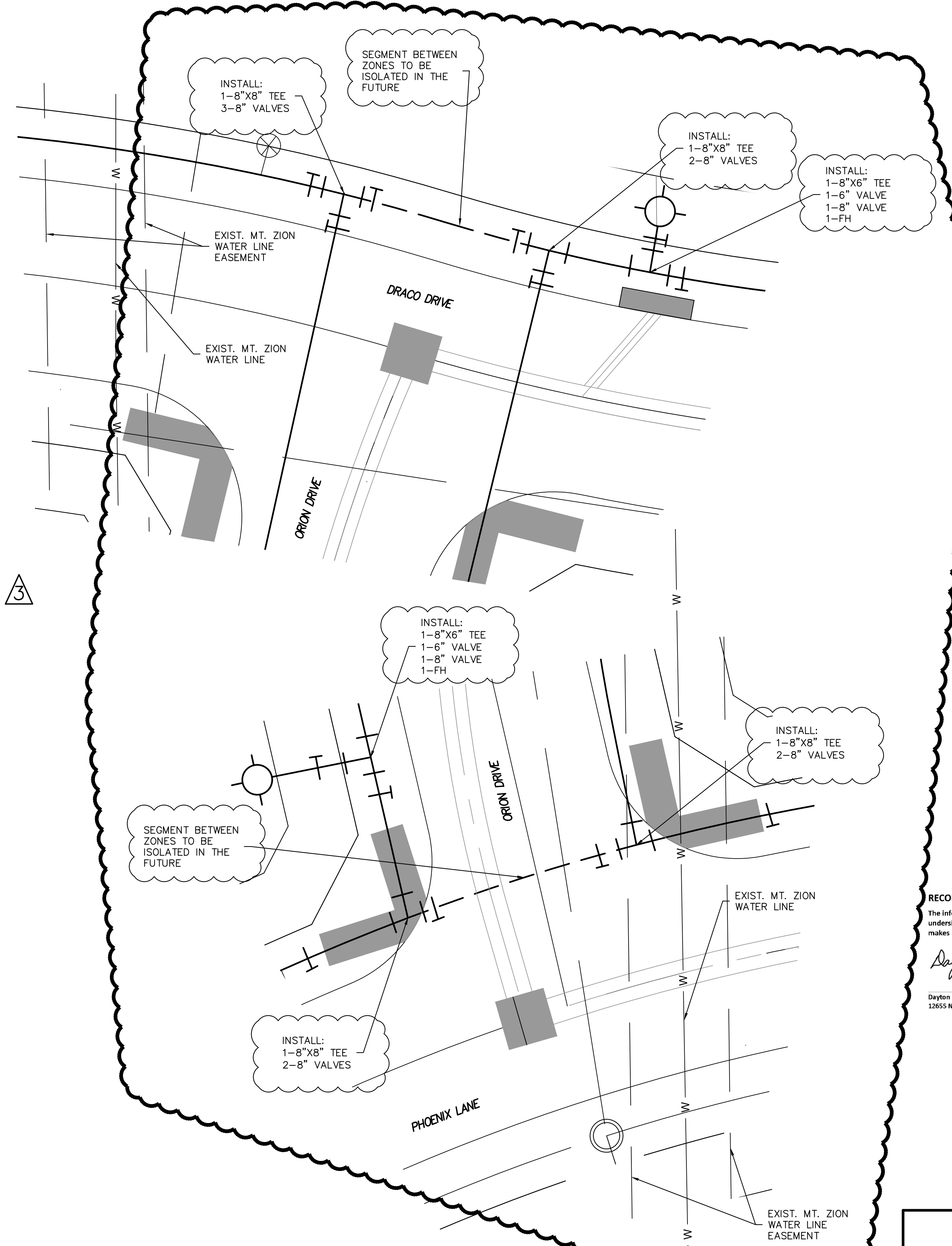

3

| REV | BY | DATE | COMMENT |
|-----|-----|----------|---------------------------|
| 1 | PJF | 08/22 | REVISED RIP-RAP QUANTITY |
| 2 | PJF | | REVISED FOR FLEXAMAT PLUS |
| 3 | NCL | 10/25/22 | REVISED FOR EXIST. WATER |

RECORD DRAWINGS
The information contained hereon was provided by the contractor based on their field installation. The undersigned registered professional engineer did not provide inspection on this project, and therefore makes no warrants concerning the accuracy or completeness of the information provided.

Dayton Macatee
NOVEMBER 29, 2023
Date

Dayton C. Macatee, P.E. - Macatee Engineering, L.L.C. (Tx. Reg. No. F-456)
12655 N. Central Expwy Suite 420, Dallas, Texas 75243 ~ Tel: 214-373-1180

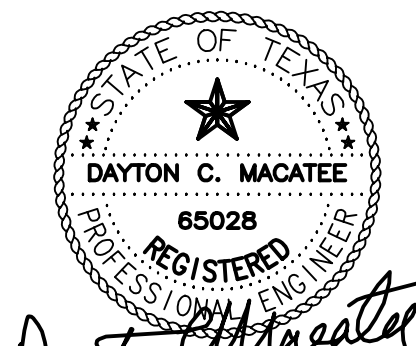

Dayton Macatee
11/29/2023
DAYTON MACATEE
ENGINEERING, LLC
TX. REG. NO. F-456

| | | | | |
|--|------------------------|--|----------------|--------------------|
| WATER PLAN | | | | |
| WINDING CREEK | | | | |
| CITY OF ROCKWALL, ROCKWALL COUNTY, TEXAS | | | | |
| | | CIVIL ENGINEERING DESIGN & CONSULTING (Tex. Reg. No. F-456) 12655 N. CENTRAL EXPWY, SUITE 420 DALLAS, TEXAS 75243 TEL 214-373-1180 * FAX 214-373-6580 daytonm@macatee-engineering.com phillip@macatee-engineering.com | | |
| | | DESIGNED BCP | CHECKED SDA | DATE 11/29/2023 |
| PROJECT # SKO_WC | SHEET NO. 50A OF 53 | | | |