

LINE SS2

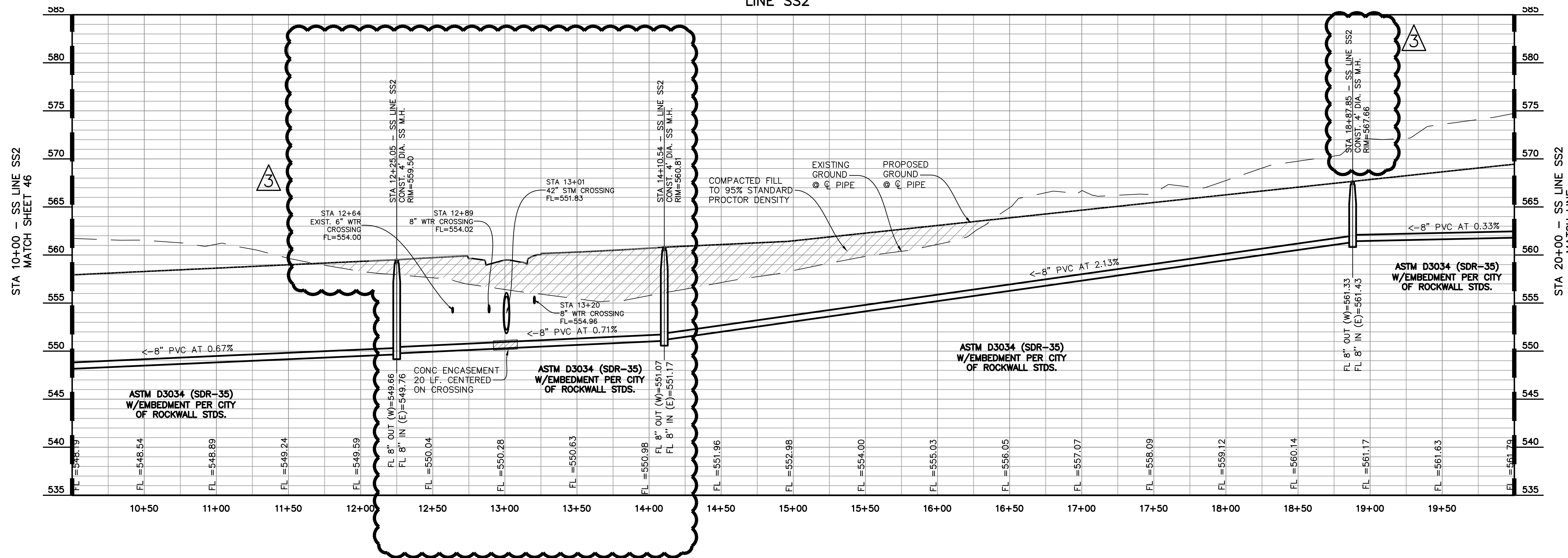

- WASTEWATER NOTES:
1. WITHIN THIS PLAN SET THE TERM "CITY OF ROCKWALL STANDARDS" IS MEANT TO INCLUDE THE CITY OF ROCKWALL STANDARDS OF DESIGN AND CONSTRUCTION MANUAL, DATED OCTOBER 2019 AND THE PUBLIC WORKS CONSTRUCTION STANDARDS AND SPECIFICATIONS, NORTH CENTRAL TEXAS, 5TH EDITION, DATED OCTOBER 2017. CONTRACTOR SHALL REFER TO BOTH MANUALS PRIOR TO BEGINNING CONSTRUCTION.
 2. ALL WASTEWATER LINES AND APPURTENANCES THERETO SHALL BE CONSTRUCTED AND/OR INSTALLED PER CITY OF ROCKWALL STANDARDS.
 2. ALL WASTEWATER PIPE SHALL BE SDR 35 FOR DEPTHS UP TO 10 FEET AND SDR 26 FOR DEPTHS GREATER THAN 10 FEET.
 3. A GREEN EMS LOCATOR PAD IS TO BE INSTALLED AT EVERY MANHOLE, CLEANOUT, AND SERVICE CONNECTION TO THE WASTEWATER MAIN, AND AT ANY OTHER LOCATION REQUIRED BY CITY OF ROCKWALL STANDARDS.
 4. MANHOLES SHALL CONFORM TO CITY OF ROCKWALL STANDARDS.
 5. RAVEN EPOXY COATING, CONSHIELD, OR APPROVED EQUAL, SHALL BE INSTALLED IN ALL MANHOLES.

REV	BY	DATE	COMMENT
1	PJF	08/22	REVISED RIP-RAP QUANTITY
2	PJF		REVISED FOR FLEXAMAT PLUS
3	NCL	10/25/22	REVISED FOR EXIST. WATER

LINE SS2

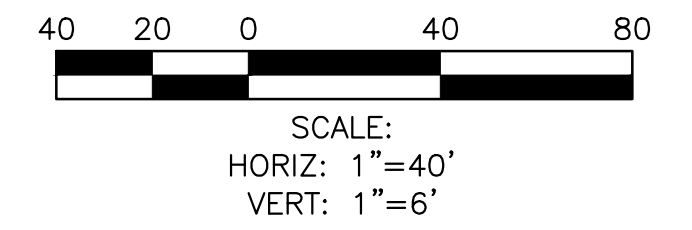
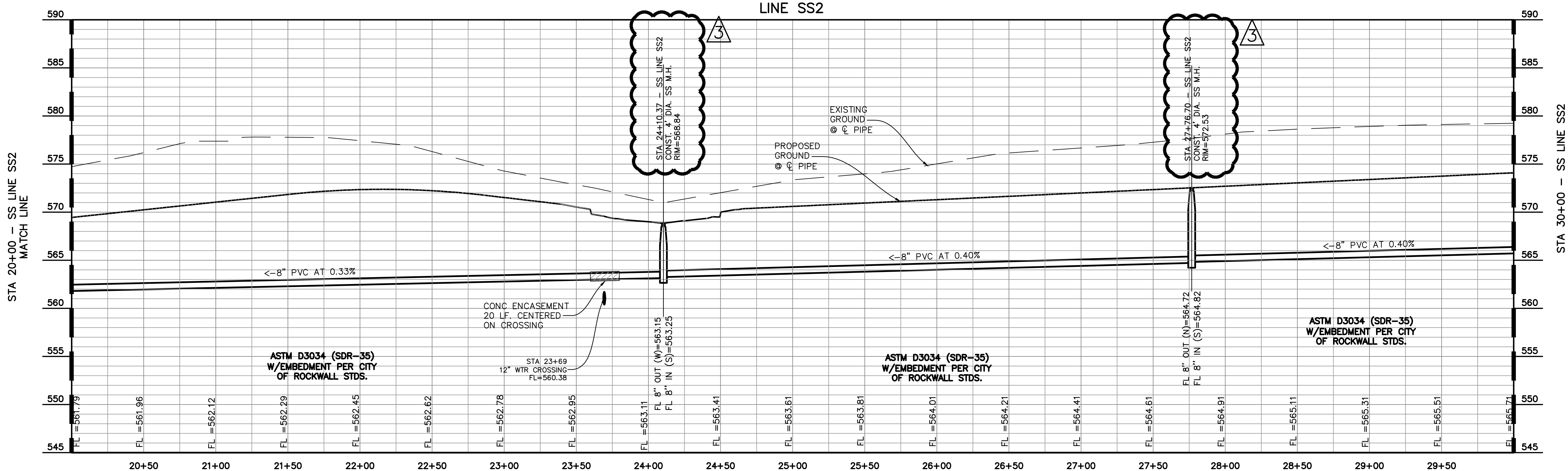

RECORD DRAWINGS
 The information contained hereon was provided by the contractor based on their field installation. The undersigned registered professional engineer did not provide inspection on this project, and therefore makes no warrants concerning the accuracy or completeness of the information provided.

Dayton C. Macatee
 NOVEMBER 29, 2023
 Dayton C. Macatee, P.E. - Macatee Engineering, L.L.C. (Tx. Reg. No. F-456)
 12655 N. Central Expwy Suite 420, Dallas, Texas 75243 - Tel: 214-373-1180

CITY OF ROCKWALL MONUMENT "COR-2"
 ALUMINUM DISK STAMPED "CITY OF ROCKWALL SURVEY MONUMENT" +/-866'
 EAST OF INTERSECTION OF WILLIAMS STREET AND CARUTH LAKE, AND 30' SOUTH
 OF CL OF WILLIAMS STREET. N: 7029731.124, E: 2598589.314, ELEV=529.10

CITY OF ROCKWALL MONUMENT "COR-4"
 ALUMINUM DISK STAMPED "CITY OF ROCKWALL SURVEY MONUMENT" ON NORTH SIDE
 OF DALTON ROAD +/-210' WEST OF INTERSECTION OF SH 205 AND DALTON ROAD,
 AND 10' NORTH OF CURB LINE. N: 7040336.992, E: 2592422.633, ELEV=541.67

WASTEWATER PROFILE
 WINDING CREEK
 CITY OF ROCKWALL, ROCKWALL COUNTY, TEXAS

CIVIL ENGINEERING
 DESIGN & CONSULTING
 (Tex. Reg. No. F-456)
 12655 N. CENTRAL EXPWY, SUITE 420
 DALLAS, TEXAS 75243
 TEL 214-373-1180 * FAX 214-373-6580
 daytonm@macatee-engineering.com
 phillipf@macatee-engineering.com

DESIGNED	CHECKED	DATE	DWG FILE	PROJECT #	SHEET NO.
BCP	SDA	11/29/2023	WC_WW PROF	SKO_WC	47 OF 53