

STA 10+00 - SS LINE SSI  
MATCH LINE

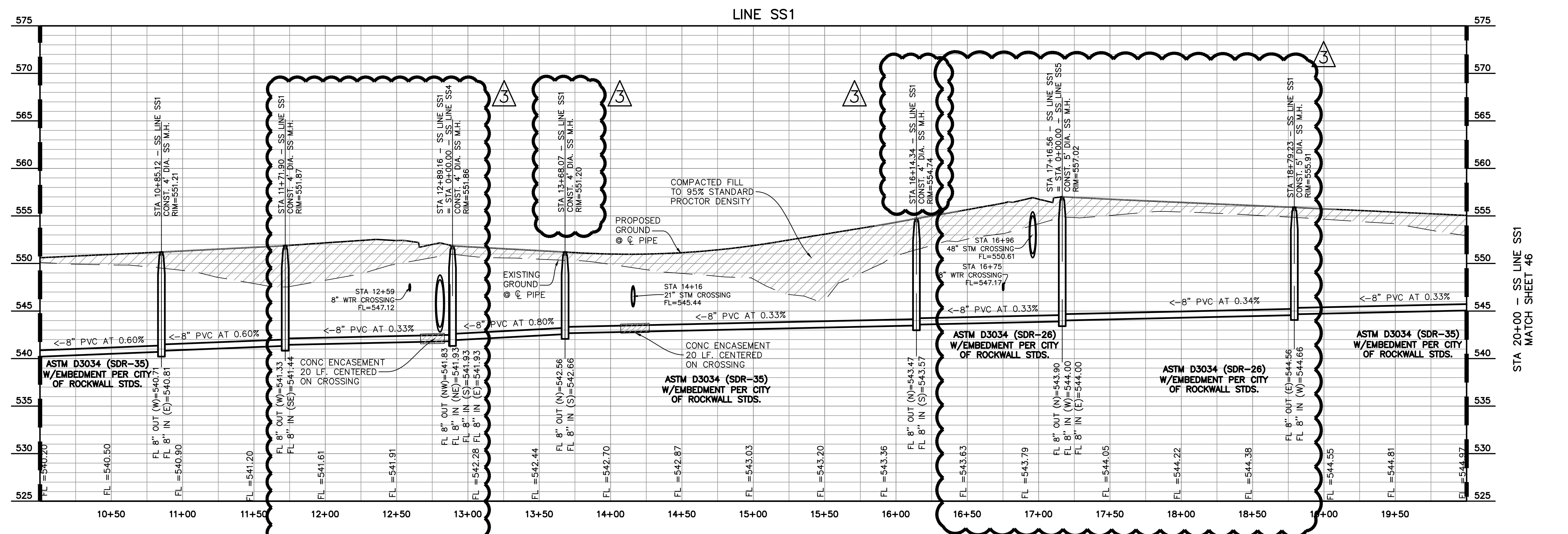

STA 10+00 - SS LINE SSI  
MATCH LINE

STA 20+00 - SS LINE SSI  
MATCH SHEET 46

- WASTEWATER NOTES:
1. WITHIN THIS PLAN SET THE TERM "CITY OF ROCKWALL STANDARDS" IS MEANT TO INCLUDE THE CITY OF ROCKWALL STANDARDS OF DESIGN AND CONSTRUCTION MANUAL, DATED OCTOBER 2019 AND THE PUBLIC WORKS CONSTRUCTION STANDARDS AND SPECIFICATIONS, NORTH CENTRAL TEXAS, 5TH EDITION, DATED OCTOBER 2017. CONTRACTOR SHALL REFER TO BOTH MANUALS PRIOR TO BEGINNING CONSTRUCTION.
  2. ALL WASTEWATER LINES AND APPURTENANCES THERETO SHALL BE CONSTRUCTED AND/OR INSTALLED PER CITY OF ROCKWALL STANDARDS.
  2. ALL WASTEWATER PIPE SHALL BE SDR 35 FOR DEPTHS UP TO 10 FEET AND SDR 26 FOR DEPTHS GREATER THAN 10 FEET.
  3. A GREEN EMS LOCATOR PAD IS TO BE INSTALLED AT EVERY MANHOLE, CLEANOUT, AND SERVICE CONNECTION TO THE WASTEWATER MAIN, AND AT ANY OTHER LOCATION REQUIRED BY CITY OF ROCKWALL STANDARDS.
  4. MANHOLES SHALL CONFORM TO CITY OF ROCKWALL STANDARDS.
  5. RAVEN EPOXY COATING, CONSHIELD, OR APPROVED EQUAL, SHALL BE INSTALLED IN ALL MANHOLES.

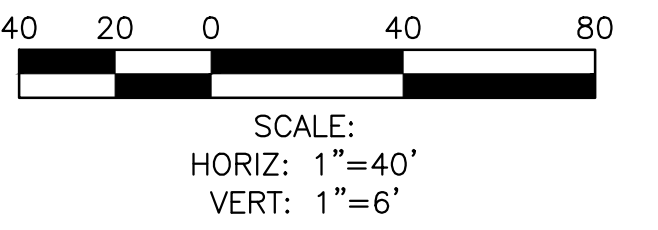

REV	BY	DATE	COMMENT
1	PJF	08/22	REVISED RIP-RAP QUANTITY
2	PJF		REVISED FOR FLEXAMAT PLUS
3	NCL	10/25/22	REVISED FOR EXIST. WATER

RECORD DRAWINGS  
The information contained hereon was provided by the contractor based on their field installation. The undersigned registered professional engineer did not provide inspection on this project, and therefore makes no warrants concerning the accuracy or completeness of the information provided.

*Dayton C. Macatee*  
NOVEMBER 29, 2023

Dayton C. Macatee, P.E. - Macatee Engineering, L.L.C. (Tx. Reg. No. F-456)  
12655 N. Central Expwy Suite 420, Dallas, Texas 75243 ~ Tel: 214-373-1180

CITY OF ROCKWALL MONUMENT "COR-2"  
ALUMINUM DISK STAMPED "CITY OF ROCKWALL SURVEY MONUMENT" +/- .866'  
EAST OF INTERSECTION OF WILLIAMS STREET AND CARUTH LANE, AND 50' SOUTH  
OF CL OF WILLIAMS STREET. N: 7029731.124, E: 2598589.314, ELEV=529.10

CITY OF ROCKWALL MONUMENT "COR-4"  
ALUMINUM DISK STAMPED "CITY OF ROCKWALL SURVEY MONUMENT" ON NORTH SIDE  
OF DALTON ROAD +/- .210' WEST OF INTERSECTION OF SH 205 AND DALTON ROAD,  
AND 10' NORTH OF CURB LINE. N: 7040336.992, E: 2592422.633, ELEV=541.67



<b>WASTEWATER PROFILE</b>				
WINDING CREEK				
CITY OF ROCKWALL, ROCKWALL COUNTY, TEXAS				
		<b>CIVIL ENGINEERING DESIGN &amp; CONSULTING</b> (Tex. Reg. No. F-456) 12655 N. CENTRAL EXPWY, SUITE 420 DALLAS, TEXAS 75243 TEL 214-373-1180 * FAX 214-373-6580 daytonm@macatee-engineering.com phillyp@macatee-engineering.com		
DESIGNED BCP	CHECKED SDA	DATE 11/29/2023	DWG FILE WC_WW PROF	PROJECT # SKO_WC
				SHEET NO. 45 OF 53