

Proposed East Pond Results Summary				
Rain Event	Peak Inflow	Peak Outflow	Peak Storage	Peak Elevation
	cfs	cfs	acre-ft	ft
5-yr	17.8	6.3	0.5	564.2
10-yr	21.6	6.9	0.6	564.7
25-yr	25.5	7.4	0.8	565.1
100-yr	32.7	8.3	1.1	565.8

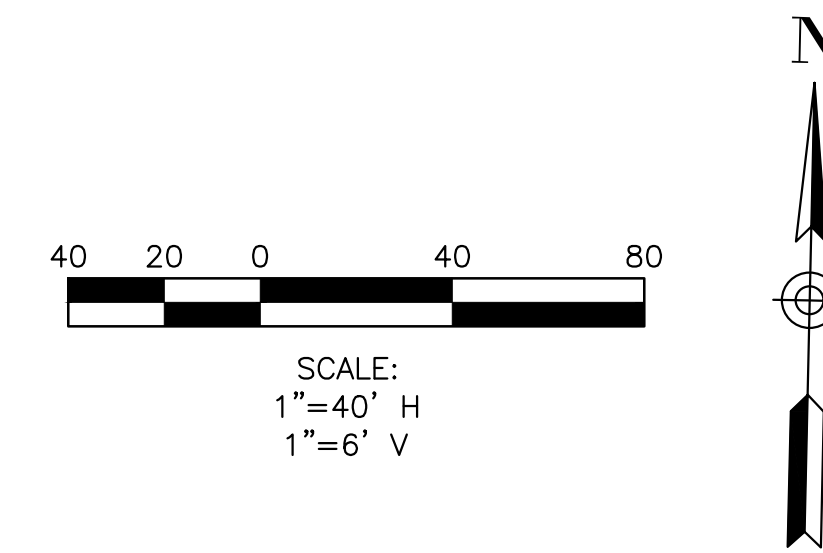
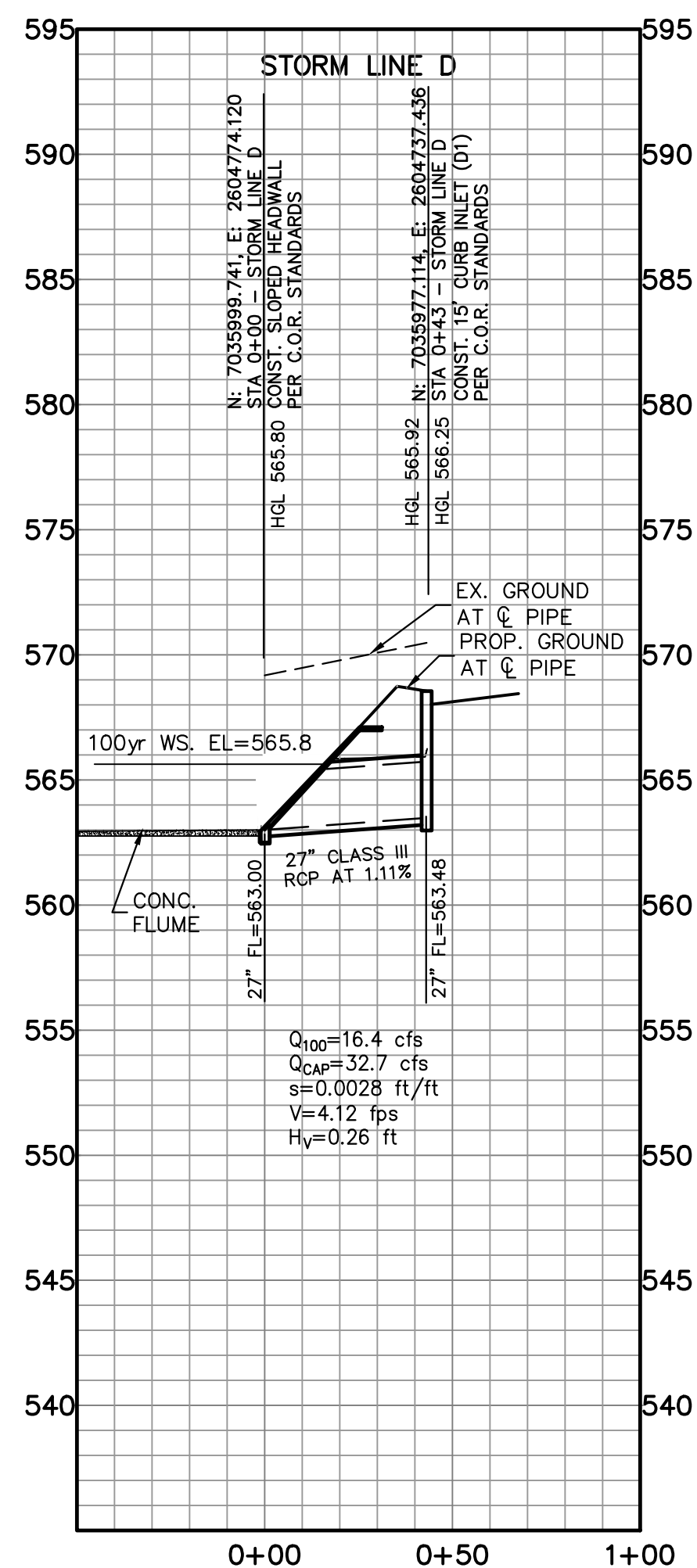
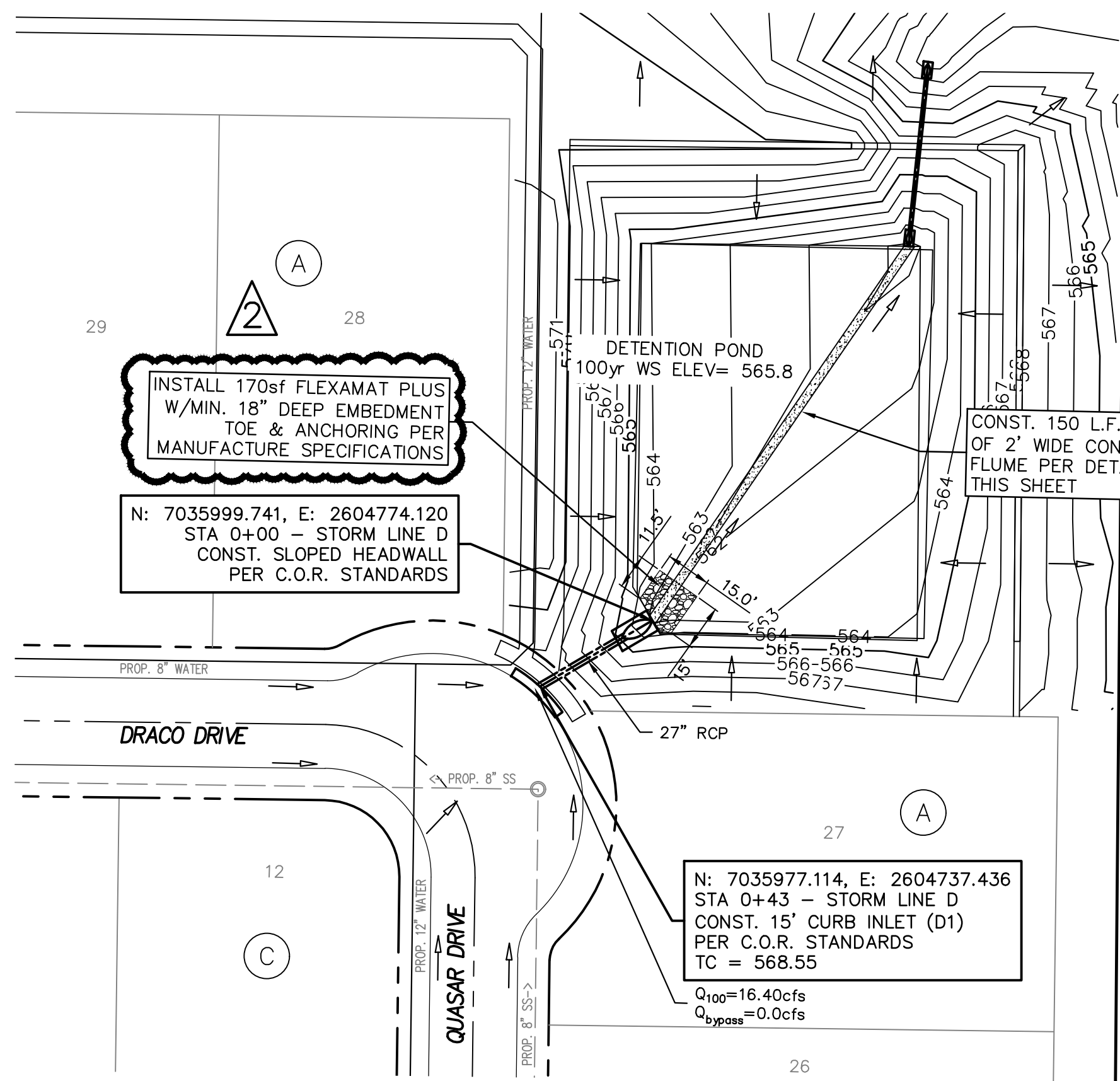

GENERAL NOTES:

- 1) ALL CONSTRUCTION SHALL BE IN ACCORDANCE WITH THE CITY OF ROCKWALL STANDARDS.
- 2) THE CONTRACTOR SHALL VERIFY THE HORIZONTAL AND VERTICAL LOCATIONS OF ALL EXISTING UTILITIES IN THE AREA OF CONSTRUCTION PRIOR TO BEGINNING CONSTRUCTION.
- 3) THE CONTRACTOR SHALL NOTIFY ENGINEER OF RECORD OF ANY DISCREPANCIES BETWEEN THESE PLANS AND ACTUAL FIELD CONDITIONS.
- 4) DIMENSIONS ARE TO BACK OF CURB, UNLESS OTHERWISE NOTED.

SEE THE CITY OF ROCKWALL STANDARDS OF DESIGN AND CONSTRUCTION, DATED OCTOBER 2019 FOR MODIFICATIONS TO NCTCOG DETAILS.

ALL STORM PIPE SHALL BE CLASS III RCP UNLESS OTHERWISE NOTED

LEGEND	
\leftarrow	DIRECTION OF FLOW
TC	TOP OF CURB
FL	FLOW LINE
ϕ	CENTERLINE

RECORD DRAWINGS

The information contained hereon was provided by the contractor based on their field installation. The undersigned registered professional engineer did not provide inspection on this project, and therefore makes no warrants concerning the accuracy or completeness of the information provided.

Dayton C. Macatee

NOVEMBER 29, 2023

Dayton C. Macatee, P.E. - Macatee Engineering, L.L.C. (Tx. Reg. No. F-456)
12655 N. Central Expwy Suite 420, Dallas, Texas 75243 - Tel: 214-373-1180

CITY OF ROCKWALL MONUMENT "COR-2"
ALUMINUM DISK STAMPED "CITY OF ROCKWALL SURVEY MONUMENT" +/- .866'
EAST OF INTERSECTION OF WILLIAMS STREET AND CARUTH LANE, AND 50' SOUTH
OF CL OF WILLIAMS STREET. N: 7029731.124, E: 2598589.314, ELEV=529.10

CITY OF ROCKWALL MONUMENT "COR-4"
ALUMINUM DISK STAMPED "CITY OF ROCKWALL SURVEY MONUMENT" ON NORTH SIDE
OF DALTON ROAD +/- .210' WEST OF INTERSECTION OF SH 205 AND DALTON ROAD,
AND 10' NORTH OF CURB LINE. N: 7040336.992, E: 2592422.633, ELEV=541.67



Dayton C. Macatee
11/29/2023

DAYTON MACATEE
ENGINEERING, LLC
TX. REG. NO. F-456

STORM SEWER PLAN & PROFILE

WINDING CREEK

CITY OF ROCKWALL, ROCKWALL COUNTY, TEXAS

<p>MACATEE CIVIL ENGINEERING</p>	<p>CIVIL ENGINEERING DESIGN & CONSULTING (Tex. Reg. No. F-456) 12655 N. CENTRAL EXPWY, SUITE 420 DALLAS, TEXAS 75243 TEL 214-373-1180 * FAX 214-373-6580 daytonm@macatee-engineering.com phillipf@macatee-engineering.com</p>
	<p>DESIGNED: BCP CHECKED: SDA DATE: 11/29/2023 DWG FILE: WC_STORM PROJECT #: SKO_WC SHEET NO.: 38 OF 53</p>