

- GENERAL NOTES:
- 1) ALL CONSTRUCTION SHALL BE IN ACCORDANCE WITH THE CITY OF ROCKWALL STANDARDS.
 - 2) THE CONTRACTOR SHALL VERIFY THE HORIZONTAL AND VERTICAL LOCATIONS OF ALL EXISTING UTILITIES IN THE AREA OF CONSTRUCTION PRIOR TO BEGINNING CONSTRUCTION.
 - 3) THE CONTRACTOR SHALL NOTIFY ENGINEER OF RECORD OF ANY DISCREPANCIES BETWEEN THESE PLANS AND ACTUAL FIELD CONDITIONS.
 - 4) DIMENSIONS ARE TO BACK OF CURB, UNLESS OTHERWISE NOTED.

SEE THE CITY OF ROCKWALL STANDARDS OF DESIGN AND CONSTRUCTION, DATED OCTOBER 2019 FOR MODIFICATIONS TO NCTCOG DETAILS.

ALL STORM PIPE SHALL BE CLASS III RCP UNLESS OTHERWISE NOTED

Curve Table: STORM LINE					
Curve #	Radius	Length	Chord Direction	Start Point	End Point
C8	500.00	17.47	N89° 43' 29.97"E	(2602527.0963, 7035594.4371)	(2602544.5626, 7035594.5209)

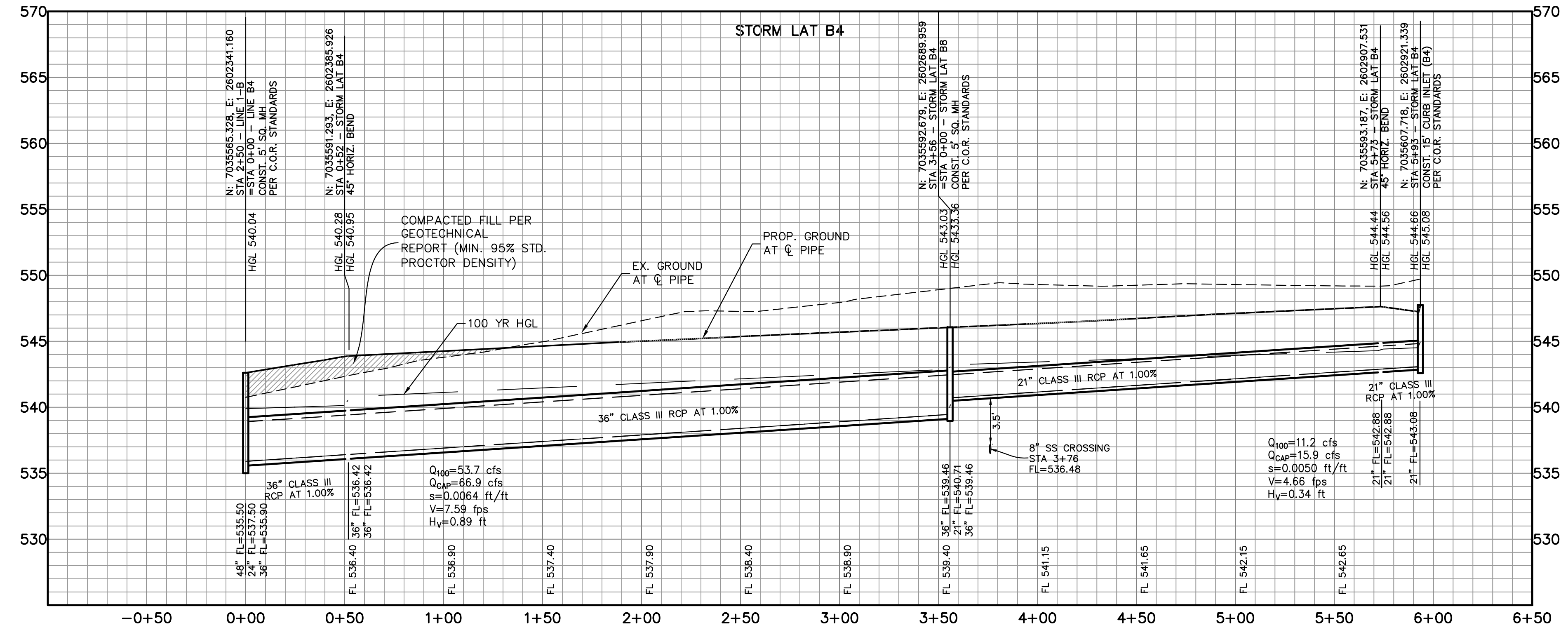
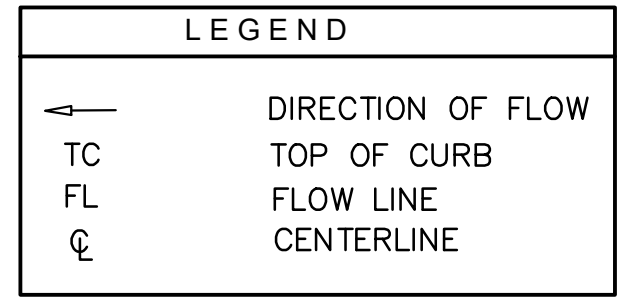

RECORD DRAWINGS
The information contained hereon was provided by the contractor based on their field installation. The undersigned registered professional engineer did not provide inspection on this project, and therefore makes no warrants concerning the accuracy or completeness of the information provided.

Dayton C. Macatee
NOVEMBER 29, 2023

Dayton C. Macatee, P.E. - Macatee Engineering, L.L.C. (Tx. Reg. No. F-456) Date
12655 N. Central Expwy Suite 420, Dallas, Texas 75243 - Tel: 214-373-1180

CITY OF ROCKWALL MONUMENT "COR-2"
ALUMINUM DISK STAMPED "CITY OF ROCKWALL SURVEY MONUMENT" +/- -866'
EAST OF INTERSECTION OF WILLIAMS STREET AND CARUTH LANE, AND 50' SOUTH
OF CL OF WILLIAMS STREET. N: 7029731.124, E: 2598589.314, ELEV=529.10

CITY OF ROCKWALL MONUMENT "COR-4"
ALUMINUM DISK STAMPED "CITY OF ROCKWALL SURVEY MONUMENT" ON NORTH SIDE
OF DALTON ROAD +/- -210' WEST OF INTERSECTION OF SH 205 AND DALTON ROAD,
AND 10' NORTH OF CURB LINE. N: 7040336.992, E: 2592422.633, ELEV=541.67



STORM SEWER PLAN & PROFILE

WINDING CREEK

CITY OF ROCKWALL, ROCKWALL COUNTY, TEXAS



MACATEE
CIVIL ENGINEERING

**CIVIL ENGINEERING
DESIGN & CONSULTING**
(Tex. Reg. No. F-456)
12655 N. CENTRAL EXPWY, SUITE 420
DALLAS, TEXAS 75243
TEL 214-373-1180 * FAX 214-373-6580
daytonm@macatee-engineering.com
phillipj@macatee-engineering.com

DESIGNED	CHECKED	DATE	DWG FILE	PROJECT #	SHEET NO.
BCP	SDA	11/29/2023	wc_STORM	SKO_WC	35 OF 53