

- GENERAL NOTES:
- 1) ALL CONSTRUCTION SHALL BE IN ACCORDANCE WITH THE CITY OF ROCKWALL STANDARDS.
 - 2) THE CONTRACTOR SHALL VERIFY THE HORIZONTAL AND VERTICAL LOCATIONS OF ALL EXISTING UTILITIES IN THE AREA OF CONSTRUCTION PRIOR TO BEGINNING CONSTRUCTION.
 - 3) THE CONTRACTOR SHALL NOTIFY ENGINEER OF RECORD OF ANY DISCREPANCIES BETWEEN THESE PLANS AND ACTUAL FIELD CONDITIONS.
 - 4) DIMENSIONS ARE TO BACK OF CURB, UNLESS OTHERWISE NOTED.

SEE THE CITY OF ROCKWALL STANDARDS OF DESIGN AND CONSTRUCTION, DATED OCTOBER 2019 FOR MODIFICATIONS TO NCTCOG DETAILS.

ALL STORM PIPE SHALL BE CLASS III RCP UNLESS OTHERWISE NOTED

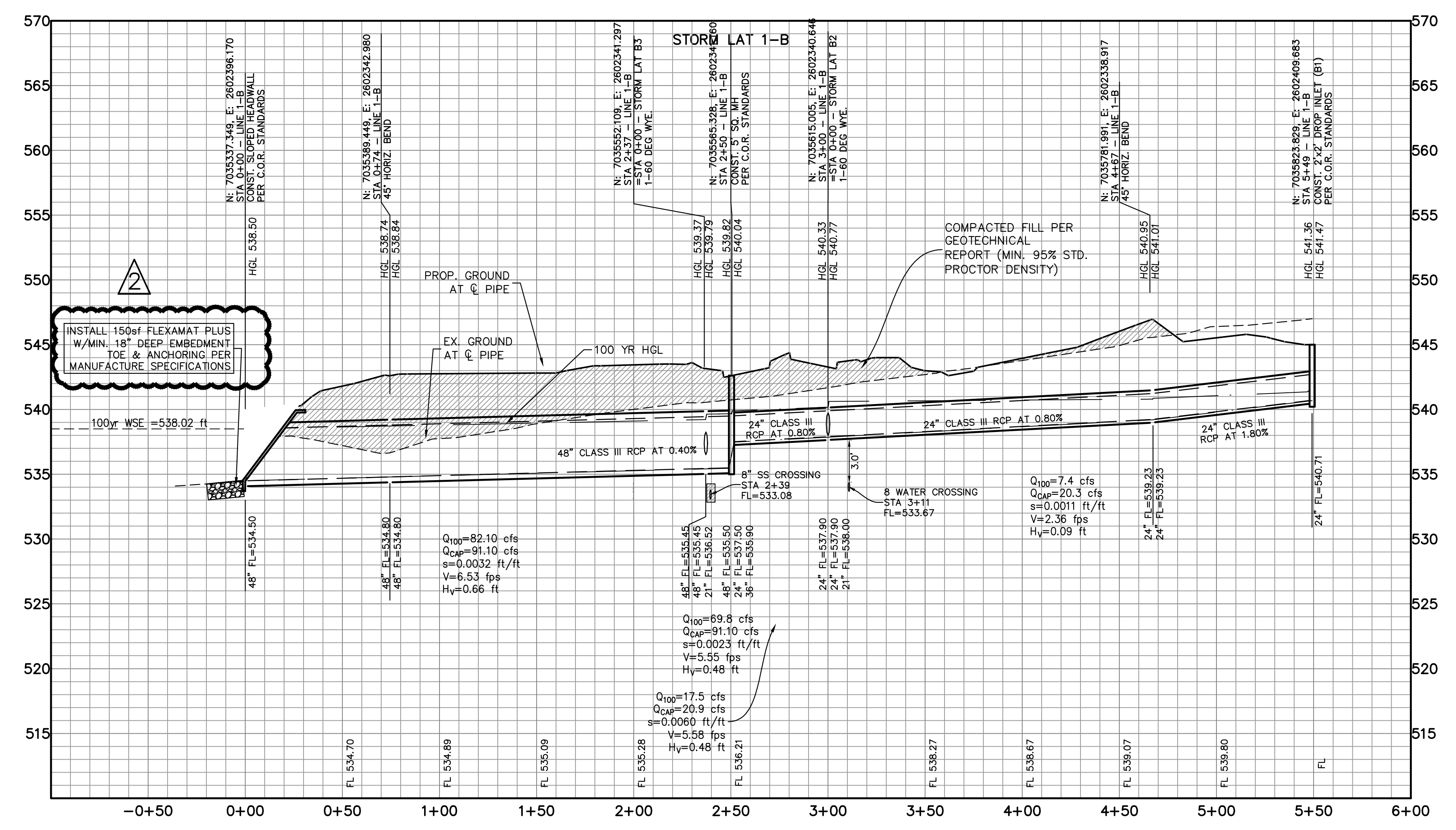
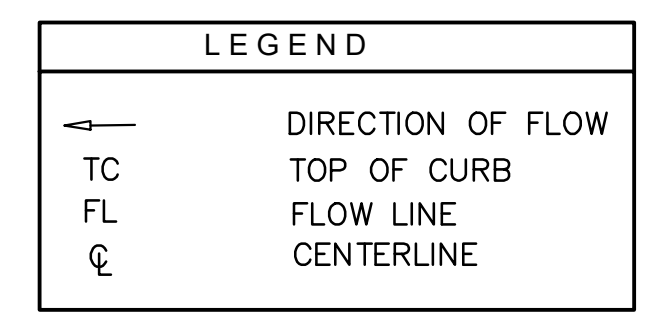

RECORD DRAWINGS
 The information contained hereon was provided by the contractor based on their field installation. The undersigned registered professional engineer did not provide inspection on this project, and therefore makes no warranties concerning the accuracy or completeness of the information provided.

Dayton C. Macatee
 NOVEMBER 29, 2023

Dayton C. Macatee, P.E. - Macatee Engineering, L.L.C. (Tx. Reg. No. F-456) Date
 12655 N. Central Expwy Suite 420, Dallas, Texas 75243 - Tel: 214-373-1180

CITY OF ROCKWALL MONUMENT "COR-2"
 ALUMINUM DISK STAMPED "CITY OF ROCKWALL SURVEY MONUMENT" +/- -866'
 EAST OF INTERSECTION OF WILLIAMS STREET AND CARUTH LANE, AND 50' SOUTH OF CL OF WILLIAMS STREET. N: 7029731.124, E: 2598589.314, ELEV=529.10

CITY OF ROCKWALL MONUMENT "COR-4"
 ALUMINUM DISK STAMPED "CITY OF ROCKWALL SURVEY MONUMENT" ON NORTH SIDE OF DALTON ROAD +/- -210' WEST OF INTERSECTION OF SH 205 AND DALTON ROAD, AND 10' NORTH OF CURB LINE. N: 7040336.992, E: 2592422.633, ELEV=541.67



STORM SEWER PLAN & PROFILE
WINDING CREEK

CITY OF ROCKWALL, ROCKWALL COUNTY, TEXAS

CIVIL ENGINEERING DESIGN & CONSULTING
 (Tex. Reg. No. F-456)
 12655 N. CENTRAL EXPWY, SUITE 420
 DALLAS, TEXAS 75243
 TEL 214-373-1180 * FAX 214-373-6580
 daytonm@macatee-engineering.com
 philipj@macatee-engineering.com

DESIGNED	CHECKED	DATE	DWG FILE	PROJECT #	SHEET NO.
BCP	SDA	11/29/2023	wc_STORM	SKO_WC	34 OF 53