

CONSTRUCTION PLANS FOR WINDING CREEK

LOTS 1-53, BLOCK A LOTS 1-18, BLOCK B LOTS 1-22, BLOCK C LOTS 1-17, BLOCK D LOTS 1-24, BLOCK E CITY OF ROCKWALL ROCKWALL COUNTY, TEXAS

ENGINEER'S NOTES TO CONTRACTOR

1. BY COMMENCING CONSTRUCTION CONTRACTOR AFFIRMS THEY HAVE REVIEWED AND UNDERSTAND THE PLANS AND SPECIFICATIONS. ANY QUESTIONS AND DISCREPANCIES MUST BE ADDRESSED PRIOR TO COMMENCING CONSTRUCTION.

2. ALL CONSTRUCTION SPECIFICATIONS WITHIN CITY ROW AND EASEMENTS SHOULD COMPLY WITH CITY OF ROCKWALL STANDARDS. PRIOR APPROVAL TO USE ANY NON-STANDARD MATERIAL IS REQUIRED.

3. CONTRACTOR MUST VERIFY THE LOCATION OF ALL EXISTING UTILITIES PRIOR TO THE START OF CONSTRUCTION.

4. CONTRACTOR MUST ENSURE THAT ALL AREAS ARE GRADED TO DRAIN.

5. CONTRACTOR MUST NOTIFY ENGINEER OF ANY DISCREPANCIES BETWEEN THESE PLANS & ONSITE CONDITIONS.

PROBABLE START OF CONSTRUCTION: _____

Sheet List Table	
Sheet Number	Sheet Title
1	COVER SHEET
2A-2C	FINAL PLAT
3	CONSTRUCTION GENERAL NOTES
4	OVERALL PAVING PLAN
5	SIDEWALK AND BFR PLAN
6-16	PAVING PLAN AND PROFILES
17	GRADING KEY MAP
18-21	GRADING PLAN
22-24	GRADING DETAILS AND SECTIONS
25	DRAINAGE AREA MAP (PRE-DEVELOPMENT)
26	DRAINAGE AREA MAP (POST-DEVELOPMENT)
27-29	DRAINAGE CALCULATIONS
30-40	STORM SEWER PLAN & PROFILE
41	DETENTION POND # 1 PLAN
42	DETENTION POND # 2 PLAN
43	TxDOT CULVERTS
44	WASTEWATER PLAN
45-49	WASTEWATER PROFILES
50	WATER PLAN
51	12" WATER LINE A PROFILE
52	EROSION CONTROL PLAN
53	STREET LIGHT AND SIGNAGE PLAN
TxDOT GF (31)	METAL BEAM GUARD FENCE DETAIL
DTLS 1-7	CONSTRUCTION DETAILS
L1.00-L1.15	LANDSCAPE PLANS
L2.00-L2.02	LANDSCAPE DETAILS & NOTES
L3.00, L1.1	TREESCAPE & MITIGATION PLAN

OWNER/DEVELOPER:

FALCON PLACE SF, LTD.
8214 WESTCHESTER DRIVE
SUITE 710
DALLAS, TX 75225
PHONE: 214-522-4945
CONTACT: JOHN ARNOLD

ENGINEER:



CIVIL ENGINEERING
DESIGN & CONSULTING
(Tex. Reg. No. F-456)
12655 N. CENTRAL EXPWY, SUITE 420
DALLAS, TEXAS 75243
TEL 214-373-1180 * FAX 214-373-6580
daytonm@macatee-engineering.com
phillipf@macatee-engineering.com

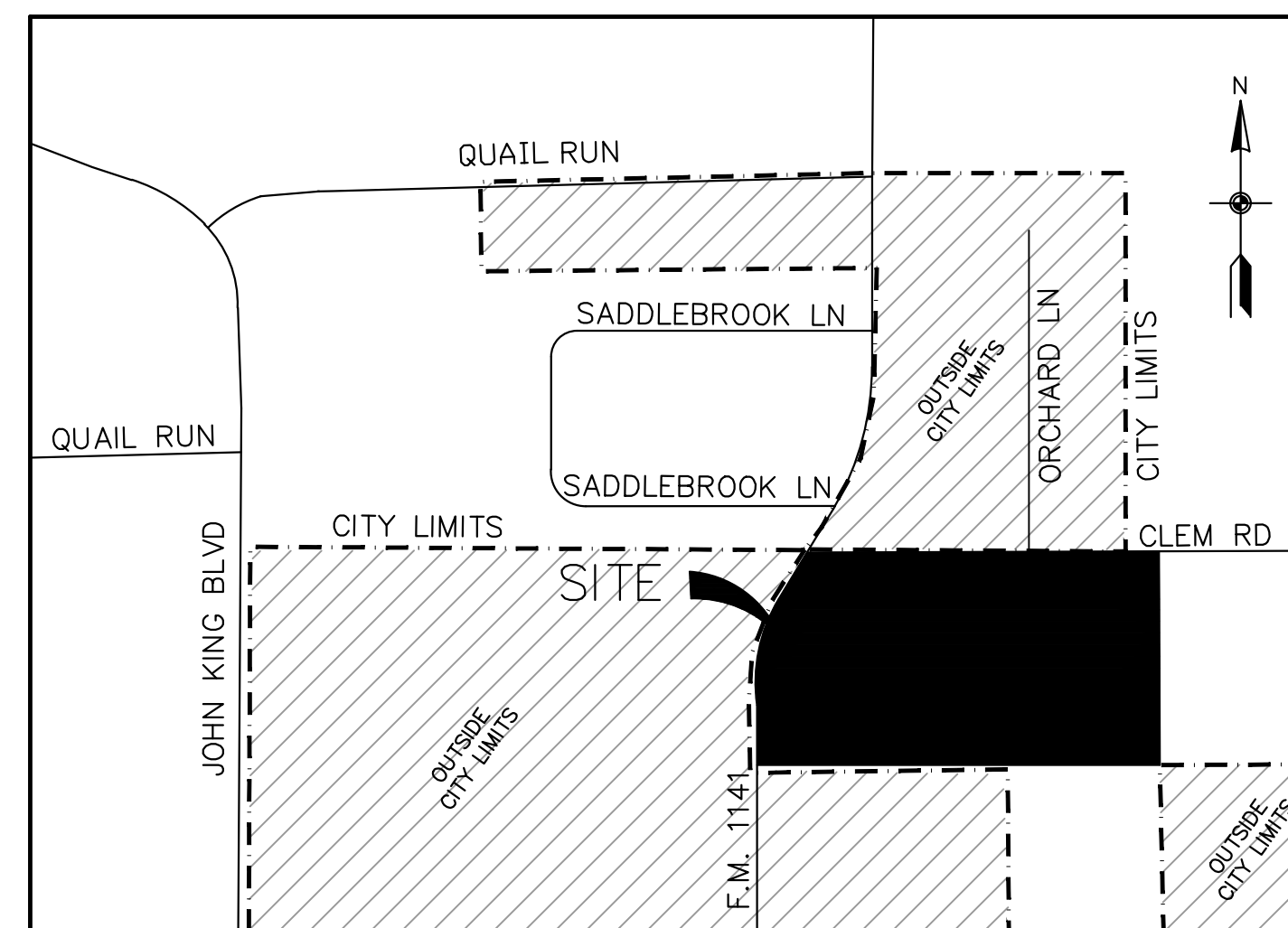

LOCATION MAP

NOT TO SCALE
MAPSCO: 20D-A

DATE: 11/29/2023

WITHIN THIS PLAN SET THE TERM "CITY OF ROCKWALL STANDARDS" IS MEANT TO INCLUDE THE CITY OF ROCKWALL STANDARDS OF DESIGN AND CONSTRUCTION MANUAL, DATED OCTOBER 2019 AND THE PUBLIC WORKS CONSTRUCTION STANDARDS AND SPECIFICATIONS, NORTH CENTRAL TEXAS, 5TH EDITION, DATED NOVEMBER 2017 - PUBLISHED BY NORTH CENTRAL TEXAS COUNCIL OF GOVERNMENTS. CONTRACTOR SHALL REFER TO BOTH MANUALS PRIOR TO BEGINNING CONSTRUCTION.



RECORD DRAWINGS

The information contained hereon was provided by the contractor based on their field installation. The undersigned registered professional engineer did not provide inspection on this project, and therefore makes no warrants concerning the accuracy or completeness of the information provided.

Dayton C. Macatee

NOVEMBER 29, 2023

Dayton C. Macatee, P.E. - Macatee Engineering, L.L.C. (Tx. Reg. No. F-456)
12655 N. Central Expwy Suite 420, Dallas, Texas 75243 - Tel: 214-373-1180

CITY OF ROCKWALL MONUMENT "COR-2"
ALUMINUM DISK STAMPED "CITY OF ROCKWALL SURVEY MONUMENT" +/- .866'
EAST OF INTERSECTION OF WILLIAMS STREET AND CARUTH LANE, AND 50' SOUTH
OF CL OF WILLIAMS STREET. N: 7029731.124, E: 2598589.314, ELEV=529.10

CITY OF ROCKWALL MONUMENT "COR-4"
ALUMINUM DISK STAMPED "CITY OF ROCKWALL SURVEY MONUMENT" ON NORTH SIDE
OF DALTON ROAD +/- .210' WEST OF INTERSECTION OF SH 205 AND DALTON ROAD,
AND 10' NORTH OF CURB LINE. N: 7040336.992, E: 2592422.633, ELEV=541.67

ALL RESPONSIBILITY FOR ADEQUACY OF DESIGN REMAINS WITH THE DESIGN ENGINEER. THE CITY OF ROCKWALL, IN REVIEWING AND RELEASING PLANS FOR CONSTRUCTION, ASSUMES NO RESPONSIBILITY FOR ADEQUACY OR ACCURACY OF DESIGN

REVISION TABLE			
REV.	BY	DATE	DESCRIPTION