

WILKINSON COMMONS RETAINING WALLS LA JOLLA POINTE DRIVE AND I-30 ROCKWALL, TEXAS.

WALL DESIGN SHOULD BE REVIEWED BY THE
GEOTECHNICAL ENGINEER TO ADDRESS GLOBAL
STABILITY.

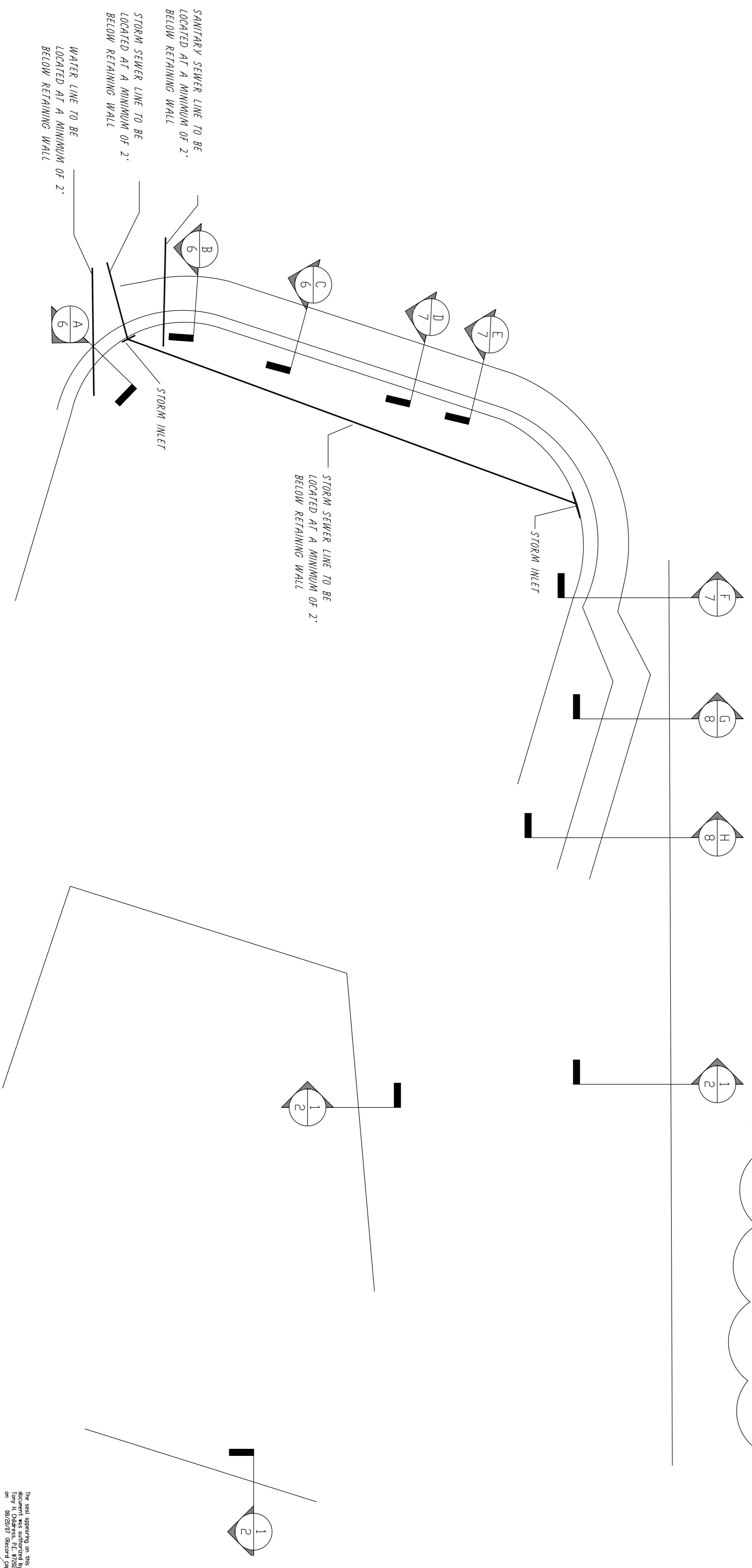

The seal appearing on this drawing is the property of Childress Engineering Services, Inc. and is not to be reproduced or used in any manner without the written consent of Childress Engineering Services, Inc. on 08/17/07 (record copy on file)

This document may not be changed without the written consent of Childress Engineering Services, Inc. from Tony H. Childress, P.E.

<p>PROJECT NO: WILKINSON COMMONS LA JOLLA POINTE DRIVE AND I-30 ROCKWALL, TEXAS RETAINING WALLS</p>	 Childress Engineering Services, Inc. 2505 North Plano Road, Suite 1200 Richardson, Texas 75082 Office:(214) 451-6630 Fax:(214) 451-6631 CESGLOBAL.COM	<p>MANUAL COMP</p> <table border="1" style="width: 100%; border-collapse: collapse;"> <tr> <td>1</td> <td>THC</td> <td>08/17/07</td> <td>REVISED WALL DESIGNS</td> </tr> <tr> <td>REV</td> <td>BY</td> <td>DATE</td> <td>DESCRIPTION</td> </tr> </table>	1	THC	08/17/07	REVISED WALL DESIGNS	REV	BY	DATE	DESCRIPTION	
1	THC	08/17/07	REVISED WALL DESIGNS								
REV	BY	DATE	DESCRIPTION								
<p>SCALE: 1/4" = 1'-0"</p> <p>DRAWING NO.:</p> <p>SHEET: 1 of 8</p>	<p>DATE: 08-04-07</p>										