

LEGEND

- 5' 3600 PSI CONCRETE
- 6' 4000 PSI CONCRETE
- 5' CONCRETE SIDEWALK
- REMOVE EXISTING PAVEMENT AND REPLACE
- BARRIER FREE RAMP
- FIRELANE

* FIRE LANE TO BE STRIPED PER FIRE DEPARTMENT DETAIL.

REVISIONS:
 CURB TRANSITIONS AND PAVEMENT WIDTHS WERE MODIFIED TO PROVIDE PROTECTION FOR AN EXISTING FIREHYDRANT.
 9-13-05

DESIGN CONTROL POINTS

DCP	NORTHING	EASTING	DESCRIPTION	DCP	NORTHING	EASTING	DESCRIPTION
I4000	7024722.70	2597621.71	BC-PC	I4087	7024630.63	2597972.77	BC
I4001	7024761.53	2597660.47	BC-PT	I4088	7024622.21	2597940.42	BC-PC
I4002	7024783.52	2597649.97	BC-PC	I4089	7024620.69	2597936.94	BC-PT
I4003	7024737.14	2597676.03	BC-PT	I4090	7024620.41	2597922.63	BC
I4004	7024739.67	2597677.60	BC-PC	I4091	7024463.24	2597926.33	FACE INLET
I4005	7024739.97	2597693.99	BC	I4092	7024440.24	2597928.30	BC
I4006	7024764.96	2597692.95	BC	I4093	7024439.85	2597946.32	BC-PC
I4007	7024784.66	2597676.50	BC-PC	I4094	7024438.39	2597947.86	BC-PT
I4008	7024786.21	2597674.98	BC-PC	I4095	7024585.39	2597982.59	BC
I4009	7024823.34	2597910.53	BC-PC	I4096	7024424.15	2597912.18	BC
I4010	7024821.87	2597912.14	BC-PT	I4097	7024441.14	2597911.80	BC-PC
I4011	7024745.99	2597939.94	COR-SW	I4098	7024442.68	2597913.27	BC-PT
I4012	7024905.44	2597912.44	BC	I4099	7024442.72	2597915.37	BC-PC
I4013	7024800.44	2597912.55	COR-SW	I4100	7024441.36	2597916.80	BC-PT
I4014	7024800.89	2597957.70	COR-SW	I4101	7024439.81	2597916.83	BC-PC
I4015	7024785.07	2597997.95	COR-SW	I4102	7024410.41	2597902.69	BC & SW
I4016	7024745.08	2597989.86	COR-SW	I4103	7024406.26	2597894.23	BC & SW
I4017	7024739.09	2597899.35	COR-SW	I4104	7024402.40	2597877.27	BC-PT
I4018	7024740.20	2597939.07	COR-SW	I4105	7024416.24	2598236.68	COR-SW
I4019	7024710.76	2597939.74	COR-SW	I4106	7024416.33	2598243.68	COR-SW
I4020	7024710.86	2597944.74	COR-SW	I4107	7024430.73	2598090.10	COR-SW
I4021	7024800.99	2597942.88	COR-SW	I4108	7024467.89	2598237.31	COR-SW
I4022	7024801.92	2597994.51	COR-SW	I4109	7024467.99	2598242.31	COR-SW
I4023	7024806.92	2597994.42	BC	I4110	7024449.73	2598079.66	COR-SW
I4024	7024848.44	2597912.06	BC-PT	I4111	7024449.61	2598074.66	COR-SW
I4025	7024823.81	2597994.12	BC-PC	I4112	7024425.62	2598075.22	COR-SW
I4026	7024825.34	2597995.58	BC-PT	I4113	7024556.67	2598243.49	COR-PAV
I4027	7024827.85	2598099.51	BC-PC	I4114	7024556.50	2598235.49	COR-PAV
I4028	7024830.40	2598105.49	BC-PT	I4115	7024468.11	2598247.81	COR-PAV
I4029	7024834.36	2598110.68	BC-PC	I4116	7024465.11	2598247.91	COR-PAV
I4030	7024836.95	2598116.99	BC-PT	I4117	7024443.35	2598242.84	COR-SW
I4031	7024855.76	2598245.70	BC-PC	I4118	7024443.80	2598266.07	COR-SW
I4032	7024859.32	2598249.12	BC-PT	I4119	7024465.85	2598282.48	COR-PAV
I4033	7024839.76	2598245.12	BC-PC	I4120	7024449.86	2598282.79	COR-PAV
I4034	7024834.94	2598383.57	BC	I4121	7024433.80	2598268.07	COR-SW
I4035	7024633.12	2598363.68	BC-PC	I4122	7024433.35	2598243.17	COR-SW
I4036	7024634.66	2598365.15	BC-PT	I4123	7024415.41	2598075.50	COR-SW
I4037	7024626.97	2598563.82	BC-PC	I4124	7024415.90	2598090.50	COR-SW
I4038	7024625.50	2598565.34	BC-PT	I4125	7024420.73	2598090.33	COR-SW
I4039	7024625.79	2598563.71	BC	I4126	7024431.38	2598108.09	COR-SW
I4040	7024472.30	2598365.63	BC	I4127	7024421.38	2598108.32	COR-SW
I4041	7024471.52	2598367.69	BC-PC	I4128	7024593.43	2598021.94	COR-SW/BC
I4042	7024470.00	2598366.22	BC-PT	I4129	7024588.43	2598022.20	COR-SW
I4043	7024448.65	2598366.50	BC-PC	I4130	7024593.85	2598041.94	COR-SW
I4044	7024410.35	2598405.61	BC-PT	I4131	7024601.84	2598041.78	COR-SW
I4045	7024408.68	2598292.68	BC-PC	I4132	7024589.16	2598057.04	COR-SW
I4046	7024447.68	2598330.51	BC-PT	I4133	7024601.96	2598047.44	COR-SW
I4047	7024450.60	2598330.46	BC	I4134	7024604.73	2598056.72	COR-SW
I4048	7024417.81	2598317.45	BC & SW	I4135	7024604.64	2598052.39	COR-SW
I4049	7024418.48	2598309.82	BC & SW	I4136	7024609.91	2598056.82	COR-SW
I4050	7024418.52	2598308.48	BC & SW	I4137	7024614.91	2598056.51	COR-SW
I4051	7024418.62	2598308.26	BC & SW	I4138	7024614.82	2598052.18	COR-SW
I4052	7024403.50	2597961.97	BC-PC	I4139	7024609.82	2598052.28	COR-SW
I4053	7024406.49	2597964.73	BC & SW	I4140	7024656.77	2598051.31	COR-SW
I4054	7024411.35	2597956.92	BC & SW	I4141	7024656.86	2598055.64	COR-SW
I4055	7024411.16	2597942.81	BC-PT	I4142	7024663.84	2598055.51	COR-SW
I4056	7024442.04	2597942.79	BC-PC	I4143	7024663.45	2598046.18	COR-SW
I4057	7024443.58	2597944.26	BC-PT	I4144	7024685.87	2597945.26	COR-SW
I4058	7024443.66	2597946.23	BC-PC	I4145	7024680.87	2597945.36	COR-SW
I4059	7024442.19	2597949.76	BC-PT	I4146	7024681.21	2597961.86	COR-SW
I4060	7024424.93	2597950.14	BC	I4147	7024686.10	2597956.75	COR-SW
I4061	7024426.07	2598005.12	BC	I4148	7024691.21	2597961.65	COR-SW
I4062	7024442.50	2598004.76	BC-PC	I4149	7024691.10	2597956.65	COR-SW
I4063	7024444.03	2598006.23	BC-PT	I4150	7024711.10	2597956.24	COR-SW
I4064	7024444.43	2598025.32	BC	I4151	7024711.20	2597961.24	COR-SW
I4065	7024485.09	2597979.59	BC-PC	I4152	7024716.10	2597956.13	COR-SW
I4066	7024483.55	2597978.14	BC-PT	I4153	7024721.20	2597961.03	COR-SW
I4067	7024483.52	2597977.14	BC-PC	I4154	7024720.86	2597944.53	COR-SW
I4068	7024484.97	2597975.60	BC-PT	I4155	7024715.86	2597944.64	COR-SW
I4069	7024602.49	2597975.04	BC	I4156	7024595.18	2598242.76	COR-CONC
I4070	7024602.58	2597979.04	BC	I4157	7024492.93	2598304.89	TOP-INLET
I4071	7024587.35	2597975.24	BC-PC	I4158	7024561.40	2598022.67	BC
I4072	7024585.83	2597973.77	BC-PT	I4159	7024561.14	2598010.00	BC-PC
I4073	7024568.30	2597974.00	BC	I4160	7024553.40	2598022.85	BC
I4074	7024568.38	2597977.50	BC	I4161	7024553.14	2598010.17	BC-PT
I4075	7024585.88	2597977.27	BC-PC	I4162	7024550.36	2598004.45	COR-SAW
I4076	7024587.36	2597975.74	BC-PT	I4163	7024826.40	2598004.95	COR-SAW
I4077	7024607.38	2598021.62	BC	I4164	7024824.34	2597907.06	COR-CONC
I4078	7024607.04	2598004.90	BC-PC	I4165	7024498.62	2597907.60	COR-CONC
I4079	7024608.51	2598003.37	BC-PT	I4166	7024647.77	2597879.04	PT-CONC
I4080	7024632.71	2598002.87	BC	I4167	7024498.82	2597907.50	PC-CONC
I4081	7024589.24	2597875.60	BC-PC	I4168	7024589.57	2597871.88	COR-CONC
I4082	7024583.71	2597874.12	BC-PT	I4169	7024589.54	2597873.17	COR-CONC
I4083	7024566.21	2597874.52	BC				
I4084	7024566.39	2597884.52	BC				
I4085	7024583.92	2597884.12	BC-PC				
I4086	7024585.39	2597882.59	BC-PT				

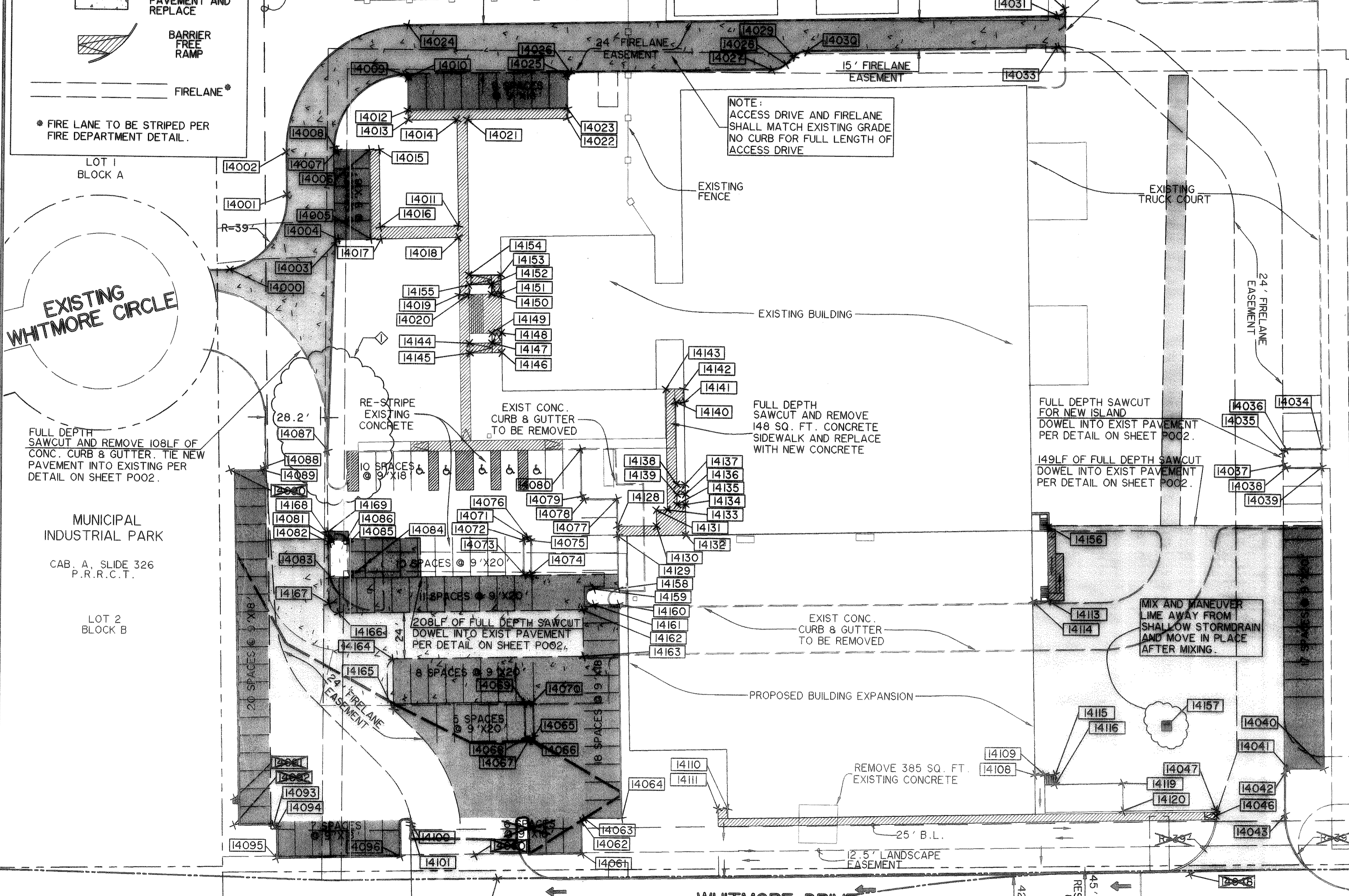

WHITMORE DRIVE

NOTE: DCP THAT ARE NOT INDICATED REPRESENT POINTS THAT WERE NOT ESTABLISHED BY DESIGN, BUT BY FIELD CHANGE

NOTE: SEE SHEET P102 FOR PLAN AND PROFILE

RECORD DRAWING
 03/13/07

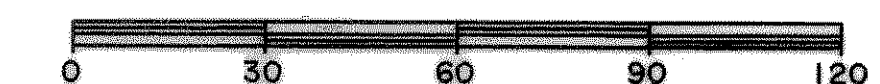

PREPARED BY:
WIA WIER & ASSOCIATES, INC.
 ENGINEERS SURVEYORS LAND PLANNERS
 4300 BELTWAY PLACE SUITE 130 ARLINGTON, TEXAS 76010 METRO (817) 467-7700
 1380 U.S. HIGHWAY 287 N. SUITE 101 WAXSFIELD, TEXAS 76093 METRO (817) 477-8700
 6046 ELM STREET FRODO, TEXAS 75004 METRO (214) 987-8000
 www.wierassociates.com



CITY OF
ROCKWALL
 WHITMORE'S
 EXPANSION

DIMENSION CONTROL AND PAVING PLAN

STATE OF TEXAS
 RONALD RAMIREZ
 81821
 REGISTERED PROFESSIONAL ENGINEER
 Copyright © WIER & ASSOCIATES, INC.
 LAST SHEET EDIT DATE 03/13/2007
 WA# 04124.02
SHEET NO. P101