

TIME: 14.01 FILE: SD_2-04124_02.dwg

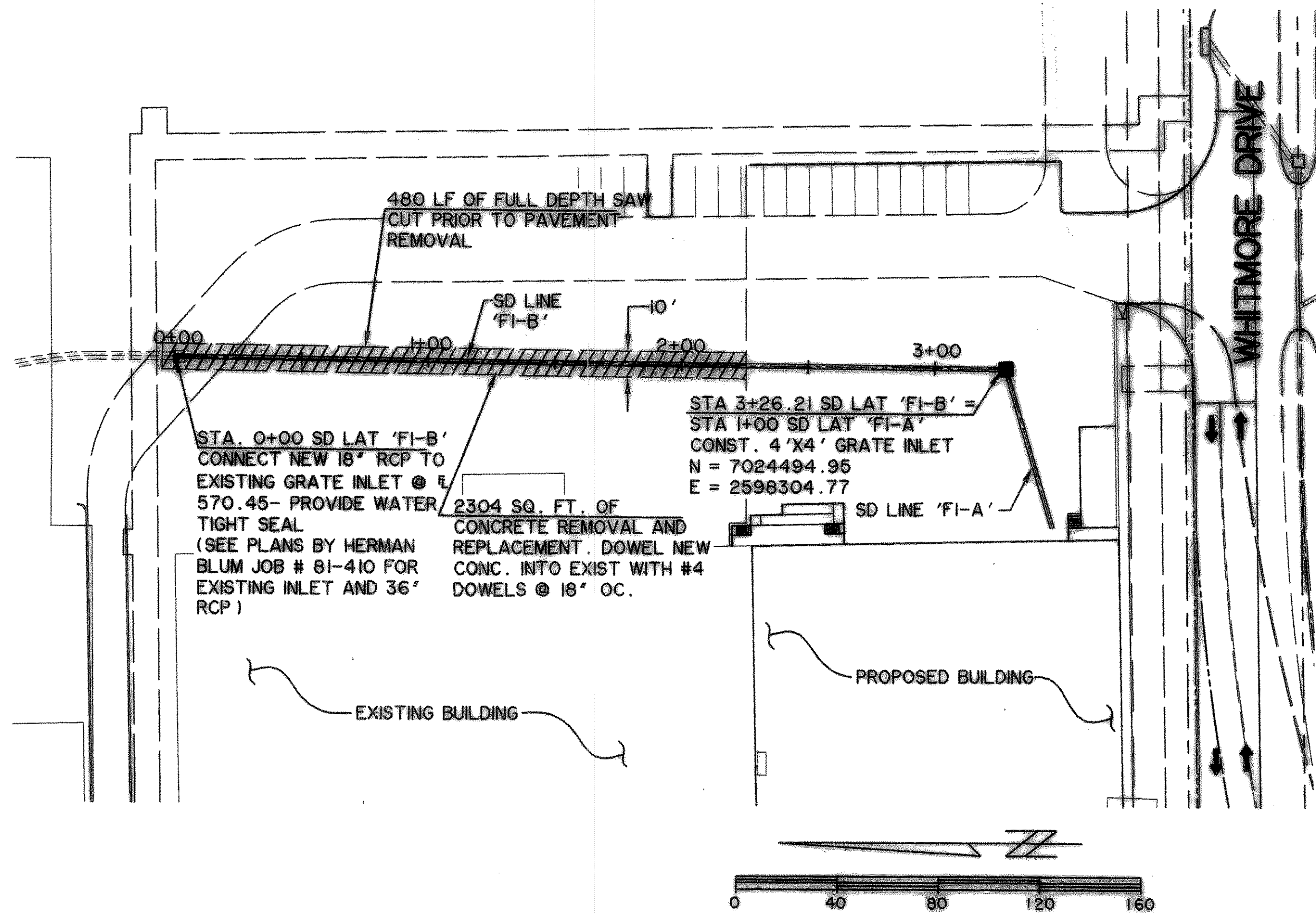

LINE 'F1-B'

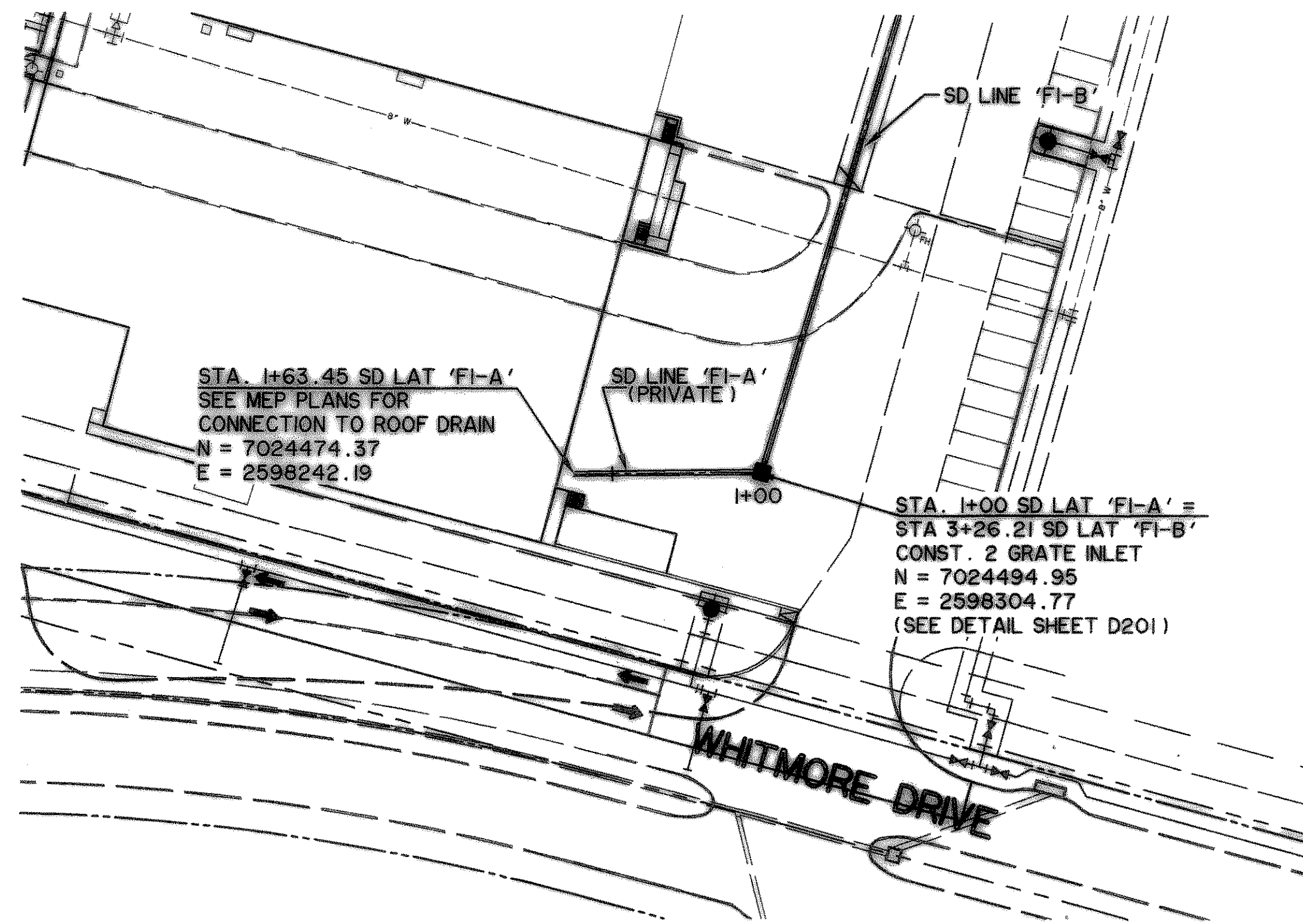
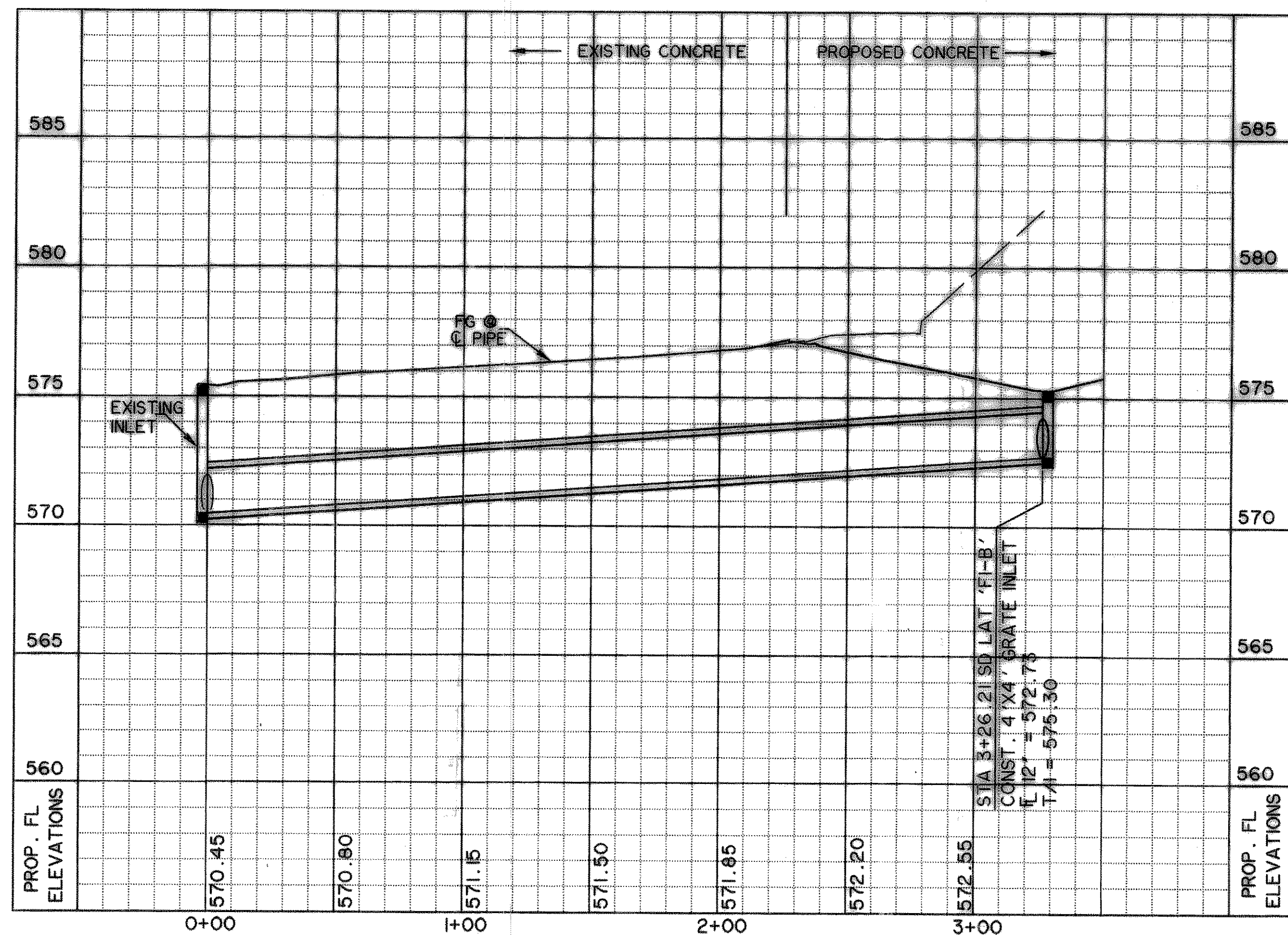

LINE 'F1-A' (PRIVATE)

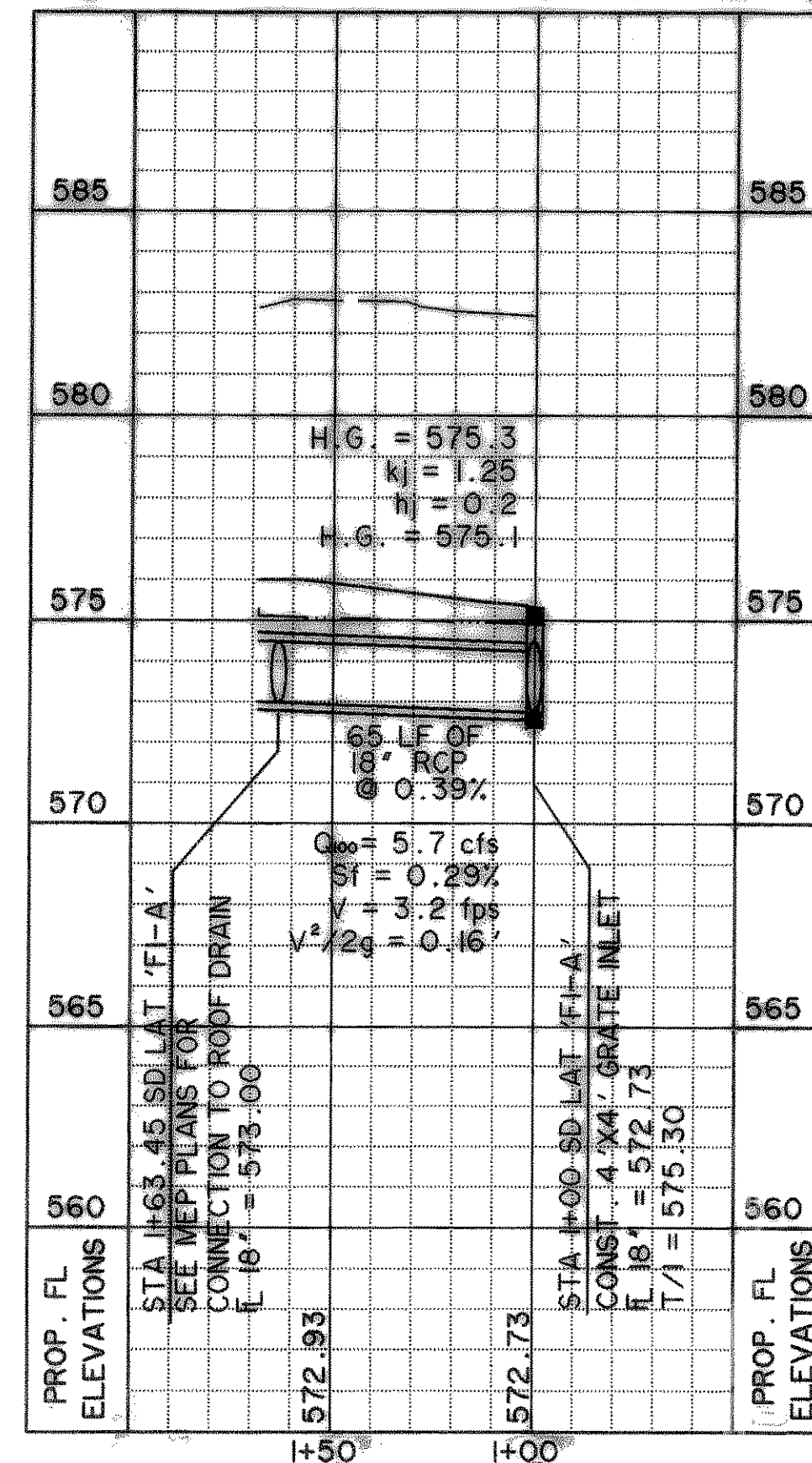

BENCHMARKS:

□ CUT IN THE INLET LOCATED AT THE SOUTHWEST CORNER OF THE PARKING LOT, SOUTH OF THE ENTRANCE.
ELEVATION 573.73

□ CUT IN THE CURB LOCATED AT THE SOUTHEAST CORNER OF THE TRUCK ENTRANCE, OPPOSITE OF THE FIRE HYDRANT.
ELEVATION 577.73

RECORD DRAWING
03/13/07

CAUTION !!!
UNDERGROUND UTILITIES

EXISTING UTILITIES AND UNDERGROUND FACILITIES INDICATED ON THESE PLANS HAVE BEEN LOCATED FROM REFERENCE INFORMATION SUPPLIED BY VARIOUS OWNERS OF THE FACILITIES. THE ENGINEER DOES NOT ACCEPT THE RESPONSIBILITY FOR THE UTILITY LOCATIONS SHOWN. IT SHALL BE THE RESPONSIBILITY OF THE CONTRACTOR TO VERIFY BOTH HORIZONTALLY AND VERTICALLY THE LOCATION OF ALL EXISTING UTILITIES AND UNDERGROUND FACILITIES PRIOR TO CONSTRUCTION. TO TAKE NECESSARY PRECAUTIONS IN ORDER TO PROTECT ALL FACILITIES ENCOUNTERED, AND TO NOTIFY THE ENGINEER PROMPTLY OF ALL CONFLICTS OF THE WORK WITH EXISTING FACILITIES. THE CONTRACTOR SHALL PRESERVE AND PROTECT ALL EXISTING UTILITIES FROM DAMAGE DURING CONSTRUCTION. ANY DAMAGE BY THE CONTRACTOR TO EXISTING UTILITIES SHALL BE REPAIRED BY THE CONTRACTOR AT HIS EXPENSE.

PREPARED BY:
VIA WIER & ASSOCIATES, INC.
ENGINEERS SURVEYORS LAND PLANNERS
4300 BELTWAY PLACE SUITE 130 ARLINGTON, TEXAS 76018 METRO (817)467-7700
1380 U.S. HIGHWAY 287 N. SUITE 101 WANSFELD, TEXAS 76683 METRO (817)477-8700
6849 ELM STREET FRODO, TEXAS 75234 METRO (214)387-8000
www.via-wier.com

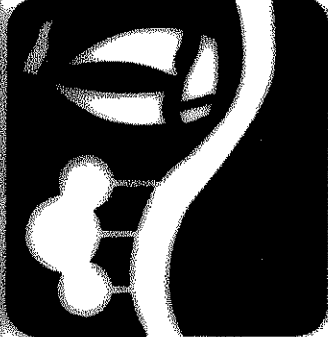

CITY OF
ROCKWALL
WHITMORE'S
EXPANSION

STORM DRAIN
PLAN & PROFILE
LINES 'F1' AND 'D1-B'

STATE OF TEXAS
REGISTERED PROFESSIONAL ENGINEER
RONALD RAMIREZ
91821

Ronald Ramirez

COPYRIGHT ©
VIA WIER & ASSOCIATES, INC.
LAST SHEET EDIT
DATE 03/13/2007
WA# 04124.02

SHEET NO.
D101