

# CITY OF ROCKWALL, TEXAS

## CONSTRUCTION PLANS

### FOR

## PAVING, DRAINAGE & WATER IMPROVEMENTS

### TO SERVE

# WHITMORE'S EXPANSION

**KEN JONES - MAYOR**

**COUNCIL MEMBERS:**

**TIM McCALLUM - Mayor Pro Tem**

**BOB COTTI**

**STEPHEN STRAUGHAN**

**JOHN KING**

**TERRY RAULSTON**

**BILL CECIL**

**JULIE COUCH - City Manager**

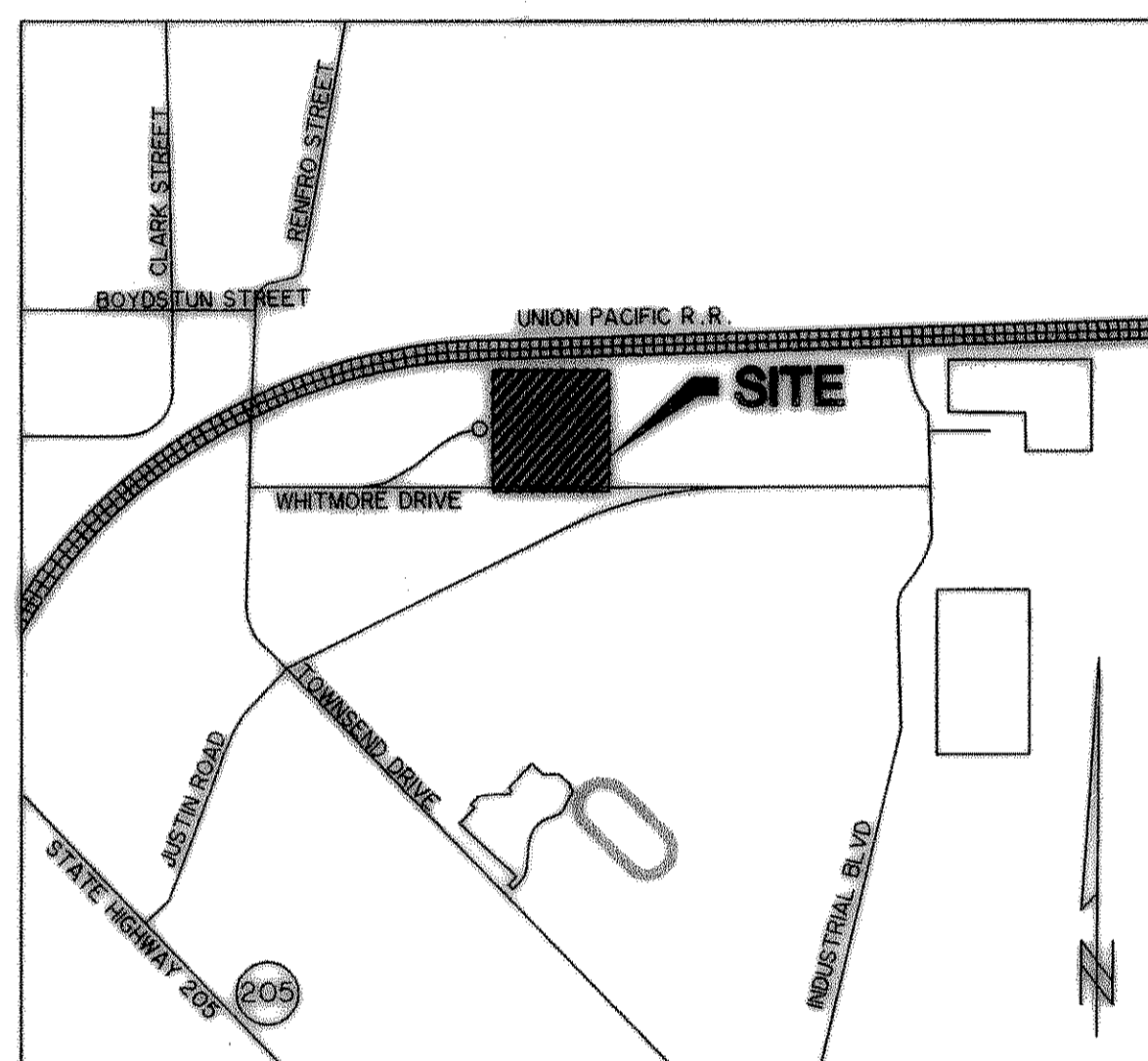

VICINITY MAP  
N.T.S.

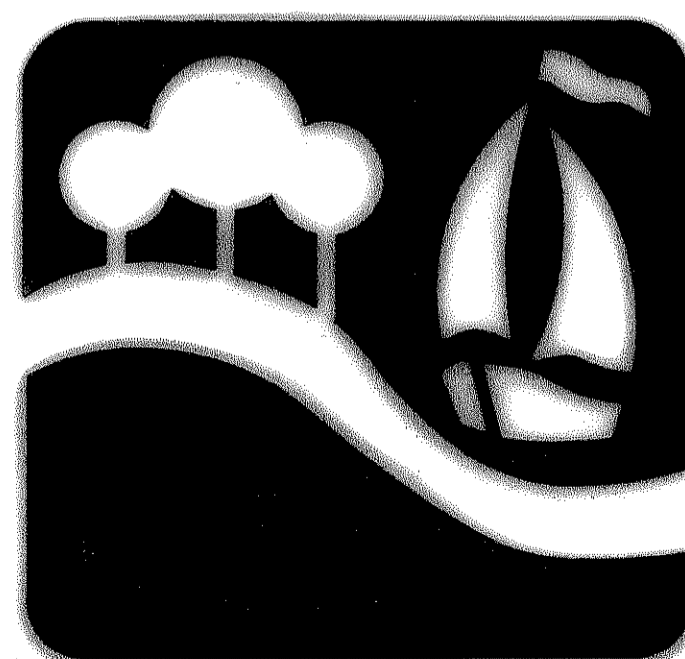

"THE NEW HORIZON"

### INDEX OF DRAWINGS

A100	COVER SHEET	
<del>A101</del>	<del>AMENDED REPLAT SHEET 1</del>	} NOT INCLUDED IN RECORD DRAWINGS
<del>A102</del>	<del>AMENDED REPLAT SHEET 2</del>	
A201	GENERAL NOTES	
P001	TYPICAL SECTION	
P002	PAVING DETAILS	
P003	HANDICAP RAMP DETAILS	
P004	TxDOT WORK ZONE DEAD END ROADWAY DETAILS	
P101	DIMENSIONAL CONTROL AND PAVING PLAN	
P102	PAVING PLAN AND PROFILE	
G001	GRADING PLAN	
G002	GRADING PLAN	
D001	DRAINAGE AREA MAP	
D002	STORM DRAIN CALCULATIONS	
D101	STORM DRAIN PLAN AND PROFILE	
D102	STORM DRAIN PLAN AND PROFILE	
D201	STORM DRAIN DETAILS	
D203	RETENTION ANALYSIS	
U101	WATER AND SANITARY SEWER PLAN	
U102	WATER LINE 'A' PROFILE	
<del>E001</del>	<del>EROSION CONTROL NOTES</del>	} NOT INCLUDED IN RECORD DRAWINGS
<del>E002</del>	<del>EROSION CONTROL NOTES</del>	
<del>E003</del>	<del>EROSION CONTROL NOTES</del>	
<del>E101</del>	<del>EROSION CONTROL PLAN</del>	
<del>E201</del>	<del>EROSION CONTROL DETAILS</del>	

**RECORD  
DRAWING**  
03/13/07



*Ronald Ramirez*  
3/15/07

JULY 2005