

CONSTRUCTION PLANS
FOR

WATERSTONE ESTATES

PHASE I & II (GRADING)

PHASE I (PAVING, DRAINAGE & UTILITIES)

CITY OF ROCKWALL, ROCKWALL COUNTY, TEXAS

OCTOBER 1994

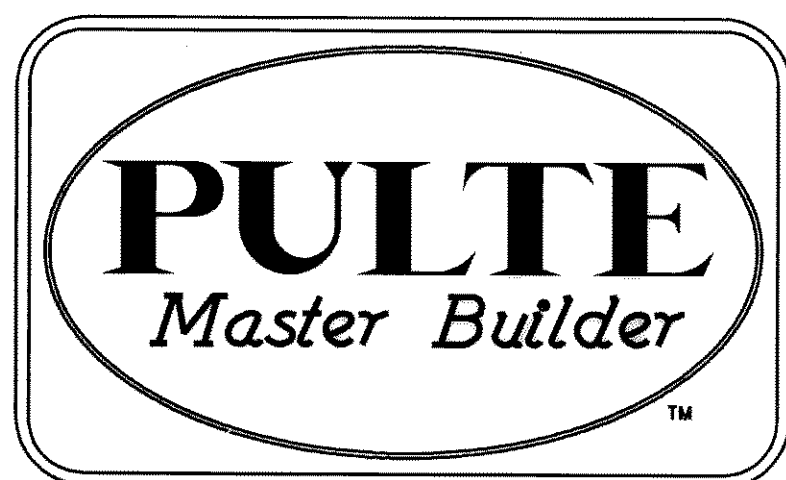
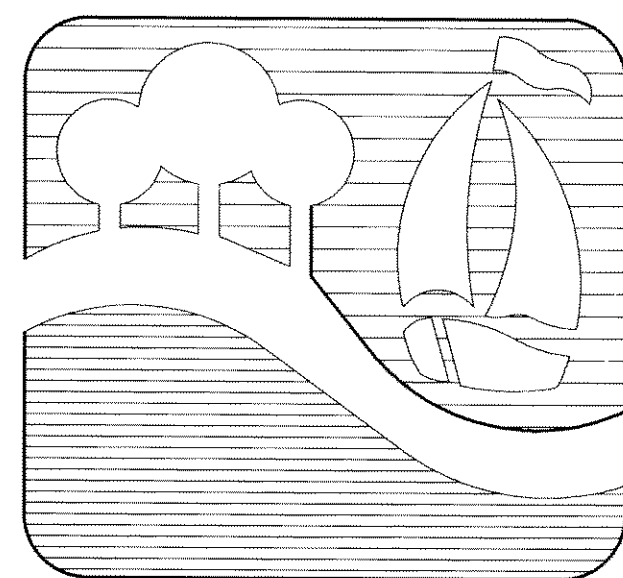

OWNER \ DEVELOPER:
PULTE HOME CORPORATION OF TEXAS
1431 GREENWAY DRIVE, SUITE 700
IRVING, TEXAS 75038
(214) 518-0177

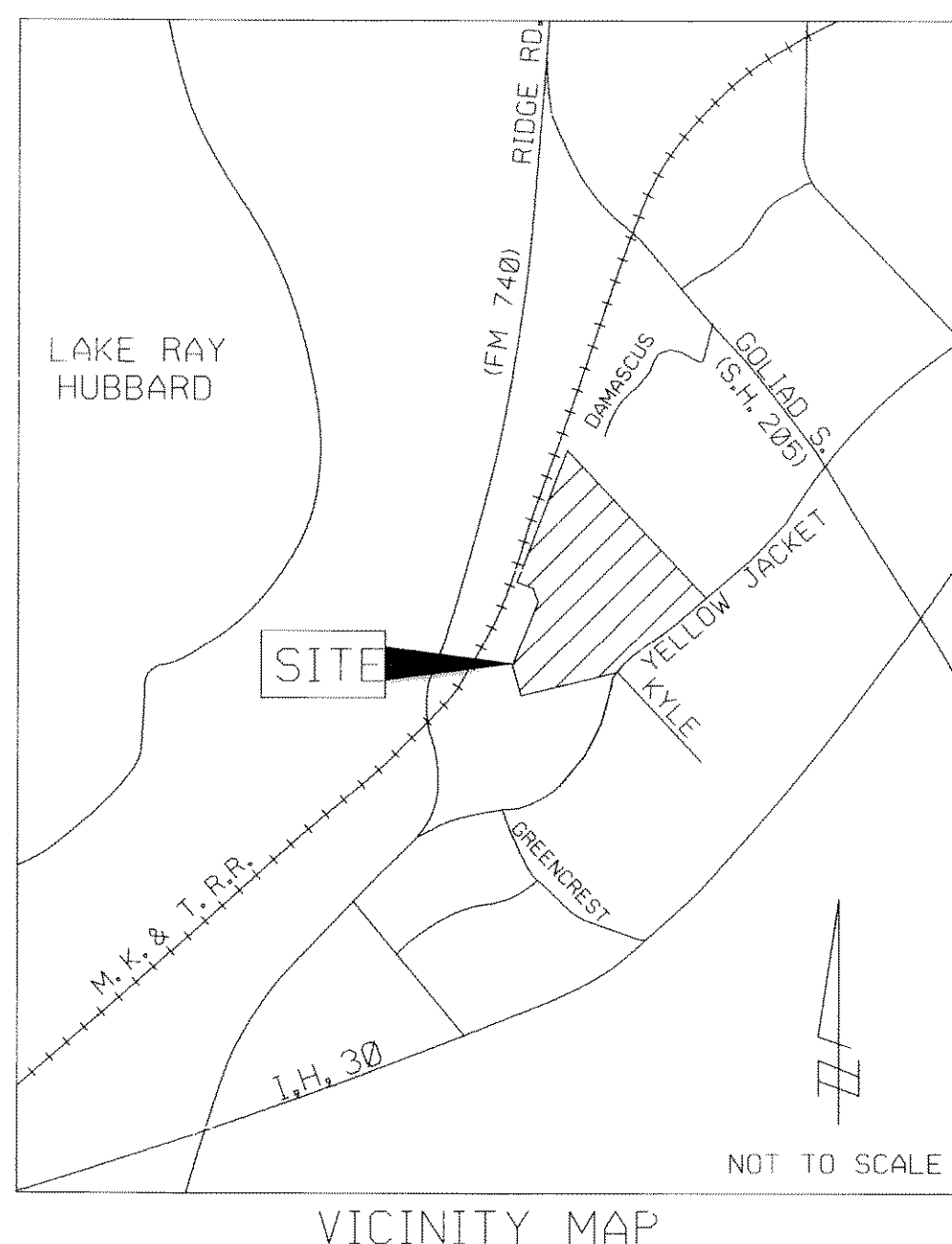

- SHEET INDEX
1. COVER
 2. FINAL PLAT
 3. LOT GRADING
 4. LOT GRADING
 5. LOT GRADING
 6. PAVING PLAN & PROFILE - JULIAN DRIVE
 7. PAVING PLAN & PROFILE - TUPELO DRIVE
 8. PAVING PLAN & PROFILE - YELLOWJACKET LEFT TURN LANE & ALLEY 'A'
 9. PAVING PLAN & PROFILE - PELICAN COVE DRIVE
 10. PAVING PLAN & PROFILE - PELICAN COVE DRIVE, ALLEY 'B' & TEMPORARY TURNAROUND
 11. PAVING PLAN & PROFILE - MURPHY COURT & ALLEY 'B'
 12. PAVING PLAN & PROFILE - DAMASCUS DRIVE & MURPHY DRIVE
 13. PAVING PLAN & PROFILE - MURPHY DRIVE & JULIAN DRIVE
 14. UTILITY LAYOUT PLAN
 15. WATER & SANITARY SEWER PLAN
 16. SANITARY SEWER PLAN & PROFILE - LINES SS-1, SS-2
 17. SANITARY SEWER PLAN & PROFILE - LINES SS-3, SS-4, SS-6
 18. DRAINAGE AREA MAP
 19. STORM DRAIN PLAN & PROFILE - LINE 'A'
 20. STORM DRAIN PLAN & PROFILE - LINE 'B'
 21. EROSION CONTROL PLAN

RECORD DRAWING'S

These drawings have been modified to reflect construction records provided to the Engineer.

ENGINEER:



Consultants in Engineering, Architecture,
Planning and the Environment

CARTER & BURGESS, INC.
7950 ELMBROOK DRIVE, SUITE 250
DALLAS, TX 75247-4961

