

TEXAS STATE PLANE COORDINATES  
 NORTH: 7011985.78  
 EAST: 2587941.94

POINT OF BEGINNING

UTILITY EASEMENT  
 VOLUME 2328, PAGE 68  
 (SHADED)  
 SANITARY SEWER EASEMENT  
 VOLUME 245, PAGE 805

Existing  
 20' Drains  
 Easement  
 Vol. 02476, Pgs. 00036-39

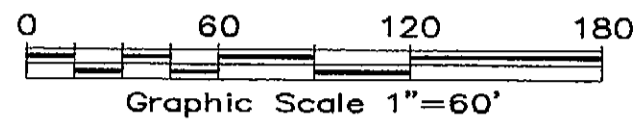

EASEMENT LINE CURVE TABLE

NUMBER	DELTA ANGLE	RADIUS	ARC LENGTH	CHORD DIRECTION	CHORD LENGTH
C1	18°11'42"	50.00	15.88	N 01°57'25" E	15.81
C2	90°00'00"	39.00	61.26	N 00°49'59" W	55.15
C3	91°43'24"	39.00	62.43	S 34°48'26" E	55.98
C4	63°00'14"	39.00	42.89	N 67°49'45" E	40.76
C5	116°59'46"	39.00	79.64	S 22°10'15" E	66.50
C6	71°21'47"	39.00	48.58	S 65°22'22" W	45.50
C7	30°23'27"	39.00	20.69	N 26°14'53" E	20.44
C8	30°23'21"	39.00	20.69	S 26°14'57" W	20.44
C9	11°45'08"	63.00	12.92	N 35°34'03" E	12.90
C10	30°23'21"	63.00	33.41	S 26°14'56" W	33.02
C11	66°16'55"	39.00	45.12	S 45°48'16" E	42.64
C12	06°40'17"	63.00	7.34	N 15°59'57" W	7.33
C13	30°23'22"	39.00	20.69	S 04°08'25" E	20.44
C14	30°23'16"	39.00	20.68	N 04°08'28" W	20.44
C15	30°23'22"	63.00	33.41	S 04°08'25" E	33.02
C16	88°16'36"	39.00	60.09	N 55°11'34" E	54.32
C17	54°16'42"	47.00	44.53	N 72°11'28" E	42.88
C18	146°00'11"	12.00	30.58	S 61°56'50" E	22.95
C19	56°52'32"	63.00	62.54	N 07°53'22" E	60.00
C20	56°52'32"	39.00	38.71	N 07°53'22" E	37.14
C21	90°00'00"	39.00	61.26	S 89°10'01" W	55.15
C22	64°42'55"	39.00	44.05	S 11°48'33" W	41.75
C23	64°42'55"	63.00	71.16	S 11°48'33" W	67.44
C24	56°53'15"	39.00	38.72	N 17°23'21" W	37.15
C25	123°06'45"	13.00	27.93	S 72°36'38" W	22.86
C26	56°53'15"	20.00	19.86	N 17°23'22" W	19.05
C27	123°06'45"	39.00	83.80	S 72°36'38" W	68.58
C28	18°11'42"	50.00	15.88	S 01°57'25" W	15.81
C28	30°30'28"	149.50	79.60	N 60°53'19" W	78.67

EASEMENT LINE TABLE

NUMBER	DIRECTION	DISTANCE
L1	S 84°15'19" E	27.59'
L2	S 11°03'16" W	87.95'
L3	N 10°43'01" E	2.97'
L4	S 11°03'16" W	150.07'
L5	S 11°03'16" W	226.89'
L6	N 36°19'38" E	181.71'
L7	N 36°19'38" E	129.74'
L8	S 80°40'08" E	151.79'
L9	S 80°40'08" E	455.74'
L10	S 11°03'16" W	74.55'
L11	S 80°40'08" E	103.88'
L12	N 78°56'44" W	38.89'
L13	N 78°56'44" W	35.63'
L14	S 41°26'37" W	22.99'
L15	S 41°26'37" W	22.99'
L16	S 19°20'06" E	22.99'
L17	S 11°03'16" W	28.38'
L18	S 19°20'06" E	22.99'
L19	N 11°03'16" E	24.00'
L20	S 11°03'16" W	143.43'
L21	S 11°03'16" W	87.36'
L22	N 45°03'05" E	105.84'
L23	N 45°03'05" E	26.84'
L24	S 45°49'59" E	121.42'
L25	S 45°49'59" E	4.78'
L26	S 45°49'59" E	218.30'
L27	S 45°49'59" E	40.87'
L28	S 44°10'01" W	5.45'
L29	N 10°58'17" E	5.61'
L30	S 80°42'14" E	37.65'
L31	N 11°03'16" E	20.15'
L32	S 48°33'23" E	10.00'
L33	S 41°26'37" W	16.39'
L34	S 11°49'16" W	68.78'
L35	N 78°43'48" W	125.54'
L36	S 78°43'48" E	98.40'
L37	N 56°04'36" E	24.87'
L38	N 36°19'38" E	14.10'
L39	S 53°40'22" E	5.00'
L40	N 36°19'38" E	15.00'
L41	S 53°40'22" E	10.00'

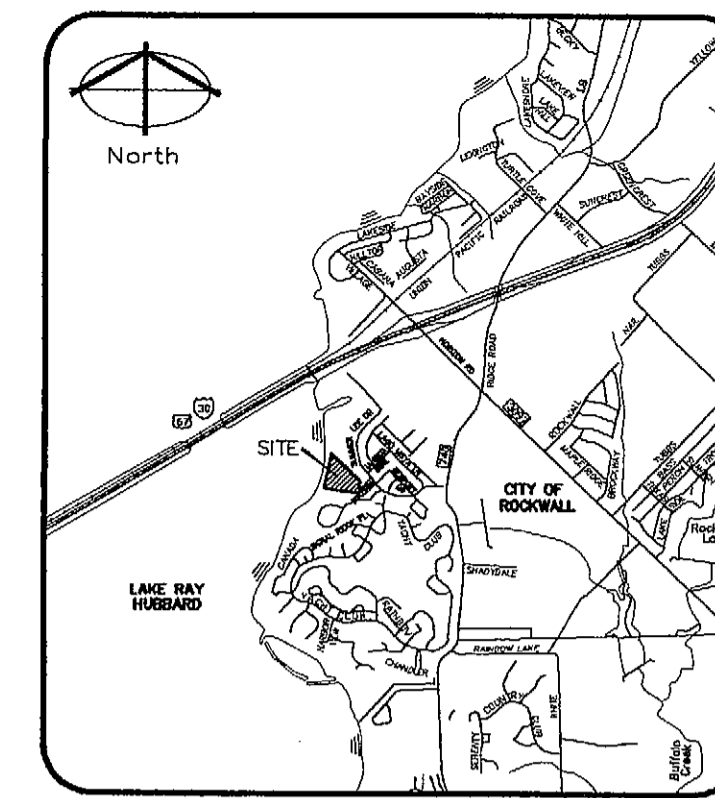

Location Map  
 NTS

ROCKWALL HARBOR  
 JOINT VENTURE  
 VOLUME 617, PAGE 106

ZONED PD-7

LOT 1, BLOCK A  
 6.5995 ACRES

ZONED PD-22

PORTOFINO DRIVE  
 60' R.O.W.  
 VOLUME 382, PAGE 205

SIGNAL RIDGE NO. 1  
 CAB. B, SLIDE 13  
 ZONED PD-15

D = 169°28'59"  
 R = 51.50'  
 L = 152.34'  
 CH = S 42°12'25" E  
 CL = 102.57'

SHEET 1 OF 3  
 AMENDING PLAT

VILLAS DE PORTOFINO

LOT 1, BLOCK A  
 situated in the

E. TEAL SURVEY, ABSTRACT NO. 207

CITY OF ROCKWALL, ROCKWALL COUNTY, TEXAS

Owner

LRH Water's Edge, LP  
 8214 Westchester Dr., Suite 635  
 Dallas, Texas 75225  
 Telephone (214) 692-5085  
 Contact: Brucker Stensrud

Prepared By

Brockette/Davis/Drake, Inc.  
 4144 N. Central Expressway, Suite 1100  
 Dallas, Texas 75204  
 Telephone (214) 824-3647

Scale: 1"=60' June, 2006

1 Lot, 6.5995 Acres  
 ZONED PD-22

TEXAS STATE PLANE COORDINATES  
 NORTH: 7011331.97  
 EAST: 2587822.67

SIGNAL RIDGE NO. 4  
 CAB. B, SLIDE 91

ZONED PD-15

SIGNAL RIDGE NO. 3  
 CAB. B, SLIDE 89

ZONED PD-15

SIGNAL RIDGE NO. 2  
 CAB. B, SLIDE 73

ZONED PD-15

FILED FOR RECORD  
 ROCKWALL COUNTY CLERK  
 PAUL ETTE BURKS  
 CO. CLERK  
 06 SEP -6 PM 2:11  
 DEPUTY

Villas De Portofino  
 Amended Plat