

Building #2, #3, & #4

Building #5, #6, #7 & #8

**CAUTION!!!**  
 EXISTING PHONE, GAS, ELECTRICAL & CATV LINES IN PROJECT AREA. CONTRACTOR SHALL VERIFY LOCATION OF ALL UTILITIES PRIOR TO CONSTRUCTION. NOTIFY THE APPROPRIATE UTILITY COMPANIES AT LEAST 48 HOURS PRIOR TO CONSTRUCTION.  
 TEXAS ONE CALL: 1-800-245-4545

**GRADING GENERAL NOTES**

- All materials and construction shall conform to the 3rd edition of the NCTCOG Standard Specifications for Public Works Construction dated January 1998 as modified by the City of Rockwall Special Provisions, except as noted herein and approved by the City.
- Contractor shall be responsible for maintaining trench safety requirements in accordance with City Standards, Texas State Law, and O.S.H.A. Standards for all excavation in excess of five feet in depth.
- The location of all utilities located on these plans are taken from existing public records. The exact location and elevation of all public utilities must be determined by the Contractor. It shall be the duty of the Contractor to ascertain whether any additional facilities other than those shown on the plans may be present.
- It shall be the responsibility of the Contractor to protect all public utilities in the construction of this project. All manholes, clean-outs, valve boxes, fire hydrants, etc. must be adjusted to proper line and grade by the Contractor prior to and after the placing of permanent paving. Utilities must be maintained to proper line and grade during construction of the paving for this development.
- Any utility installed outside of an easement shall be installed by a plumber and inspected by Code Enforcement.
- Care should be taken that fill materials and areas to receive fill are relatively free of vegetation, roots, debris, large rocks or other objectionable material. Prior to placing any fill, soil subgrades should be scarified to a minimum depth of 8 inches, and recompacted to a minimum of 95 percent of ASTM D 698, at a minimum of +2 percent above the optimum moisture content as determined by that test. Clay fill materials should then be spread in loose lifts, less than 9 inches thick, and uniformly compacted to the same criteria. Processed limestone should be compacted to a minimum of 95 percent of ASTM D 698, at a minimum of +1 percent above optimum moisture.
- Drainage should be maintained away from the foundations, both during and after construction.
- Backfill for utility lines should be carefully placed so that they will be stable. Where utility lines pass through the parking lot, the top 6" should be compacted similarly to the remainder of the lot. Utility ditches should be visually inspected during the excavation process to ensure that undesirable fill is not used.
- Concrete for inlets and drainage structures shall be 4200 psi at 28 days.
- If rock is encountered in the trench, rock spoil shall not be used in the upper 1.5 feet of the trench.
- All earthwork operations, pavement installation, etc. shall conform to the Geotechnical Exploration recommendations or City of Rockwall Standards, whichever is greater.

**LEGEND**

- 460 --- Existing Contour
- 60 --- Proposed Contour
- 460.0 Existing Spot Elevation
- 60.0 Proposed Spot Elevation
- TW Top Wall
- ← Flow Arrow
- Proposed Pavement
- Proposed Retaining Wall
- Existing Curb
- Proposed Curb
- Sawcut

**NOTE:**  
 MAXIMUM 2% CROSS SLOPE ON ALL PROPOSED WALKWAYS

**NOTE:**  
 RETAINING WALL AND INTERIOR SITE CONTOUR LOCATIONS ARE SCHEMATIC. REFER TO LANDSCAPE PLANS FOR EXACT LOCATIONS AND ELEVATIONS.

**RECORD DRAWING**  
 02/09/07

**NOTE:**  
 THESE PLANS HAVE BEEN REVISED TO CONFORM WITH CONSTRUCTION RECORDS PROVIDED BY THE CONTRACTOR.

**Benchmark:**  
 "□" Cut At South Side Of Sanitary Sewer Lift Station. Located 100 Ft. East and 10 Ft.± South From The Southwest Corner Of This Property  
 Elevation : 450.45

**GRADING PLAN - AREA 1**  
**WATER'S EDGE RESIDENCES AT LAKE RAY HUBBARD**  
**CITY OF ROCKWALL, TEXAS**

**BROCKETTE • DAVIS • DRAKE, INC.**  
 consulting engineers  
 Civil & Structural Engineering • Surveying  
 4144 North Central Expressway, Suite 1100 • Dallas, Texas 75204  
 (214) 824-3647 • Fax (214) 824-7064

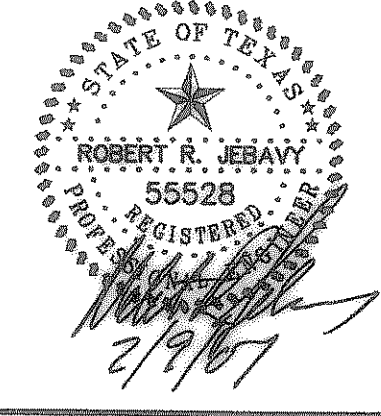

DESIGNED	DRAWN	DATE	SCALE	NOTES	FILE	NO.
RRJ	STL	10/04	1"=20'	BDD	C04207	C5

Copyright 2004, Brockette/Davis/Drake, Inc. All Rights Reserved. No part of this drawing may be reproduced, stored in a retrieval system, or transmitted in any form or by any means, electronic, mechanical, photocopying, recording, or by any information storage and retrieval system, without the prior written authorization of Brockette/Davis/Drake, Inc. is prohibited.

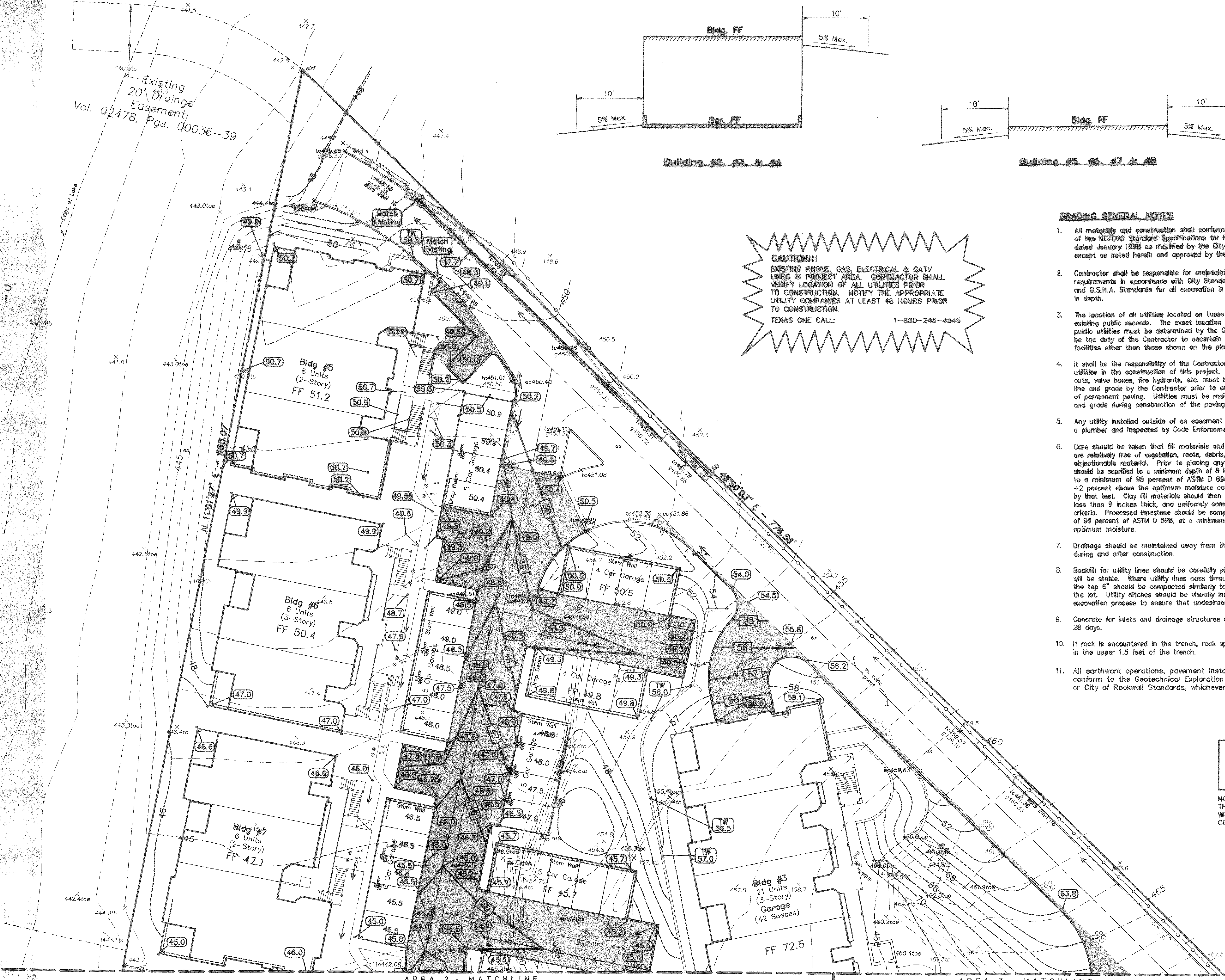

AREA 2 - MATCHLINE

AREA 3 - MATCHLINE