

RE: GENERAL NOTES AND SPECIFICATION DATA FOR PLANTING NOTES.

**A SECTION: Tree Guying**  
TO 5000 3" CALIPER & LARGER

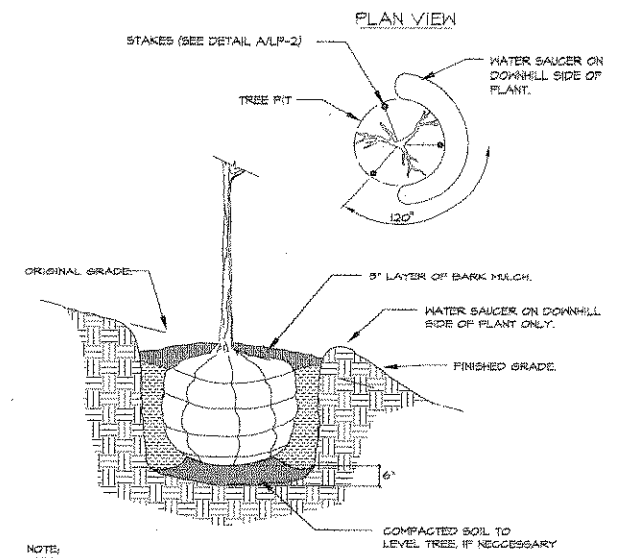

NOTE: SEE TREE PLANTING DETAIL FOR STAKING AND PLANTING INSTRUCTIONS.

**B SECTION: Tree Pit on Slope**  
TO 5000

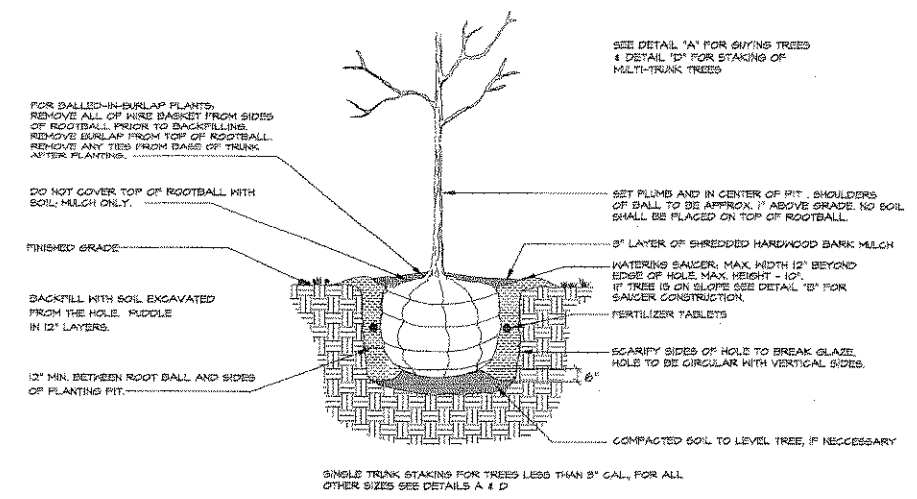

SINGLE TRUNK STAKING FOR TREES LESS THAN 8" CAL. FOR ALL OTHER SIZES SEE DETAILS A & D

**C SECTION: Tree Planting - B&B, Box, Can**  
TO 5000

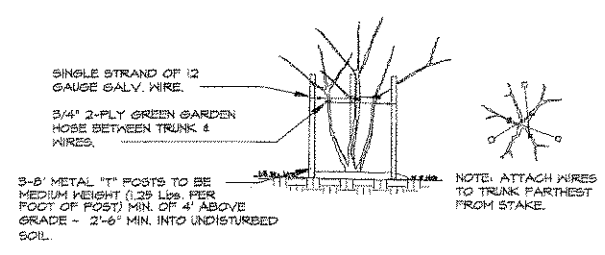

RE: GENERAL NOTES AND SPECIFICATION DATA FOR PLANTING AND PRUNING DETAILS.

**D SECTION: Tree Staking**  
TO 5000 MULTI-TRUNKED TREES LESS THAN 3" CALIPER

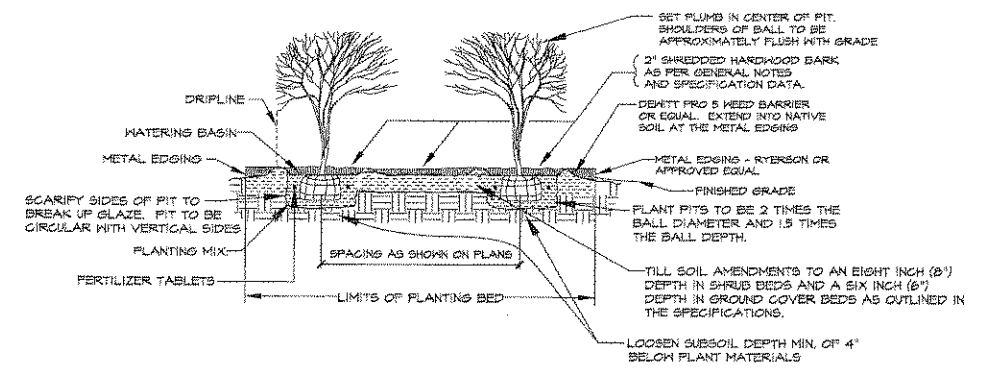

**E SECTION: Planting Bed**  
TO 5000

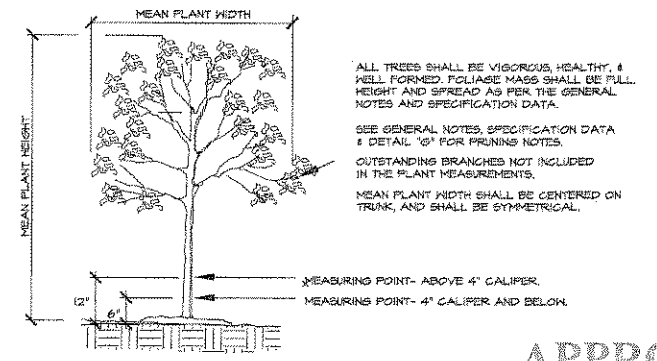

ALL TREES SHALL BE VIGOROUS, HEALTHY, & WELL FORMED. FOLIAGE MASS SHALL BE FULL HEIGHT AND SPREAD AS PER THE GENERAL NOTES AND SPECIFICATION DATA.  
SEE GENERAL NOTES, SPECIFICATION DATA & DETAIL 'G' FOR PRUNING NOTES.  
OUTSTANDING BRANCHES NOT INCLUDED IN THE PLANT MEASUREMENTS.  
MEAN PLANT WIDTH SHALL BE CENTERED ON TRUNK, AND SHALL BE SYMMETRICAL.

**F SECTION: Tree Measuring**  
TO 5000

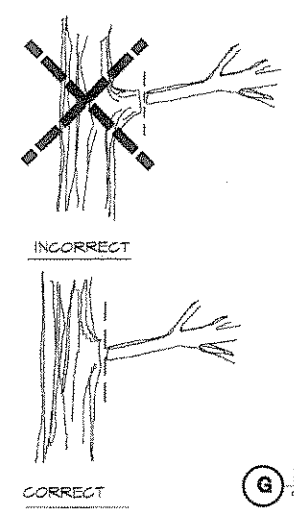

**PRUNING NOTES:**

1. REMOVE ALL BROKEN, DISEASED, OR WEAK BRANCHES.
2. MAKE ALL CUTS AS CLOSE TO THE TRUNK OR LIMB AS POSSIBLE-LEAVE NO STUBS.
3. DO NOT CUT A LEADER.
4. PRUNE SO AS TO RETAIN THE NATURAL FORM OF THE TREE.
5. REMOVE APPROXIMATELY 1/3 OF INTERIOR BRANCHING.
6. DO NOT TIP PRUNE.
7. CONTACT ENGINEER PRIOR TO PRUNING FOR FURTHER INSTRUCTIONS.
8. CUTS OVER 1/2" DIAMETER MADE TO TREES OF THE OAK FAMILY (ie RED OAK, LIVE OAK, BUR OAK, ETC.) FROM FEBRUARY 15 - DECEMBER 15 SHALL BE PAINTED WITH TREE PRUNING PAINT IMMEDIATELY FOLLOWING PRUNING (1 HOUR MAX). APPLY SUFFICIENT COATS TO INSURE SEALING OF THE CUT.

**G SECTION: Tree Pruning**  
TO 5000

**APPROVED FOR CONSTRUCTION**

MAR 27 2000

City of Rockwall Engineering Dept.  
City Engineer: \_\_\_\_\_

FERTILIZER SCHEDULE: PLANTING	
TREES	
5-GALLON TREES 2 AGRIFORM *21 GRAM TABLETS	1-GALLON AND SMALLER 1 AGRIFORM *21 GRAM TABLET
15-GALLON TREES 5 AGRIFORM *21 GRAM TABLETS	3 TO 5-GALLON AND B&B MATERIAL WITH SPREADS TO THREE (3) FT. 2 AGRIFORM *21 GRAM TABLETS
50-GALLON AND ALL B&B MATERIAL 1 AGRIFORM *21 GRAM TABLET PER EACH ONE-HALF (1/2) INCH OF CALIPER	15-GALLON AND B&B MATERIAL WITH SPREADS GREATER THAN THREE (3) FT. 5 AGRIFORM *21 GRAM TABLETS

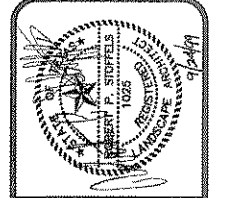

**DUNKIN SIMS STOFFELS, INC.**  
Landscape Architects / Planners  
9603 White Rock Trail, Suite 210  
Houston, TX 77027  
Phone: (214)553-5778  
Fax: (214)553-5781

**WALGREEN'S - ROCKWALL ADDITION**  
LOT 1, BLOCK 'A'

**RDI DEVELOPMENT, INC.**  
3000 WESLAYAN, SUITE 225  
HOUSTON, TX 77027  
(713)850-1047

TITLE:  
**LANDSCAPE DETAILS**

ISSUE DATE:  
SEPTEMBER 25, 1999

REVISIONS:  
▲  
▲  
▲  
▲  
▲

SHEET:  
**PL-3**