

FARM-MARKET 740
(EX. VARIABLE WIDTH R.O.W.)

Sawcut and Remove 258 Sq.Ft. of Asphalt Roadway. Transition to Ex. Asphalt Pmnt. w/6" Thick H.M.A.C. Match Existing Grades

Sawcut and Remove 254 Sq.Ft. of Asphalt Roadway. Transition to Ex. Asphalt Pmnt. w/6" Thick H.M.A.C. Match Existing Grades

$\theta=02'20''48''$
 $R=613.69'$
 $T=12.57'$
 $L=25.14'$
 $CB=N37'05''42''E$
 $CL=25.13'$

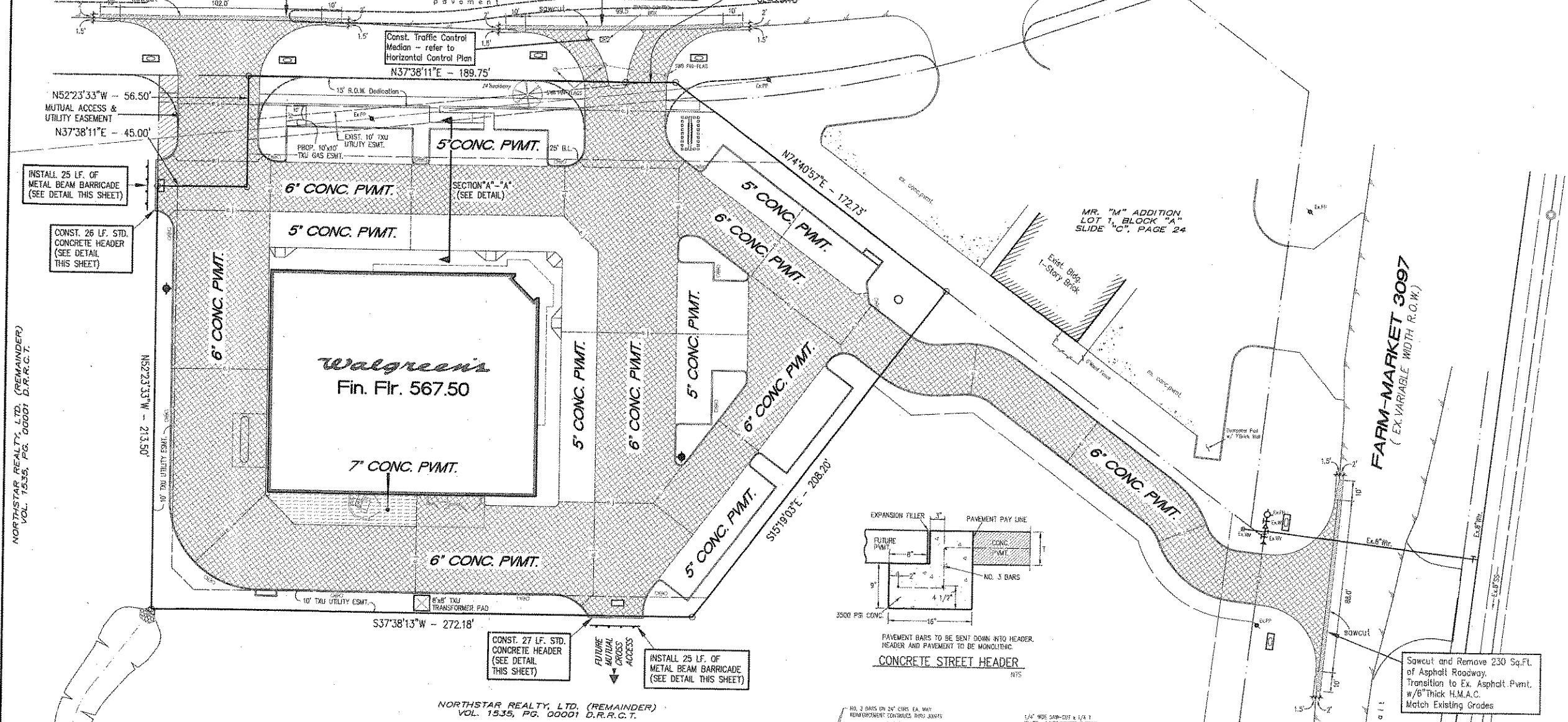
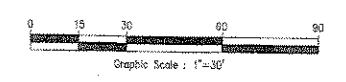

GENERAL NOTES:

1. ALL MATERIAL AND CONSTRUCTION SHALL CONFORM TO THE CITY OF ROCKWALL STANDARDS AND SPECIFICATIONS, EXCEPT AS NOTED HEREIN AND APPROVED BY THE CITY.
2. THE LOCATION OF ALL UTILITIES LOCATED ON THESE PLANS ARE TAKEN FROM EXISTING PUBLIC RECORDS. THE CONTRACTOR MUST DETERMINE THE EXACT LOCATION AND ELEVATION OF ALL PUBLIC UTILITIES. IT SHALL BE THE DUTY OF THE CONTRACTOR TO ASCERTAIN WHETHER ANY ADDITIONAL FACILITIES OTHER THAN THOSE SHOWN ON THE PLANS MAY BE PRESENT.
3. IT WILL BE THE RESPONSIBILITY OF THE CONTRACTOR TO PROTECT ALL PUBLIC UTILITIES IN THE CONSTRUCTION OF THIS PROJECT.
4. REFER TO ARCHITECTURAL PLANS FOR EXACT BUILDING AND RELATED SIDEWALK DIMENSIONS.
5. ALL PARKING SPACES ARE 9' x 18' UNLESS NOTED OTHERWISE.
6. ALL EARTHWORK OPERATIONS SHALL CONFORM TO THE GEOTECHNICAL INVESTIGATION RECOMMENDATIONS. PREPARED BY HBC ENGINEERING, INC., 8801 CARPENTER FREEWAY, SUITE 100, DALLAS, TEXAS 75247, REPORT NO. 94995372, DATED: AUGUST, 1999.
7. SUBGRADE SHALL BE 6" STABILIZED SUBGRADE UNIFORMLY COMPACTED TO A MINIMUM OF 95 PERCENT OF ASTM D698 NEAR, -1 TO +3 PERCENT, THE OPTIMUM MOISTURE CONTENT. SUBGRADE SHALL BE PROTECTED AND MAINTAINED IN A MOIST CONDITION UNTIL THE PAVEMENT IS PLACED.
8. BACKFILLING OF CURBS SHOULD BE ACCOMPLISHED AS SOON AS PRACTICAL TO PREVENT PONDING OF WATER.
9. CONTROL JOINTS SHOULD BE SAWS AS SOON AS THE CONCRETE WILL ALLOW.
10. ALL PAVING MATERIALS SHALL COMPLY WITH THE TEXAS DEPARTMENT OF TRANSPORTATION STANDARD SPECIFICATIONS FOR CONSTRUCTION OF HIGHWAYS, STREETS AND BRIDGES, ITEM 360, 1993.
11. LOADING (TRAFFIC) MUST NOT BE ALLOWED UNTIL THE CONCRETE HAS REACHED PERCENT OF IT'S DESIGN STRENGTH.

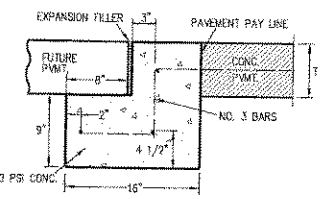

CONCRETE STREET HEADER
NTS

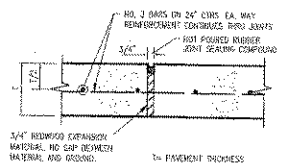

EXPANSION JOINT
NTS

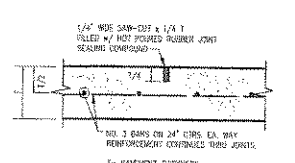

SAWED DUMMY (CONTROL) JOINT
NTS

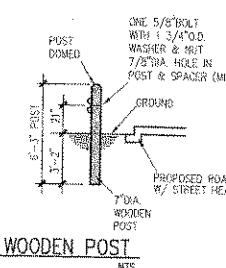

WOODEN POST
NTS

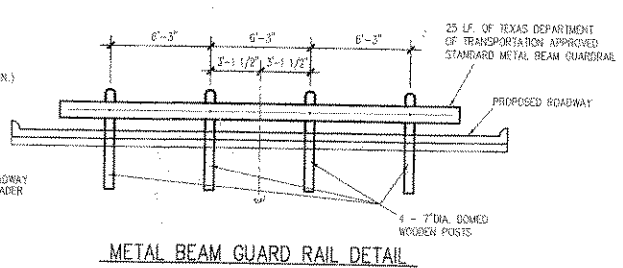

METAL BEAM GUARD RAIL DETAIL
NTS

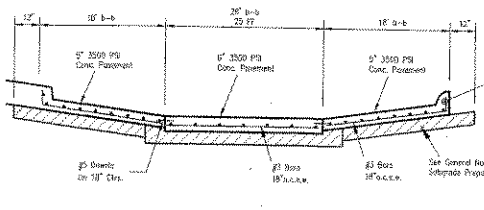

SECTION "A"-A"
NTS

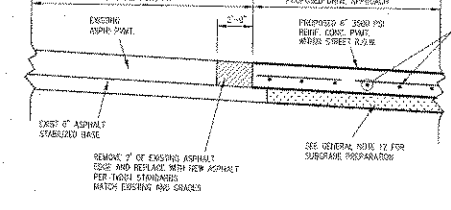

CONCRETE TO ASPHALT DETAIL
NTS

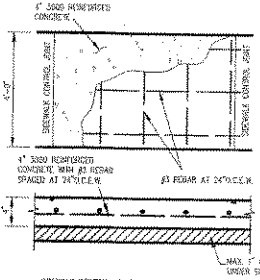

TYPICAL CONCRETE WALK
NTS

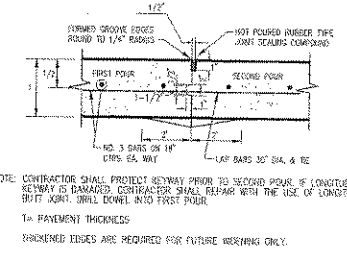

CONSTRUCTION JOINT
NTS

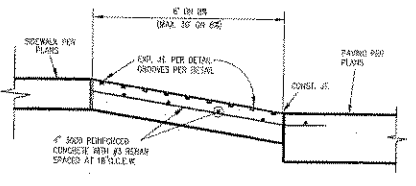

BARRIER FREE RAMP SECTION
NTS

APPROVED FOR CONSTRUCTION

MAR 27 2000

City of Rockwall Engineering Dept.
City Engineer:

NOTE:

1. Drives and Service Areas to be 6" 3500 PSI Reinforced Concrete.
2. Public and Private Parking Areas to be 5" 3500 PSI Reinforced Concrete.
3. Dumpster Pad Areas to be 7" 3500 PSI Reinforced Concrete.

- 5" 3500 PSI REINF. CONC. W/ #3 BARS @ 18" O.C. & 6" STABILIZED SUBGRADE
- 6" 3500 PSI REINF. CONC. W/ #3 BARS @ 18" O.C. & 6" STABILIZED SUBGRADE 6 SACK MINIMUM 6-1/2 SACK FOR HARD POUR
- 7" 3500 PSI REINF. CONC. W/ #3 BARS @ 18" O.C. & 6" STABILIZED SUBGRADE

---|--- EXPANSION JOINT

Benchmark:
City of Rockwall Brass Disk Monument set in Concrete City of Rockwall Monument # R017.
Elevation = 549.45



revisions	date

NDM NATHAN D. MAIER
consulting engineers, inc.
Two Northpark / 8080 Park Lane / Suite 600
Dallas, Texas 75231 / (214) 739-4741

PAVEMENT CONSTRUCTION PLAN
WALGREENS - STORE # 5827
F.M. 740 AND F.M. 3097
ROCKWALL, ROCKWALL COUNTY, TEXAS

designed	drawn	scale	date	notes
NDM/C	NDM/C	NOTED	Mar. 27, 2000	

sheet no.
10
13
job number
9805057