

- NOTES:
- EXISTING ZONING: COMMERCIAL
  - SETBACKS:  
FRONT YARD - 40'  
SIDE YARD - NONE  
REAR YARD - NONE
  - BENCHMARKS:  
\* CUT AT BACK OF CURB UNDER ARBY'S SIGN ELEVATION = 545.98
  - UTILITY CONTACTS:  
GAS SERVICE:  
LONE STAR GAS  
1310 ST. HWY. 66  
GARLAND, TX. 75040  
ATTN: DINAH WOOD  
(214) 573-3704  
ELECTRIC SERVICE:  
T.U. ELECTRIC  
1545 HIGH POINT  
MESQUITE, TX. 75149  
ATTN: BRIAN HUGHES  
(214) 216-8984  
CABLE SERVICE:  
TEXAS CABLECOMM  
920 WHITMORE  
ROCKWALL, TX. 75087  
ATTN: RICK WAHL  
(800) 480-7020  
TELEPHONE SERVICE:  
SOUTHWESTERN BELL  
208 S. AKARD ST, FLOOR 8  
1 BELL PLAZA  
DALLAS, TX. 75202  
ATTN: NORMA Mc KENZIE  
(214) 268-7283  
\* WATER & SEWER TAPS  
GEORGE BARNETT  
CITY OF ROCKWALL  
(214) 771-7731

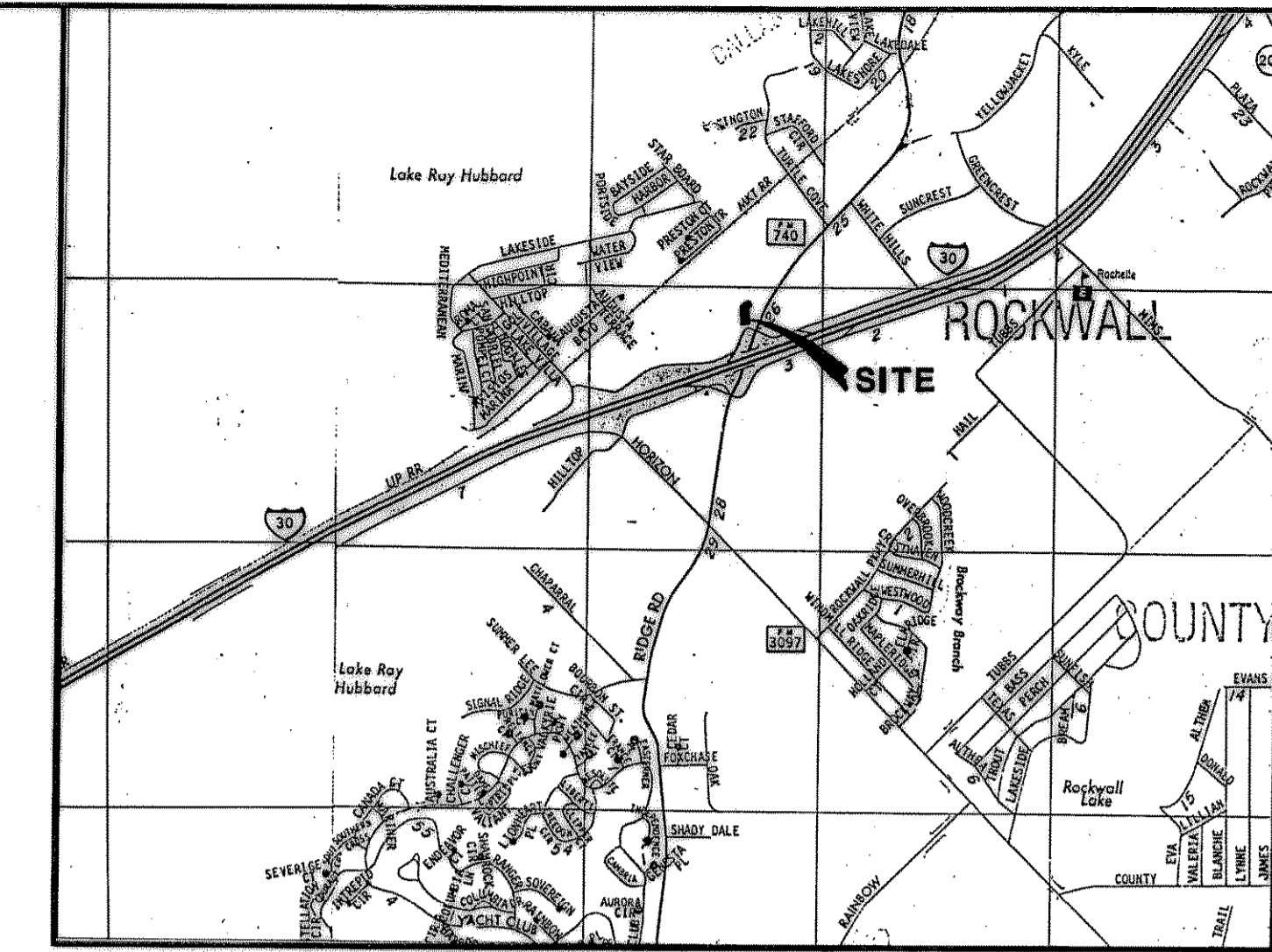

LOCATION MAP

PROJECT SUMMARY

ZONING	(C) COMMERCIAL
SETBACK	40' FRONT SETBACK 15' SIDE SETBACK
LOT AREA	0.523 Ac. 22,798 SF
BUILDING	1,726 SQUARE FEET
PROPOSED USE	RESTAURANT
PARKING PROVIDED	STANDARD SPACES 28 HANDICAP SPACES 2 R.V. SPACES 3 TOTAL SPACES 33
LANDSCAPE	24% 5516 SQUARE FEET
F.A.R.	0.08 : 1
BUILDING HEIGHT	1 STORY 18 FEET

MATERIAL QUANTITY CHART

- A. ASPHALT: N/A sq. yds. PARKING LOT  
CONCRETE: 1,615 sq. yds. 5" CONC. PARKING LOT PAVEMENT  
0 sq. yds. 4" SIDEWALK  
31 sq. yds. 6" DUMPSTER PAD
- B. CONCRETE APPROACHES: 81 sq. yds.
- C. DRAINAGE: APRONS  
1-10" STORM INLET rip-rap: N/A sq. yds.  
N/A DROP INLET concrete flumes: N/A sq. yds.  
N/A JUNCTION BOX 19 L.F. 24" R.C.P.
- D. SANITARY SEWER: ON SITE 177 L.F. Clean Outs: 4  
OFF SITE N/A L.F. Grease Traps: 1  
N/A Manholes
- E. WATER LINE: On Site 145 L.F. METERS SHOWN: 2  
Off Site N/A L.F.
- F. REMOVE EXISTING FLATWORK: 335 SY
- G. CURBING: On Site 362 L.F.  
Curb Cut 22 L.F.
- H. PARKING STALLS: 33 Total, including 2 Handicap (2 Minimum)
- I. CUT: 77 cu. yds. + 15% expansion = 89 total cu. yds.  
FILL: 1,233 cu. yds. + 20% shrinkage = 1,480 total cu. yds.

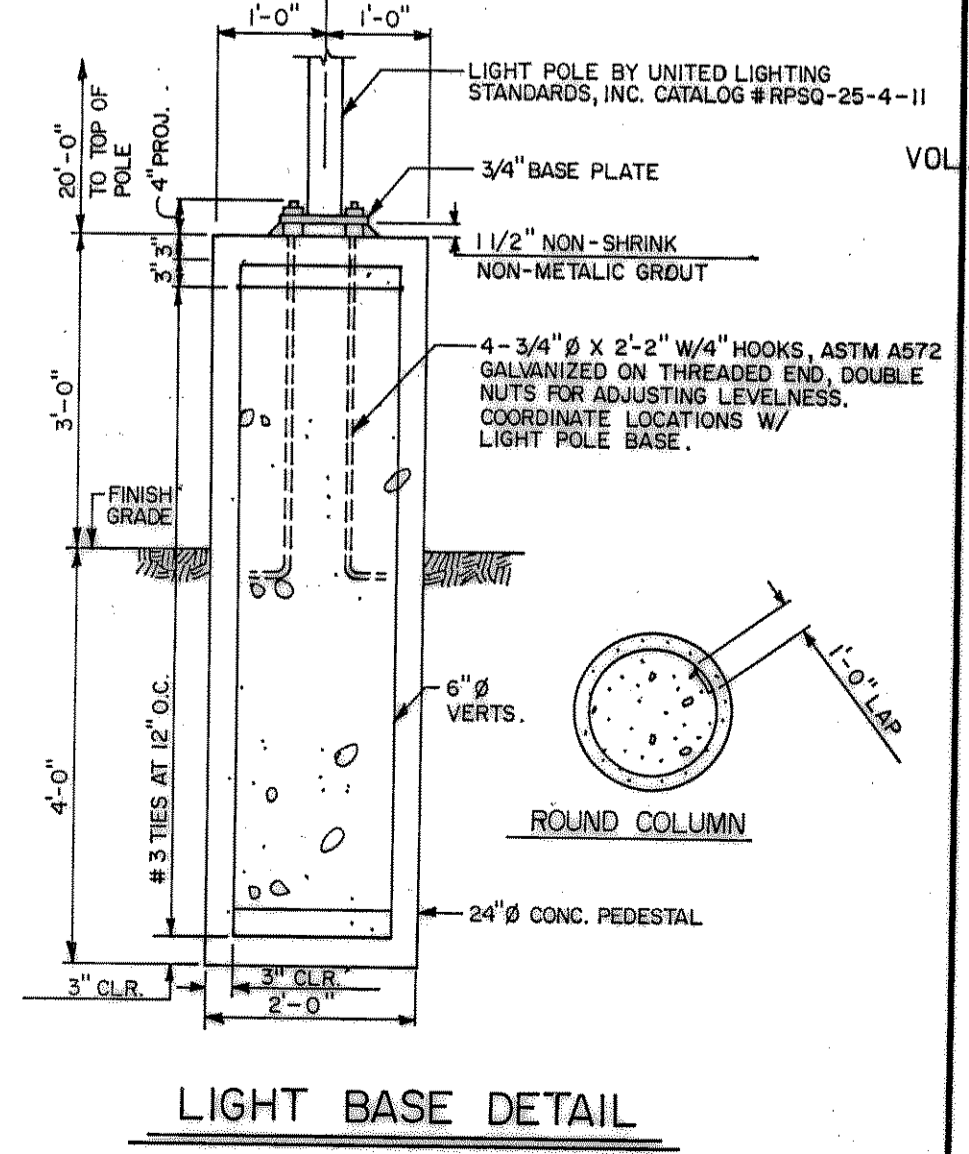
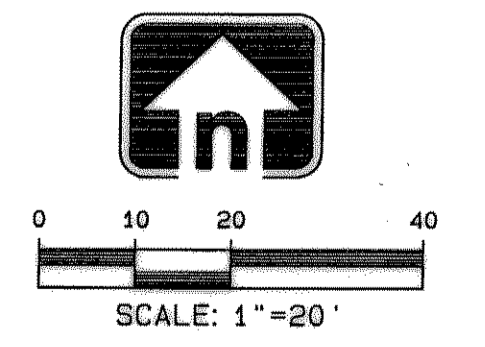
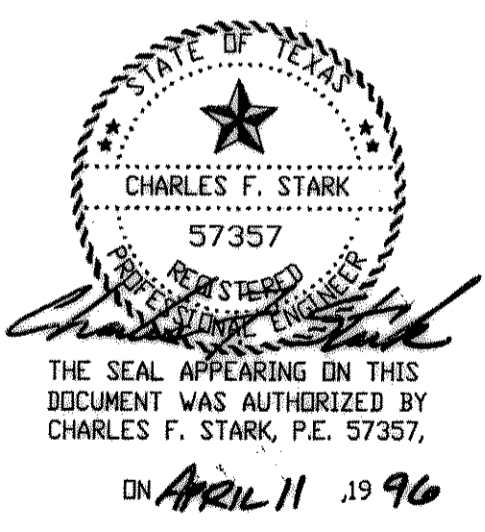

NO.	DATE	REVISIONS	DATE	WAFFLE HOUSE APPROVALS	SIGNATURE

**WAFFLE HOUSE**  
GOOD FOOD FAST  
P.O. BOX 6450, NORCROSS, GA. 30091  
EXECUTIVE OFFICES:  
5986 FINANCIAL DRIVE  
NORCROSS, GA. 30071  
(770) 729-5700

**SITE PLAN**  
WAFFLE HOUSE ADDITION  
PART OF 1-30/740  
ADDITION  
CITY OF ROCKWALL  
ROCKWALL COUNTY, TEXAS

**Graham Associates, Inc.**  
CONSULTING ENGINEERS & PLANNERS  
616 SIX FLAGS DRIVE, SUITE 400  
ARLINGTON, TEXAS 76011 (817) 640-8535  
(770) 729-5700

Drawn By: JPK  
Sheet: 1 OF 2

Date: JAN, 1996  
File: 9806-1007