

TYPICAL PAVING SECTION

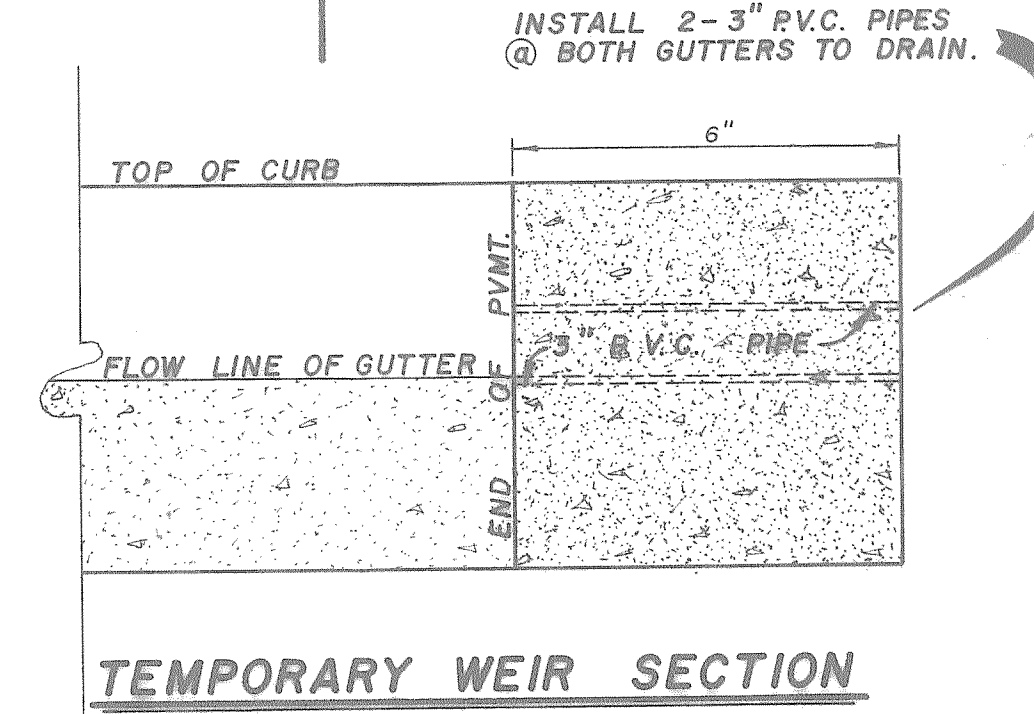

TEMPORARY WEIR SECTION

BENCH MARK
Top of exist. M.H. in intersection of
Stimson St. & Joe White St. - Elev. 511.96

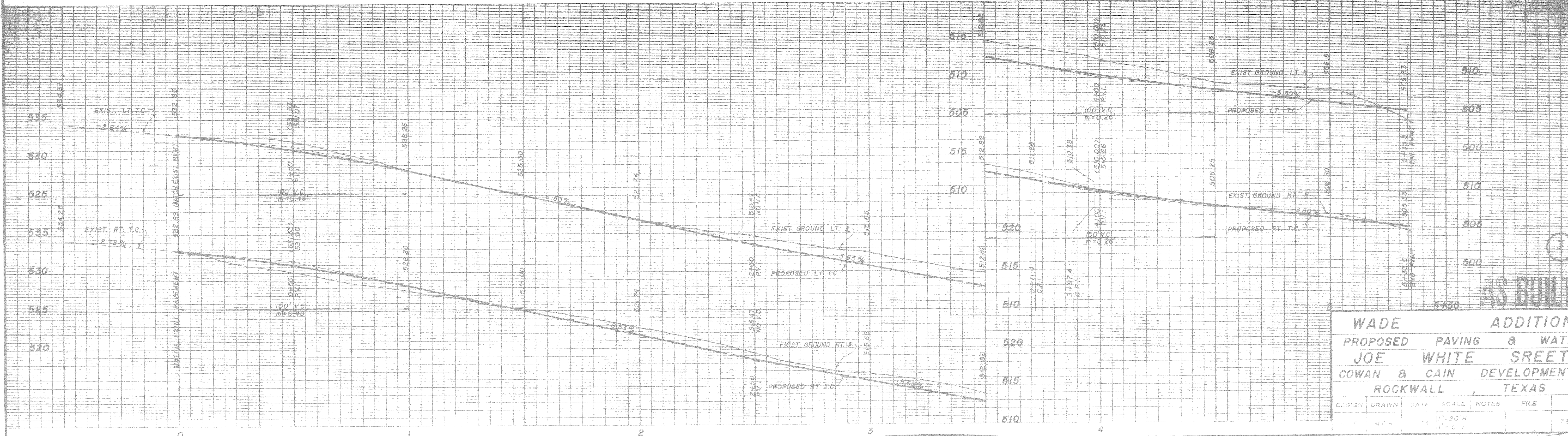

AS BUILT		5+80	
WADE ADDITION			
PROPOSED PAVING & WATER			
JOE WHITE SREET			
COWAN & CAIN DEVELOPMENTS			
ROCKWALL, TEXAS			
DESIGN	DRAWN	DATE	SCALE
			1"=20'H
			1"=6'
FILE	NO		
	7302 E		