

TYPICAL PAVING SECTION

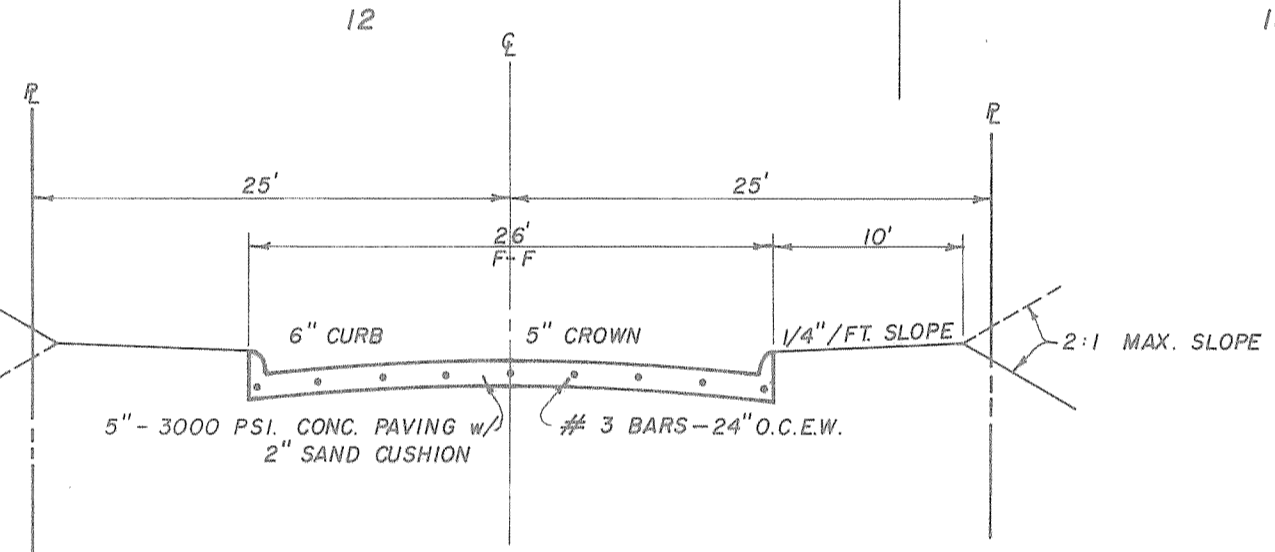

BENCH MARK
 Top nut of F.H. in Joe White St. - 24'
 south of intersection with Stimson St.
 Elev. 527.07

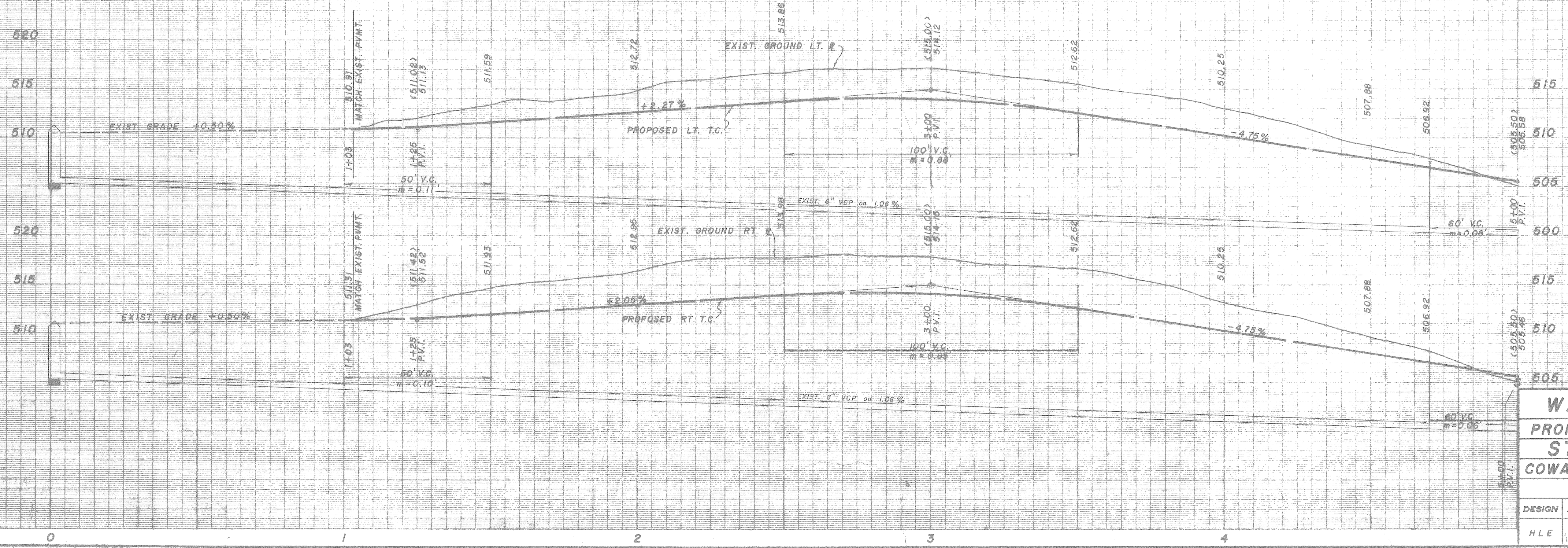

AS BUILT

WADE		ADDITION	
PROPOSED PAVING & WATER			
STIMSON STREET			
COWAN & CAIN DEVELOPMENTS			
ROCKWALL, TEXAS			
DESIGN	DRAWN	DATE	SCALE
HLE		5/73	1" = 20' H. 1" = 6' V.
NOTES	FILE	NO.	