

GENERAL LANDSCAPE NOTES

- The contractor is responsible for making himself familiar with all underground utilities, pipe and structures whether or not shown on the plans. The contractor shall be responsible for location of all underground utilities and will be responsible for costs incurred due to damage or replacement of said utilities or structures caused by his forces.
- Do not willfully proceed with construction, as designed, when it is obvious that unknown obstructions or conflicts exist that may not have been known during design. Such conditions shall be brought immediately to the attention of the Owner's Representative. The contractor shall assume full responsibility for all necessary revisions due to failure to give such notification.
- The crown of all plants shall be slightly higher, after settling, than adjacent soil.
- The contractor shall be responsible for removing or adding topsoil as needed for the inclusion of the soil amendments.
- The contractor shall coordinate installation of the landscaping with installation of the irrigation system.
- All ground covers, seasonal color and shrub groupings are to be aligned in straight even rows and triangularly spaced at the spacing shown on the plant list.
- Prepare the top 2" of soil to be grassed by mechanically tilling. Rake all areas removing debris, clods and rocks 1" dia. and greater. Render soil loose and finely graded. Eliminate all depressions and ridges and provide a smooth, and even finish grade.
- All turf areas shown are to be hydromulched, or solid sodded with common bermuda grass, as noted on the plan.
- The contractor shall be responsible for obtaining all required landscape and irrigation permits.
- The landscape contractor shall receive the site at (+/-) .1' of finish grade.
- All planting beds and tree pits are to receive a minimum of 2" of shredded cedar mulch top dressing. Save this operation until near final inspection.
- All shrubs are to be located a minimum of 3' from steel edging, curbs, walks and trees.
- All trees are to be located a minimum of 5' from all fire hydrants, utility lines and other underground structures.
- All planting areas shall be maintained weed free until final acceptance.
- All work shall be guaranteed against all defects in workmanship and materials for a period of one year from the date of final acceptance.
- The contractor shall adjust final plant material locations as needed to accommodate light fixtures, underground service lines, and other utilities.

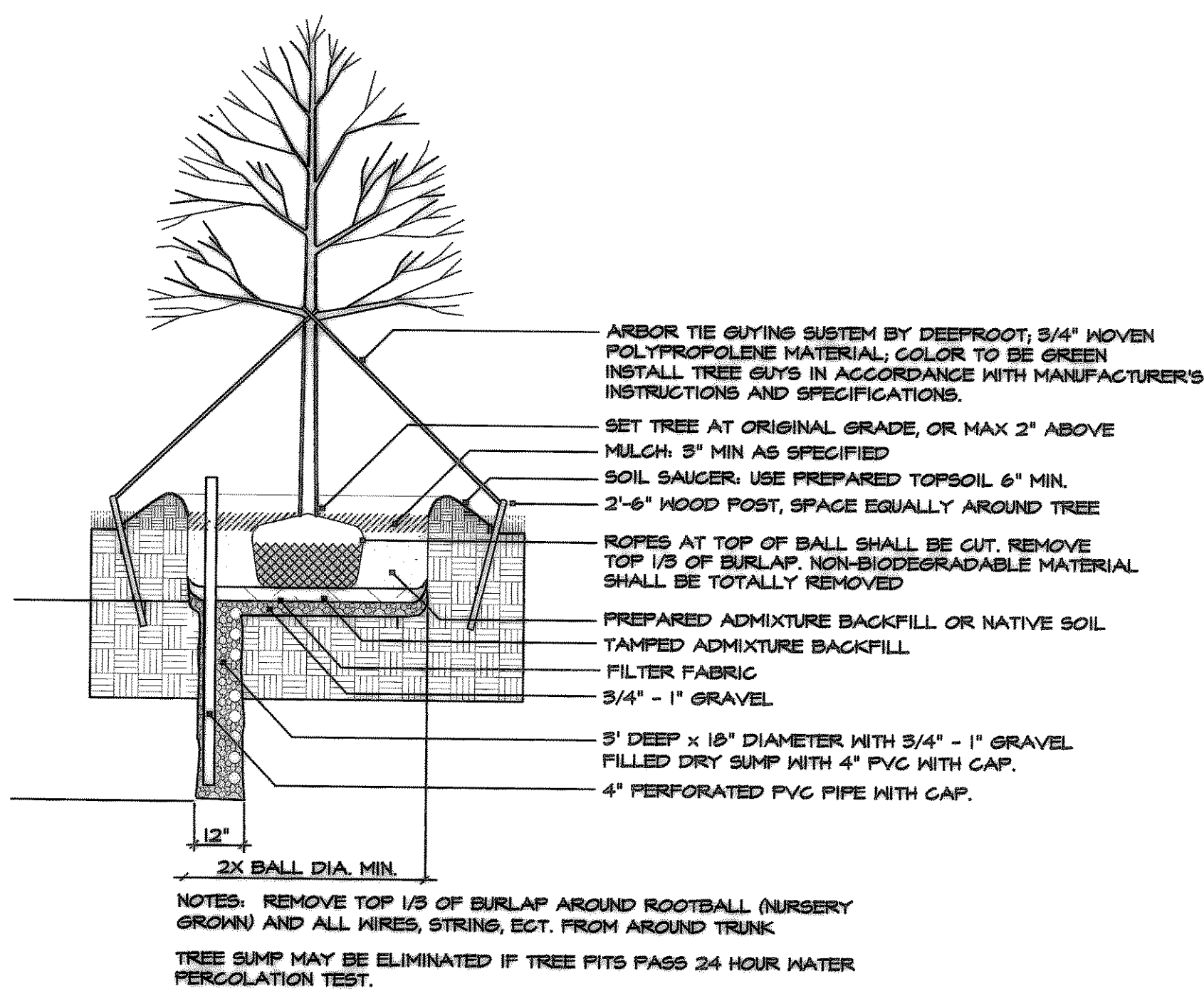

1 SHADE TREE PLANTING DETAIL
NOT TO SCALE

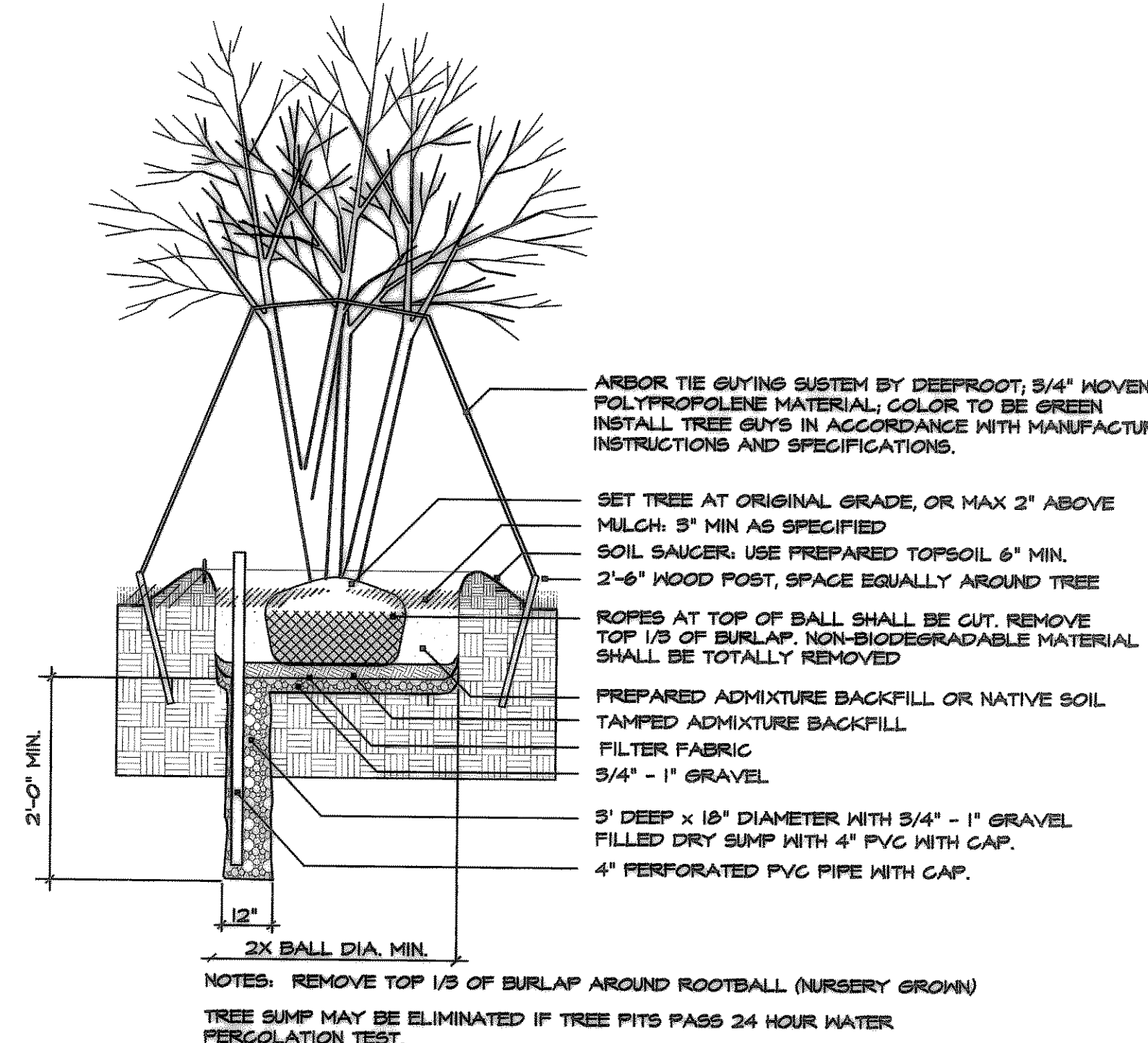

2 ORNAMENTAL TREE PLANTING DETAIL
NOT TO SCALE

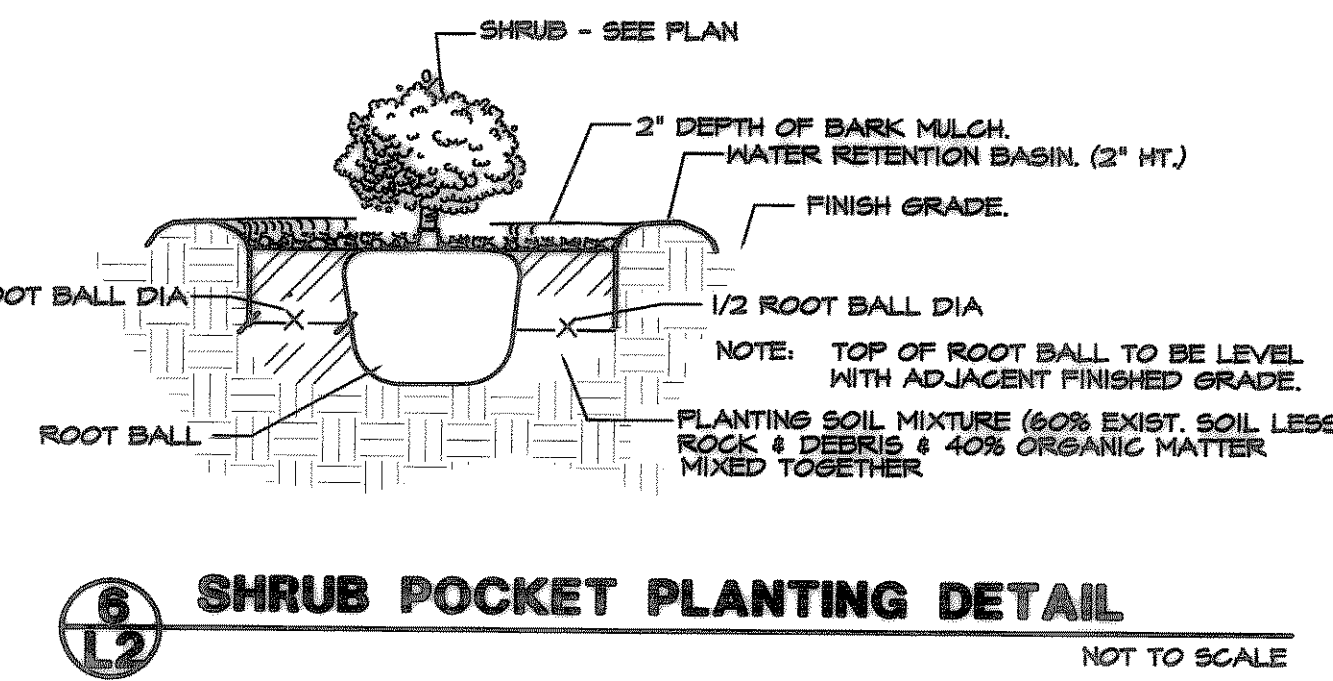

3 SHRUB POCKET PLANTING DETAIL
NOT TO SCALE

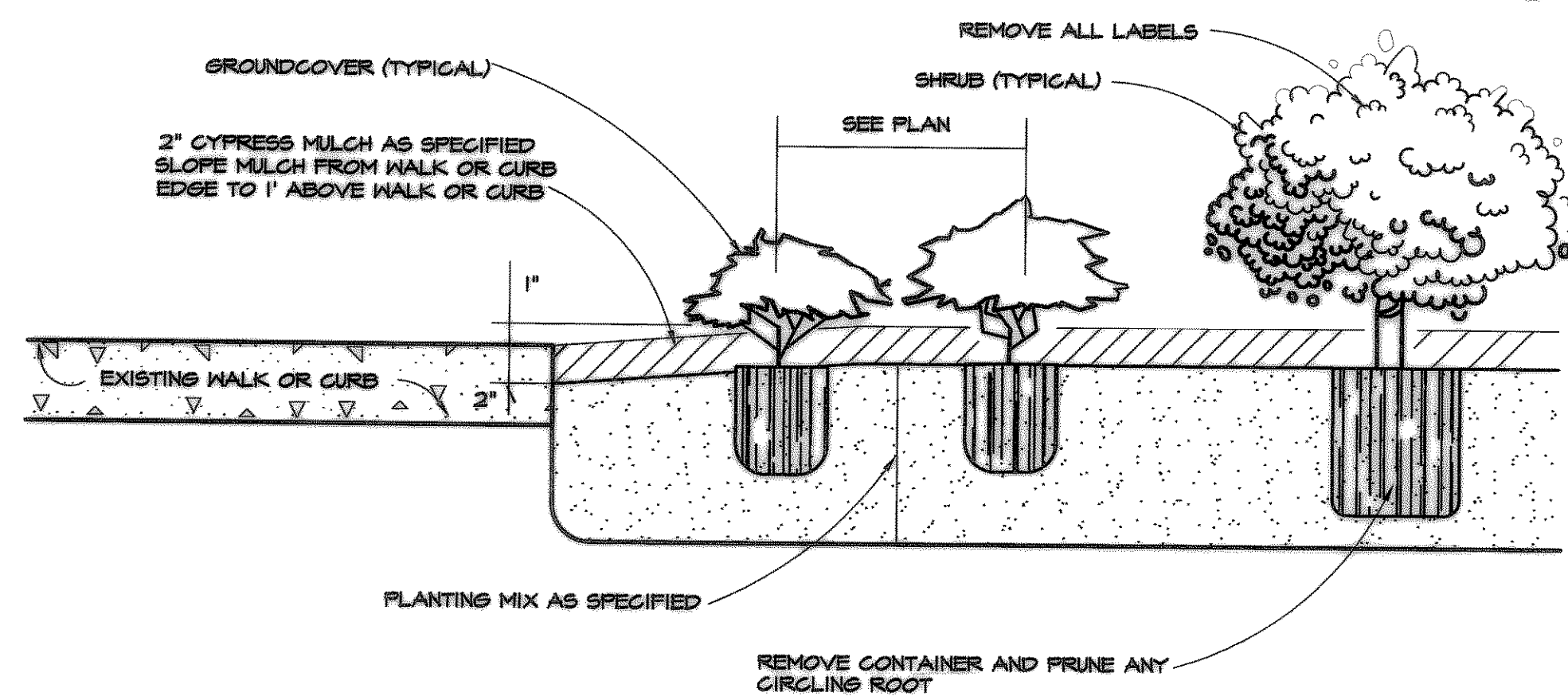

4 SHRUB AND GROUNDCOVER PLANTING DETAIL
NOT TO SCALE

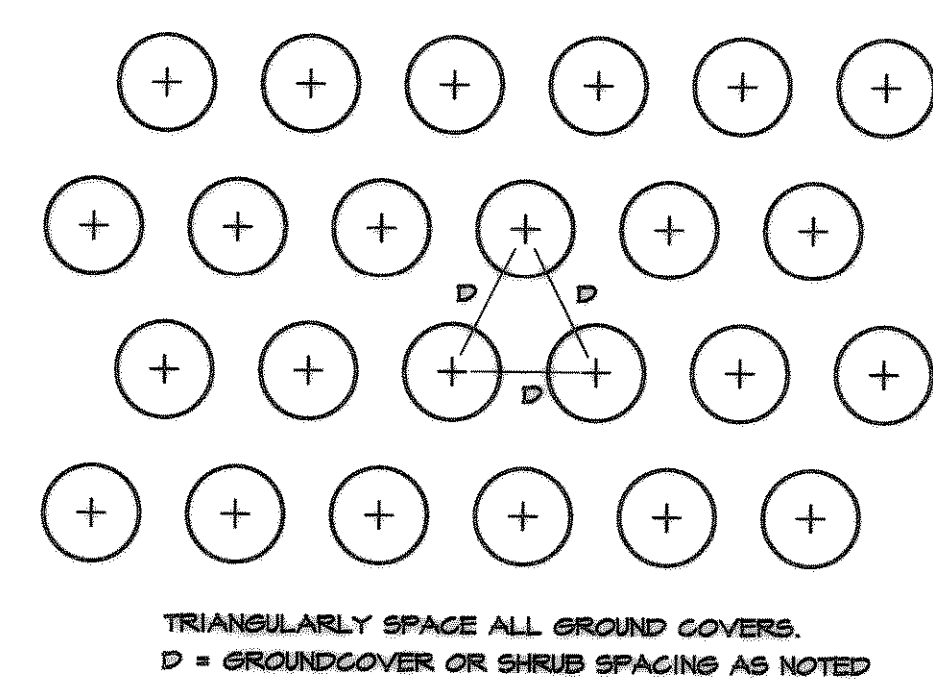

5 3' DEPTH MULCH BED DETAIL ALONG PARKING
NOT TO SCALE

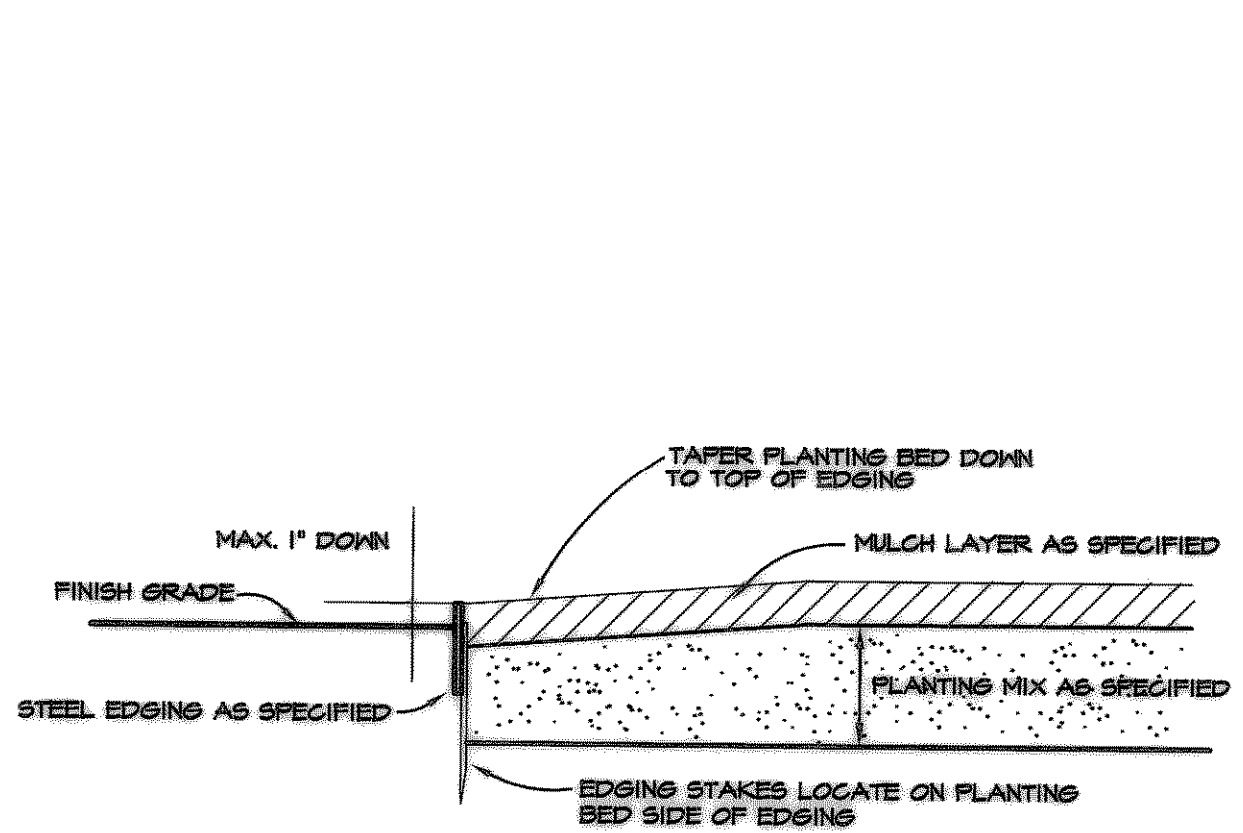

6 TYPICAL BED EDGING DETAIL
NOT TO SCALE

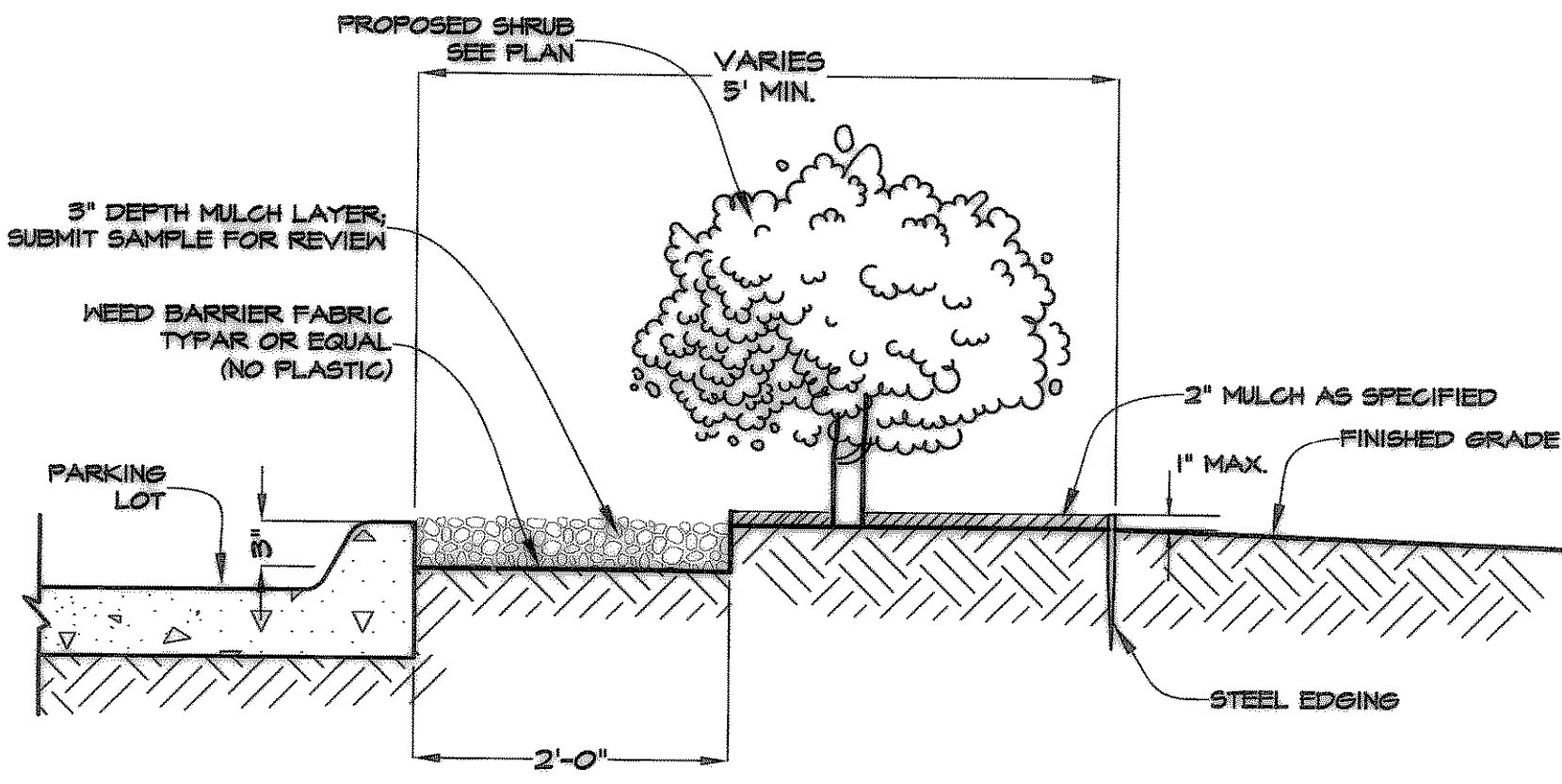

7 3' DEPTH MULCH BED DETAIL ALONG PARKING
NOT TO SCALE

"AS-BUILT" PLANS
NOTE: THE INTENT OF THE OWNER AND ENGINEER WAS TO CONSTRUCT THE IMPROVEMENTS ACCORDING TO THESE PLANS AS APPROVED BY THE CITY OF ROCKWALL. THE CONSTRUCTION OF ALIGNMENTS AND GRADES WERE VERIFIED BY JONES & BOYD IN ACCORDANCE TO THESE DOCUMENTS. WE ARE NOT AWARE OF ANY CHANGES OR REVISIONS TO THESE PLANS DURING CONSTRUCTION EXCEPT AS SHOWN ON THESE DOCUMENTS.

NO.	REVISIONS DURING CONSTRUCTION	BY	DATE	NO.	CHANGES PER CITY COMMENTS	BWC	7/5/08
1							



Jones & Boyd, Inc.
17090 Dallas Parkway, Suite 200
Dallas, Texas 75248
972.248.1616 office
972.248.1414 fax
www.jones-boyd.com

- Engineering
- Surveying
- Planning
- Landscape Architecture
- Construction Management

LANDSCAPE DETAILS		PROJECT NO.
BLOCK A, LOT 2		QUA003
NEWMAN CENTER NO. ONE		SHEET NO.
CITY OF ROCKWALL, ROCKWALL COUNTY, TEXAS		L2