

REVISION	DATE	DESCRIPTION	DRAWN BY	CHECKED BY
△	4/16/96	ADJUST PAVING FOR COMMON AREA #5.	PBS&J	CLS

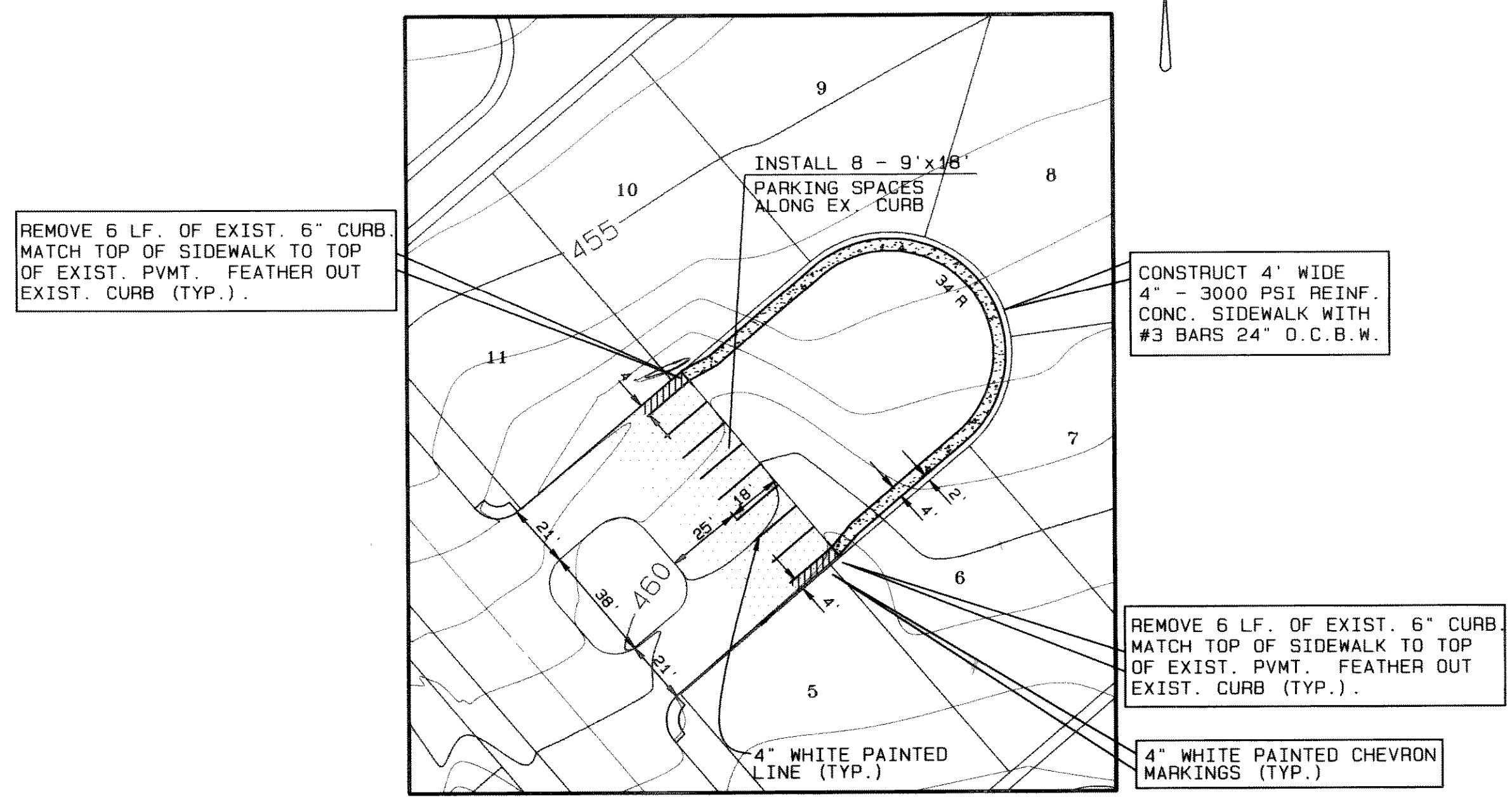

COMMON AREA NO.1
SCALE 1" = 40'

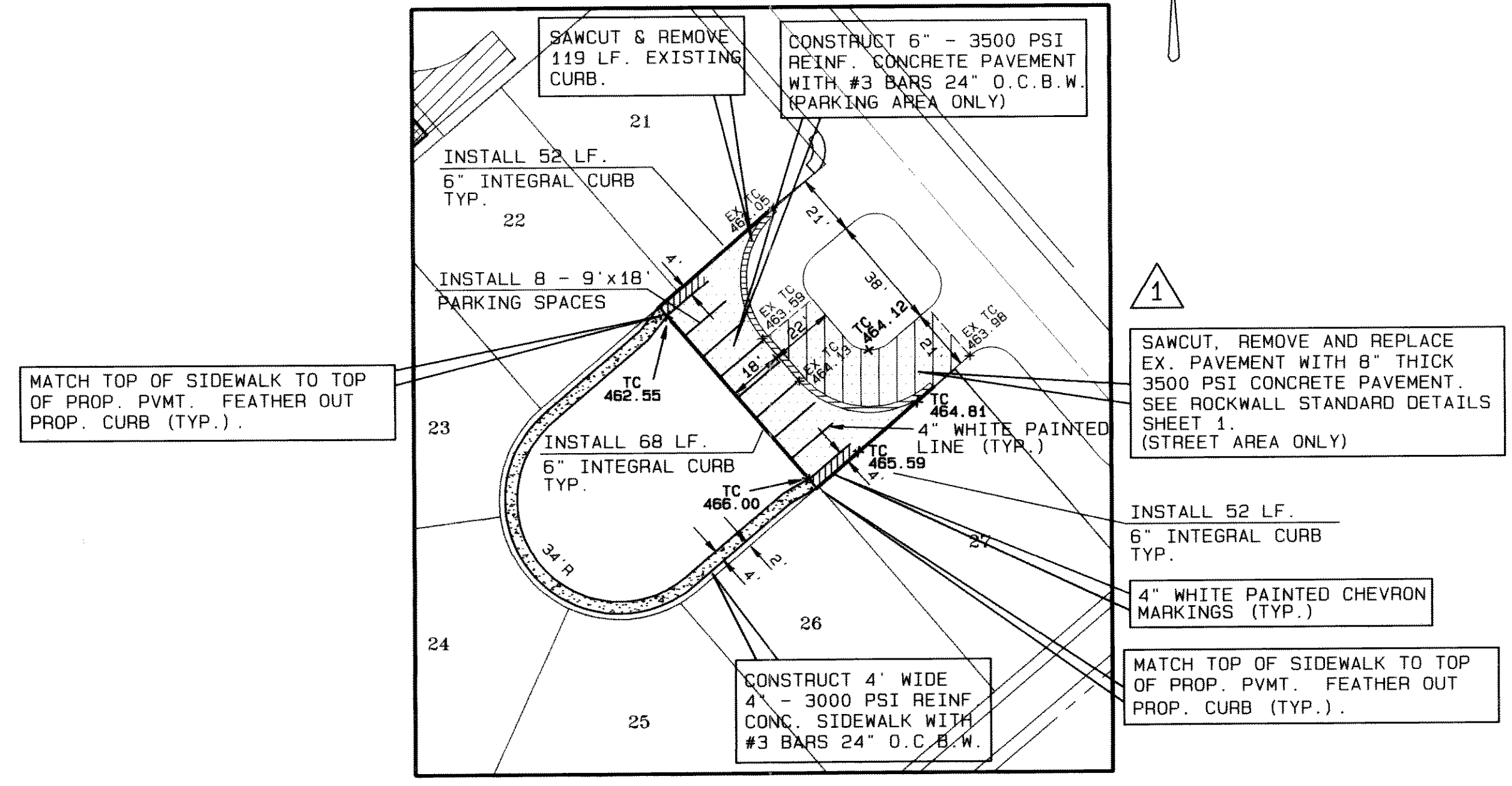

COMMON AREA NO.5
SCALE 1" = 40'

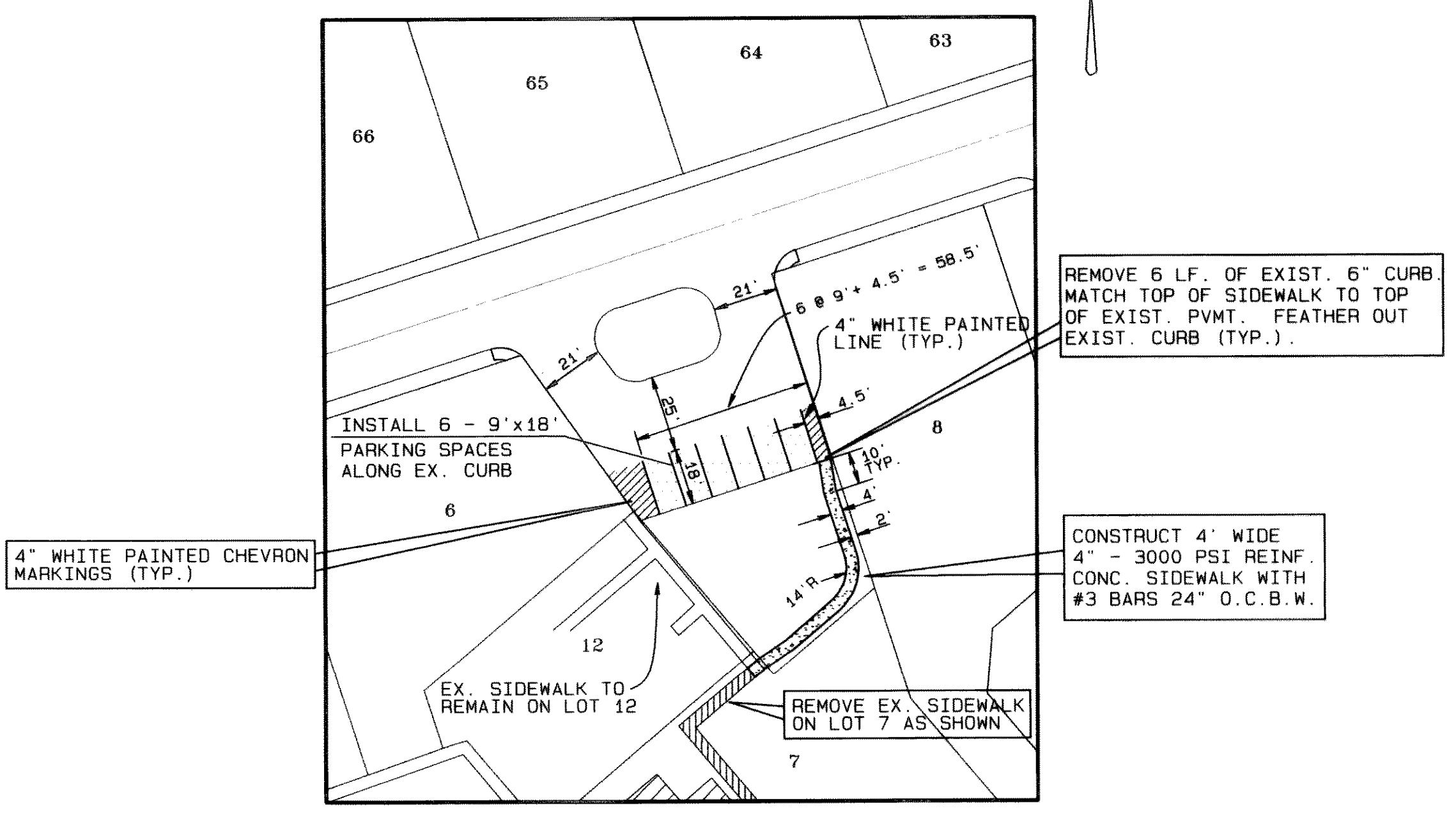

COMMON AREA NO.3
SCALE 1" = 40'

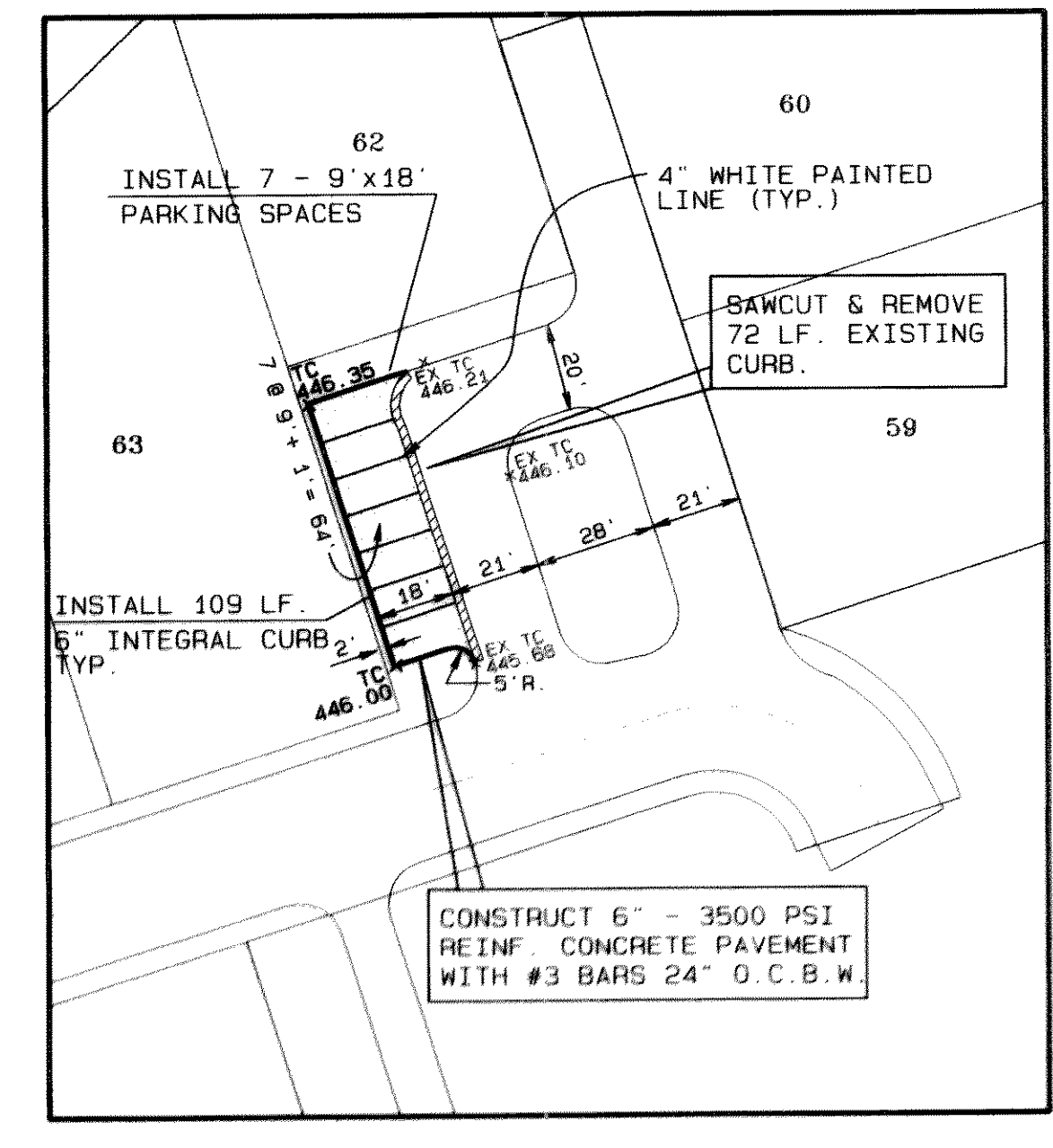

COMMON AREA NO.4
SCALE 1" = 40'

LEGEND

△ 1

TC 464.81 PROPOSED TOP OF CURB ELEVATION

EX TC 464.81 EXISTING TOP OF CURB ELEVATION

- BENCHMARKS:**
- SQUARE CUT ON NORTHEAST CURB ± 150' NORTHWEST OF RAILROAD ON TURTLE COVE BOULEVARD. ELEV. 469.36
 - SQUARE CUT ON CENTERLINE OF INLET WESTERLY FROM CLUBHOUSE ENTRANCE (#700 TURTLE COVE BLVD). ELEV. 447.21

AS BUILTS:

THE INTENT OF THE OWNER AND ENGINEER WAS TO CONSTRUCT THESE FACILITIES ACCORDING TO THESE PLANS AS APPROVED BY THE CITY OF ROCKWALL. THE LINES AND GRADES WERE SET ON THE GROUND FOR CONSTRUCTION ACCORDING TO SAID PLANS. THE CITY OF ROCKWALL INSPECTED THE CONSTRUCTION. THE OWNER NOR ENGINEER DID NOT VERIFY LINES OR GRADES AFTER CONSTRUCTION. WE ARE NOT AWARE OF ANY CHANGES OR REVISIONS TO THESE PLANS DURING CONSTRUCTION EXCEPT AS NOTED.

Clyde L. Sifford

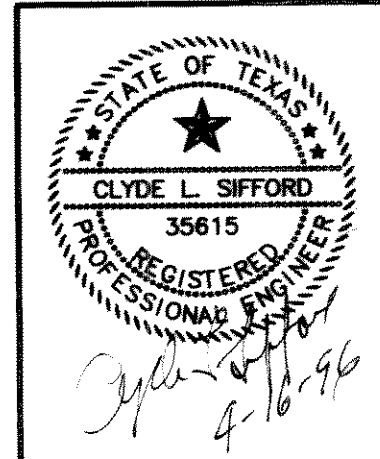

COMMON AREA IMPROVEMENT DETAILS

TURTLE COVE

ROCKWALL COUNTY, TEXAS

THE NELSON CORPORATION
PLANNING ENGINEERING SURVEYING

5099 SUMMERSIDE DRIVE SUITE 202 DALLAS, TEXAS 75252 (214) 380-2805

DESIGN	DRAWN	DATE	SCALE	FILE	SHEET NO.
TNC	TNC	04/16/96	AS NOTED	95115.00	6