

CONSTRUCTION PLANS

FOR

TURTLE COVE ADDITION

CITY OF ROCKWALL, ROCKWALL COUNTY, TEXAS

PAVING GENERAL NOTES:

1. It will be the responsibility of the Contractor to protect all public utilities in the construction of this project. All storm sewer inlets, manholes, cleanouts, valve boxes, meter boxes, fire hydrants, gas mains, electric and telephone lines and duct banks, etc. must be adjusted to proper line and grade by the Contractor prior to and after the placing of permanent paving.
2. Contractor shall have, prior to construction necessary permits, licenses etc.
3. All fill placed under paving shall be compacted to 95% Standard Proctor Density in 8 inch lifts.
4. All curbs shall be integral curbs.
5. Unless otherwise noted all material and construction shall conform to the construction specifications of the City of Rockwall with amendments latest edition. Refer to the City of Rockwall Standard Construction Details. (November, 1990) for additional requirements.
6. All curb dimensions are to back of curb.
7. Pavement reinforcing will be grade 60.
8. Construct a barrier-free curb as shown on the plans at all street intersections.
9. The Contractor will be responsible for field verifying the location of all existing utilities prior to his operations.
10. Hydrated lime will be applied as a slurry.

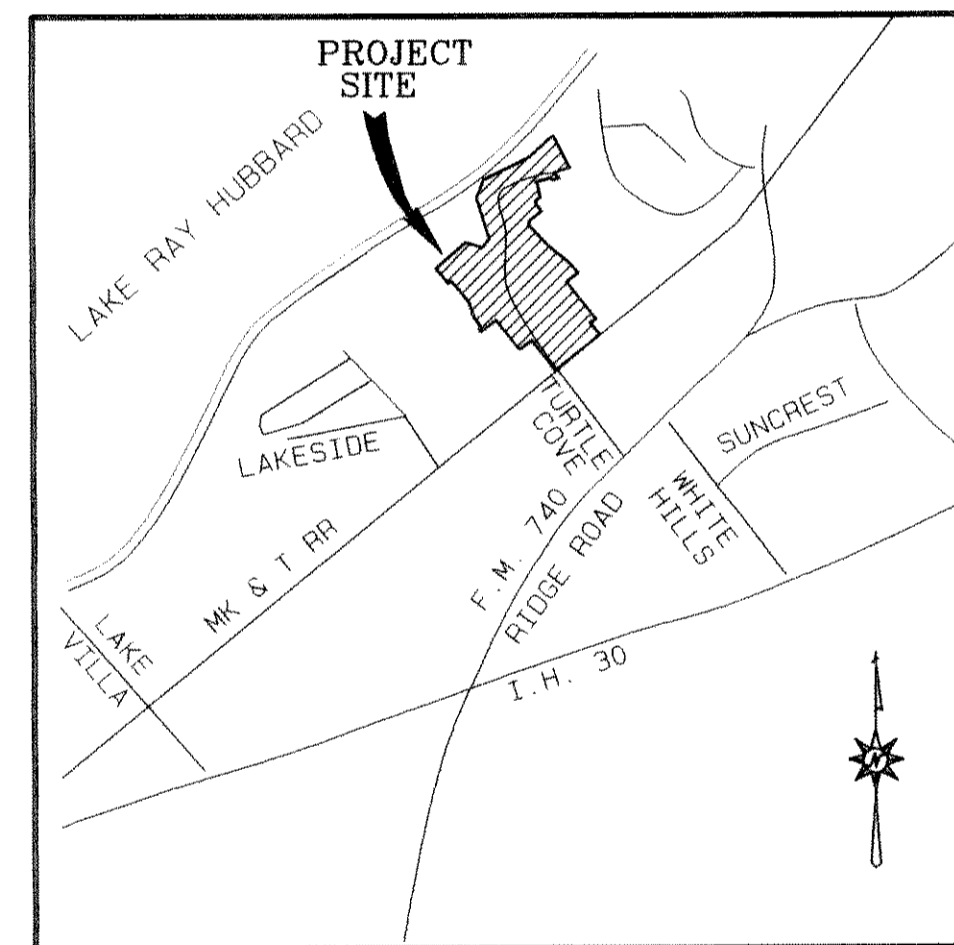

LOCATION MAP
NOT TO SCALE

INDEX TO SHEETS	
SHEET NO.	DESCRIPTION
1	COVER SHEET
2	FINAL PLAT (SECOND REPLAT)
3	FINAL PLAT (SECOND REPLAT)
4	FINAL PLAT (SECOND REPLAT)
PAVING	
5	ALLEY "A" PLAN & PROFILE
6	COMMON AREA IMPROVEMENT DETAILS
WATER AND WASTEWATER	
7	WATER AND WASTEWATER PLAN
GRADING	
8	GRADING AND EROSION CONTROL PLAN
9	GRADING AND EROSION CONTROL PLAN

ENGINEER

THE NELSON CORPORATION
5999 SUMMERSIDE DRIVE, SUITE 202
DALLAS, TEXAS 75252
(214) 380-2605

AS BUILT:

THE INTENT OF THE OWNER AND ENGINEER WAS TO CONSTRUCT THESE FACILITIES ACCORDING TO THESE PLANS AS APPROVED BY THE CITY OF ROCKWALL. THE LINES AND GRADES WERE SET ON THE GROUND FOR CONSTRUCTION ACCORDING TO SAID PLANS. THE CITY OF ROCKWALL INSPECTED THE CONSTRUCTION. THE OWNER NOR ENGINEER DID NOT VERIFY LINES OR GRADES AFTER CONSTRUCTION. WE ARE NOT AWARE OF ANY CHANGES OR REVISIONS TO THESE PLANS DURING CONSTRUCTION EXCEPT AS NOTED. *Clyde L. Sifford 6-17-96*

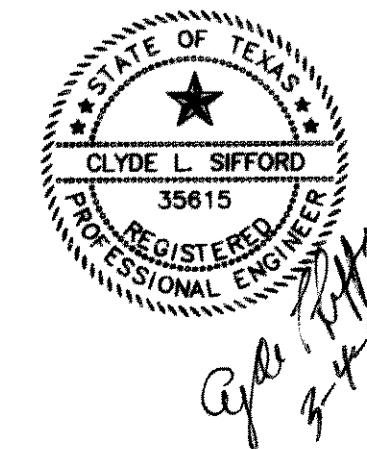

OWNER

ASHTON CUSTER, L.L.C.
15851 DALLAS PARKWAY, SUITE 100
DALLAS, TEXAS 75248
(214) 490-3255
(214) 991-4949 (Fax)