

ALLEY LOCATION MAP
N.T.S.

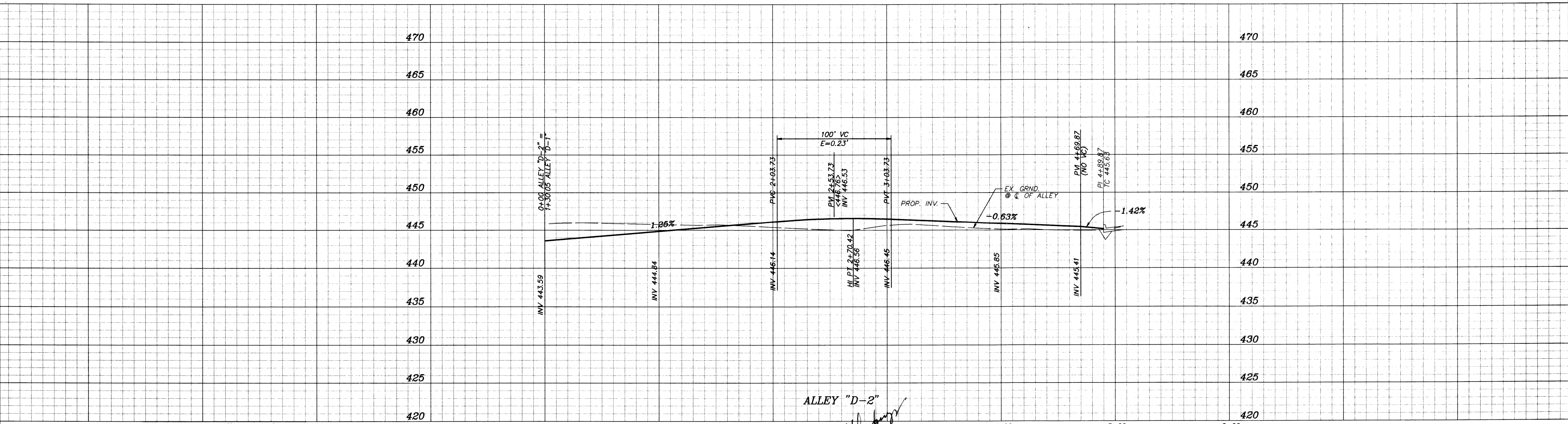

RECORD DRAWING
DATE: 7-28-00
THIS RECORD DRAWING HEREIN REFLECTS TO THE BEST OF THE DESIGN ENGINEER'S KNOWLEDGE THE APPROXIMATE LOCATION OF THE CONSTRUCTED WORK USING INFORMATION AS PROVIDED BY THE CONTRACTOR(S).

- BENCHMARKS:**
- SQUARE CUT ON NORTHEAST CURB ± 150' NORTHWEST OF RAILROAD ON TURTLE COVE BOULEVARD ELEV. 469.36
 - SQUARE CUT ON CENTERLINE OF INLET WESTERLY FROM CLUBHOUSE ENTRANCE ELEV. 447.21

NO.	REVISION	BY	DATE
0+00			
1+00			
2+00			
3+00			
4+00			
5+00			
6+00			

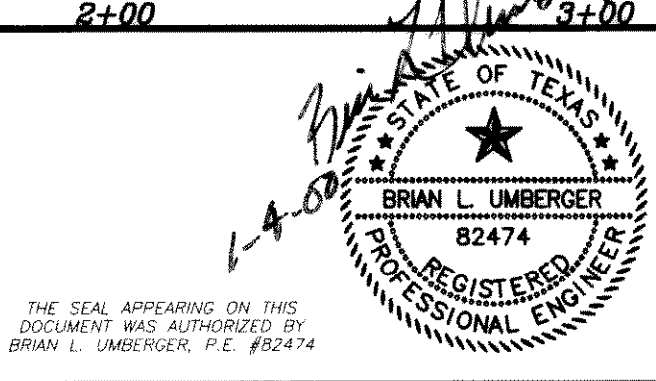

SCALE: AS SHOWN
DESIGNED: PBS&J
DRAWN: PBS&J
DATE:
DWG FILE:

PBS&J
5999 SUMMERSIDE DRIVE ~ SUITE 202
DALLAS, TEXAS 75252
PH. (972) 380-2605 FAX (972) 380-2609

PAVING PLAN & PROFILE		JOB NO.
TURTLE COVE ADDITION, PHASE 3		95115.02
ROCKWALL ROCKWALL COUNTY, TEXAS		SHEET
		13 OF 28