

CONSTRUCTION PLANS

FOR

TURTLE COVE ADDITION

PHASE 3

ROCKWALL, TEXAS

INDEX TO SHEETS	
SHEET NO.	DESCRIPTION
1	COVER SHEET
2	FINAL PLAT
3	GRADING PLAN
4	GRADING PLAN
5	LEXINGTON DRIVE (1+00 TO 6+50) / SHERWOOD DRIVE (6+50 TO 12+00)
6	SHERWOOD DRIVE (12+00 TO 15+00) / BAYPOINT DRIVE (15+00 TO END)
7	WOODLAND WAY
8	BLUFFVIEW DRIVE
9	DANIELLE COURT
10	ALLEY "B-1"
11	ALLEY "B-2", ALLEY "C"
12	ALLEY "D-1"
13	ALLEY "D-2"
14	ALLEY "D-3"
15	ALLEY "E"
16	WATER PLAN
17	SANITARY SEWER PLAN
18	SANITARY SEWER PROFILES (S-1, S-4, S-6)
19	SANITARY SEWER PROFILES (S-2, S-3, S-5)
20	DRAINAGE AREA MAP
21	STORM SEWER PLAN & PROFILE (LINE "A")
22	STORM SEWER PLAN & PROFILE (LINE "B" & LAT "D-1")
23	STORM SEWER PLAN & PROFILE (LINE "C" & "D")
24	STORM SEWER PLAN & PROFILE (LINE "E" & LAT "C-2")
25	S.W.P.P.P. (EXCAVATION)
26	S.W.P.P.P. (UTILITY)
27	S.W.P.P.P. (PAVING)
28	S.W.P.P.P. (STANDARD DETAILS)

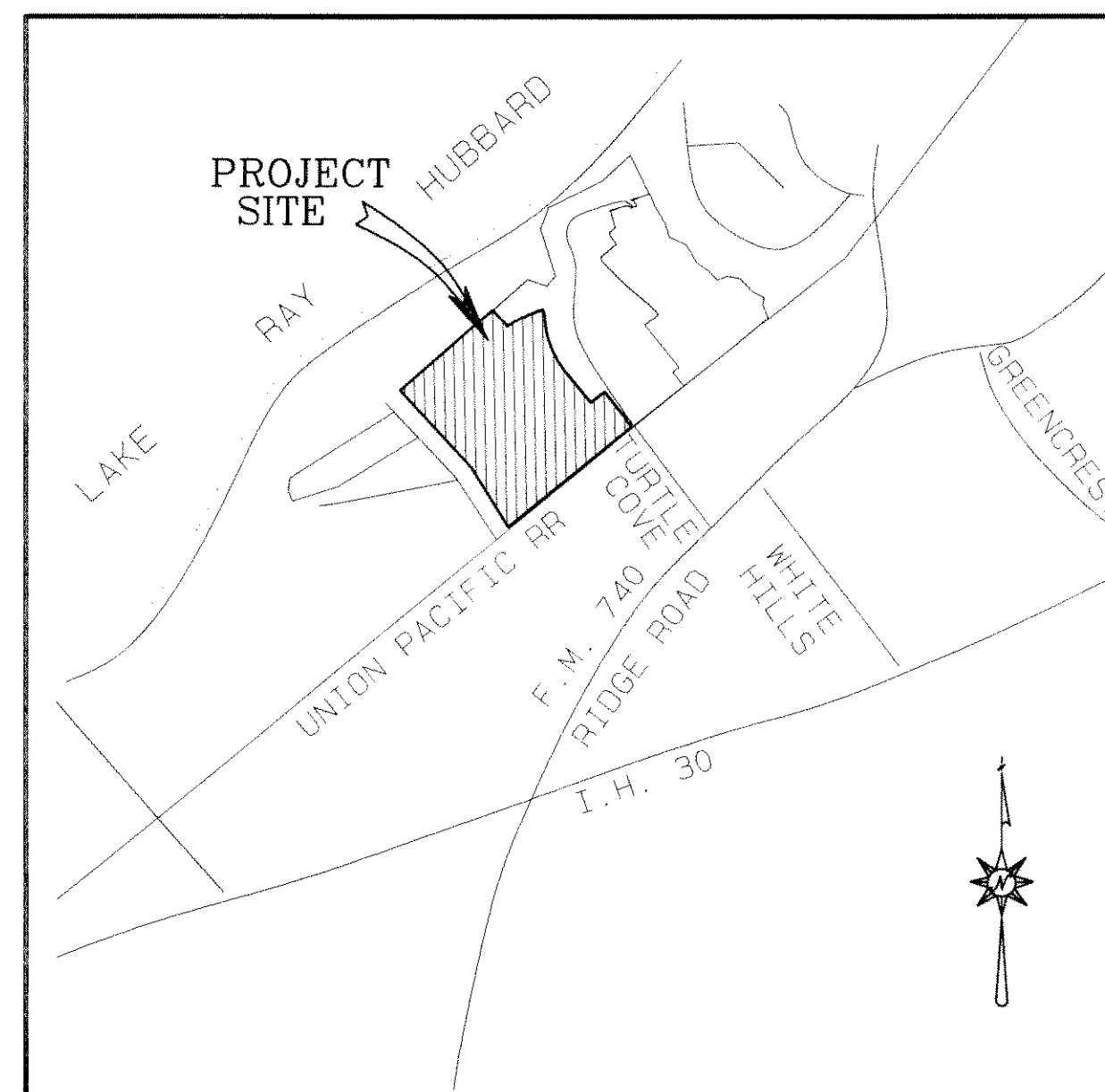

LOCATION MAP
NOT TO SCALE

DRAINAGE GENERAL NOTES

1. Unless otherwise noted, all material and construction shall conform to applicable specifications of the City of Rockwall, with amendments, The North Central Council of Governments, "Standard Specifications for Public Works Construction" Parts II and III, latest edition. Refer to applicable City of Rockwall "Standard Construction Details", latest edition (Rev. January, 1993).
2. All reinforcement will be grade 60.
3. Jetting of embedment and backfill will not be allowed as a method of compaction.
4. Minimum compaction adjacent to and above storm sewers and drainage structures will be 95% with moisture 1% to 3% wet of optimum in all rights-of-way. Compaction in other areas will be 90%. Lifts will not exceed 6" and results will be obtained by Ramex, hand-tamping or as approved in writing by the owner's representative.
5. All curved storm sewers having a radius of less than 200 feet shall be constructed with factory beveled joints. No joint will be allowed to have a tongue exposed by more than one-half.
6. Contractor will be responsible for field verifying the location of all existing utilities prior to his operations.

PAVING GENERAL NOTES

1. Unless otherwise noted, all material and construction shall conform to applicable specifications of the City of Rockwall with amendments - The North Central Texas Council of Governments "Standard Specifications for Public Works Construction", Parts II and III, latest edition. Refer to applicable City of Rockwall "Standard Construction Details", latest edition (Rev. January, 1993).
2. All curb dimensions are to back of curb.
3. Pavement reinforcing will be grade 60.
4. For details of paving joints see Rockwall's "Standard Construction Details", Sheet SD-3.
5. Hydrated lime will be applied as a slurry.
6. Construct a barrier-free curb and ramp at all street intersections. See Rockwall's "Standard Construction Details", Sheet SD-133.
7. Contractor will be responsible for field verifying the location of all existing utilities prior to his operations.
8. Installation, maintenance and removal of traffic safety devices for all construction in or contiguous to existing pavement, will be at the expense of the contractor and will follow as a guide "The Manual of Uniform Traffic Control Devices", latest edition.
9. Unless shown otherwise, all street pavement on this project will be 6"-3600 psi on 6"-6% lime min. and all alley paving will be 7"-5"-7" (See Alt. Section) both having a minimum compressive strength of 4000psi at 28 days (each min. of cement/CY). Refer to City of Rockwall Standard Details Sheets SD-P01 through SD-P19 for additional reference. All street pavement will be constructed on a 6" lime stabilized subbase with lime applied at a minimum rate as directed in the geotechnical report, but not less than 27#/CY and compacted to a density not less than 95 percent, laboratory tests must be submitted to the engineering department for approval to determine amount of lime required. Laboratory test may be waived provided at least 36 lbs. of lime per sq. yd. is used. SEE ITEM 4.6.4 SPECIAL PROVISIONS.
10. Upon completion of utility work and prior to lime stabilization operations, the engineer will verify areas that can suitably be stabilized and other areas which, in his opinion, may require additional removal of weathered shale. Remove the weathered shale at the direction of the engineer as follows:
 - A. To a point 1 foot behind the back of curb.
 - B. To a point 6" below the bottom of the proposed pavement.
11. Replace this excavated shale with an approved onsite material and continue lime stabilization.
12. Bar chairs or an approved device shall be furnished.
13. Bar laps shall be thirty diameters.

PLANNER-ENGINEER-SURVEYOR



PBS&J, INC.
5999 SUMMERSIDE DRIVE ~ SUITE 202
DALLAS, TEXAS 75252
PH. (972) 380-2605 FAX (972) 380-2609

BENCHMARKS:

1. SQUARE CUT ON NORTHEAST CURB ± 150' NORTHWEST OF RAILROAD ON TURTLE COVE BOULEVARD ELEV. 469.36
2. SQUARE CUT ON CENTERLINE OF INLET WESTERLY FROM CLUBHOUSE ENTRANCE ELEV. 447.21



RECORD DRAWING

DATE: 7-28-00

THIS RECORD DRAWING HEREIN REFLECTS TO THE BEST OF THE DESIGN ENGINEER'S KNOWLEDGE THE APPROXIMATE LOCATION OF THE CONSTRUCTED WORK USING INFORMATION AS PROVIDED BY THE CONTRACTOR(S).

OWNER-APPLICANT

ASHTON CUSTER, L.L.C.
15851 DALLAS PARKWAY, SUITE 100
DALLAS, TEXAS 75248
(972) 490-3255