

OWNER HAS PROVIDED A TREE SURVEY OF AREA FOR DESIGN OF THE BEST ALIGNMENT. OWNER WILL COMPLY WITH THE CITY OF ROCKWALL TREE ORDINANCE. CURRENT STORM SEWER ALIGNMENT DOES NOT CONFLICT WITH THE ROCKWALL TREE ORDINANCE.

OWNER HAS PROVIDED A TREE SURVEY OF AREA FOR DESIGN OF THE BEST ALIGNMENT. OWNER WILL COMPLY WITH THE CITY OF ROCKWALL TREE ORDINANCE. CURRENT STORM SEWER ALIGNMENT DOES NOT CONFLICT WITH THE ROCKWALL TREE ORDINANCE.

EXISTING TREES WILL NOT BE DISTURBED

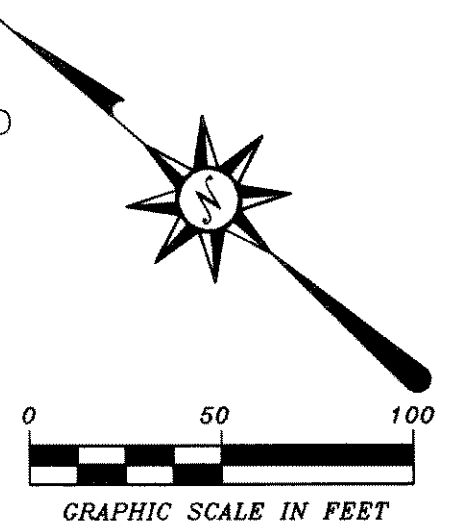

R=5696.19'  
A=00°36'13"  
L=60.02'  
CB=548°17'14"W  
C=60.02'

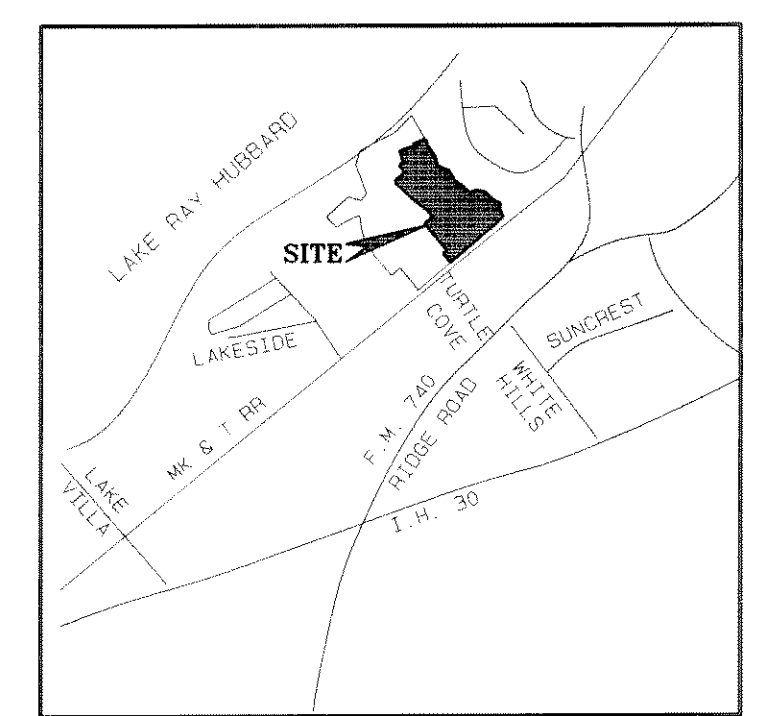

LOCATION MAP  
MAPSCO PAGE 30C  
ROCKWALL, TEXAS

EXISTING CEDAR FENCE WITH GALVANIZED STEEL POSTS ON ROW LINE

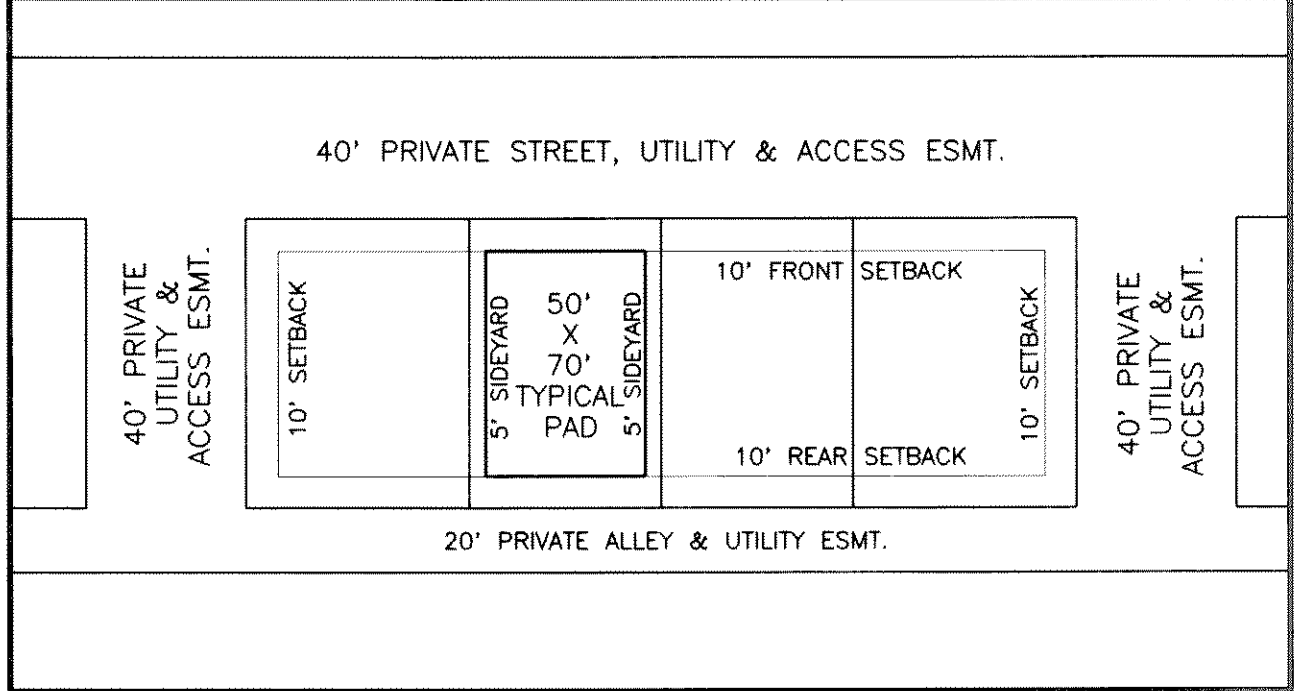

TYPICAL BUILDING SETBACKS

- GENERAL NOTES
- 1.) PROPOSED PRIVATE ALLEY RIGHT-OF-WAY IS 20' WIDE.
  - 2.) PROPOSED PRIVATE STREET RIGHT-OF-WAY IS 40' WIDE.
  - 3.) FOR PROPOSED UTILITY EASEMENTS REFER TO PRELIMINARY PLAT.

- TREE LEGEND
- O = OAK
  - P = PECAN
  - H = HACKBERRY
  - LO = LIVE OAK
  - W = WILLOW
  - A = ASH
  - E = ELM

TYPICAL TREE DESCRIPTION  
14E = 14" DIAMETER ELM

RECORD DRAWINGS  
THE INTENT OF THE OWNER AND ENGINEER WAS TO CONSTRUCT THE FACILITIES ACCORDING TO THESE PLANS AS APPROVED BY THE CITY OF ROCKWALL. THE LINES AND GRADES WERE SET ON THE GROUND FOR CONSTRUCTION ACCORDING TO SAID PLANS. THE CITY OF ROCKWALL INSPECTED THE CONSTRUCTION. THE OWNER OR ENGINEER DID NOT VERIFY LINES OR GRADES AFTER CONSTRUCTION. WE ARE NOT AWARE OF ANY CHANGES OR REVISIONS TO THESE PLANS DURING CONSTRUCTION EXCEPT AS NOTED.

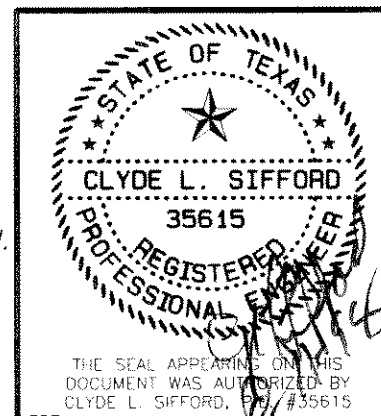

TREESCAPE PLAN					
TURTLE COVE ADDITION, PHASE 2					
CITY OF ROCKWALL, TEXAS					
DESIGN		DATE	SCALE	FILE	SHEET NO.
PBSJ	PBSJ		AS SHOWN	95115.01	14

POST, BUCKLEY, SCHUH & JERNIGAN, INC.  
5999 SUMMERSIDE DRIVE ~ SUITE 202  
DALLAS, TEXAS 75252  
PH. (972) 380-2605 FAX (972) 380-2609