

1" = 10'

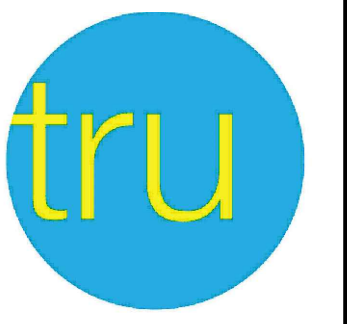

by HILTON™

teague nall and perkins, inc
823 Walters Creek Blvd., Suite M900
Allen, Texas 75013
214.461.9867 ph 214.461.9864 fx
www.tnpi.com

TBPE: F-230; TBPLS: 10011600, 10011601, 10194381



PROPOSED 4' CONCRETE FLUME TO BE INSTALLED BETWEEN PROPERTY LINE AND RETAINING WALL. RE: DETAIL ON THIS SHEET

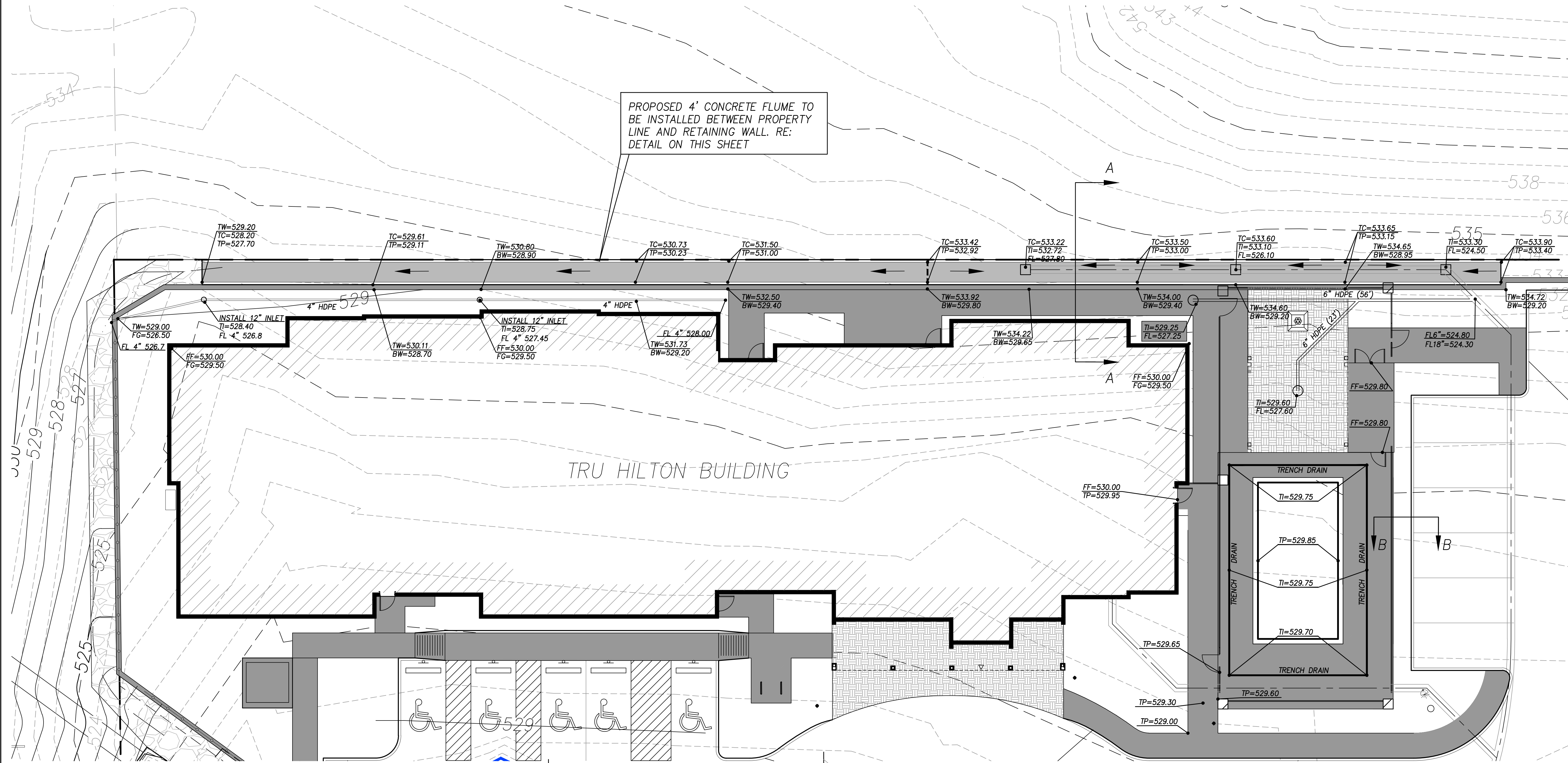

4' CONCRETE FLUME
W/ 6" CURB
EXISTING GRADE

12" PROPOSED
RETAINING WALL

TRU HILTON
BUILDING

POOL DECK
W/TURN DOWN.
RE: STRUCTURAL

4:1 MAX. SLOPE IN
LANDSCAPE AREA

6" CONCRETE
CURB
PARKING LOT
PAVEMENT

PROP. LINE

PROPOSED
18" RCP

SECTION A-A
N.T.S.

SECTION B-B
N.T.S.

9/2/2020



C. A. Slowin

RECORD DRAWINGS

PROJECT:
TRU by HILTON
2600 SUMMERLEE DRIVE
ROCKWALL, TEXAS 75087

CLIENT:
MHC Rockwall, LLC.
1468 KIMBROUGH ROAD, SUITE 103
GERMANTOWN, TENNESSEE 38138

©2018 GARY BRINK & ASSOC.
Any duplication, reproduction, or use by any
other party is prohibited unless prior written
authorization is received from GARY BRINK &
ASSOC.

PROJECT: 201709
DRAWN BY: C.A.S.
DATE: 9/2/2020
SCALE: AS NOTED

CASE NO.

GRADING
PLAN

C6.1