

1/2" IRS W/ CAP "PATE ENGRS."
FROM WHICH A FOUND
CONCRETE HWY MON BEARS
S 56° 06' 10" W 0.66'

1/2" IRS W/ CAP
"PATE ENGRS."
FROM WHICH A FOUND
CONCRETE HWY MON BEARS
S 80° 23' 07" W 1.24'

7.5' WATERLINE EASEMENT
VOL. 64, PG. 199
D.R.R.C.T.

INTERSTATE HIGHWAY 30
(VARIABLE WIDTH R.O.W.)
(NORTH BOUND SERVICE ROAD)

N 44° 32' 00" E
355.30'

N 44° 32' 00" E
94.54'

N 36° 25' 00" E
268.67'

N 36° 25' 00" E
95.48'

N 36° 25' 00" E
123.27'

1/2" IRS W/ CAP
"PATE ENGRS."

S 39° 08' 32" W
2.79176'

S 39° 08' 32" W
2.79176'

S 39° 36' 51" E
86.84'

S 87° 57' 42" E
69.872'

N 89° 19' 28" E
95.29'

N 89° 19' 28" W
95.23'

N 45° 28' 00" W
128.08'

N 45° 16' 55" W
188.16'

N 45° 16' 55" W
211.06'

N 45° 02' 41" E
178.76'

N 45° 02' 41" W
175.21'

N 44° 55' 43" W
958.27'

N 44° 55' 43" W
958.27'

N 44° 55' 43" W
958.27'

S 29° 53' 39" E
70.45'

S 29° 17' 27" E
82.80'

N 60° 42' 33" E
26.82'

S 29° 53' 39" E
153.15'

N 44° 49' 26" E
514.11'

N 44° 33' 39" E
231.19'

S 44° 33' 36" W
455.08'

S 44° 33' 36" W
455.08'

S 44° 33' 36" W
455.08'

S 44° 33' 36" W
455.08'

S 44° 33' 36" W
455.08'

S 44° 33' 36" W
455.08'

233.50'

122.86'

70.45'

161.10'

82.80'

26.82'

153.15'

427.21'

124.79'

102.83'

259.00'

259.00'

7.50'

7.50'

7.50'

7.50'

7.50'

7.50'

7.50'

7.50'

7.50'

7.50'

7.50'

7.50'

7.50'

7.50'

7.50'

7.50'

7.50'

7.50'

7.50'

7.50'

7.50'

7.50'

7.50'

7.50'

7.50'

7.50'

7.50'

7.50'

7.50'

7.50'

7.50'

7.50'

7.50'

7.50'

7.50'

7.50'

7.50'

7.50'

7.50'

7.50'

7.50'

7.50'

7.50'

7.50'

7.50'

7.50'

7.50'

7.50'

7.50'

7.50'

7.50'

7.50'

7.50'

7.50'

7.50'

7.50'

7.50'

7.50'

7.50'

7.50'

7.50'

7.50'

7.50'

7.50'

7.50'

7.50'

7.50'

7.50'

7.50'

7.50'

7.50'

7.50'

7.50'

7.50'

7.50'

7.50'

7.50'

7.50'

7.50'

7.50'

7.50'

7.50'

7.50'

7.50'

7.50'

7.50'

7.50'

7.50'

7.50'

7.50'

7.50'

7.50'

7.50'

7.50'

7.50'

7.50'

7.50'

7.50'

7.50'

7.50'

7.50'

7.50'

7.50'

7.50'

7.50'

7.50'

7.50'

7.50'

7.50'

7.50'

7.50'

7.50'

7.50'

7.50'

7.50'

7.50'

7.50'

7.50'

7.50'

7.50'

7.50'

7.50'

7.50'

7.50'

7.50'

7.50'

7.50'

7.50'

7.50'

7.50'

7.50'

7.50'

7.50'

7.50'

7.50'

7.50'

7.50'

7.50'

7.50'

7.50'

7.50'

7.50'

7.50'

7.50'

7.50'

7.50'

7.50'

7.50'

7.50'

7.50'

7.50'

7.50'

7.50'

7.50'

7.50'

7.50'

7.50'

7.50'

7.50'

7.50'

7.50'

7.50'

7.50'

7.50'

7.50'

7.50'

7.50'

7.50'

7.50'

7.50'

7.50'

7.50'

7.50'

7.50'

7.50'

7.50'

7.50'

7.50'

7.50'

7.50'

7.50'

7.50'

7.50'

7.50'

7.50'

7.50'

7.50'

7.50'

7.50'

7.50'

7.50'

7.50'

VICINITY MAP

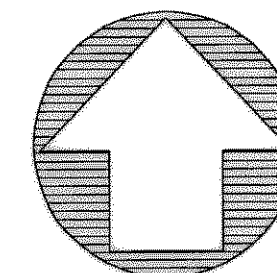
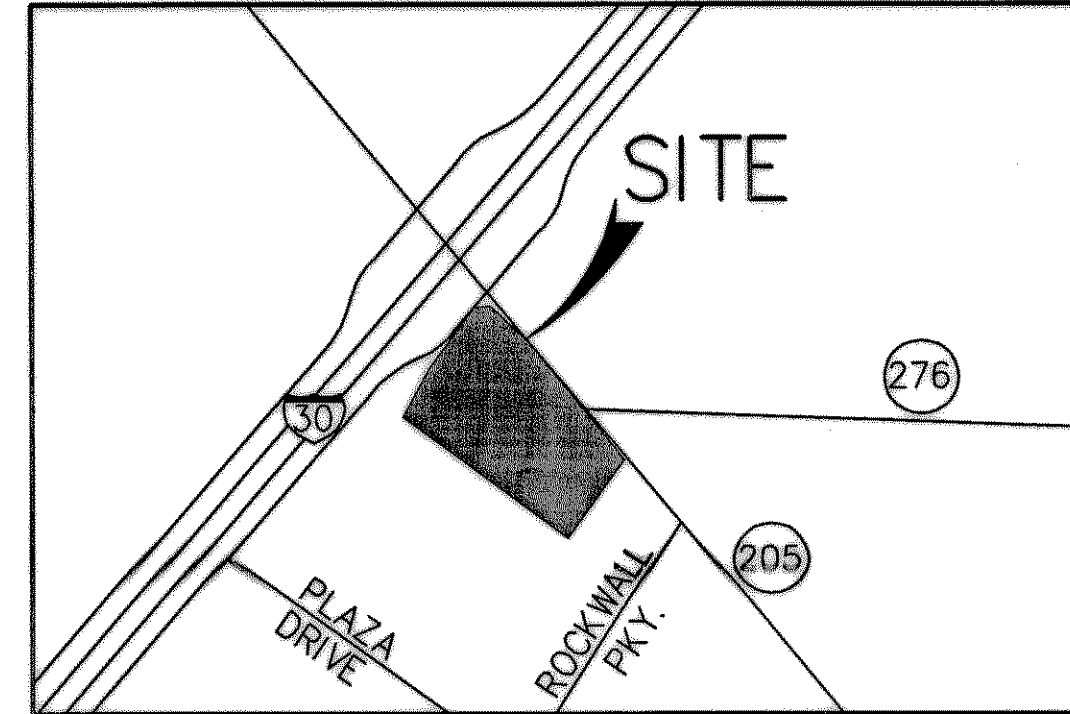

GRAPHIC SCALE

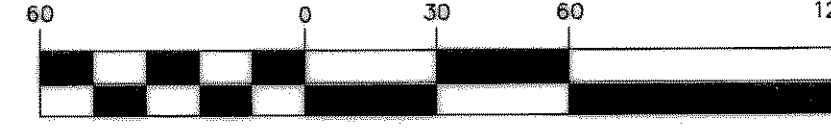

(IN FEET)
1 inch = 60 ft.

POINT OF BEGINNING

JOSEPH CADLE SURVEY
ABSTRACT NUMBER 65

LOT 1, BLOCK A
10.6163 ACRES
462,444.58 SQ. FT.

NATIONAL AUTO/TRUCKSTOPS INC.
VOL. 779, PG. 184
D.R.R.C.T.
ZONED "C"

LOT 2, BLOCK A
2.4536 ACRES
106876.74 SQ. FT.

ROCKWALL BUSINESS PARK EAST PHASE 2
LOT 1, BLOCK A
CAB. B, SLIDE 143
M.R.R.C.T.

J.D. McFARLAND SURVEY
ABSTRACT NUMBER 145

ROCKWALL BUSINESS PARK EAST PHASE 1
LOT 1, BLOCK A
CAB E, SLIDE 265-266
M.R.R.C.T.

LEGEND

- C.M. CONTROLLING MONUMENT
- HWY. HIGHWAY
- MON. MONUMENT

RECORD DRAWING

REVISED TO REFLECT KNOWN CHANGES MADE DURING CONSTRUCTION.

DATE

OWNER: TRAVEL CENTERS OF AMERICA
24601 CENTER RIDGE RD., STE. 200
WESTLAKE, OHIO 44145-5634
PHONE: (404) 808-7378
CONTACT: RICHARD LAWRENCE

FINAL PLAT
LOT 1, BLOCK A
TRAVEL CENTERS
OF AMERICA ADDITION
BEING 13.167 ACRES

LOCATED IN THE
JOSEPH CADLE SURVEY, ABSTRACT NO. 65
AN ADDITION TO THE
CITY OF ROCKWALL, ROCKWALL COUNTY, TEXAS

PATE ENGINEERS

8150 BROOKRIVER DRIVE, SUITE S-700, DALLAS, TEXAS 75247
TEL: (214) 357-2981 FAX (214) 357-2985
JOB NO. 078700402 SHEET 1 OF 3

DATE: JULY 27, 2004

X:\PROJECTS\98-4\2\rockwall\078\00402\SURVEY\98-4\2\1p1.dwg 11/9/2004 3:10:11 PM CSI

X:\PROJECTS\98-4\2\rockwall\078\00402\SURVEY\98-4\2\1p1.dwg 11/9/2004 3:10:11 PM CSI