

GOLIAD STREET
(HIGHWAY NO. 205)
(VARIABLE WIDTH R.O.W.)

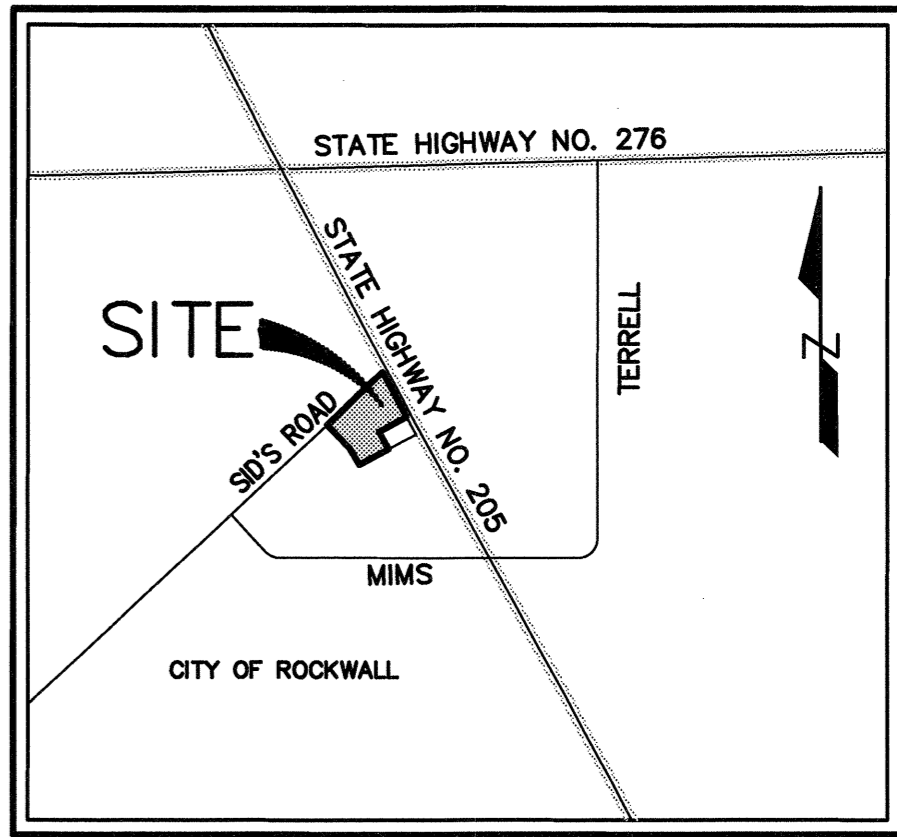
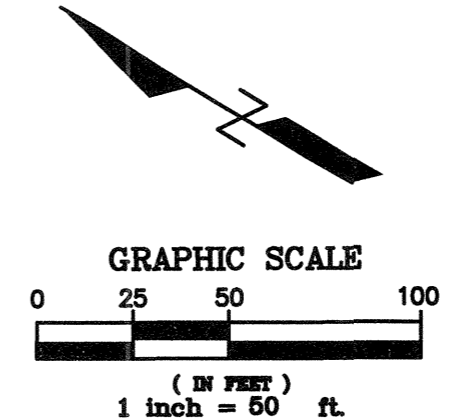

EXISTING	LEGEND	PROPOSED
---	PROPERTY LINE	---
---	PAVEMENT	---
---	CONTOUR	---
---	WATER LINE W/ F.H. & METERS	---
---	SAN. SEW. LINE	---
---	STM. SEW.	---
---	TELE. LINE	---
---	ELEC. LINE	---
---	GAS LINE	---
---	OVERHEAD ELECTRIC POWER LINES	---
---	POWER POLE	---
---	FIRE LANE	---
---	CONCRETE PAVT	---
---	FENCE	---

LOCATION MAP
MAPSCO 30D-E

THE SEAL APPEARING ON THIS DOCUMENT WAS AUTHORIZED BY
JUAN J. VASQUEZ, P.E.-88822, ON
12/09/10

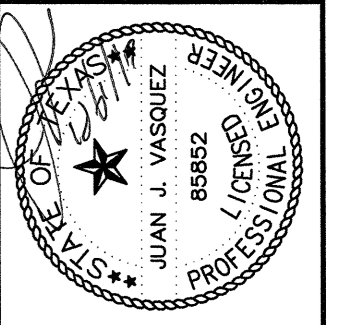

TRANAM TRUCKING, INC.
2670 SOUTH GOLIAD
ROCKWALL, TEXAS 75032
PHONE: 972-722-0673
FAX: 972-961-9050

SITE PLAN

TRANAM TRUCKING, INC.
LOT 1, BLOCK A
CITY OF ROCKWALL, ROCKWALL COUNTY, TEXAS

SITE SUMMARY TABLE	
County	ROCKWALL
Project Name	TRANAM TRUCKING, INC. - ROCKWALL, TEXAS
Zoning District	PD 44
Proposed use	TRUCKING - TRAINING AND PARKING
Site Area:	8.82 Acres 384,210 Sq. Ft.
Building Area	23,260 Sq.Ft. (EXISTING)
Building Height:	EXISTING
Lot Coverage:	23,260 / 384,210 = 6.1% (EXISTING)
Floor Area Ratio:	23,260 s.f. / 384,210 = 06.05:1 (EXISTING)
Parking Required:	EXISTING
Parking Provided:	EXISTING
Impervious Area:	320,682 S.F.
Impervious Area Ratio:	320,682 S.F. / 384,210 = 83.5%
Pervious Area Ratio:	63,548 S.F. / 384,210 = 16.5% (OPEN SPACE)

- SITE PLAN NOTES:**
- Boundary per filed plat recorded in Cabinet D, Slide 107, P.R.R.C.T., Topographic Survey by Peiser Surveying Company, dated 01/05/09.
 - See sheet C1 for Paving and Layout Plan.
 - See sheet C2 for Grading and Drainage Plan.
 - See sheet C3 for Utility Plan.
 - See sheet C5 for Detention Calculations and Details.
 - See sheet C7 for General Notes and Details.
 - See sheet L1 & L2 for Landscaping Plans.
 - Mark fire lane to city specification. "NO PARKING FIRE LANE" Every 25' white 4" letters on a 6" red striped background.
 - Electric gates that cross fire lane are required to be provided with the emergency ingress system for the fire department. A permit for such system shall be obtained from the Rockwall Fire Department.

BENCHMARK
Elevations are based on City of Rockwall survey Control Monument No. M929, NAVD 88 Elevation of 524.552 feet.

RECORD DRAWING

THE IMPROVEMENTS SHOWN ON THIS PLAN WERE COMPLETED IN GENERAL COMPLIANCE WITH THE DESIGN PLANS TO THE BEST OF OUR KNOWLEDGE. THIS DETERMINATION WAS MADE BASED ON POST-CONSTRUCTION SURVEY DATA AND INFORMATION PROVIDED BY THE CONTRACTOR.

SIGNED _____ DATE 12/6/10
VASQUEZ ENGINEERING, TEXAS REG. F-12266

Scale: 1" = 50'
Designed by: J.J.V.
Drawn by: J.N.M.
Checked by: J.J.V.
508-01.dwg 01/05/09 P1.dwg
05/18/10

SHEET
SP1