

**Notes:**  
 Bearings shown hereon based on survey performed by Surdukan Surveying, Inc., dated November 16, 2005.  
 X, Y, and X coordinates shown hereon based on GPS observations taken from City of Rockwall Monument #M929.  
 By graphic plotting only, this property is within Zone "X", areas outside of a 100 yr. flood plain as shown by FIRM Map Community Panel Number 4805470005C, dated 06/16/1992. No surveying was done to determine this flood zone.

JEFF & JOAN ELLEN HALPIN  
 VOL. 3630, PG. 293

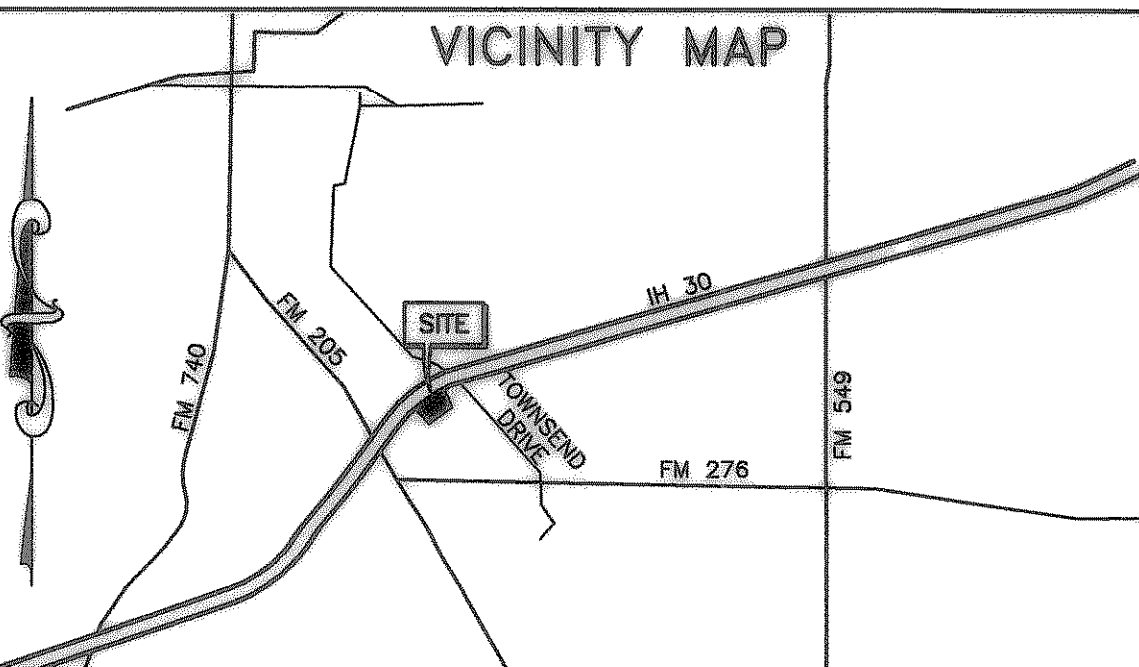

**LEGEND**

○ 5/8" IRF	5/8" IRON ROD FOUND
○ XFND	CHISELED X CUT IN CONCRETE FOUND
○ XSET	CHISELED X CUT IN CONCRETE SET
○ 5/8" IRF	5/8" IRON ROD WITH CAP MARKED "WEBB-4125" SET

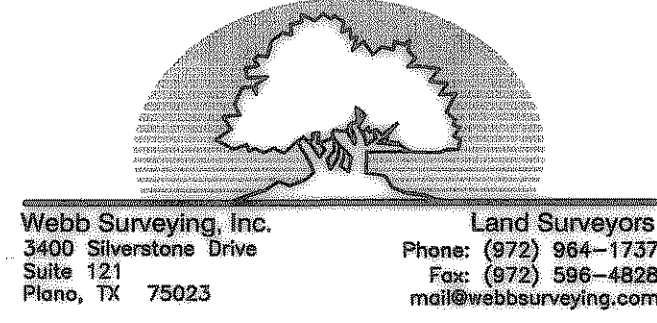

**FINAL PLAT OF LOT 1, BLOCK 1 TOYOTA OF ROCKWALL**  
 BEING A 11.2561 ACRE TRACT OF LAND  
 SITUATED IN THE JOSEPH CADLE SURVEY, ABSTRACT NO. 65,  
 CITY OF ROCKWALL, ROCKWALL COUNTY, TEXAS.  
 SHEET 1 OF 3 DATE: 3/19/07