

THE SEAL APPEARING ON THIS DOCUMENT WAS AUTHORED BY W.L. DOUPHRATE II, TEXAS P.E. NO. 80102 ON 7/11

DOUPHRATE & ASSOCIATES, INC.
 ENGINEERING • PROJECT MANAGEMENT • SURVEYING
 2235 RIDGE RD., # 200 ROCKWALL, TEXAS 75087
 PHONE: (972)771-9004 FAX: (972)771-9005

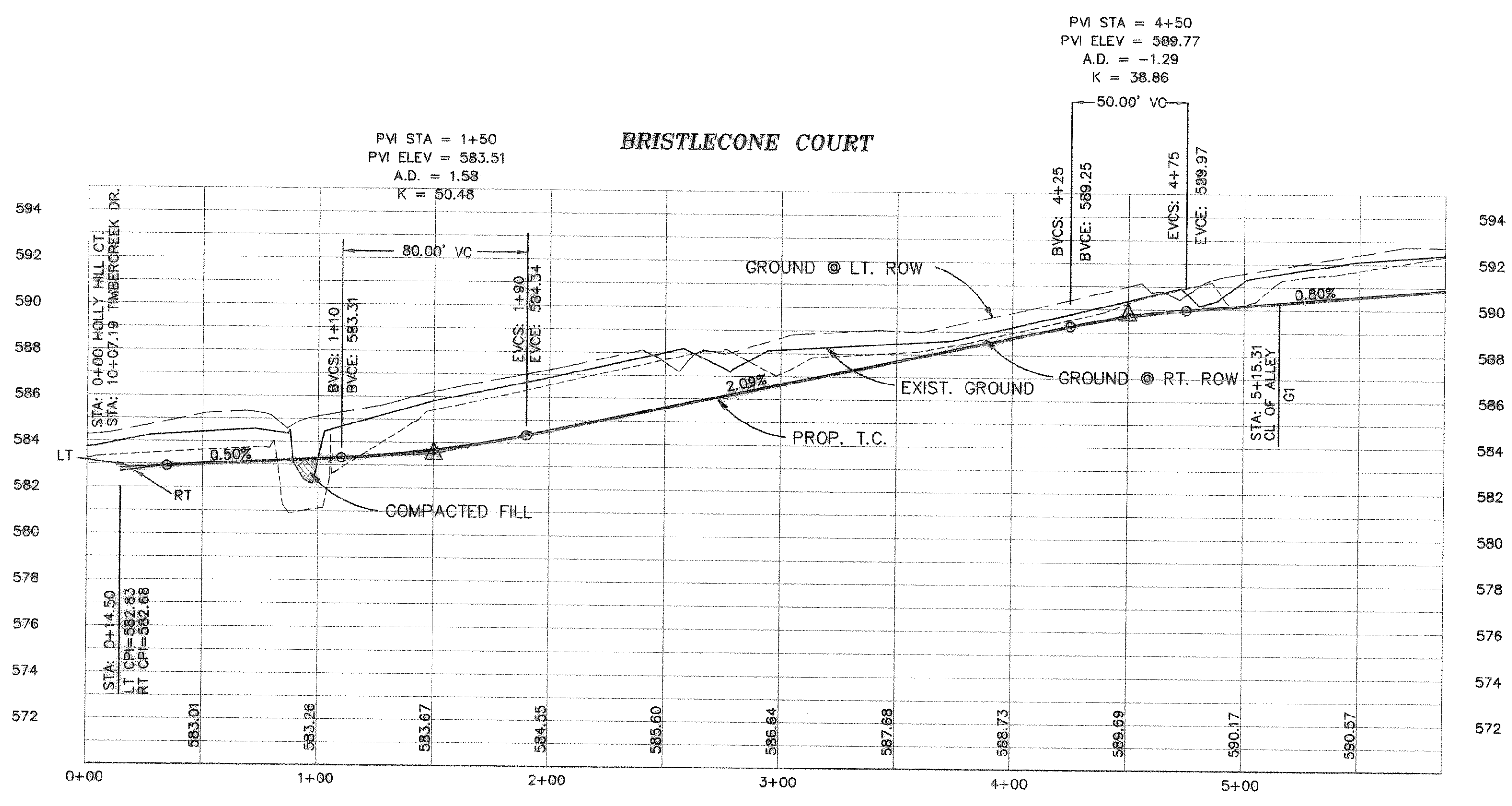

REVISED TO CONFORM TO CONSTRUCTION RECORDS.
WLD
 DATE: 5/23/07

BENCHMARK:
 T.C. CENTERLINE OF INLET ON WEST SIDE OF SILVER VIEW LANE BETWEEN LOTS 4 & 5, BLOCK B, OF STERLING FARMS ADDITION
 ELEV: 599.65

PAVING PLAN & PROFILE
BRISTLECONE COURT
 TIMBER CREEK ESTATES
 CITY OF ROCKWALL, ROCKWALL COUNTY, TEXAS

REVISION
W.L.D.
CHECKED
K.E.B.
DRAWN
7/17/00
DATE
9913PV7
PROJECT