

SHEET NOTES:

SUBDIVISION - THE STANDARD - 15.826 ACRES - ZONING - PD-68

NUMBER OF DWELLING UNITS (DU) - 46

OPEN SPACE:

GROSS AREA: 13.03 AC. OR 567,644 S.F.

OPEN AREA: 3.50 AC. OR 152,415 S.F.

OPEN AREA: 26.98% OF GROSS AREA

46 DU - 3.53 DU/AC.

NOTES:

1. ALL LOTS ARE WITHIN 800 FT. OF AN OPEN SPACE OR A PUBLIC PARK.
2. SUBDIVISION ENTRANCE SIGNAGE IS LOCATED AT THE SE CORNER OF S. GOLIAD ST. AND LOT 4.
3. ROOT BARRIERS WILL BE INSTALLED WHERE TREES ARE TO BE INSTALLED WITHIN ROW.
4. NO TREES WITHIN 5 FT. OF UTILITIES.

HARDSCAPE DETAILS

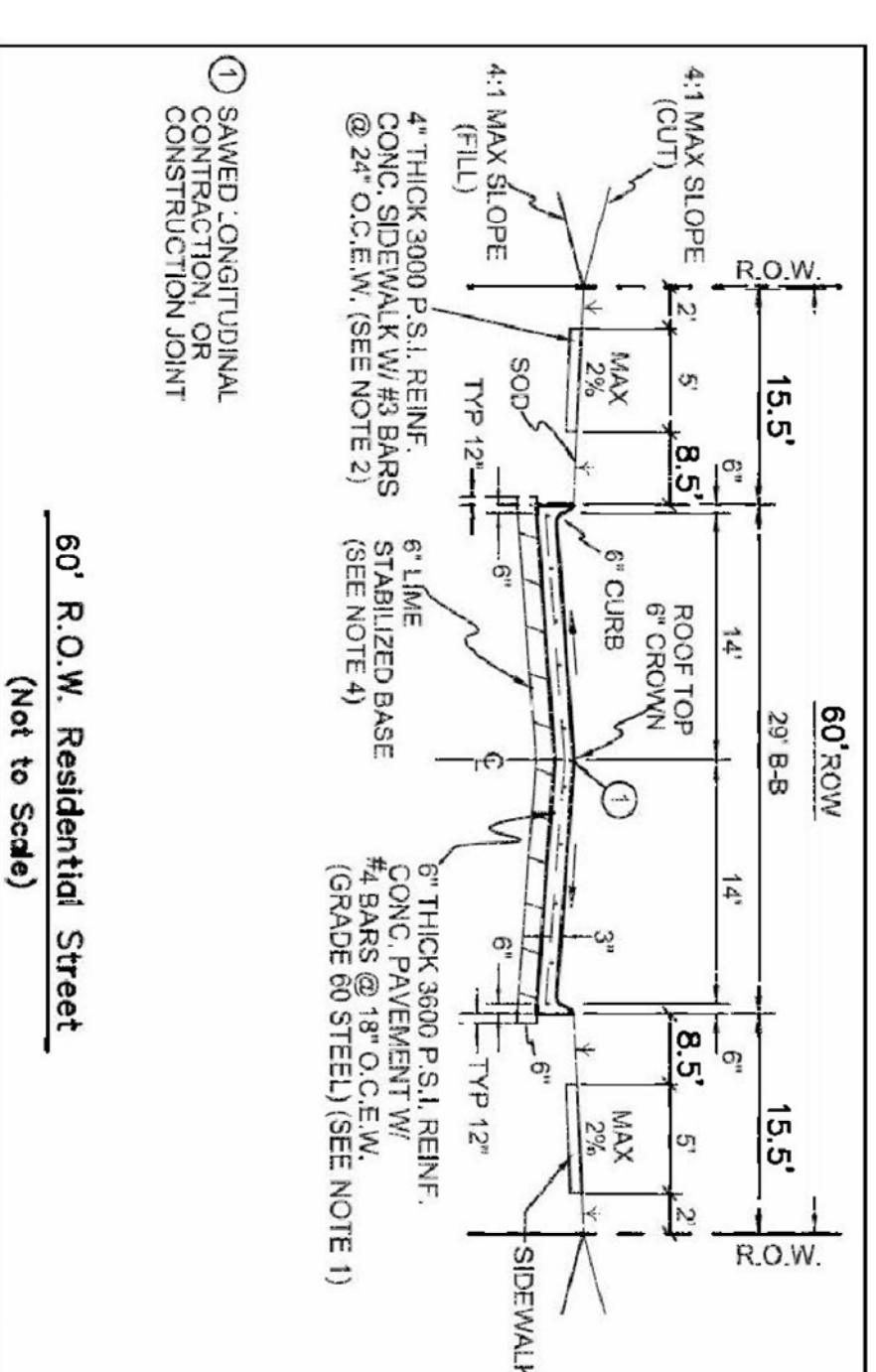

TRAIL NOTES:

STEEL EDGING - 4,800 L.F. APPROX.
 DECOMPOSED GRANITE - 11,308 S.F. APPROX.
 PROVIDE APPROX. 1,750 L.F. OF TEMPORARY IRRIGATION FOR SOD ESTABLISHMENT.

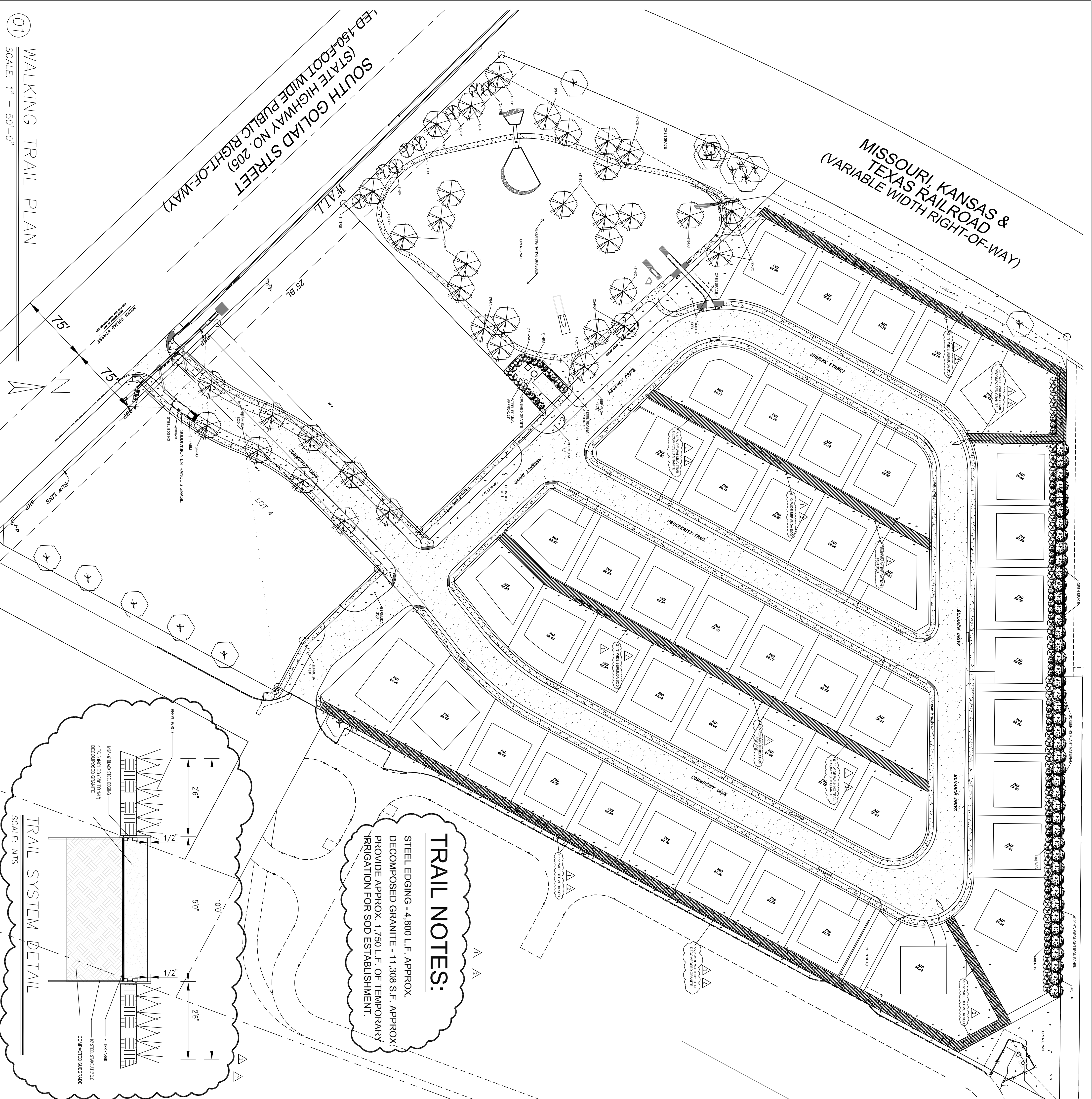

WALKING TRAIL PLAN
 SCALE: 1" = 50'-0"

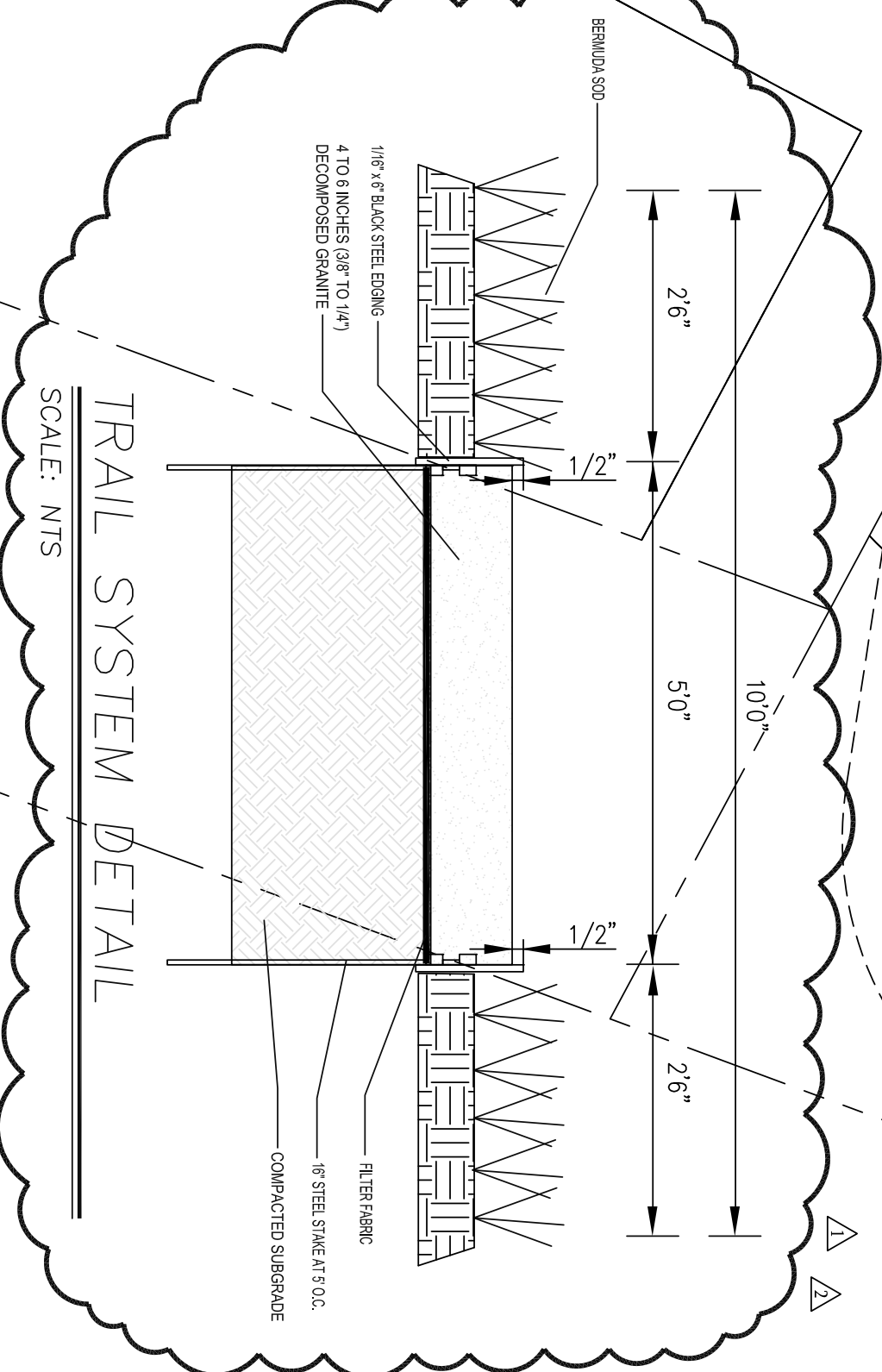

HARDSCAPE, SIDEWALKS/TRAILS KEY

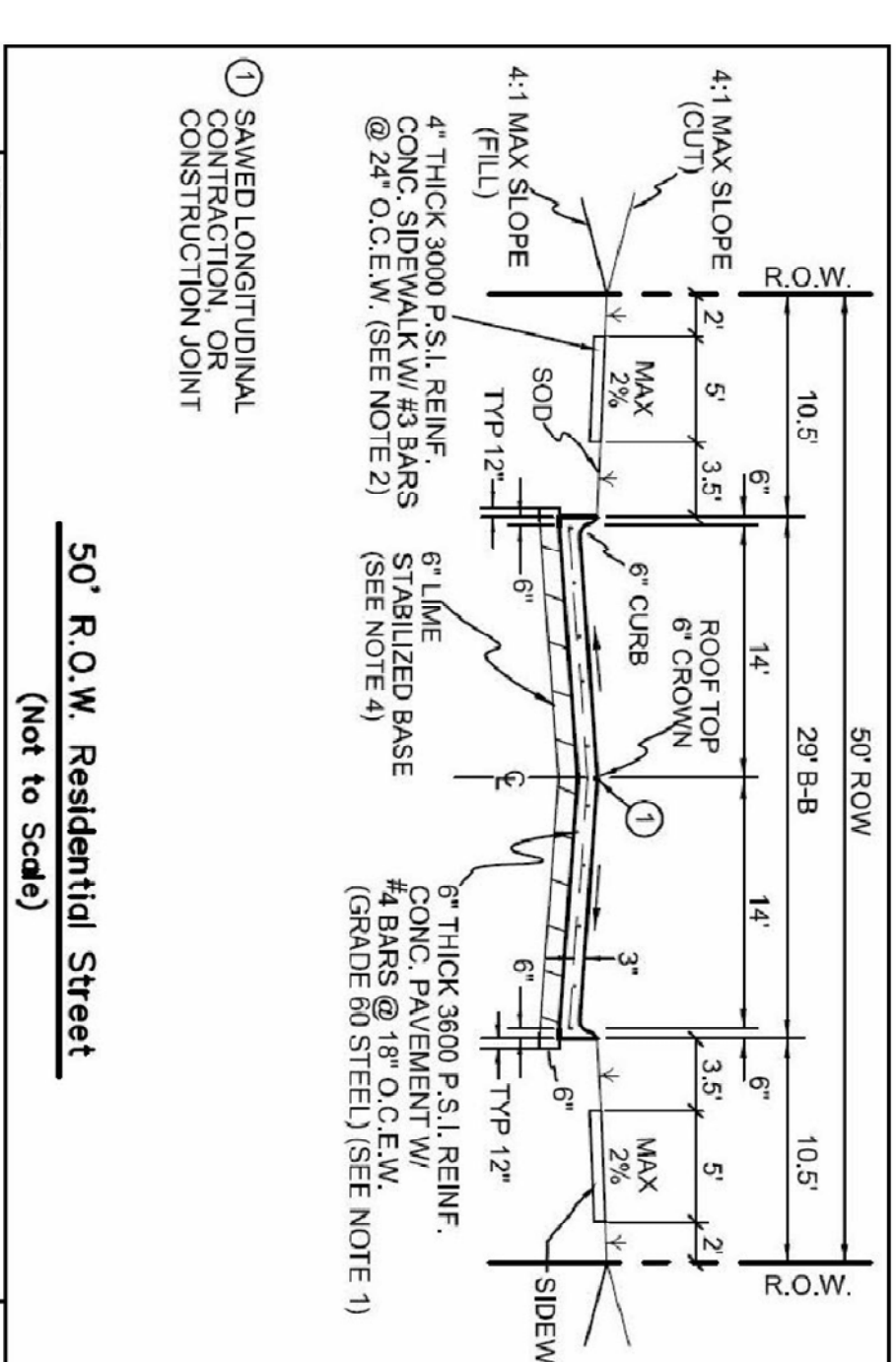
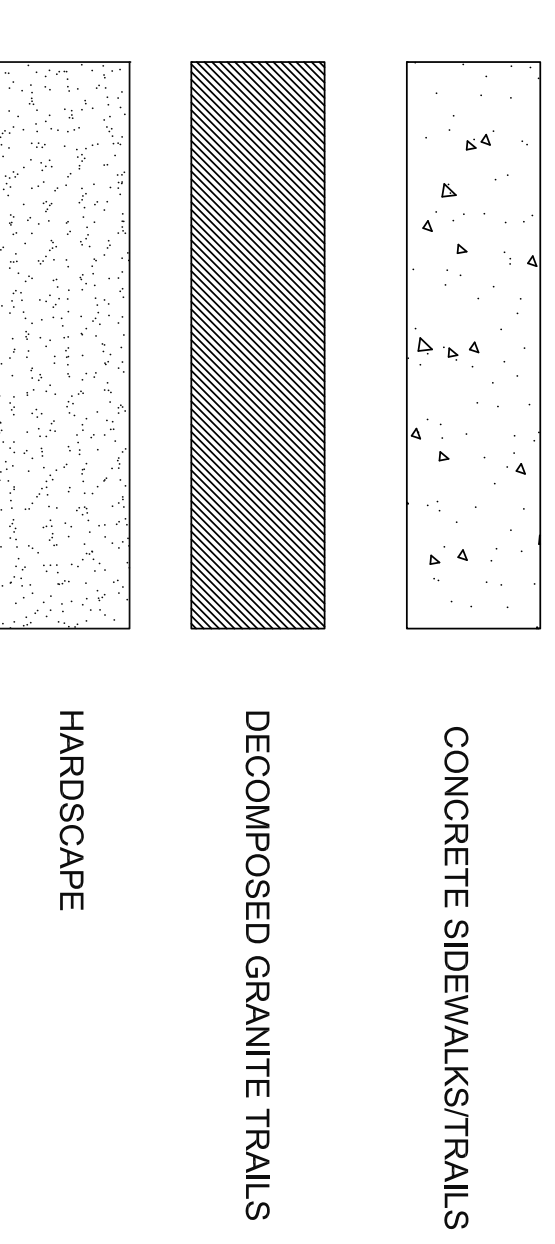

10016	Project Status	2020/24/03
NO.	Revisions	NO. Date
Δ	REVISION	
Δ	REVISION	

SITE PLAN
The Standard
 Goliad St. and Justin Rd.
 Rockwall, Texas

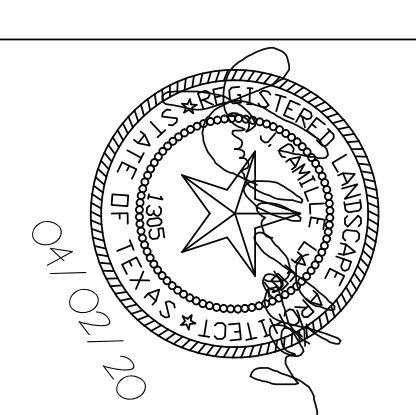

JCL
J. CAMILLE LA FOY
 LANDSCAPE ARCHITECTURE CONSULTING
 101C NORTH GREENVILLE AVENUE, #242
 ALLEN, TEXAS 75002
 214-562-4036

DOUPHRAE & ASSOCIATES, INC.
 ENGINEERING PROJECT MANAGEMENT SURVEYING
 2835 RIDGE ROAD ROCKWALL, TEXAS 75087
 PHONE: (972)771-9004 FAX: (972)771-9006