

| CURVE TABLE |           |         |         |         |             |          |
|-------------|-----------|---------|---------|---------|-------------|----------|
| CURVE       | DELTA     | RADIUS  | TANGENT | LENGTH  | BEARING     | DISTANCE |
| C1          | 18°34'44" | 200.00' | 32.71'  | 64.85'  | N37°41'08"E | 64.57'   |
| C4          | 28°20'44" | 200.00' | 50.51'  | 98.95'  | N75°37'35"E | 97.94'   |
| C5          | 23°32'02" | 270.50' | 86.35'  | 111.11' | S40°09'46"W | 110.33'  |
| C6          | 6°18'44"  | 250.00' | 13.78'  | 27.54'  | S48°46'17"W | 27.53'   |

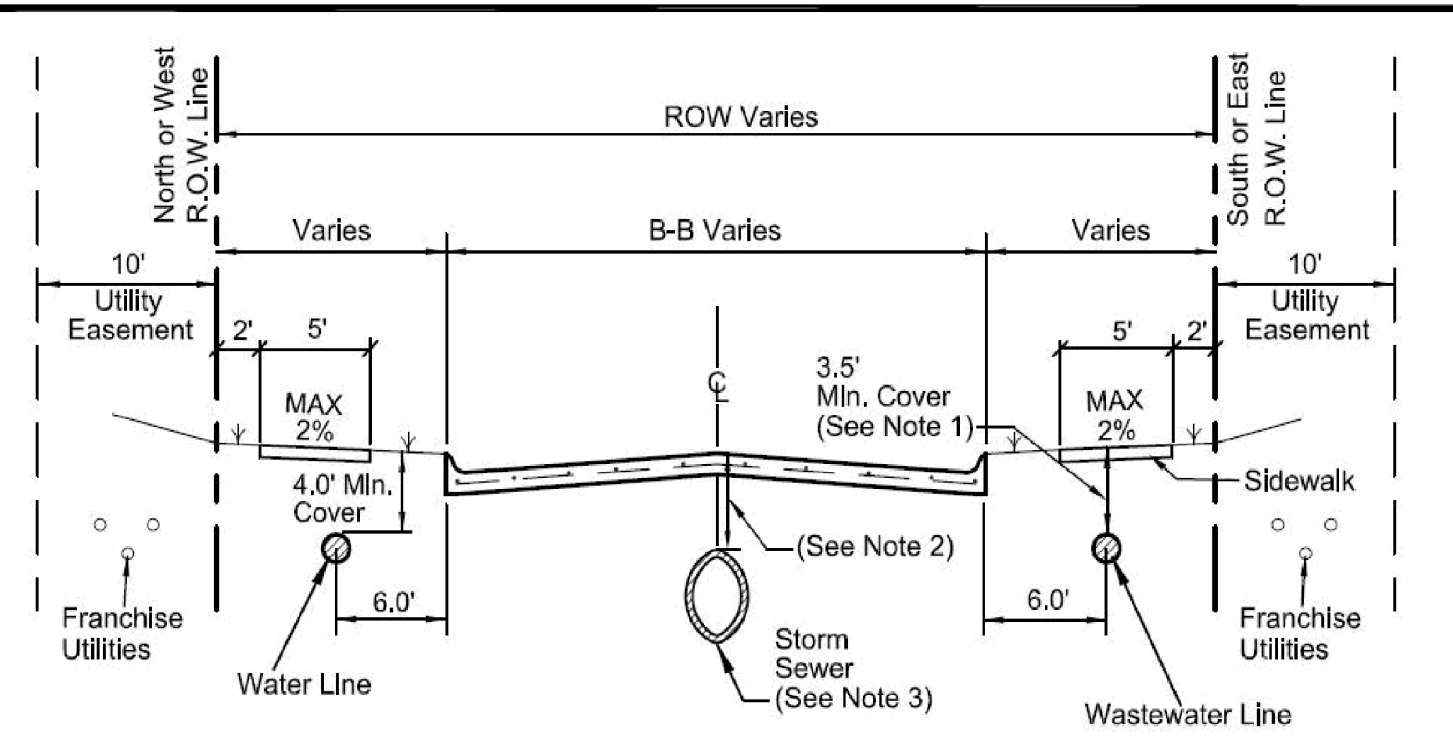

- NOTE:**
- If wastewater line has a cover greater than ten feet (10') than pipe shall be minimum SDR 26 and no services allowed.
  - If cover is two (2) feet or less than Class IV RCP is required.
  - Horizontal location of storm sewer for divided roads to be determined by design engineer. Not to be placed in the parkway.

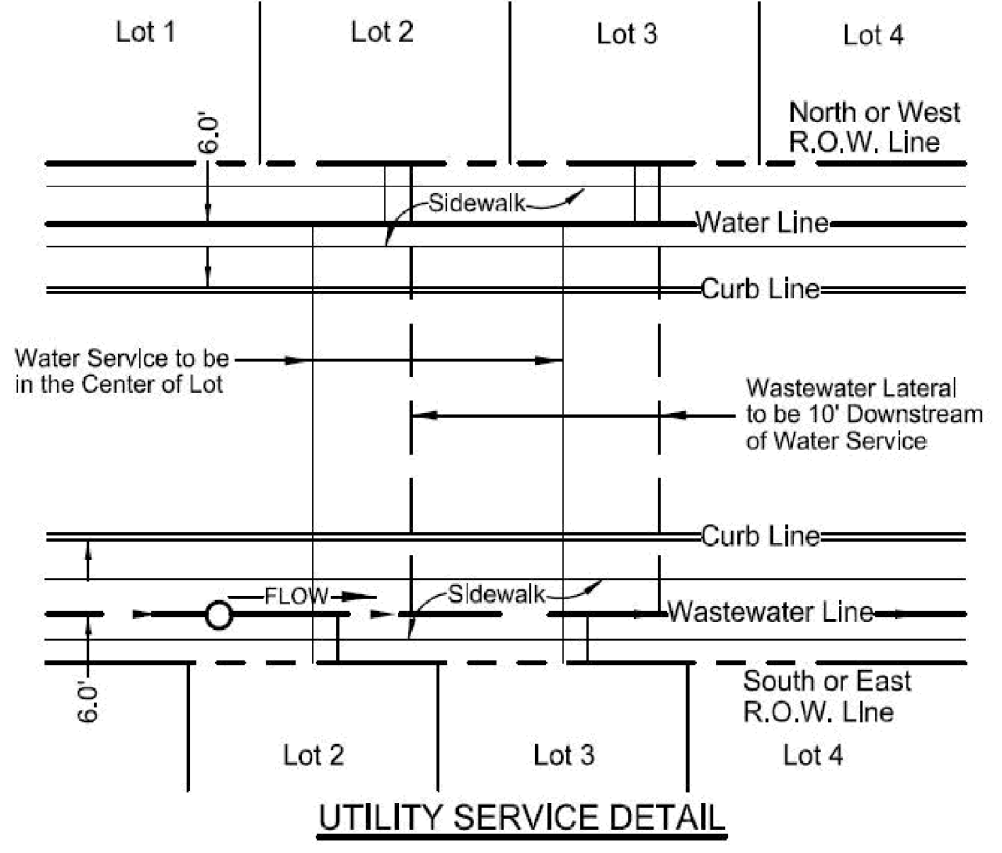

|                             |                  |          |             |
|-----------------------------|------------------|----------|-------------|
| GENERAL UNDERGROUND CONDUIT | CITY OF ROCKWALL | DATE     | DRAWING NO. |
| UTILITIES LOCATION DETAIL   |                  | AUG. '15 | R-3000      |

REVISED TO CONFORM TO CONSTRUCTION RECORDS.  
 DATE: 8-10-20

**NOTE:**  
 ALL MANHOLES TO BE RAVEN LINED  
 OR APPROVED EQUAL  
 ALL MANHOLES TO BE MIN. 4,200 PSI (6.5 SACK MIX)



THE SEAL APPEARING ON THIS DOCUMENT WAS AUTHORIZED BY W.L. DOUPHRATE, LICENSE NO. 80102, EXPIRES ON DATE: APRIL 10, 2016.

**DOUPHRATE & ASSOCIATES, INC.**  
 ENGINEERING • PROJECT MANAGEMENT • SURVEYING  
 2235 RIDGE RD., # 200 ROCKWALL, TEXAS 75087  
 PHONE: (972)771-9004 FAX: (972)771-9005

**SANITARY SEWER PLAN**  
**THE STANDARD**  
 CITY OF ROCKWALL,  
 ROCKWALL COUNTY, TEXAS

3-6-18 REV. ENTRANCE REVISION

W.L.D.  
 CHECKED  
 DAC.  
 DRAWN  
 SCALE  
 1"=80' H  
 1"=80'

APRIL 2018  
 DATE

17013  
 PROJECT