

REVISED TO CONFORM TO CONSTRUCTION RECORDS.  
 DATE: 8-10-20

- NOTE:**
1. NO SMOOTH CONCRETE WALLS ALLOWED.
  2. NO PART OF THE WALL (FOOTINGS, TIE-BACKS, ETC) MAY BE OFF-SITE OR ON LOT LINE, IN EASEMENTS OR R.O.W..
  3. WALL MUST BE COMPLETELY ON ONE LOT.
  4. ALL LOTS NOT TO EXCEED 4:1 MAX SLOPE

**LEGEND**

- BFR BARRIER FREE RAMP
- PAD PROP. PAD ELEVATION
- XX.XX PROP. TOP OF CURB ELEVATION
- XX.XX+ PROP. SPOT GRADES
- XX.XXNG+ NATURAL GROUND ELEVATION
- XX.XXNG-TW+ TOP OF WALL @ NATURAL GROUND ELEVATION
- XX.XX-TW+ PROP. TOP OF WALL ELEVATION
- XX.XXBW PROP. BOTTOM OF WALL ELEVATION
- XX.XXFG+ PROP. FINISHED GRADE ELEVATION
- XX.XXPF+ PROP. FINISHED PAVEMENT ELEVATION

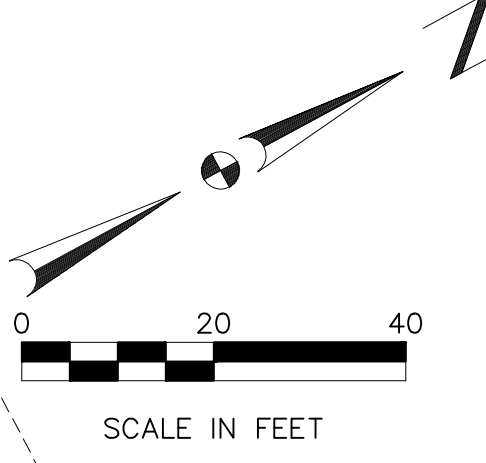
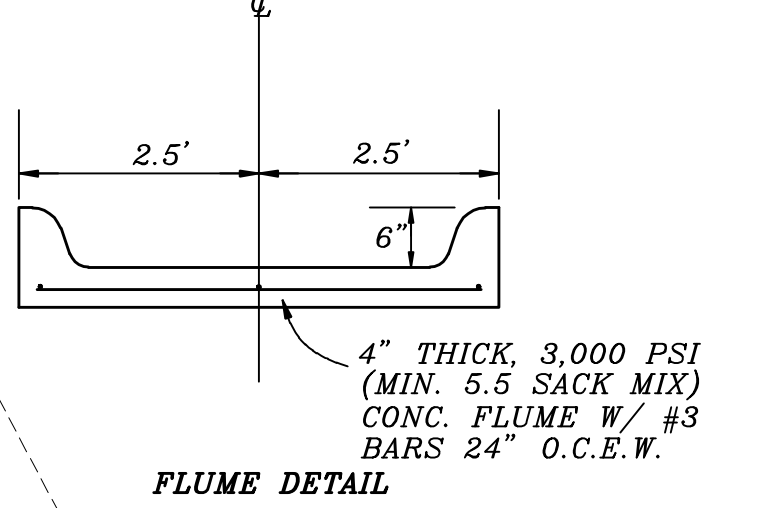

THE SEAL APPEARING ON THIS DOCUMENT WAS AUTHORIZED BY W.L. DOHPHRAE II, TEXAS P.E. LICENSE NO. 60102 EXPIRES APRIL 18, 2018

DOUPHRAE & ASSOCIATES, INC.  
 2235 RIDGE RD., # 200 ROCKWALL, TEXAS 75087  
 PHONE: (972)771-9004 FAX: (972)771-9005

**PROPOSED GRADING**  
**SHT. 4.3**  
**THE STANDARD ROCKWALL**  
 CITY OF ROCKWALL  
 ROCKWALL COUNTY, TEXAS

REVISION	W.L.D.
CHECKED	D.A.C.
DRAWN	
SCALE	1" = 30' H 1" = 1' V
DATE	APRIL 2018
PROJECT	17013
	43