

PROPOSED S.H.205 WIDENING
SEE DETAIL THIS SHEET

NOTE: Saw Cut & Remove 18" of Existing Concrete /Asphalt Pavement
Place Dowels into Existing Concrete with #4 Bars @ 30" O.C.

Proposed Asphalt Transition

NOTE: Saw Cut 18" of Exist. Concrete/Asphalt Pavement

CAUTION !!!
EXISTING UTILITIES AND UNDERGROUND FACILITIES INDICATED ON THESE PLANS HAVE BEEN LOCATED FROM REFERENCE INFORMATION. IT SHALL BE THE RESPONSIBILITY OF THE CONTRACTOR TO VERIFY BOTH HORIZONTALLY AND VERTICALLY THE LOCATION OF ALL EXISTING UTILITIES AND UNDERGROUND FACILITIES PRIOR TO CONSTRUCTION, TO TAKE NECESSARY PRECAUTIONS IN ORDER TO PROTECT ALL FACILITIES ENCOUNTERED. THE CONTRACTOR SHALL PRESERVE AND PROTECT ALL EXISTING UTILITIES FROM DAMAGE DURING CONSTRUCTION.

STATE HIGHWAY 205
(SOUTH GOLIAD STREET)

LEGEND

- ALL PROPOSED FIRE LANES TO BE 6"-3600 PSI (MIN.) REINFORCED CONCRETE PAVEMENT WITH NO. 3 BARS, 24" O.C.E.W., ON 6" LIME STABILIZED SUBGRADE, 6 1/2" SACK HAND POUR, 6 MIN. 6 SACK MACHINE POUR, PER GEOTECHNICAL RECOMMENDATIONS
- 11 1/2" REINFORCED CONCRETE PVMT PER TXDOT STANDARDS, 6" LIME TREATED SUB GRADE (4% Lime) PER TXDOT STANDARDS
- EXISTING CONCRETE PAVEMENT
- AREA OF PAVEMENT TO BE REMOVED.
- 11 1/2" REINFORCED CONCRETE PVMT PER TXDOT STANDARDS, 6" LIME TREATED SUB GRADE (4% Lime) PER TXDOT STANDARDS
- FIRE LANE
- PROPOSED TOP OF PAVEMENT
- PROPOSED TOP OF CURB
- EXISTING ELEVATION
- FINISHED FLOOR ELEVATION

- NOTES:**
- ALL DIMENSIONS ARE TO FACE OF CURB UNLESS NOTED OTHERWISE
 - ALL RADII ALONG FIRE LANE ARE MIN. 24.0 @ BACK OF CURB
 - ALL SURFACE PARKING SPACES ARE 9.0' WIDE x 20.0' DEEP OR 18.0' DEEP w. A 2' OVERHANG. NO SHRUBS SHALL BE CONTAINED IN THIS 2' OVERHANG AREA. SHRUBS SHALL BE PLACED 4' FROM THE FACE OF CURB WHERE ADJACENT TO 18' PARKING SPACES.
 - REFER TO LANDSCAPE PLANS FOR ALL SIDEWALK, SCREENING, OPEN SPACE CALCULATIONS, AND MONUMENT SIGN LOCATIONS.
 - REFER TO SITE LIGHTING PLANS FOR LIGHTING LOCATIONS, SPECIFICATIONS, AND PHOTOMETRIC DETAILS.
 - REFER TO BUILDING ELEVATION PLANS FOR ALL BUILDING SIGNAGE LOCATIONS AND DETAILS.
 - A 10x10" OR 5'x10" WATER ESMT. TO BE PROVIDED AROUND EACH FIRE HYDRANT.
 - ALL FIRE LANES SHALL BE CONSTRUCTED MARK PER CITY OF ROCKWALL SPECIFICATIONS.
 - CONTRACTOR ADJUSTMENTS TO SPOT GRADES TO MAINTAIN POSITIVE DRAINAGE IS ALLOWED, WITH PRIOR APPROVAL OF THE ENGINEER. CONTRACTOR SHALL CONTACT THE ENGINEER PRIOR TO PAVING IF AREAS OF POOR DRAINAGE ARE ENCOUNTERED.

4" SOLID WHITE STRIPE
W/4" BUTTONS AT 10' O.C.

NOTE: Saw Cut 18" of Exist. Concrete/Asphalt Pavement

NOTE: EXISTING POWER POLES TO BE RELOCATED PRIOR TO CONSTRUCTION

NOTE: REMOVE AND RELOCATE EXISTING FENCE

PAVING GENERAL NOTES

- ALL CONSTRUCTION SHALL CONFORM TO TEXAS DEPARTMENT OF TRANSPORTATION "STANDARD SPECIFICATION FOR CONSTRUCTION OF HIGHWAYS, STREETS, AND BRIDGES" DATED 1993, THE MOST CURRENT EDITION, AND OTHER TEXAS HIGHWAY DEPARTMENT STANDARDS, SPECIFICATIONS AND REQUIREMENTS.
- HMAC SHALL MEET TXDOT SPECIFICATION ITEM 340. THE PAVEMENT SHALL BE 6 INCHES THICK, WITH THE FIRST 4 INCHES TYPE "B" BASE COURSE, AND THE FINAL 1 1/2 INCHES TYPE "D" SURFACE COURSE.
- THE DECELERATION LANE SHALL HAVE A 2% CROSS SLOPE AWAY FROM THE EXISTING EDGE OF PAVEMENT. THE ROADWAY DITCH SHALL BE REGRADED AND MOVED BEYOND THE NEW PAVED AREA IN A CROSS SECTION THAT MATCHES THE EXISTING DITCH.
- TRAFFIC CONTROL AND PAVEMENT STRIPPING SHALL BE PER CITY OF ROCKWALL, N.C.T.C.O.G. AND TXDOT SPECIFICATIONS.
- ALL PAVEMENT PROPOSED IN S.H.205 RIGHT-OF-WAY SHALL BE INSTALLED & TESTED PER TXDOT SPECIFICATIONS & STANDARDS
- CONTRACTOR TO MAINTAIN 2 LANES OF OPEN TRAFFIC AT ALL TIMES ALONG MIMS ROAD.

RECORD DRAWING:
These plans, to the best of our knowledge and based on information supplied by the contractor, represent the general conditions that were constructed. Any changes or modifications shown which differ from the City approved plans are based on the information supplied by the contractor. As Lucas Consulting Services did not perform any construction inspection on this project, Lucas Consulting Services makes no certification or approval as to the quality or correctness of the construction of the facilities shown on these plans.

MICHAEL D. LUCAS
DATE: 02/26/05
LUCAS CONSULTING SERVICES

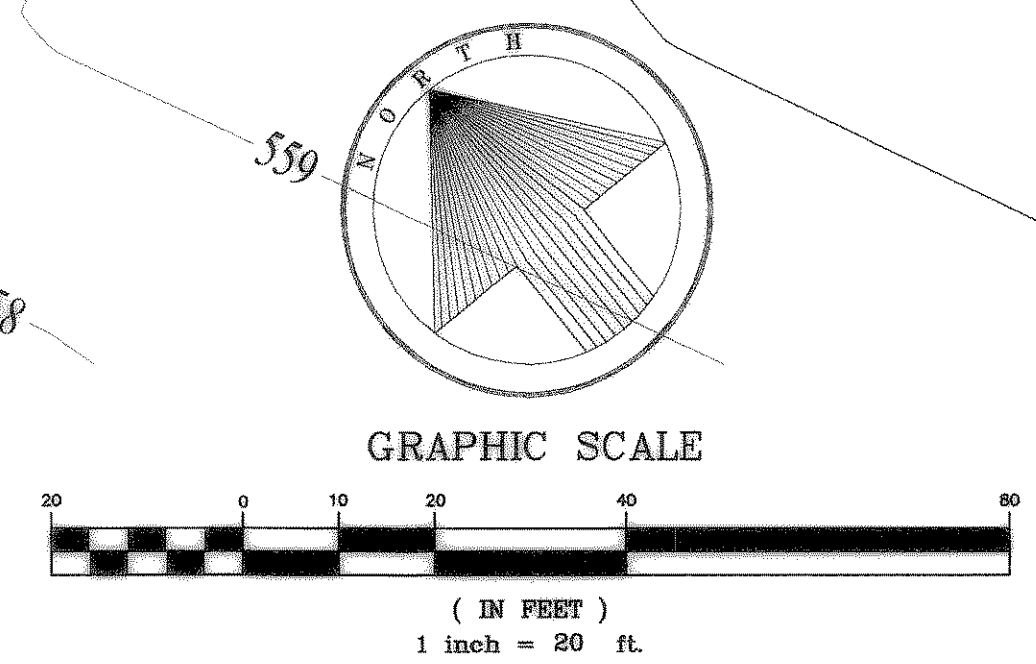
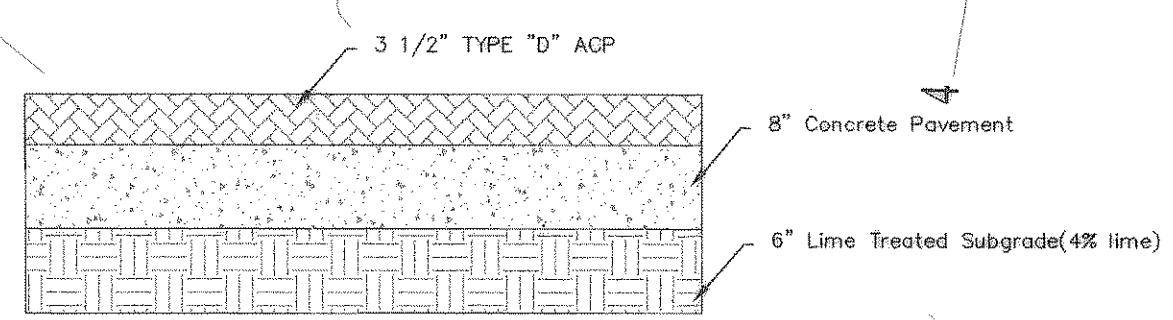

BENCHMARK -
TOP RIM OF SANITARY SINKER MANHOLE ON SOUTH SIDE OF MIMS ROAD, LOCATED 100 FEET WEST AND 20 FEET NORTH OF THE NORTHWEST CORNER OF LOT 1, BLOCK 1 TEXAS STAR ADDITION. ELEVATION=566.55 MVD 29
TOP OF STANDARD USGS MON STAMPED "M 929 1945" AT THE NORTHWEST CORNER OF A CONCRETE BRIDGE OVER SH 205 IN THE TOP OF THE CONCRETE GUARDRAIL BASE, 17 FT. SOUTHWEST OF THE CENTERLINE OF HIGHWAY AND 3 FT. SOUTHWEST OF THE NORTHWEST END OF GUARDRAIL BASE. ELEV. = 524.80 MVD 29

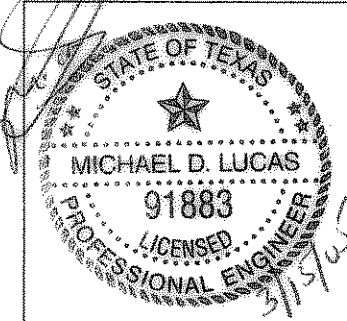

revisions	date
REMOVED MIMS ROAD PAVEMENT IMPROVEMENTS	03/03/05

Lucas Consulting Services
1932 Gullwing Drive Rockwall, Texas 75087
ph: 972-722-8314 fax: 972-722-8314
email: lucasconsulting@charter.net

TEXAS STAR EXPRESS GRADING, PAVING, AND DIMENSION CONTROL PLAN ROCKWALL, TEXAS					sheet no.
design	drawn	scale	date	notes	job number
LCS	LCS	1"=20'	OCT. 2004	*	#022-01-04