

# CONSTRUCTION PLANS FOR STONEY HOLLOW ADDITION DRAINAGE IMPROVEMENTS CITY OF ROCKWALL ROCKWALL COUNTY, TEXAS

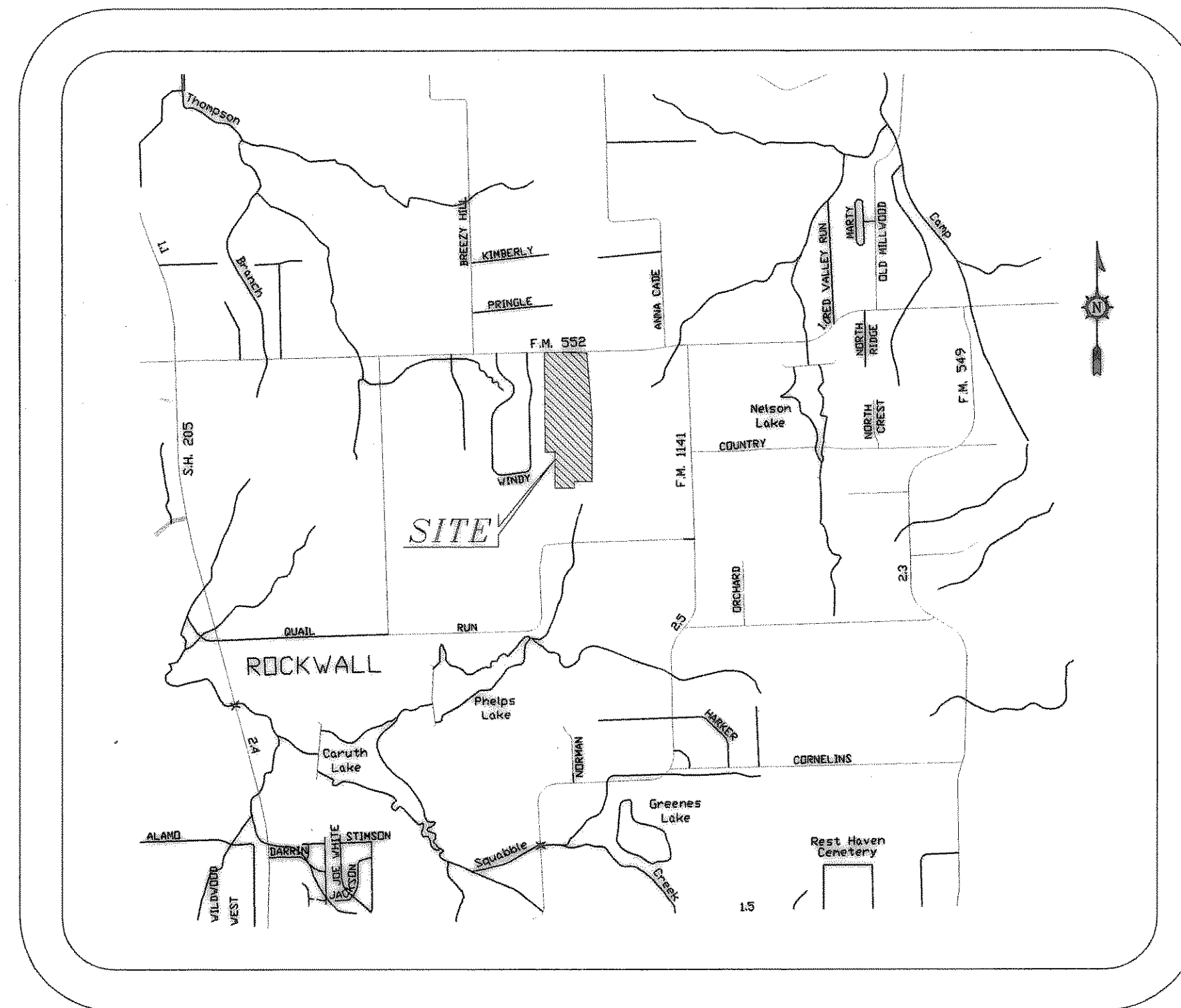

LOCATION MAP  
1" = 2000'

GENERAL NOTE

ALL MATERIALS AND CONSTRUCTION SHALL CONFORM TO THE CITY OF ROCKWALL STANDARD CONSTRUCTION DETAILS FOR PAVING, DRAINAGE, WATER & SANITARY SEWER FACILITIES AND BE INSTALLED IN ACCORDANCE WITH THE CITY SPECIFICATIONS AND STANDARD SPECIFICATIONS FOR PUBLIC WORKS CONSTRUCTION FOR NORTH CENTRAL TEXAS PUBLISHED BY NCTCOG. THESE SPECIFICATIONS SHALL BE MADE PART OF THESE PLANS. ALL WORK SHALL BE INSPECTED BY THE CITY OF ROCKWALL PUBLIC WORKS INSPECTORS.

## INDEX

SHEET NO.	DESCRIPTION
1-3	FINAL PLAT
4	DRAINAGE AREA MAP
5	INLET & STORM CALCULATIONS
6-10	STORM SEWER PLANS & PROFILES
11	EROSION CONTROL PLAN
12-14	CHANNEL PLAN
D1-D2	JUNCTION BOX DETAILS

**DEVELOPER:**

D.R. HORTON-TEXAS, LTD.  
310 E. IH-30 STE. 280  
GARLAND, TEXAS 75043  
(972) 226-4333

**ENGINEER \ SURVEYOR:**

JONES & BOYD, INC.  
17090 DALLAS PARKWAY, SUITE 200  
DALLAS, TEXAS 75248  
(972) 248-7676

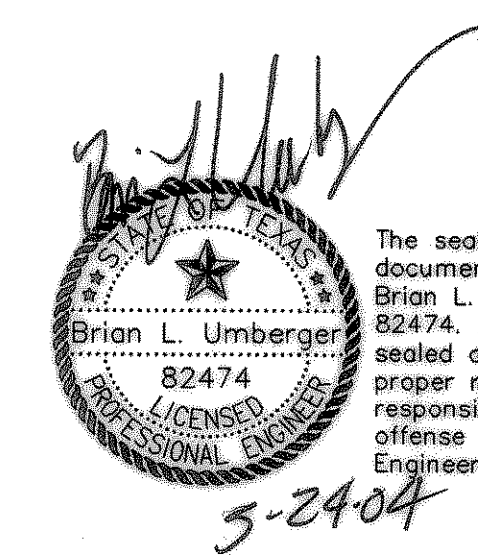

The seal appearing on this document was authorized by Brian L. Umberger, P.E. 82474. Alteration of a sealed document without proper notification to the responsible engineer is an offense under the Texas Engineering Practice Act.

5-2404

RECORD DRAWINGS  
THESE RECORD DRAWINGS HAVE BEEN PREPARED BASED ON INFORMATION PROVIDED BY OTHERS. JONES & BOYD, INC. DOES NOT WARRANT THE ACCURACY AND/OR COMPLETENESS OF THIS INFORMATION. UNLESS OTHERWISE NOTED ON THESE DRAWINGS, JONES & BOYD, INC. SHALL NOT BE RESPONSIBLE FOR ANY ERRORS OR OMISSIONS THAT MAY BE INCURRED AS A RESULT OF USING THIS INFORMATION. PROVIDE TO OTHERS INFORMATION PROVIDED BY OTHERS.

BY: *[Signature]*  
DATE: 4/25/00

STONEY HOLLOW DRAINAGE IMPROVEMENTS