

**BENCHMARK NOTES:**  
 R.R. SPIKE SET IN PP 89± E OF N.E. COR. OF PROPERTY  
 ELEV: 558.16  
 R.R. SPIKE SET IN PP 2± WEST OF N.W. COR. OF PROPERTY  
 ELEV: 549.83

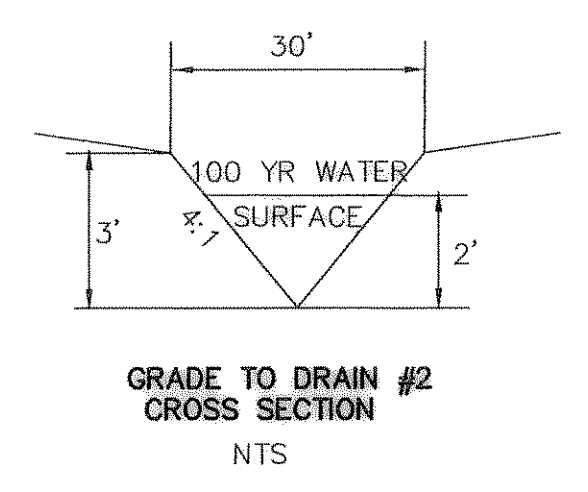

STORM LINE "D"

REVISED TO CONFORM TO CONSTRUCTION RECORDS.  
 DATE: 1/25/04

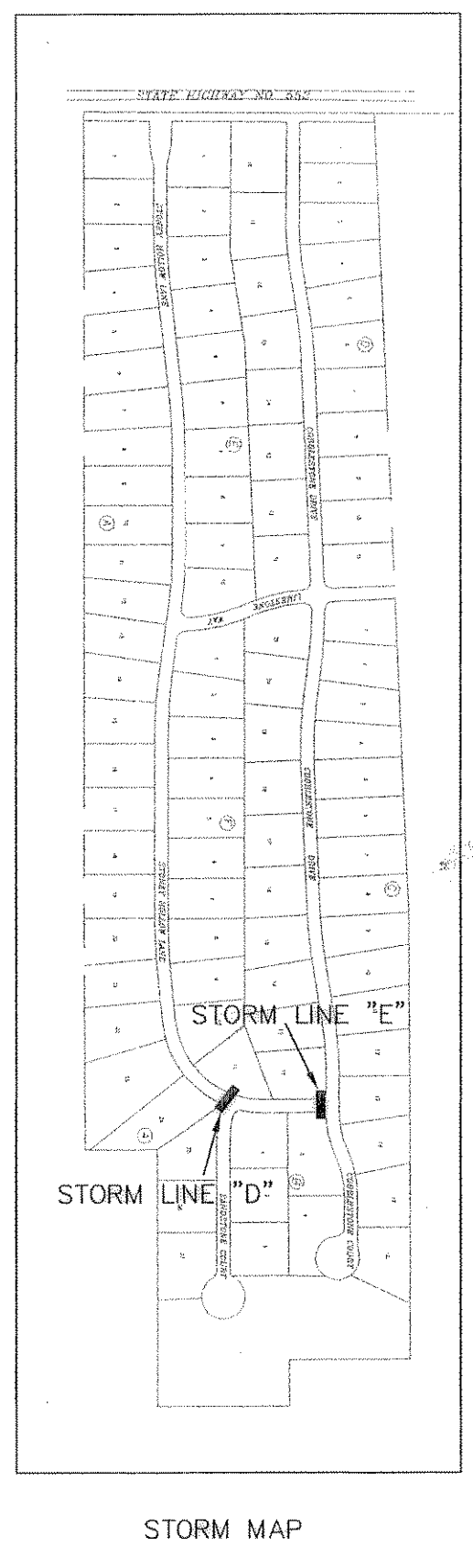
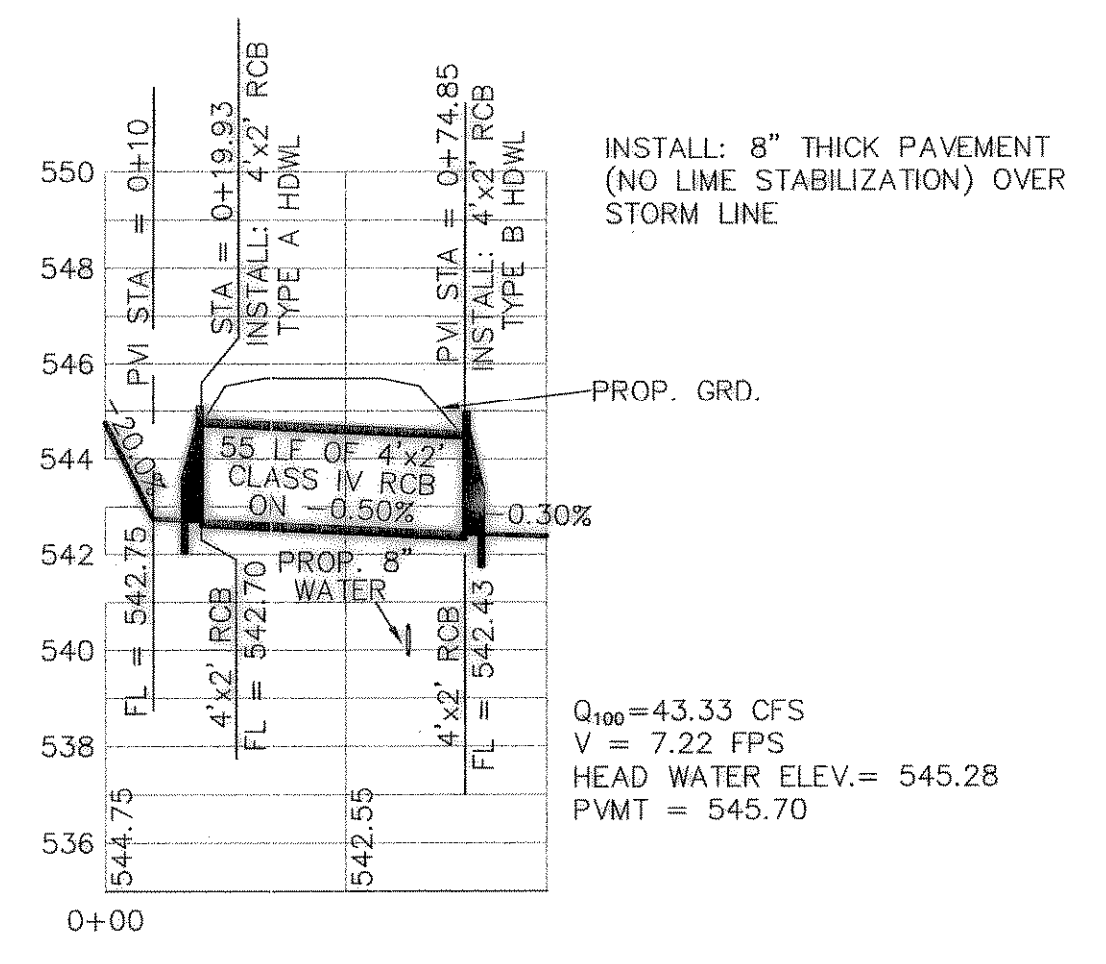
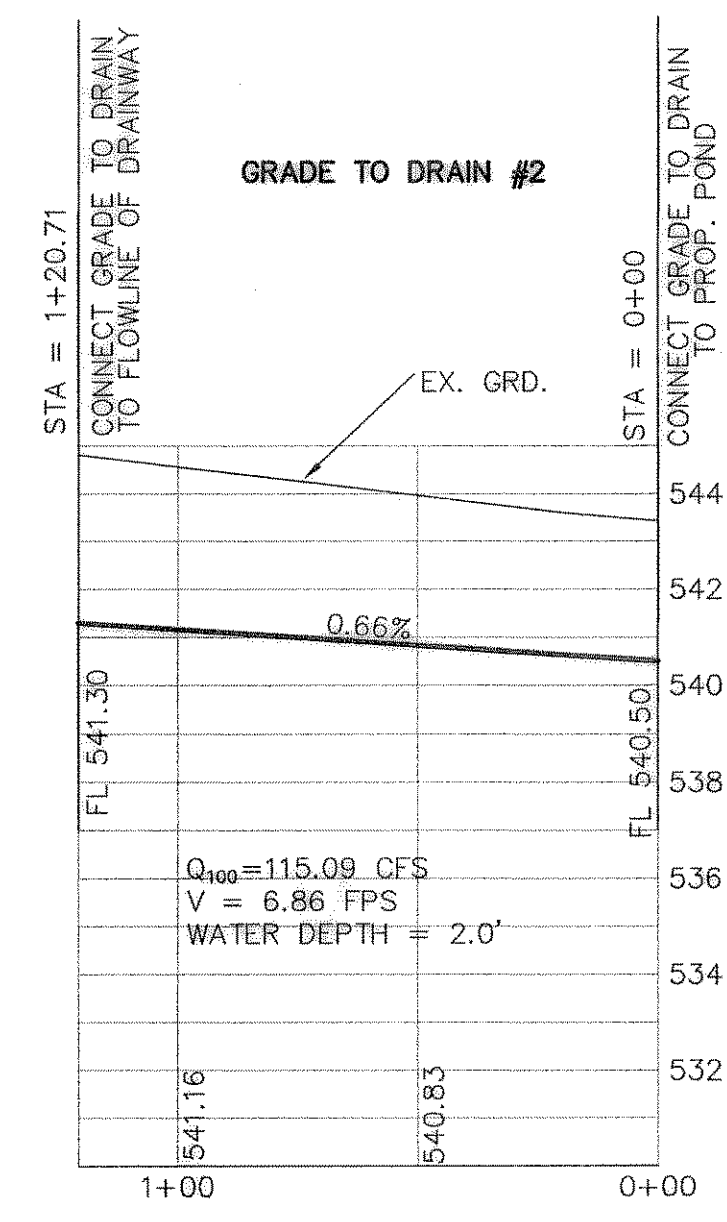
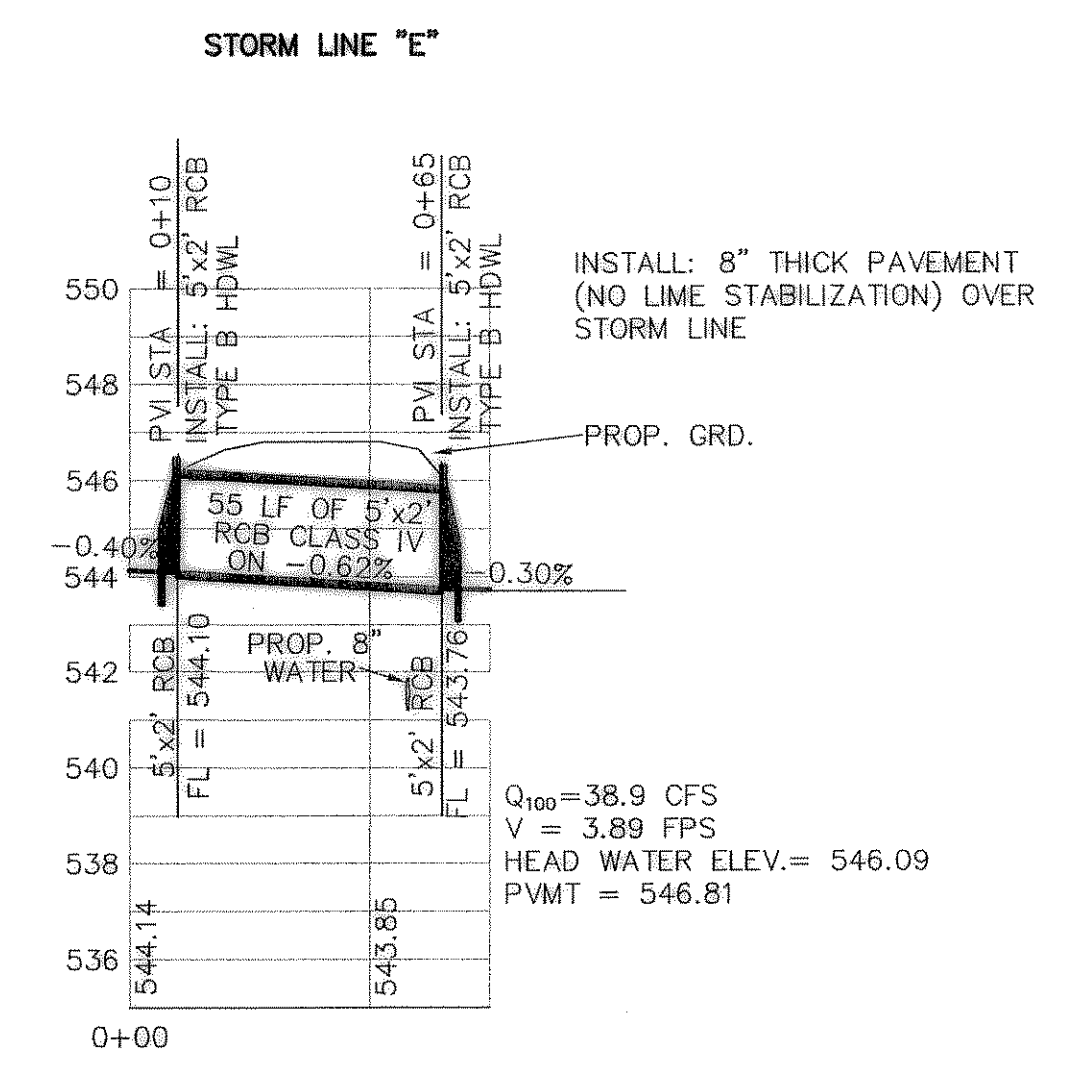
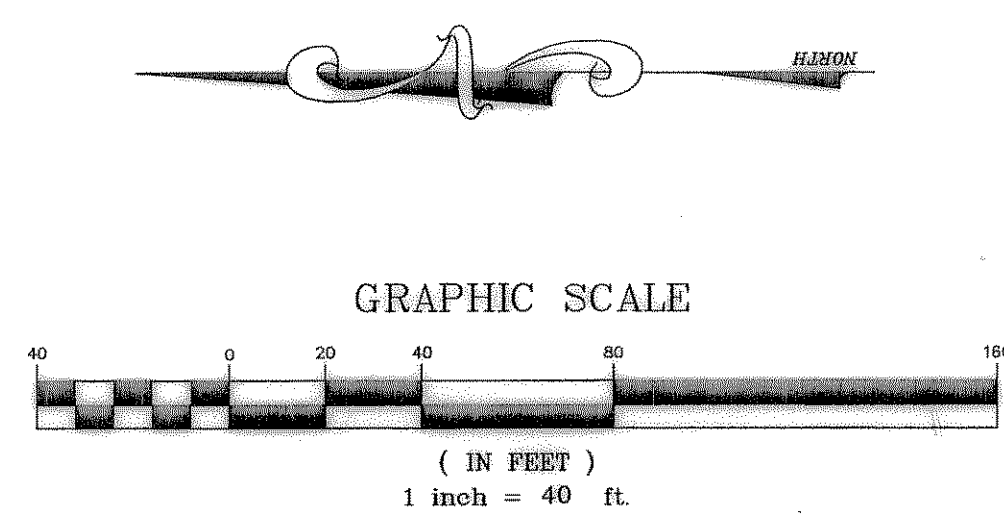
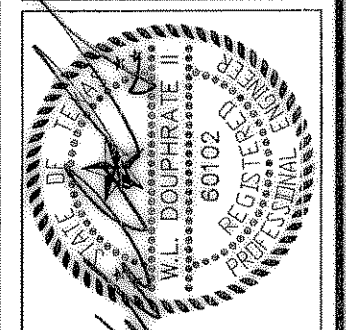

THE SEAL APPEARING ON THIS DOCUMENT WAS AUTHORIZED BY W.L. DOUPHRATE II, TEXAS P.E. NO. 60102 ON 1/25/04

**DOUPHRATE & ASSOCIATES, INC.**  
 ENGINEERING - PROJECT MANAGEMENT - SURVEYING  
 2235 RIDGE RD., # 200 ROCKWALL, TEXAS 75087  
 PHONE: (972)771-8004 FAX: (972)771-9005

**STORM SEWER PLAN & PROFILES**  
**LINES D & E**  
**STONEY HOLLOW ADDITION**  
 CITY OF ROCKWALL, ROCKWALL COUNTY, TEXAS

REV. 6-04-02  
 PER CITY COMMENTS

REVISION	
W.L.D. CHECKED	
K.E.B. DRAWN	
12/01 DATE	
9907STM2 PROJECT	