

BENCHMARK NOTES:

R.R. SPIKE SET IN PP 89± E OF N.E. COR. OF PROPERTY
ELEV: 558.16

R.R. SPIKE SET IN PP 2± WEST OF N.W. COR. OF PROPERTY
ELEV: 549.83

**CAUTION!!!
UNDERGROUND UTILITIES**

EXISTING UTILITIES AND UNDERGROUND FACILITIES INDICATED ON THESE PLANS HAVE BEEN LOCATED FROM REFERENCE INFORMATION SUPPLIED BY VARIOUS OWNERS OF THE FACILITIES. THE ENGINEER DOES NOT ACCEPT THE RESPONSIBILITY FOR THE UTILITY LOCATIONS SHOWN. IT SHALL BE THE RESPONSIBILITY OF THE CONTRACTOR TO VERIFY BOTH HORIZONTALLY AND VERTICALLY THE LOCATION OF ALL EXISTING UTILITIES AND UNDERGROUND FACILITIES PRIOR TO CONSTRUCTION. TO TAKE NECESSARY PRECAUTIONS IN ORDER TO PROTECT ALL FACILITIES ENCOUNTERED, AND TO NOTIFY THE ENGINEER PROMPTLY OF ALL CONFLICTS OF THE WORK WITH EXISTING FACILITIES. THE CONTRACTOR SHALL PRESERVE AND PROTECT ALL EXISTING FACILITIES FROM DAMAGE DURING CONSTRUCTION. ANY DAMAGE BY THE CONTRACTOR TO EXISTING UTILITIES SHALL BE REPAIRED BY THE CONTRACTOR AT HIS EXPENSE.

PARK CENTRAL

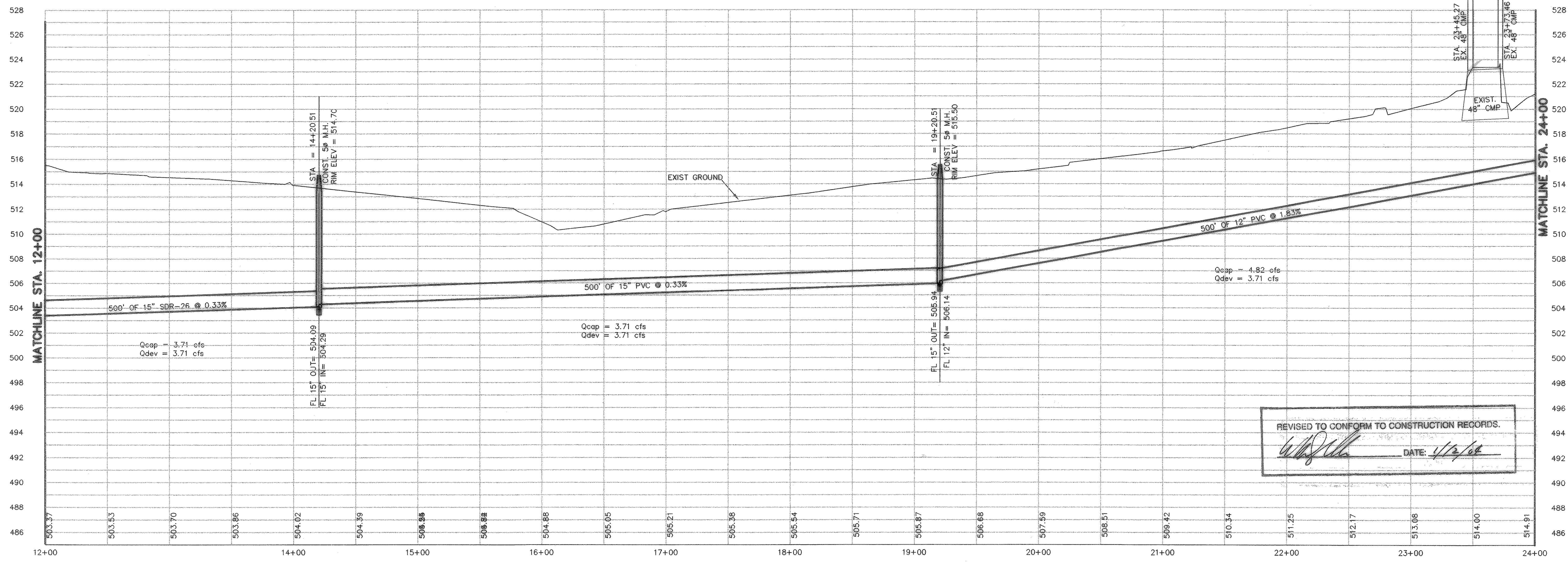

REVISED TO CONFORM TO CONSTRUCTION RECORDS.
[Signature] DATE: 4/12/04

THE SEAL APPEARING ON THIS DOCUMENT WAS AUTHORIZED BY THE BOARD OF ENGINEERING EXAMINERS IN TEXAS P.E. NO. 80102 ON 8/1/02

DOUPHRATE & ASSOCIATES, INC.
 ENGINEERING - PROJECT MANAGEMENT - SURVEYING
 2235 RIDGE RD., # 200 ROCKWALL, TEXAS 75087
 PHONE: (972)771-8004 FAX: (972)771-9005

OFF-SITE SAN. SEW. PLAN & PROFILE
 STA. 12+00 - 24+00
 STONEY HOLLOW ADDITION
 CITY OF ROCKWALL, ROCKWALL COUNTY, TEXAS

REVISION	W.L.D.
CHECKED	K.E.B.
DRAWN	2/02
DATE	9907OFFSITES92
PROJECT	26
	48